

(SUBMIT IN TRIPLICATE)

UNITED STATES
DEPARTMENT OF THE INTERIOR
GEOLOGICAL SURVEY

Land Office Santa Fe
Lease No. AN 03551
Unit _____
Derrick "6"

SUNDRY NOTICES AND REPORTS ON WELLS

NOTICE OF INTENTION TO DRILL.....	<input checked="" type="checkbox"/>	SUBSEQUENT REPORT OF WATER SHUT-OFF.....	
NOTICE OF INTENTION TO CHANGE PLANS.....		SUBSEQUENT REPORT OF SHOOTING OR ACIDIZING.....	
NOTICE OF INTENTION TO TEST WATER SHUT-OFF.....		SUBSEQUENT REPORT OF ALTERING CASING.....	
NOTICE OF INTENTION TO RE-DRILL OR REPAIR WELL.....		SUBSEQUENT REPORT OF RE-DRILLING OR REPAIR.....	
NOTICE OF INTENTION TO SHOOT OR ACIDIZE.....		SUBSEQUENT REPORT OF ABANDONMENT.....	
NOTICE OF INTENTION TO PULL OR ALTER CASING.....		SUPPLEMENTARY WELL HISTORY.....	
NOTICE OF INTENTION TO ABANDON WELL.....			

(INDICATE ABOVE BY CHECK MARK NATURE OF REPORT, NOTICE, OR OTHER DATA)

..... September 16, 1962

Well No. D-50 is located 990 ft. from N line and 990 ft. from W line of sec. 5

NE 1/4 Section 5 (1/4 Sec. and Sec. No.) 26 North (Twp.) 6 West (Range) 100W (Meridian)

Basin Dakota (Field) Hio Arriba (County or Subdivision) New Mexico (State or Territory)

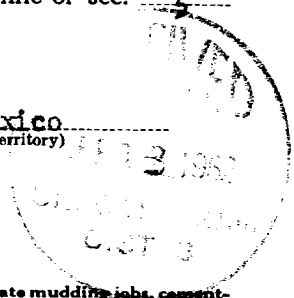

The elevation of the derrick floor above sea level is _____ ft.

DETAILS OF WORK

(State names of and expected depths to objective sands; show sizes, weights, and lengths of proposed casings; indicate mudding jobs, cementing points, and all other important proposed work)

It is proposed to mud drill with rotary drilling equipment to approximately 7800' to test the Dakota formation. The following casing and cementing program will be used:
 9-5/8" 32.30# N-40 Seamless Casing to 250' cemented top to bottom
 4 1/2" 11.6# J-55 Seamless Casing 0 to 1000', 4 1/2" 10.5# J-55 Seamless Casing from 1000' to 6800' and 4 1/2" 11.6# J-55 Seamless casing 6800' to 7800'.

The 4 1/2" casing will be cemented through the casing shoe with 150 sks. 12% aquapel cement followed by 100 sks. latex cement. It will also be cemented through a stage collar at approximately 3600' with 350 sks. 12% aquapel cement followed by 50 sks. neat. The second stage is 150% of the calculated volume required to cover the Mesa Verde and Pictured Cliffs zones.

The 4 1/2" casing will be perforated in the Dakota zone and the well will be sand/water fractured to obtain the best possible completion.

I understand that this plan of work must receive approval in writing by the Geological Survey before operations may be commenced.

Company Caulkins Oil Company

Address Box 780

Hardington, New Mexico

By Frank Gray

Title Superintendent

NEW MEXICO OIL CONSERVATION COMMISSION
WELL LOCATION AND ACREAGE DEDICATION PLAT

SECTION A.

DATE _____

OPERATOR Caulkins Oil Company LEASE Breech "E"
 WELL NO. D-50 UNIT LETTER A SECTION 5 TOWNSHIP 26 North RANGE 6 West NMPM
 LOCATED 990 FEET FROM North LINE, 990 FEET FROM East LINE
 COUNTY Rio Arriba S. L. ELEVATION 6549 DEDICATED ACREAGE N 320.52 ACRES
 NAME OF PRODUCING FORMATION Dakota POOL Basin Dakota

1. IS THE OPERATOR THE ONLY OWNER* IN THE DEDICATED ACREAGE OUTLINED ON THE PLAT BELOW? YES _____ NO X
 2. IF THE ANSWER TO QUESTION ONE IS "NO," HAVE THE INTERESTS OF ALL THE OWNERS BEEN CONSOLIDATED BY COMMUNITIZATION AGREEMENT OR OTHERWISE? YES X NO _____ IF ANSWER IS "YES," TYPE OF CONSOLIDATION _____

3. IF THE ANSWER TO QUESTION TWO IS "NO," LIST ALL THE OWNERS AND THEIR RESPECTIVE INTERESTS BELOW:

OWNER	LAND DESCRIPTION

SECTION B.

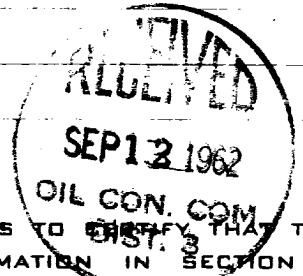
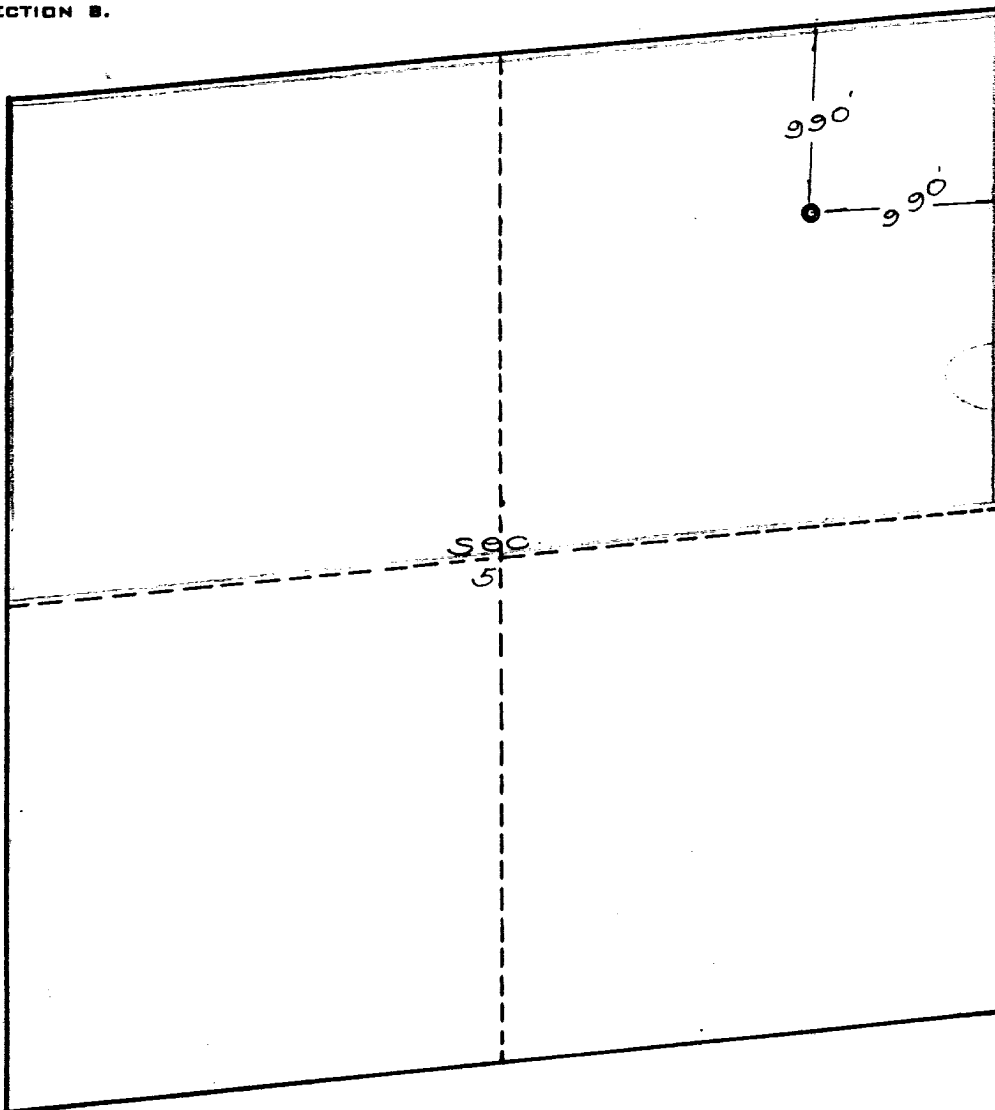

THIS IS TO CERTIFY THAT THE INFORMATION IN SECTION A ABOVE IS TRUE AND COMPLETE TO THE BEST OF MY KNOWLEDGE AND BELIEF.

Caulkins Oil Company
(OPERATOR)

Frank O. Gray
(REPRESENTATIVE)

Frank O. Gray
Box 967, Farmington, N. M.
(ADDRESS)

THIS IS TO CERTIFY THAT THE WELL LOCATION SHOWN ON THE PLAT IN SECTION B WAS PLOTTED FROM FIELD NOTES OF ACTUAL SURVEY MADE BY ME OR UNDER MY SUPERVISION AND THAT THE SAME IS TRUE AND CORRECT TO THE BEST OF MY KNOWLEDGE AND BELIEF.

DATE SURVEYED SEP 8, 1962

FOUR STATES ENGINEERING CO.

FARMINGTON, NEW MEXICO

Earnest S. Cash
REGISTERED ENGINEER OF LAND SURVEYOR

CERTIFICATE NO. 3602

3-25-68

CAULKINS OIL COMPANY

WELLS REQUIRING FILE CORRECTION ONLY

LEASE NAME & WELL NUMBER	LOCATION	POOL	PRESENT ACREAGE	CORRECT ACREAGE
Breech E #64	A-1-26N-6W	Blanco MV	E 320	E 320.49 ✓
Breech E #64	A-1-26N-6W	Basin Dak.	E 320	E 320.49 ✓
Breech E #118	N-1-26N-6W	Basin Dak.	W 320	W 321.51 ✓
State A#62	A-2-26N-6W	Blanco MV	N 320	N 323 ✓
State A#62	A-2-26N-6W	Basin Dak.	N 320	N 323 ✓
Breech E #58	A-3-26N-6W	Blanco MV	E 320	E 320.75 ✓
Breech E #58	A-3-26N-6W	Basin Dak.	E 320	E 320.75 ✓
Breech E #89	L-3-26N-6W	Basin Dak.	W 320	W 320.25 ✓
Breech E #54	A-4-26N-6W	Basin Dak.	E 320	E 319.97 ✓
Breech E #50	A-5-26N-6W	Basin Dak.	N 320	N 320.52 ✓
Breech B #123	B-7-26N-6W	Basin Dak.	N 320	N 321 ✓
Breech #312	N-18-26N-6W	So. Bl. PC	160	160.71 ✓