

<b>x</b>		

(SUBMIT IN TRIPLICATE)

UNITED STATES  
DEPARTMENT OF THE INTERIOR  
GEOLOGICAL SURVEY

Indian Agency \_\_\_\_\_  
Jicarilla  
Allottee \_\_\_\_\_  
Contr. #119  
Lease No. \_\_\_\_\_

SUNDRY NOTICES AND REPORTS ON WELLS

NOTICE OF INTENTION TO DRILL	<b>X</b>	SUBSEQUENT REPORT OF WATER SHUT-OFF
NOTICE OF INTENTION TO CHANGE PLANS		SUBSEQUENT REPORT OF SHOOTING OR ACIDIZING
NOTICE OF INTENTION TO TEST WATER SHUT-OFF		SUBSEQUENT REPORT OF ALTERING CASING
NOTICE OF INTENTION TO REDRILL OR REPAIR WELL		SUBSEQUENT REPORT OF REDRILLING OR REPAIR
NOTICE OF INTENTION TO SHOOT OR ACIDIZE		SUBSEQUENT REPORT OF ABANDONMENT
NOTICE OF INTENTION TO PULL OR ALTER CASING		SUPPLEMENTARY WELL HISTORY
NOTICE OF INTENTION TO ABANDON WELL		

(INDICATE ABOVE BY CHECK MARK NATURE OF REPORT, NOTICE, OR OTHER DATA)

September 18, 19 62

Well No. "N" 12-6 is located 1190 ft. from ~~33~~ line and 1190 ft. from ~~33~~ line of sec. 6

NW NW 6 26 N 4 W Rio Arriba New Mexico  
(1/4 Sec. and Sec. No.) (Twp.) (Range) (Meridian)  
Tapacite PC Rio Arriba New Mexico  
(Field) (County or Subdivision) (State or Territory)

The elevation of the ~~structure~~ ungr. grad. above sea level is 7218 ft.

DETAILS OF WORK

(State names of and expected depths to objective sands; show sizes, weights, and lengths of proposed casings; indicate mudlogging jobs, cementing points, and all other important proposed work)

Propose to drill 13 3/8" hole to 150', set 9 5/8" OD casing and cement to surface with 100 sx regular. Drill 7 7/8" hole to total depth of 4200', run 5" OD casing and cement with 150 sx regular. Perforate 5" casing opposite the Pictured Cliffs formation and sand-water treat. Run 1 1/4" OD tubing and complete. The NW/4 of Sec. 6, comprised of Lots 3, 4 & 5 and the SE/4 NW/4, a total of 165.00 acres, is dedicated to the well.

I understand that this plan of work must receive approval in writing by the Geological Survey before operations may be commenced.

Company NORTHWEST PRODUCTION CORP.  
Address 520 SIMMS BLDG.  
ALBUQUERQUE, N.M.  
By Ray Phillips  
Title Mgr., Production Operations

NEW MEXICO OIL CONSERVATION COMMISSION  
Well Location and Acreage Dedication Plat

Section A.

Date Sept. 18, 1962

Operator NORTHWEST PRODUCTION CO. Lease JICARILLA TRIBAL CONT. 119 BLOCK "N"  
Well No. N 12-6 Unit Letter D Section 6 Township 26 N Range 1 W NMPM  
Located 1190 Feet From north Line, 1190 Feet From west Line  
County Rio Arriba G. L. Elevation 7218 Dedicated Acreage 165.00 Acres  
Name of Producing Formation Pictured Cliffs Pool Tapacito

1. Is the Operator the only owner\* in the dedicated acreage outlined on the plat below?  
Yes X No       .
2. If the answer to question one is "no," have the interests of all the owners been consolidated by communitization agreement or otherwise? Yes        No       . If answer is "yes," Type of Consolidation
3. If the answer to question two is "no," list all the owners and their respective interests below:

Owner

Land Description

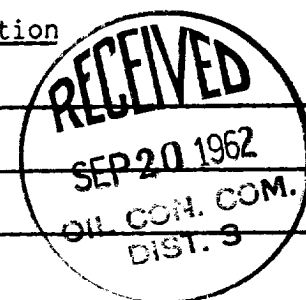

Section B

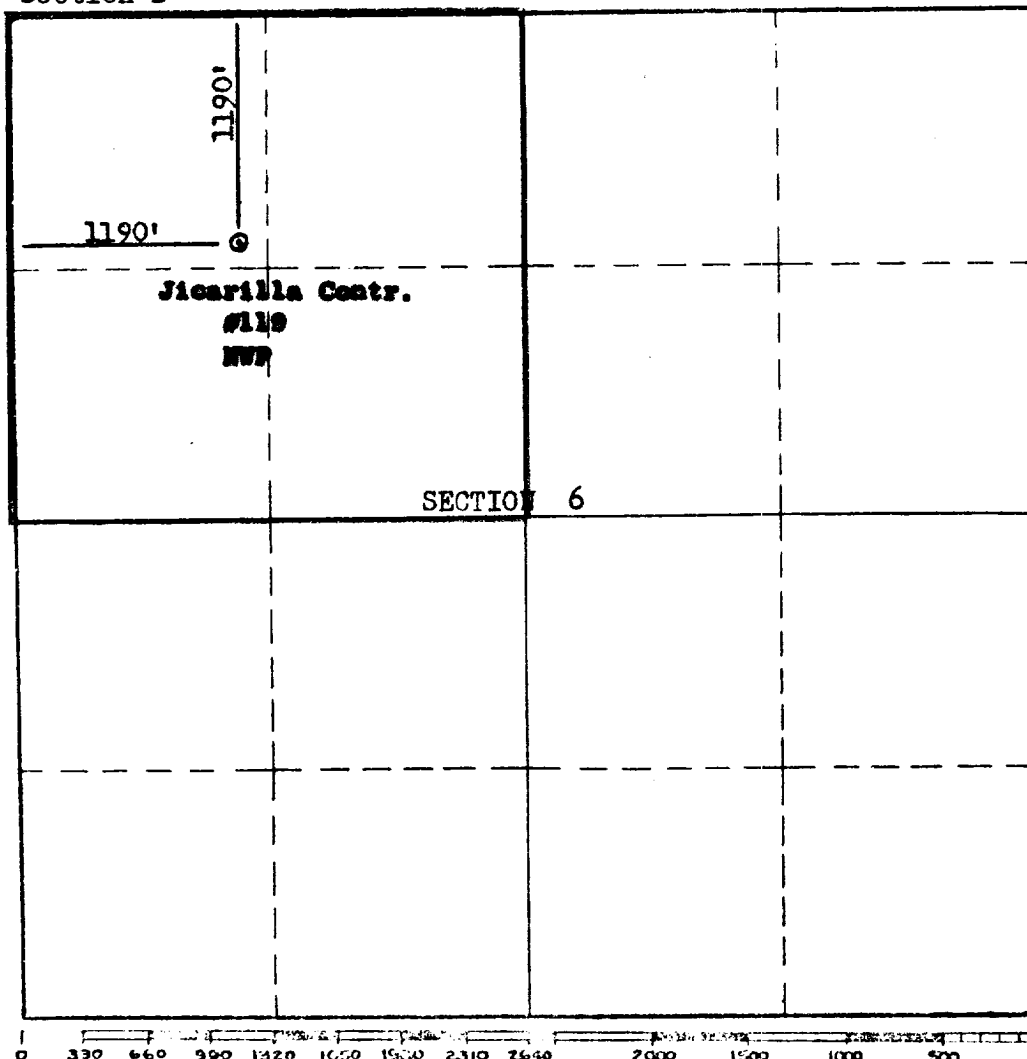

This is to certify that the information in Section A above is true and complete to the best of my knowledge and belief.

NORTHWEST PRODUCTION CORP.

(Operator)

Ray Phillips

(Representative)

830 Sims Bldg.  
Albuquerque, N.M.

Address

This is to certify that the well location shown on the plat in Section B was plotted from field notes of actual surveys made by me or under my supervision and that the same is true and correct to the best of my knowledge and belief.

Date Surveyed Sept. 16, 1962

Stephen H. Kinney  
STEPHEN H. KINNEY

Registered Professional  
Engineer and/or Land Surveyor.

Certificate No. 804