

Well Location and Acreage Dedication Plat

May 28, 1965
October 19, 1964

Section A.

Date

Operator TENNECO OIL COMPANY Lease Jicarilla (Cont. 110)
 Well No. A-2 Unit Letter B Section 18 Township 26 North Range 5 West NMPM
 Located 790' Feet From North Line, 1850 Feet From East Line
 County Rio Arriba G. L. Elevation 6678 ungraded Dedicated Acreage 80 Acres
 Name of Producing Formation Blanco-Tocito-Basta-Basta Pool Tocito ONLY

1. Is the Operator the only owner in the dedicated acreage outlined on the plat below?

Yes _____ No X2. If the answer to question one is "no", have the interests of all the owners been consolidated by communitization agreement or otherwise? Yes X No _____. If answer is "yes", Type of Consolidation.**Operating Agreement**

3. If the answer to question two is "no", list all the owners and their respective interests below:

OwnerLand Description

Section B.

Note: All distances must be from outer boundaries of section.

This is to certify that the information
 in Section A above is true and complete
 to the best of my knowledge and belief.

Tenneco Oil Company

(Operator)

(Representative) J. H. WatkinsP. O. Box 1714

(Address)

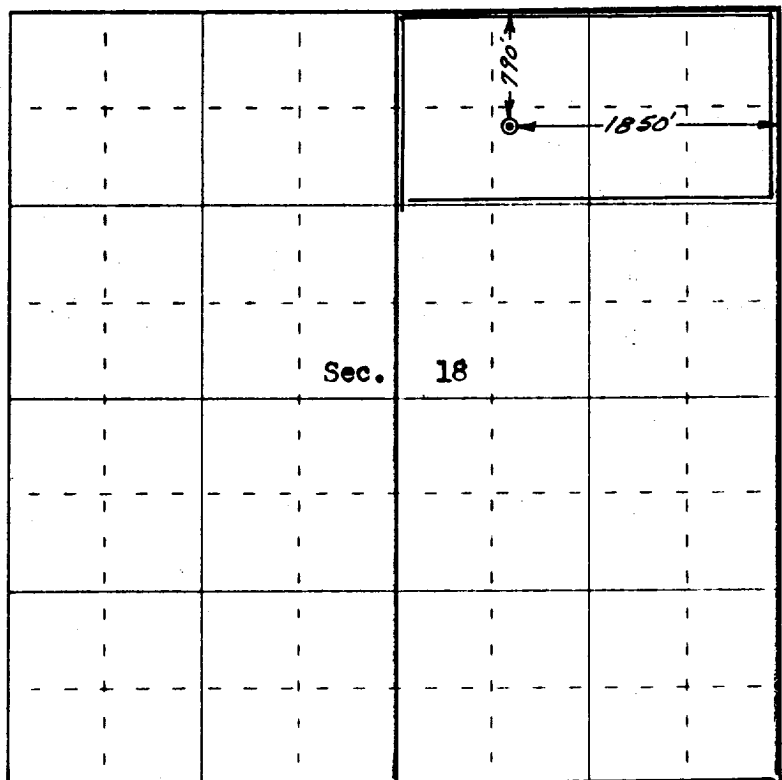
Durango, Colorado

Scale 4 inches equal 1 mile



ERNST ENGINEERING CO.
 Durango, Colorado

This is to certify that the above plat was prepared from field notes of actual surveys
 made by me or under my supervision and that the same are true and correct to the best
 of my knowledge and belief.

Date Surveyed 14 October 1964

Robert H. Ernst
 Registered Professional Engineer and/or Land Surveyor
 Robert H. Ernst, N. Mex. PE & LS 2463

