

State of New Mexico
Energy, Minerals and Natural Resources Dept.
DEPUTY OIL & GAS INSPECTOR
District II

P.O. Box 1980, Hobbs, NM 88221
JAN 27 1999

District III
1000 Rio Brazos Rd, Aztec,
NM 87410

OIL CONSERVATION DIVISION
2040 S. Pacheco
Santa Fe, New Mexico 87504

SUBMIT 1 COPY TO
APPROPRIATE
DISTRICT OFFICE
AND 1 COPY TO
SANTA FE OFFICE

PIT REMEDIATION AND CLOSURE REPORT

Operator: Caulkins Oil Company

Telephone: (505) 632-1544

Address: P.O. Box 340, Bloomfield, NM 87413

Facility or Well Name: Breech "A" 682

Location: Unit or Qtr/Qtr K Sec 10 T 26N R 6W County Rio Arriba

Pit Type: Separator X Dehydrator Other

Land Type: BLM X, State , Fee , Other

Pit Location: Pit dimensions: length 30', width 27', depth 12'
(Attach diagram)

References: wellhead X, other

Footage from reference: 75'

Direction from reference: 15 Degrees X East North X
of
 West South

Depth to Ground Water:	Less than 50 feet	(20 points)	
(Vertical distance from	50 feet to 99 feet	(10 points)	
contaminants to seasonal high	Greater than 100 feet	(0 points)	<u>0</u>
water elevation of ground water)			

Wellhead Protection Area:	Yes	(20 points)	
(Less than 200 feet from a	No	(0 points)	<u>0</u>
private domestic water source,			
or; less than 1000 feet from all			
other water sources)			

Distance to Surface Water:	Less than 200 feet	(20 points)	
(Horizontal distance to perennial	200 feet to 1000 feet	(10 points)	
lakes, ponds, rivers, streams,	Greater than 1000 feet	(0 points)	<u>0</u>
creeks, irrigation canals and			
ditches)			

RANKING SCORE (TOTAL POINTS): 0

Date Remediation Started: 5-5-97 Date Completed: 7-17-97

Remediation Method: Excavation X Approx. cubic yards 360
Check all appropriate sections) Landfarmed X Insitu Bioremediation ____
Other _____

Remediation Location: Onsite X Offsite _____
(ie. landfarmed onsite, name and location of offsite facility) _____

General Description of Remedial Action: Aeration and Dilution

Ground Water Encountered: No X Yes ____ Depth _____

Final Pit: Sample Location Bottom of pit and landfarm
Closure Sampling: _____
(if multiple samples, attach sample results and diagram of sample) Sample depth 14'
Sample date 8-26-97 Sample time 1:45 p.m.
Benzene (ppm) _____
Total BTEX (ppm) ND
Field headspace (ppm) _____
TPH Landfarm: 14 ppm Pit: 7.8 ppm

Ground Water Sample: Yes ____ No X (If yes, attach sample results)

I HEREBY CERTIFY THAT THE INFORMATION ABOVE IS TRUE AND COMPLETE TO THE BEST OF MY KNOWLEDGE AND BELIEF.

DATE October 6, 1998

SIGNATURE Robert L. Verquer PRINTED NAME AND TITLE ROBERT L. VERQUER, SUPERINTENDENT

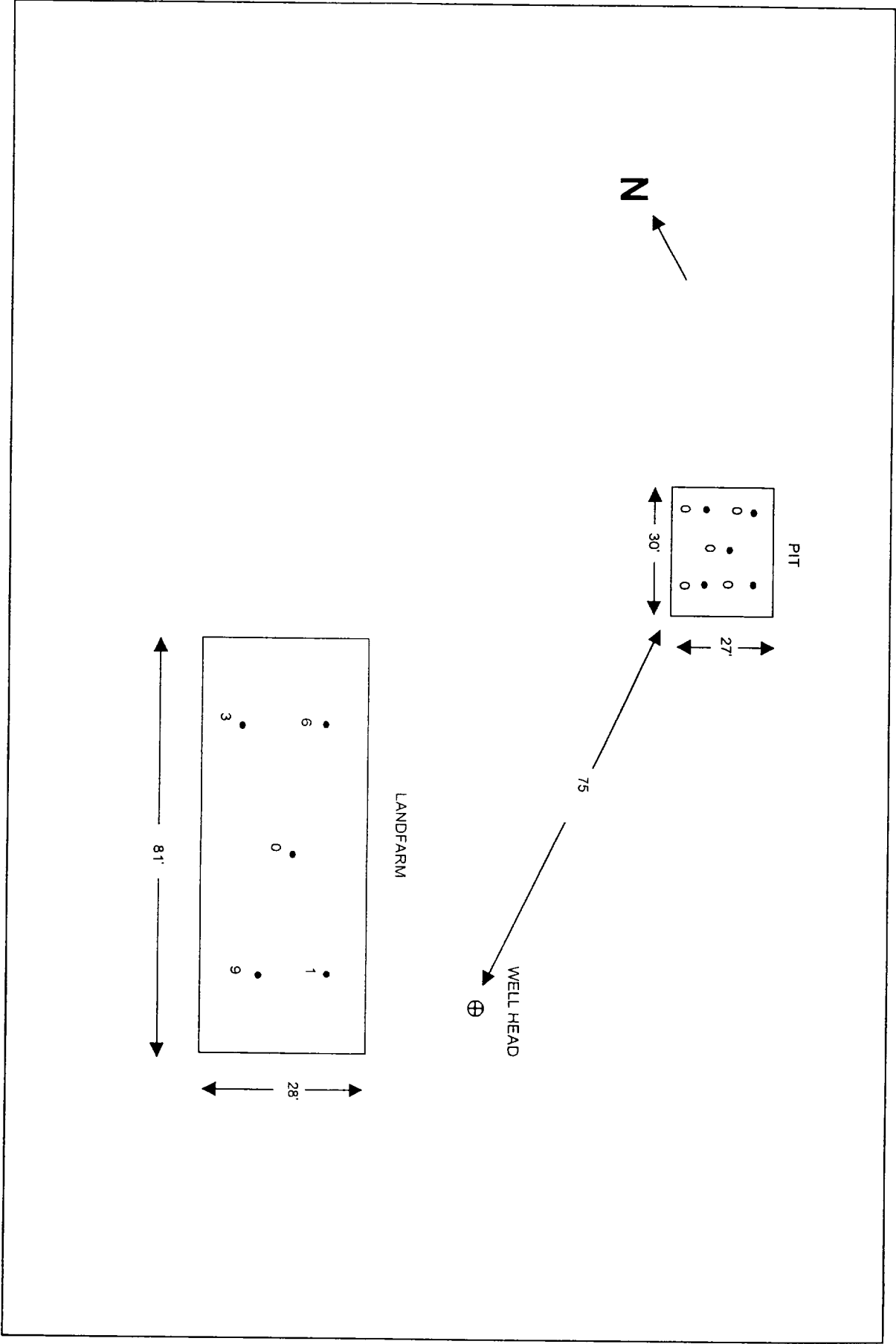



® Certificate of Analysis No. 9708147-12

FARMINGTON LABORATORY
P.O. BOX 1289
FARMINGTON, NEW MEXICO 87499-1289
PHONE (505) 326-2588

Caulkins Oil and Gas Co.
PO Box 340
Bloomfield, NM 87413
Attn: Bobby Verquer

Date: 09/08/97

Project: Landfarm
Site:
Sampled By: J. Waggoner
Sample ID: Breech A 682

Project No:
Matrix: Soil
Date Sampled: 08/26/97
Date Received: 08/27/97

Analytical Data

PARAMETER	RESULTS	DETECTION LIMIT	UNITS
Benzene	ND	10	µg/Kg
Toluene	ND	10	µg/Kg
Ethylbenzene	ND	10	µg/Kg
Total Xylene	ND	10	µg/Kg
Total Volatile Aromatic Hydrocarbons	ND		µg/Kg

Surrogate

% Recovery

1,4-Difluorobenzene
4-Bromofluorobenzene
Method 8020A
Analyzed by: JN
Date: 09/04/97

100
100

Total Petroleum Hydrocarbons-Diesel

14

4.0

mg/Kg

Surrogate

% Recovery

n-Pentacosane
Modified 8015A
Analyzed by: RR
Date: 09/03/97

102

Petroleum Hydrocarbons-Gasoline

ND

1.0

mg/Kg

Surrogate

% Recovery

1,4-Difluorobenzene
4-Bromofluorobenzene
Method 8020A
Analyzed by: JN
Date: 09/04/97

100
67

Test Methods for Evaluating Solid Waste, EPA SW846, 3rd Ed.

MI - Matrix Interference

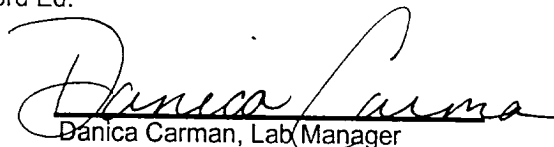
Danica Carman, Lab Manager



® Certificate of Analysis No. 9708147-11

FARMINGTON LABORATORY
P.O. BOX 1289
FARMINGTON, NEW MEXICO 87499-1289
PHONE (505) 326-2588

Caulkins Oil and Gas Co.
PO Box 340
Bloomfield, NM 87413
Attn: Bobby Verquer

Date: 09/08/97

Project: Pit
Site:
Sampled By: J. Waggoner
Sample ID: Breech A 682

Project No:
Matrix: Soil
Date Sampled: 08/26/97
Date Received: 08/27/97

Analytical Data

PARAMETER	RESULTS	DETECTION LIMIT	UNITS
Benzene	ND	10	µg/Kg
Toluene	ND	10	µg/Kg
Ethylbenzene	ND	10	µg/Kg
Total Xylene	ND	10	µg/Kg
Total Volatile Aromatic Hydrocarbons	ND		µg/Kg

Surrogate

% Recovery

1,4-Difluorobenzene
4-Bromofluorobenzene

100
103

Method 8020A

Analyzed by: JN

Date: 09/04/97

Total Petroleum Hydrocarbons-Diesel

7.8

4.0

mg/Kg

Surrogate

% Recovery

n-Pentacosane
Modified 8015A
Analyzed by: RR
Date: 09/03/97

108

Petroleum Hydrocarbons-Gasoline

ND

1.0

mg/Kg

Surrogate

% Recovery

1,4-Difluorobenzene
4-Bromofluorobenzene
Method 8020A
Analyzed by: JN
Date: 09/04/97

100
70

Test Methods for Evaluating Solid Waste, EPA SW846, 3rd Ed.

MI - Matrix Interference

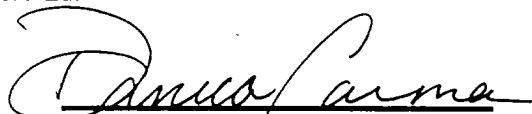
Danica Carman, Lab Manager

WELL NAME: Breech A 682

CAULKINS OIL
SITE SECURITY DIAGRAM

