

NO. OF COPIES RECEIVED	6
DISTRIBUTION	
SANTA FE	1
FILE	1
U.S.G.S.	2
LAND OFFICE	1
OPERATOR	1

NEW MEXICO OIL CONSERVATION COMMISSION

Form C-101
Revised 1-1-65

039
44
30-281-20055

APPLICATION FOR PERMIT TO DRILL, DEEPEN, OR PLUG BACK

1a. Type of Work DRILL <input checked="" type="checkbox"/> DEEPEN <input type="checkbox"/> PLUG BACK <input type="checkbox"/>		7. Unit Agreement Name	
b. Type of Well OIL WELL <input type="checkbox"/> GAS WELL <input checked="" type="checkbox"/> OTHER <input type="checkbox"/> SINGLE ZONE <input checked="" type="checkbox"/> MULTIPLE ZONE <input type="checkbox"/>		8. Farm or Lease Name Skelly	
2. Name of Operator Perry and Faust Drilling Co.		9. Well No. 1	
3. Address of Operator 201 Petroleum Plaza Building		10. Field and Pool, or Wildcat Otero Chacra	
4. Location of Well UNIT LETTER E LOCATED 790 FEET FROM THE West LINE AND 1650 FEET FROM THE North LINE OF SEC. 35 TWP. 26N RGE. 6W NMPM		12. County Rio Arriba	
19. Proposed Depth 3800		19A. Formation Chacra	
20. Rotary or C.T. Rotary		21. Elevations (Show whether DF, RT, etc.) 6258 Ground	
21A. Kind & Status Plug. Bond \$10,000.00		21B. Drilling Contractor Perry & Faust	
22. Approx. Date Work will start May 10, 1967			

PROPOSED CASING AND CEMENT PROGRAM

SIZE OF HOLE	SIZE OF CASING	WEIGHT PER FOOT	SETTING DEPTH	SACKS OF CEMENT	EST. TOP
12"	8 5/8"	32#	100'	75	Circulated
6 3/4"	4 1/2"	9.5#	3700'	300	2200'

Cement 8 5/8 in. casing at 100 feet with 75 sack with Cable Tools. Move in rotary tools. Install BOP. Pressure test casing to 500 psi. Drill 6 3/4 in. hole to 100 feet below Chacra with mud. Run electric log. Cement 4 1/2 in. casing through Chacra at estimated total depth of 3700 feet with 300 sacks. Perforate opposite Chacra sand, sand-water fracture, run 1 1/4 in. tubing, test and complete.



APPROVAL VALID
FOR 90 DAYS UNLESS
DRILLING COMMENCED,

EXPIRES Sept. 28, 1967

IN ABOVE SPACE DESCRIBE PROPOSED PROGRAM: IF PROPOSAL IS TO DEEPEN OR PLUG BACK, GIVE DATA ON PRESENT PRODUCTIVE ZONE AND PROPOSED NEW PRODUCTIVE ZONE. GIVE BLOWOUT PREVENTER PROGRAM, IF ANY.

I hereby certify that the information above is true and complete to the best of my knowledge and belief.

Signed Leland Perry Title Partner Date May 8, 1967
(This space for State Use)

APPROVED BY Ernest Chavez TITLE Sup Dist III DATE 6-30-67
CONDITIONS OF APPROVAL, IF ANY:

**NEW MEXICO OIL CONSERVATION COMMISSION
WELL LOCATION AND ACERAGE DEDICATION PLAT**

All distances must be from the outer boundaries of the Section

Operator Perry & Faast Drilling Company			Lease SKELLY		Well No. 1
Unit Letter E	Section 35	Township 26 North	Range 6 West	County Rio Arriba	
Actual Footage Location of Well: 1850 feet from the North line and 790 feet from the West line					
Ground Level Elev. 6288	Producing Formation CHACRA		Pool OTERO	Dedicated Acreage: 160 Acres	

1. Outline the acreage dedicated to the subject well by colored pencil or hachure marks on the plat below.
2. If more than one lease is dedicated to the well, outline each and identify the ownership thereof (both as to working interest and royalty),
3. If more than one lease of different ownership is dedicated to the well, have the interests of all owners been consolidated by communitization, unitization, force-pooling, etc?

() Yes () No If answer is "yes," type of consolidation

If answer is "no," list the owners and tract descriptions which have actually consolidated. (Use reverse side of this form if necessary.)

No allowable will be assigned to the well until all interests have been consolidated (by communitization, unitization, forced-pooling, or otherwise) or until a non standard unit, eliminating such interests, has been approved by the Commission.

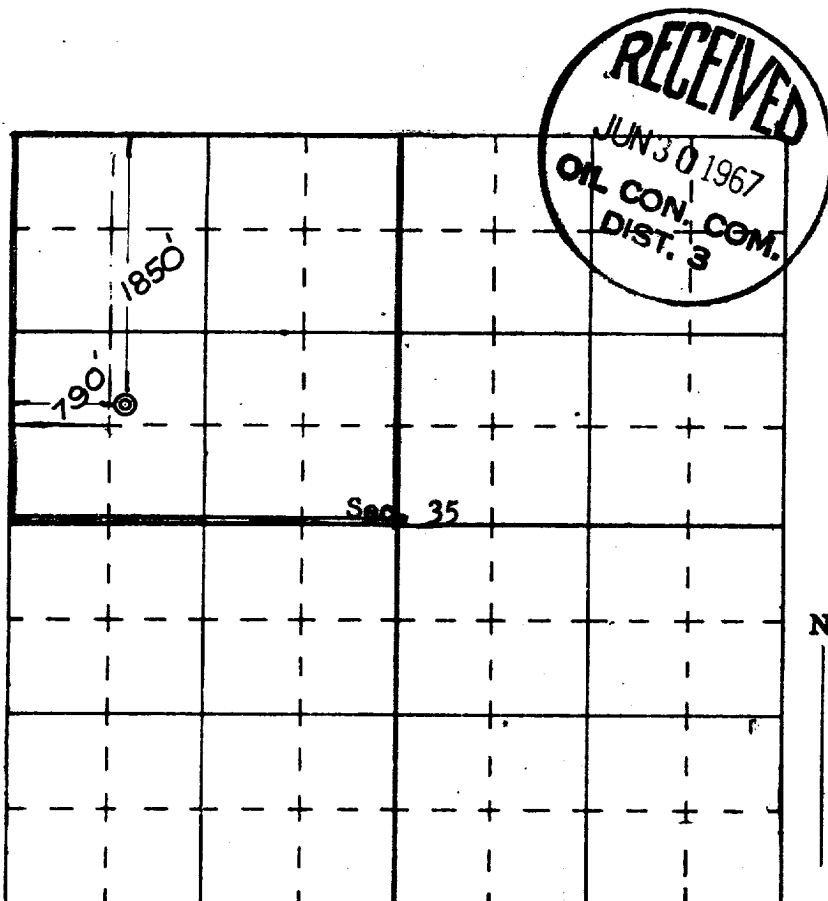

CERTIFICATION

I hereby certify that the information contained herein is true and complete to the best of my knowledge and belief.

Name JJ Ray
 Position Agent
 Company Perry & Faast Drilling Co
 Date 6-28-67

I hereby certify that the well location shown on this plat was obtained from field notes of actual surveys made by me or under my supervision, and that the same is true and correct to the best of my knowledge and belief.

Date Surveyed March 7, 1967
 Registered Professional Engineer
 and/or Land Surveyor

E. J. C. [Signature]
 Certificate No. **3602**

