

UNITED STATES  
DEPARTMENT OF THE INTERIOR  
GEOLOGICAL SURVEY

30-039-20508

5. LEASE DESIGNATION AND SERIAL NO.

SF 079266

6. IF INDIAN, ALLOTTEE OR TRIBE NAME

7. UNIT AGREEMENT NAME

8. FARM OR LEASE NAME

Vaughn

9. WELL NO.

22

10. FIELD AND POOL, OR WILDCAT

Otero Chacra

11. SEC., T., E., M., OR BLK.  
AND SURVEY OR AREA

Sec. 29, T-26-N, R-6-W  
NMPM

12. COUNTY OR PARISH 13. STATE

Rio Arriba New Mexico

APPLICATION FOR PERMIT TO DRILL, DEEPEN, OR PLUG BACK

1a. TYPE OF WORK

DRILL ☒

DEEPEN ☐

PLUG BACK ☐

b. TYPE OF WELL

OIL  
WELL ☐

GAS  
WELL ☒

OTHER

SINGLE  
ZONE ☐

MULTIPLE  
ZONE ☐

2. NAME OF OPERATOR

El Paso Natural Gas Co.

3. ADDRESS OF OPERATOR

PO Box 990, Farmington, NM 87401

4. LOCATION OF WELL (Report location clearly and in accordance with any State requirements.)\*

At surface

1550'N, 1740'E

At proposed prod. zone

14. DISTANCE IN MILES AND DIRECTION FROM NEAREST TOWN OR POST OFFICE\*

15. DISTANCE FROM PROPOSED\*

LOCATION TO NEAREST  
PROPERTY OR LEASE LINE, FT.  
(Also to nearest drilg. unit line, if any)

16. NO. OF ACRES IN LEASE

17. NO. OF ACRES ASSIGNED  
TO THIS WELL

160.00

18. DISTANCE FROM PROPOSED LOCATION\*  
TO NEAREST WELL, DRILLING, COMPLETED,  
OR APPLIED FOR, ON THIS LEASE, FT.

19. PROPOSED DEPTH

3993'

20. ROTARY OR CABLE TOOLS

Rotary

21. ELEVATIONS (Show whether DF, RT, GR, etc.)

22. APPROX. DATE WORK WILL START?

23.

PROPOSED CASING AND CEMENTING PROGRAM

SIZE OF HOLE	SIZE OF CASING	WEIGHT PER FOOT	SETTING DEPTH	QUANTITY OF CEMENT
12 1/4"	8 5/8"	24.0#	130'	107 cu. ft. to circulate
6 3/4"	2 7/8"	6.4#	3993'	529 cu. ft. to cover Ojo Alamo

Selectively perforate and sand-water fracture the Chacra formation.

The NE/4 Section 29 is dedicated to this well.



IN ABOVE SPACE DESCRIBE PROPOSED PROGRAM: If proposal is to deepen or plug back, give data on present productive zone and proposed new productive zone. If proposal is to drill or deepen directionally, give pertinent data on subsurface locations and measured and true vertical depths. Give blowout preventer program, if any.

24.

SIGNED

*EH Wood*

TITLE

Petroleum Engineer

DATE June 5, 1972

(This space for Federal or State office use)

PERMIT NO.

APPROVAL DATE

APPROVED BY

TITLE

DATE

CONDITIONS OF APPROVAL, IF ANY:

*OKed*

NEW MEXICO OIL CONSERVATION COMMISSION  
WELL LOCATION AND ACREAGE DEDICATION PLAT

Form C-102  
Supersedes C-128  
Effective 1-1-66

All distances must be from the outer boundaries of the Section

Operator <b>EL PASO NATURAL GAS COMPANY</b>		Lease <b>VAUGHN (SF-079266)</b>		Well No. <b>22</b>
Unit Letter <b>G</b>	Section <b>29</b>	Township <b>26-N</b>	Range <b>6-W</b>	County <b>RIO ARriba</b>
Actual Footage Location of Well: <b>1550</b> feet from the <b>NORTH</b> line and <b>1740</b> feet from the <b>EAST</b> line.				
Initial Level Elev. <b>6733</b>	Producing Formation <b>CHACRA</b>	Pool <b>OTERO CHACRA</b>	Consolidated Acreage: <b>160.00</b>	

1. Outline the acreage dedicated to the subject well by colored pencil or hachure marks on the plat below.
2. If more than one lease is dedicated to the well, outline each and identify the ownership thereof (but not a working interest and royalty).
3. If more than one lease of different ownership is dedicated to the well, have the interests of all owners been consolidated by communitization, unitization, force-pooling, etc?

☐ Yes ☐ No If answer is "yes" type of consolidation \_\_\_\_\_

If answer is "no," list the owners and tract descriptions which have actually been consolidated. (Use reverse side of this form if necessary.) \_\_\_\_\_

No allowable will be assigned to the well until all interests have been consolidated (by communitization, unitization, forced-pooling, or otherwise) or until a non-standard unit, eliminating such interests, has been approved by the Commission.

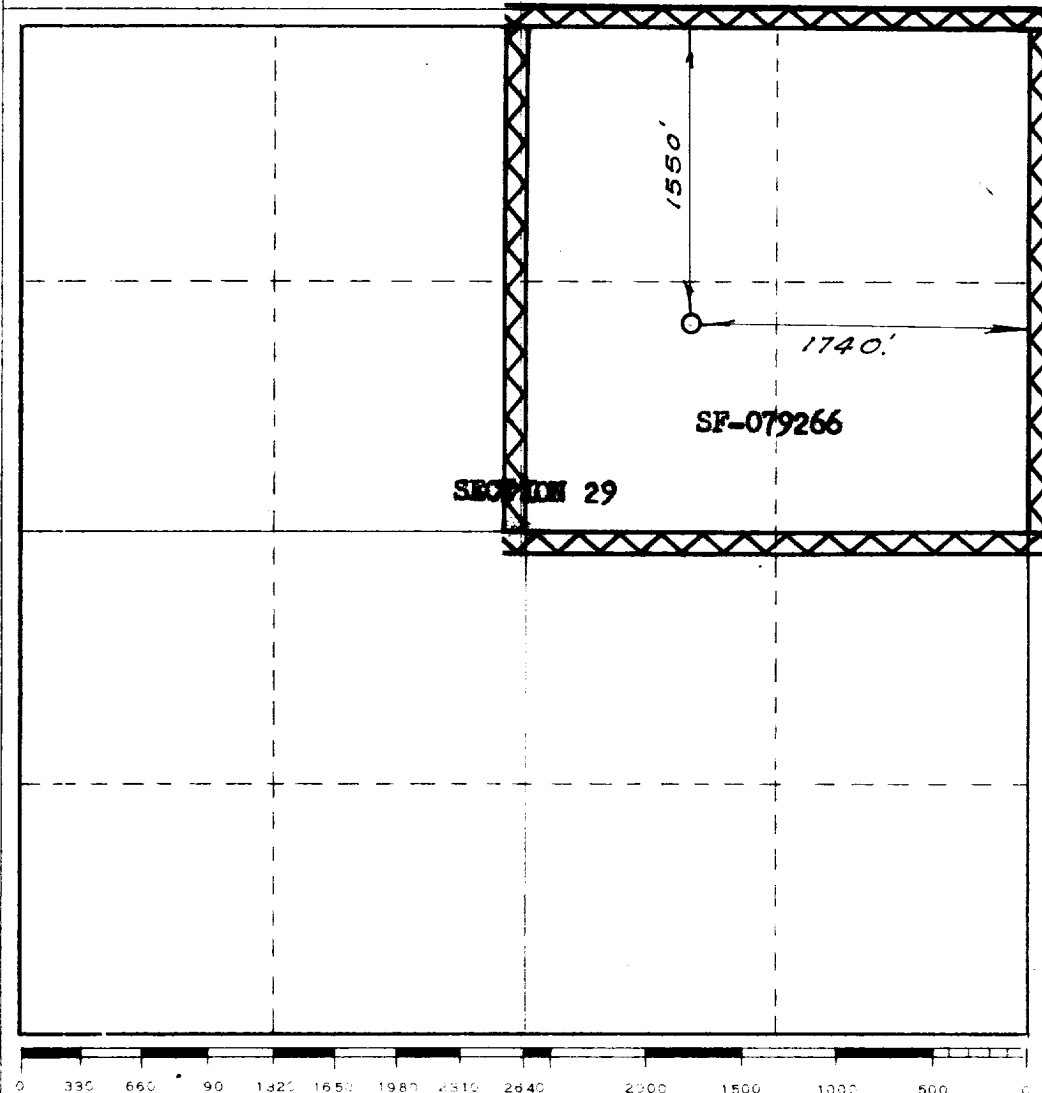
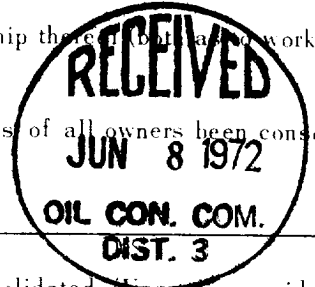

CERTIFICATION

I hereby certify that the information contained herein is true and complete to the best of my knowledge and belief.

Original Signed F. H. WOOD

Name

Petroleum Engineer

Position

El Paso Natural Gas Co.

Company

June 5, 1972

Date

I hereby certify that the well location shown on this plat was plotted from field notes of actual surveys made by me or under my supervision, and that the same is true and correct to the best of my knowledge and belief.

Date Surveyed

APRIL 3, 1972

Registered Professional Engineer and Oil Well Surveyor

*[Signature]*

Certification No.

1760

EXISTING AND PROPOSED ROADS AND PIPELINE RIGHTS-OF-WAY

Vaughn #22

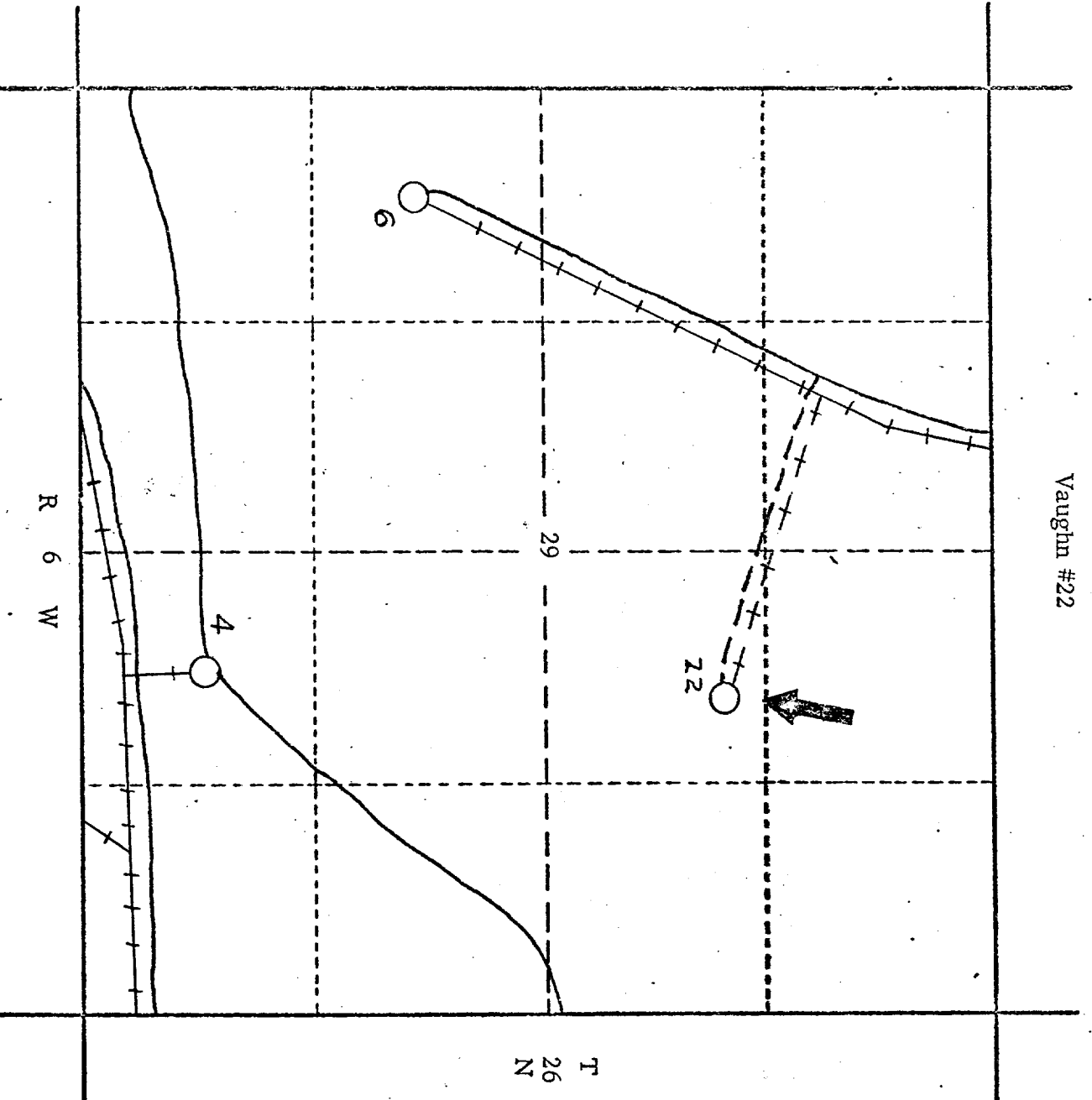

Existing Road  
Proposed Road  
Existing Right-of-Way  
Proposed Right-of-Way

# LOCATION AND EQUIPMENT LAY-OUT

Vaughn #22

