

UNITED STATES  
DEPARTMENT OF THE INTERIOR  
GEOLOGICAL SURVEY

30-039-20556

5. LEASE DESIGNATION AND SERIAL NO.

SF-079186

6. IF INDIAN, ALLOTTEE OR TRIBE NAME

--

7. UNIT AGREEMENT NAME

--

8. FARM OR LEASE NAME

Federal

9. WELL NO.

19

10. FIELD AND POOL, OR WILDCAT

South Blanco Pictured Cliff

11. SEC., T., R., M., OR BLK.  
AND SURVEY OR AREA

Sec. 1-26N-6W

12. COUNTY OR PARISH

13. STATE

Rio Arriba

New Mexico

## APPLICATION FOR PERMIT TO DRILL, DEEPEN, OR PLUG BACK

1a. TYPE OF WORK

DRILL ☒DEEPEN ☐PLUG BACK ☐

b. TYPE OF WELL

OIL  
WELL ☐GAS  
WELL ☒

OTHER

SINGLE  
ZONE ☒MULTIPLE  
ZONE ☐

2. NAME OF OPERATOR

Pubco Petroleum Corporation

3. ADDRESS OF OPERATOR

P. O. Box 869, Albuquerque, New Mexico

4. LOCATION OF WELL (Report location clearly and in accordance with any State requirements.)

At surface

350' FWL &amp; 990' FNL Section 1-26N-6W

At proposed prod. zone

Same as above

14. DISTANCE IN MILES AND DIRECTION FROM NEAREST TOWN OR POST OFFICE\*

35 miles southeast of Bloomfield

15. DISTANCE FROM PROPOSED\*

LOCATION TO NEAREST  
PROPERTY OR LEASE LINE, FT.  
(Also to nearest drlg. unit line, if any)

350'

16. NO. OF ACRES IN LEASE

2563.40

17. NO. OF ACRES ASSIGNED  
TO THIS WELL

161.51

18. DISTANCE FROM PROPOSED LOCATION\*  
TO NEAREST WELL, DRILLING, COMPLETED,  
OR APPLIED FOR, ON THIS LEASE, FT.

19. PROPOSED DEPTH

3450' +

20. ROTARY OR CABLE TOOLS

Rotary

21. ELEVATIONS (Show whether DF, RT, GR, etc.)

6745' GL

22. APPROX. DATE WORK WILL START\*

September 1, 1972

23.

## PROPOSED CASING AND CEMENTING PROGRAM

SIZE OF HOLE	SIZE OF CASING	WEIGHT PER FOOT	SETTING DEPTH	QUANTITY OF CEMENT
12-1/4"	7-5/8"	24#	130' +	100 sxs.
6-3/4"	3-1/2"	7.7#	3450' +	350 sxs.

1. Drill 12" or 12-1/4" hole, set 7-5/8" (or larger) casing at 130'±, cement to surface with approx. 100 sxs. Class "A" with 2% Calcium Chloride. WOC 18 hrs., test casing to 1000 psi for 30".
2. Drill 6-3/4" hole to approx. 3450', run Gammaray-Density Log and Induction Electric Log.
3. Run approx. 3450' of 3-1/2", 7.7#, H-40 casing, cement with 250 sxs. of 65-35 poz. 10% Gel, plus 100 sxs. Class "C" neat.
4. Pressure test casing to 3500 psi, WOC 48+ hours.
5. Perforate pay sands, fracture with 30,000-50,000 gals. Sand-water frac as need is indicated.
6. Run 1-1/4" unloader tubing string; flow to clean up; potential test.
7. Pipe rams will be tested each tour; blind rams each trip.

IN ABOVE SPACE DESCRIBE PROPOSED PROGRAM: If proposal is to deepen or plug back, give data on present productive zone and proposed new productive zone. If proposal is to drill or deepen directionally, give pertinent data on subsurface locations and measured and true vertical depths. Give blowout preventer program, if any.

24. Charles W. Sanders TITLE Area Production Manager DATE August 18, 1972  
SIGNED Charles W. Sanders  
(This space for Federal or State office use)

PERMIT NO. \_\_\_\_\_ APPROVAL DATE \_\_\_\_\_

APPROVED BY SA TITLE \_\_\_\_\_ DATE \_\_\_\_\_  
CONDITIONS OF APPROVAL, IF ANY:Handl. 0.104 for NSC

\*See Instructions On Reverse Side

NEW MEXICO OIL CONSERVATION COMMISSION  
WELL LOCATION AND ACREAGE DEDICATION PLAT

Form O-162  
Supersedes O-128  
Effective 1-1-65

All distances must be from the outer boundaries of the Section.

Operator PURCO PETROLEUM CO.			Lease FEDERAL			Well No. 12		
Unit Letter D	Section 1	Township 26 N	Range 6 W	County RIO ARriba				
Actual Footage Location of Well: 990 feet from the north line and 350 feet from the west line								
Ground Level Elev. 6745	Producing Formation Pictured Cliff		Pool South Blanco		Dedicated Acreage 161.51 (161.51) Acres			

1. Outline the acreage dedicated to the subject well by colored pencil or hatchure marks on the plat below.
2. If more than one lease is dedicated to the well, outline each and identify the ownership thereof (both as to working interest and royalty).
3. If more than one lease of different ownership is dedicated to the well, have the interests of all owners been consolidated by communitization, unitization, force-pooling, etc?

☐ Yes ☐ No If answer is "yes," type of consolidation NA

If answer is "no," list the owners and tract descriptions which have actually been consolidated. (Use reverse side of this form if necessary.) NA

No allowable will be assigned to the well until all interests have been consolidated (by communitization, unitization, forced-pooling, or otherwise) or until a non-standard unit, eliminating such interests, has been approved by the Commission.

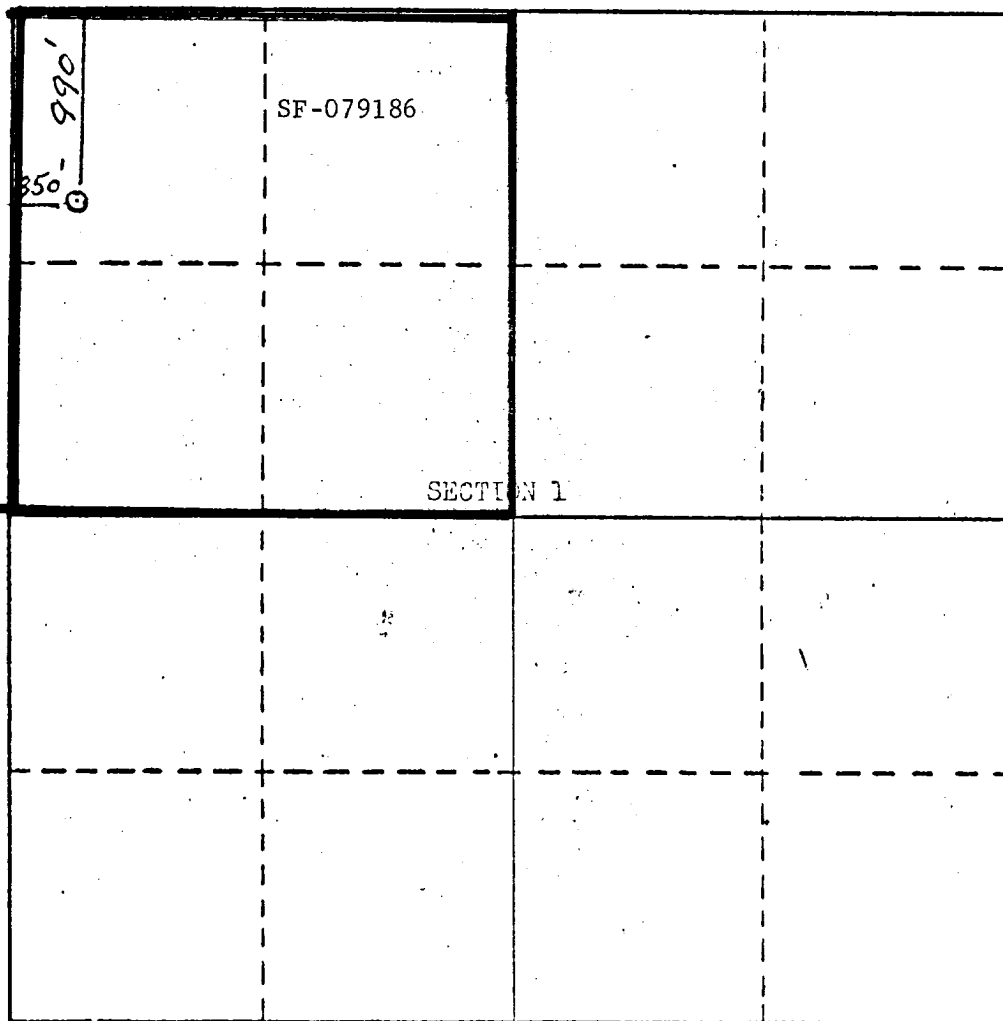

CERTIFICATION

I hereby certify that the information contained herein is true and complete to the best of my knowledge and belief.

*Charles W. Sanders*  
Name

Charles W. Sanders

Position

Area Production Manager

Company

Pubco Petroleum Corporation

Date

August 18, 1972

I hereby certify that the well location shown on this plat was plotted from field notes of actual surveys made by me or under my supervision, and that the same is true and correct to the best of my knowledge and belief.

Date Surveyed

August 16, 1972

Registered Professional Engineer and/or Land Surveyor

*Stephen H. Kinney*  
Stephen H. Kinney

Certificate No.

N. A. 803

0 220 440 660 880 1100 1320 1540 1760 1980 2200 2420 2640 2860 3080 3300 3520 3740 3960 4180 4400 4620 4840 5060 5280 5500 5720 5940 6160 6380 6600 6820 7040 7260 7480 7700 7920 8140 8360 8580 8800 9020 9240 9460 9680 9900 10120 10340 10560 10780 11000 11220 11440 11660 11880 12100 12320 12540 12760 12980 13200 13420 13640 13860 14080 14300 14520 14740 14960 15180 15400 15620 15840 16060 16280 16500 16720 16940 17160 17380 17600 17820 18040 18260 18480 18700 18920 19140 19360 19580 19800 20020 20240 20460 20680 20900 21120 21340 21560 21780 22000 22220 22440 22660 22880 23100 23320 23540 23760 23980 24200 24420 24640 24860 25080 25300 25520 25740 25960 26180 26400 26620 26840 27060 27280 27500 27720 27940 28160 28380 28600 28820 29040 29260 29480 29700 29920 30140 30360 30580 30800 31020 31240 31460 31680 31900 32120 32340 32560 32780 33000 33220 33440 33660 33880 34100 34320 34540 34760 34980 35200 35420 35640 35860 36080 36300 36520 36740 36960 37180 37400 37620 37840 38060 38280 38500 38720 38940 39160 39380 39600 39820 40040 40260 40480 40700 40920 41140 41360 41580 41800 42020 42240 42460 42680 42900 43120 43340 43560 43780 44000 44220 44440 44660 44880 45100 45320 45540 45760 45980 46200 46420 46640 46860 47080 47300 47520 47740 47960 48180 48400 48620 48840 49060 49280 49500 49720 49940 50160 50380 50600 50820 51040 51260 51480 51700 51920 52140 52360 52580 52800 53020 53240 53460 53680 53900 54120 54340 54560 54780 55000 55220 55440 55660 55880 56100 56320 56540 56760 56980 57200 57420 57640 57860 58080 58300 58520 58740 58960 59180 59400 59620 59840 60060 60280 60500 60720 60940 61160 61380 61600 61820 62040 62260 62480 62700 62920 63140 63360 63580 63800 64020 64240 64460 64680 64900 65120 65340 65560 65780 66000 66220 66440 66660 66880 67100 67320 67540 67760 67980 68200 68420 68640 68860 69080 69300 69520 69740 69960 70180 70400 70620 70840 71060 71280 71500 71720 71940 72160 72380 72600 72820 73040 73260 73480 73700 73920 74140 74360 74580 74800 75020 75240 75460 75680 75900 76120 76340 76560 76780 77000 77220 77440 77660 77880 78100 78320 78540 78760 78980 79200 79420 79640 79860 80080 80300 80520 80740 80960 81180 81400 81620 81840 82060 82280 82500 82720 82940 83160 83380 83600 83820 84040 84260 84480 84700 84920 85140 85360 85580 85800 86020 86240 86460 86680 86900 87120 87340 87560 87780 88000 88220 88440 88660 88880 89100 89320 89540 89760 89980 90200 90420 90640 90860 91080 91300 91520 91740 91960 92180 92400 92620 92840 93060 93280 93500 93720 93940 94160 94380 94600 94820 95040 95260 95480 95700 95920 96140 96360 96580 96800 97020 97240 97460 97680 97900 98120 98340 98560 98780 99000 99220 99440 99660 99880 100100 100320 100540 100760 100980 101200 101420 101640 101860 102080 102300 102520 102740 102960 103180 103400 103620 103840 104060 104280 104500 104720 104940 105160 105380 105600 105820 106040 106260 106480 106700 106920 107140 107360 107580 107800 108020 108240 108460 108680 108900 109120 109340 109560 109780 110000 110220 110440 110660 110880 111100 111320 111540 111760 111980 112200 112420 112640 112860 113080 113300 113520 113740 113960 114180 114400 114620 114840 115060 115280 115500 115720 115940 116160 116380 116600 116820 117040 117260 117480 117700 117920 118140 118360 118580 118800 119020 119240 119460 119680 119900 120120 120340 120560 120780 121000 121220 121440 121660 121880 122100 122320 122540 122760 122980 123200 123420 123640 123860 124080 124300 124520 124740 124960 125180 125400 125620 125840 126060 126280 126500 126720 126940 127160 127380 127600 127820 128040 128260 128480 128700 128920 129140 129360 129580 129800 130020 130240 130460 130680 130900 131120 131340 131560 131780 132000 132220 132440 132660 132880 133100 133320 133540 133760 133980 134200 134420 134640 134860 135080 135300 135520 135740 135960 136180 136400 136620 136840 137060 137280 137500 137720 137940 138160 138380 138600 138820 139040 139260 139480 139700 139920 140140 140360 140580 140800 141020 141240 141460 141680 141900 142120 142340 142560 142780 143000 143220 143440 143660 143880 144100 144320 144540 144760 144980 145200 145420 145640 145860 146080 146300 146520 146740 146960 147180 147400 147620 147840 148060 148280 148500 148720 148940 149160 149380 149600 149820 150040 150260 150480 150700 150920 151140 151360 151580 151800 152020 152240 152460 152680 152900 153120 153340 153560 153780 154000 154220 154440 154660 154880 155100 155320 155540 155760 155980 156200 156420 156640 156860 157080 157300 157520 157740 157960 158180 158400 158620 158840 159060 159280 159500 159720 159940 160160 160380 160600 160820 161040 161260 161480 161700 161920 162140 162360 162580 162800 163020 163240 163460 163680 163900 164120 164340 164560 164780 165000 165220 165440 165660 165880 166100 166320 166540 166760 166980 167200 167420 167640 167860 168080 168300 168520 168740 168960 169180 169400 169620 169840 170060 170280 170500 170720 170940 171160 171380 171600 171820 172040 172260 172480 172700 172920 173140 173360 173580 173800 174020 174240 174460 174680 174900 175120 175340 175560 175780 176000 176220 176440 176660 176880 177100 177320 177540 177760 177980 178200 178420 178640 178860 179080 179300 179520 179740 179960 180180 180400 180620 180840 181060 181280 181500 181720 181940 182160 182380 182600 182820 183040 183260 183480 183700 183920 184140 184360 184580 184800 185020 185240 185460 185680 185900 186120 186340 186560 186780 187000 187220 187440 187660 187880 188100 188320 188540 188760 188980 189200 189420 189640 189860 190080 190300 190520 190740 190960 191180 191400 191620 191840 192060 192280 192500 192720 192940 193160 193380 193600 193820 194040 194260 194480 194700 194920 195140 195360 195580 195800 196020 196240 196460 196680 196900 197120 197340 197560 197780 198000 198220 198440 198660 198880 199100 199320 199540 199760 199980 200200 200420 200640 200860 201080 201300 201520 201740 201960 202180 202400 202620 202840 203060 203280 203500 203720 203940 204160 204380 204600 204820 205040 205260 205480 205700 205920 206140 206360 206580 206800 207020 207240 207460 207680 207900 208120 208340 208560 208780 209000 209220 209440 209660 209880 210100 210320 210540 210760 210980 211200 211420 211640 211860 212080 212300 212520 212740 212960 213180 213400 213620 213840 214060 214280 214500 214720 214940 215160 215380 215600 215820 216040 216260 216480 216700 216920 217140 217360 217580 217800 218020 218240 218460 218680 218900 219120 219340 219560 219780 220000 220220 220440 220660 220880 221100 221320 221540 221760 221980 222200 222420 222640 222860 223080 223300 223520 223740 223960 224180 224400 224620 224840 225060 225280 225500 225720 225940 226160 226380 226600 226820 227040 227260 227480 227700 227920 228140 228360 228580 228800 229020 229240 229460 229680 229900 230120 230340 230560 230780 231000 231220 231440 231660 231880 232100 232320 232540 232760 232980 233200 233420 233640 233860 234080 234300 234520 234740 234960 235180 235400 235620 235840 236060 236280 236500 236720 236940 237160 237380 237600 237820 238040 238260 238480 238700 238920 239140 239360 239580 239800 240020 240240 240460 240680 240900 241120 241340 241560 241780 242000 242220 242440 242660 242880 243100 243320 243540 243760 243980 244200 244420 244640 244860 245080 245300 245520 245740 245960 246180 246400 246620 246840 247060 247280 247500 247720 247940 248160 248380 248600 248820 249040 249260 249480 249700 249920 250140 250360 250580 250800 251020 251240 251460 251680 251900 252120 252340 252560 252780 253000 253220 253440 253660 253880 254100 254320 254540 254760 254980 255200 255420 255640 255860 256080 256300 256520 256740 256960 257180 257400 257620 257840 258060 258280 258500 258720 258940 259160 259380 259600 259820 260040 260260 260480 260700 260920 261140 261360 261580 261800 262020 262240 262460 262680 262900 263120 263340 263560 263780 264000 264220 264440 264660 264880 265100 265320 265540 265760 265980 266200 266420 266640 266860 267080 267300 267520 267740 267960 268180 268400 268620 268840 269060 269280 269500 269720 269940 270160 270380 270600 270820 271040 271260 271480 271700 271920 272140 272360 272580 272800 273020 273240 273460 273680 273900 274120 274340 274560 274780 275000 275220 275440 275660 275880 276100 276320 276540 276760 276980 277200 277420 277640 277860 278080 278300 278520 278740 278960 279180 279400 279620 279840 280060 280280 280500 280720 280940 281160 281380 281600 281820 282040 282260 282480 282700 282920 283140 283360 283580 283800 284020 284240 284460 284680 284900 285120 285340 285560 285780 286000 286220 286440 286660 286880 287100 287320 287540 287760 287980 288200 288420 288640 288860 289080 289300 289520 289740 289960 290180 290400 290620 290840 291060 291280 291500 291720 291940 292160 292380 292600 292820 293040 293260 293480 293700 293920 294140 294360 294580 294800 295020 295240 295460 295680 295900 296120 296340 296560 296780 297000 297220 297440 297660 297880 298100 298320 298540 298760 298980 299200 299420 299640 299860 300080 300300 300520 300740 300960 301180 301400 301620 301840 302060 302280 302500 302720 302940 303160 303380 303600 303820 304040 304260 304480 304700 304920 305140 305360 305580 305800 306020 306240 306460 306680 306900 307120 307340 307560 307780 308000 308220 308440 308660 308880 309100 309320 309540 309760 309980 310200 310420 310640 310860 311080 311300 311520 311740 311960 312180 312400 312620 312840 313060 313280 313500 313720 313940 314160 314380 314600 314820 315040 315260 315480 315700 315920 316140 316360 316580 316800 317020 317240 317460 317680 317900 318120 318340 318560 318780 319000 319220 319440 319660 319880 320100 320320 320540 320760 320980 321200 321420 321640 321860 322080 322300 322520 322740 322960 323180 323400 323620 323840 324060 324280 324500 324720 324940 325160 325380 325600 325820 326040 326260 326480 326700 326920 327140 327360 327580 327800 328020 328240 328460 328680 328900 329120 329340 329560 329780 330000 330220 330440 330660 330880 331100 331320 331540 331760 331980 332200 332420 332640 332860 333080 333300 333520 333740 333960 334180 334400 334620 334840 335060 335280 335500 335720 335940 336160 336380 336600 336820 337040 337260 337480 337700 337920 338140 338360 338580 338800 339020 339240 339460 339680 339900 340120 340340 340560 340780 341000 341220 341440 341660 341880 342100 342320 342540 342760 342980 343200 343420 343640 343860 344080 344300 344520 344740 344960 345180 345400 345620 345840 346060 346280 346500 346720 346940 347160 347380 347600 347820 348040 348260 348480 348700 348920 349140 349360 349580 349800 350020 350240

PUBCO PETROLEUM CORPORATION  
Federal #19  
350' FWL & 990' FNL Section 1-26N-6W  
Rio Arriba County, New Mexico

Attached is a topographic map and separate location plat which, with the information given below, conform to the EPA and USGS requirements for drilling on public lands.

1. Existing roads are shown on the topographic map.
2. Planned access roads are shown on the topographic map as the road extension from the nearest road or existing well.
3. Location of all wells within 1/2 mile are shown on the topographic map.
4. Lateral road to well location is shown.
5. Location of flow line and surface dehydrator are shown on the well plat.
6. Water supply will be purchased from trucking company and hauled from nearest surface source.
7. Method of handling waste disposal. Waste will be discarded into reserve pit and buried when well is completed.
8. Camps: None.
9. Air Strips: None.
10. Location layout: See attached well plat.
11. Plans for restoration of surface: After completion of the well, the surface will be graded and levelled. Terracing will be used to prevent washing, if necessary.

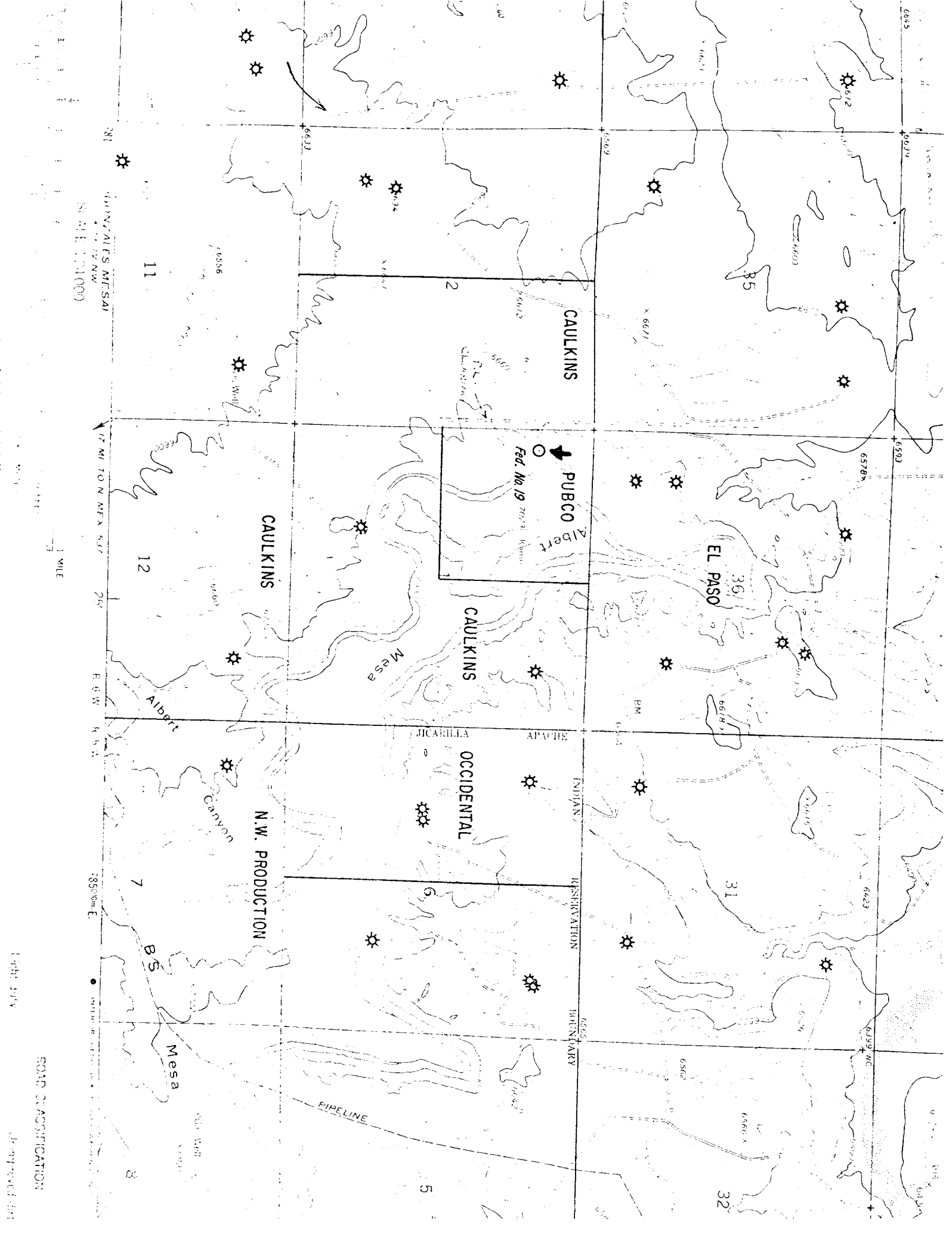

UNITED STATES MESSA  
SCALE 1:100,000

17 MI TON MEX 537

E 5 W N 5 N

8900m E

• INTERIOR COUNTRY

10th July

Approved for

ROAD CLASSIFICATION

Pubco Petroleum Corporation  
Federal #19  
350' FWL & 990' FNL Section 1-26N-6W  
Rio Arriba County, New Mexico

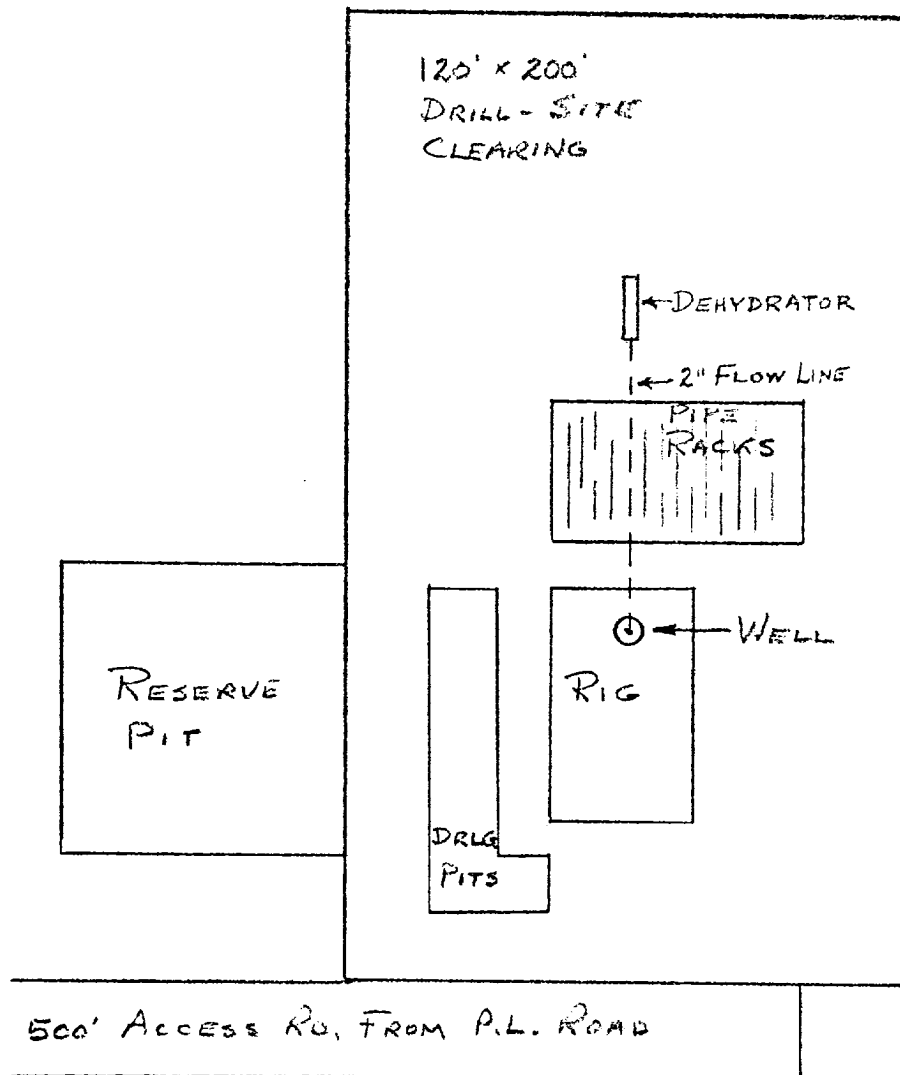

ALBERT

MESA



PUBCO

POST OFFICE BOX 869 • ALBUQUERQUE, NEW MEXICO 87103 • TELEPHONE (505) 842-1940

August 18, 1972

El Paso Natural Gas Company  
P. O. Box 990  
Farmington, New Mexico 87401

Gentlemen:

Pubco Petroleum Corporation respectfully requests your waiver of objection to the following unorthodox location:

Pubco Petroleum Corporation  
Federal #19  
350' FWL & 990' FNL  
Section 1, T-26N, R-6W  
Rio Arriba County, New Mexico

Attached you will find a topographic and ownership plat of the area showing the proposed well location. Pubco is seeking State Administrative approval for exception to Rule 104 because of the prohibitive expense which would be involved in building a road and location to a more geologically desirable point on top of Albert Mesa in the NE/4 NW/4 of Section 1.

A copy of the "Application to Drill" this Pictured Cliff well is also attached. Please call if you require additional information about the proposed well.

Very truly yours,

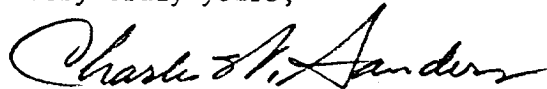

Charles W. Sanders  
Area Production Manager

CWS:cm

We hereby waive objection to the above unorthodox location.

BY: \_\_\_\_\_

COMPANY: \_\_\_\_\_

# PUBCO

POST OFFICE BOX 869 • ALBUQUERQUE, NEW MEXICO 87103 • TELEPHONE (505) 842-1940

August 18, 1972

Caulkins Oil Company  
315 Majestic Building  
209 16th Street  
Denver, Colorado 80202

Gentlemen:

Pubco Petroleum Corporation respectfully requests your waiver of objection to the following unorthodox location:

Pubco Petroleum Corporation  
Federal #19  
350' FWL & 990' FNL  
Section 1, T-26N, R-6W  
Rio Arriba County, New Mexico

Attached you will find a topographic and ownership plat of the area showing the proposed well location. Pubco is seeking State Administrative approval for exception to Rule 104 because of the prohibitive expense which would be involved in building a road and location to a more geologically desirable point on top of Albert Mesa in the NE/4 NW/4 of Section 1.

A copy of the "Application to Drill" this Pictured Cliff well is also attached. Please call if you require additional information about the proposed well.

Very truly yours,

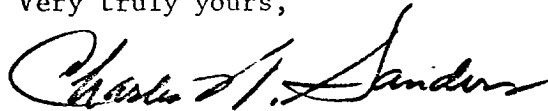

Charles W. Sanders  
Area Production Manager

CWS:cm

We hereby waive objection to the above unorthodox location.

\_\_\_\_\_  
BY:

COMPANY: \_\_\_\_\_

# PUBCO

POST OFFICE BOX 869 • ALBUQUERQUE, NEW MEXICO 87103 • TELEPHONE (505) 842-1940

August 18, 1972

Mr. A. L. Porter, Jr.  
Secretary-Director  
Oil Conservation Commission  
P. O. Box 2088  
Santa Fe, New Mexico 87501

Dear Sir:

Pubco Petroleum Corporation respectfully requests Administrative approval for exception to Rule 104 for the following unorthodox Pictured Cliff location:

Pubco Petroleum Corporation  
Federal #19  
350' FWL & 990' FNL  
Section 1, T-26N, R-6W  
Rio Arriba County, New Mexico

Attached you will find a topographic and ownership plat of the area showing the proposed location. Pubco is seeking State Administrative approval for exception to Rule 104 because of the prohibitive expense which would be involved in building a road and location to a more geologically desirable point on top of Albert Mesa in the NE/4 NW/4 of Section 1.

A copy of "Surveyor's Plat" and "Application to Drill" this Pictured Cliff well is attached. Also attached is a copy of the request for waiver of objection to offset operators, the mailing list of offset operators, and a copy of the Certified mail receipts.

Thank you.

Very truly yours,

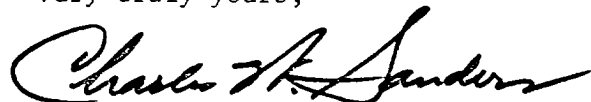

Charles W. Sanders  
Area Production Manager

CWS:cm  
Enclosures