

UNITED STATES
DEPARTMENT OF THE INTERIOR
GEOLOGICAL SURVEY

30-039-20572

APPLICATION FOR PERMIT TO DRILL, DEEPEN, OR PLUG BACK

1a. TYPE OF WORK

DRILL ☒DEEPEN ☐PLUG BACK ☐

b. TYPE OF WELL

OIL
WELL ☐GAS
WELL ☒

OTHER

SINGLE
ZONE ☒MULTIPLE
ZONE ☐

2. NAME OF OPERATOR

Marathon Oil Company

3. ADDRESS OF OPERATOR

P O. Box #39, Sidney, Nebraska 69162

4. LOCATION OF WELL (Report location clearly and in accordance with any State requirements.*)

At surface

1,060' FNL, 1,190' FEL, SW NE NE Section 27, T.26N., R.5W.

At proposed prod. zone

14. DISTANCE IN MILES AND DIRECTION FROM NEAREST TOWN OR POST OFFICE*

10. DISTANCE FROM PROPOSED*

LOCATION TO NEAREST
PROPERTY OR LEASE LINE, FT.
(Also to nearest drlg. unit line, if any)

1,060'

16. NO. OF ACRES IN LEASE

2,560'

17. NO. OF ACRES ASSIGNED

TO THIS WELL

320 / 6.4

18. DISTANCE FROM PROPOSED LOCATION*

TO NEAREST WELL, DRILLING, COMPLETED,
OR APPLIED FOR, ON THIS LEASE, FT.

19. PROPOSED DEPTH

3,100'

20. ROTARY OR CABLE TOOLS

Rotary

21. ELEVATIONS (Show whether DF, RT, GR, etc.)

6,528' GR

22. APPROX. DATE WORK WILL START*

October 11, 1972

23.

PROPOSED CASING AND CEMENTING PROGRAM

SIZE OF HOLE	SIZE OF CASING	WEIGHT PER FOOT	SETTING DEPTH	QUANTITY OF CEMENT
9-7/8"	7-5/8"	24#	200'	160 sacks (cement to surface)
6-3/4"	4-3/4"	16#	3,100'	350 sacks (cement to surface)

OBJECTIVE: Pictured Cliffs Sand.

MUD PROGRAM:

Gel-Chem mud. WL 10 cc's or less while drilling Pictured Cliffs.

CORES AND DRILL STEM TESTS: None planned

DEVIATION SURVEYS: Minimum of 500' intervals.

LOGS: IES log from T.D. to base of surface casing. Minimum run FDC - GR - Cal - CNL.
GR - Correlation log in cased hole.BOP PROGRAM: Series 900 dual hydraulic W/blind rams, drill pipe rams, and changeable
rams for production casing.

IN ABOVE SPACE DESCRIBE PROPOSED PROGRAM: If proposal is to deepen or plug back, give data on present productive zone and proposed new productive zone. If proposal is to drill or deepen directionally, give pertinent data on subsurface locations and measured and true vertical depths. Give blowout preventer program, if any. This well will be drilled in conformance with safe oil field drilling and 24. operating practice.

SIGNED

Mark Paul

TITLE

District Operations Manager DATE October 6, 1972

(This space for Federal or State office use)

PERMIT NO.

APPROVAL DATE

APPROVED BY

TITLE

DATE

CONDITIONS OF APPROVAL, IF ANY:

*See Instructions On Reverse Side

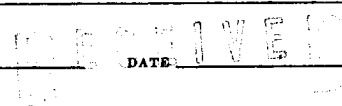
U. S. GEOLOGICAL SURVEY
COLD.

OCT 11 1972

**NEW MEXICO OIL CONSERVATION COMMISSION
WELL LOCATION AND ACERAGE DEDICATION PLAT**

All distances must be from the outer boundaries of the Section

Operator MARATHON OIL COMPANY			Lease Jicarilla Apache		Well No. 17
Unit Letter A	Section 27	Township 26 North	Range 5 West	County Rio Arriba	
Actual Footage Location of Well: 1060 feet from the North line and 1190 feet from the East line					
Ground Level Elev. 6528	Producing Formation		Pool S.P.R.	Dedicated Acreage: 1.00 Acres	

1. Outline the acreage dedicated to the subject well by colored pencil or hachure marks on the plat below.
2. If more than one lease is dedicated to the well, outline each and identify the ownership thereof (both mineral and working interest and royalty),
3. If more than one lease of different ownership is dedicated to the well, have the interests of all owners been consolidated by communitization, unitization, force-pooling, etc?

() Yes () No If answer is "yes," type of consolidation

If answer is "no," list the owners and tract descriptions which have actually consolidated. (Use reverse side of this form if necessary.)

No allowable will be assigned to the well until all interests have been consolidated (by communitization, unitization, forced-pooling, or otherwise) or until a non standard unit, eliminating such interests, has been approved by the Commission.

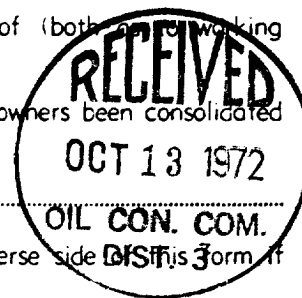

CERTIFICATION

I hereby certify that the information contained herein is true and complete to the best of my knowledge and belief.

Frank Barrett
Name
Position
District Operations Manager
Company
Marathon Oil Company
Date
October 6, 1972

I hereby certify that the well location shown on this plat was plotted from field notes of actual surveys made by me or under my supervision, and that the same is true and correct to the best of my knowledge and belief.

September 26, 1972
Date Surveyed
E. V. Echhawk
Registered Professional Engineer
and/or Land Surveyor

Certificate No. 3602
E. V. Echhawk LS

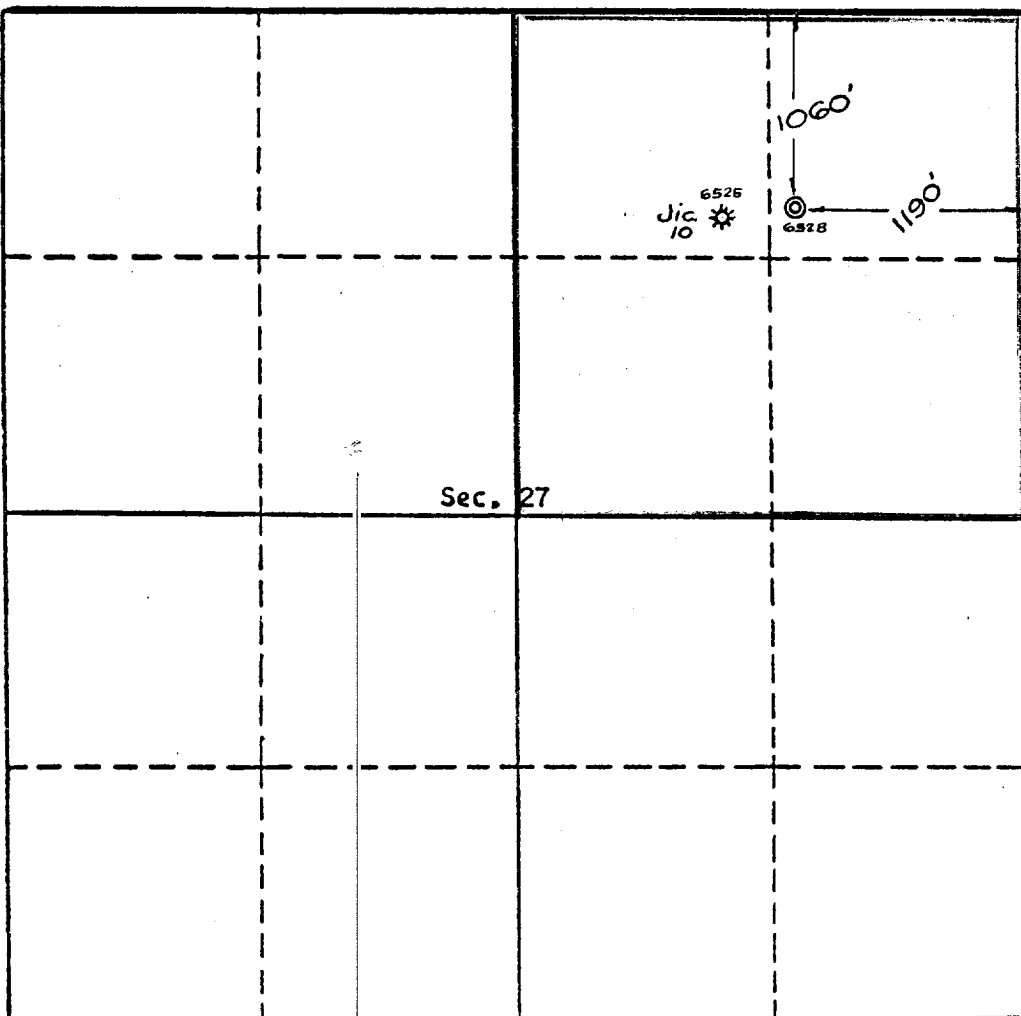

Scale, 1 inch = 1,000 feet