

OIL CONSERVATION DIVISION

STATE OF NEW MEXICO
ENERGY AND MINERALS DEPARTMENTP. O. BOX 2088
SANTA FE, NEW MEXICO 87501Form C-102
Revised 10-1-79

All distances must be from the outer boundaries of the Section.

Operator Jerome P. McHugh			Lease Jicarilla		Well No. 6-E
Unit Letter J	Section 29	Township 26 North	Range 4 West	County Rio Arriba	
Actual Footage Location of Well:					
1850 feet from the South line and		1520 feet from the East line			
Ground Level Elev. 7258	Producing Formation Dakota	Pool Basin Dakota	Dedicated Acreage: 320 Acres		

1. Outline the acreage dedicated to the subject well by colored pencil or hachure marks on the plat below.
2. If more than one lease is dedicated to the well, outline each and identify the ownership thereof (both as to working interest and royalty).
3. If more than one lease of different ownership is dedicated to the well, have the interests of all owners been consolidated by communitization, unitization, force-pooling, etc?

☐ Yes ☐ No If answer is "yes," type of consolidation _____

If answer is "no," list the owners and tract descriptions which have actually been consolidated. (Use reverse side of this form if necessary.) _____

No allowable will be assigned to the well until all interests have been consolidated (by communitization, unitization, forced-pooling, or otherwise) or until a non-standard unit, eliminating such interests, has been approved by the Division.

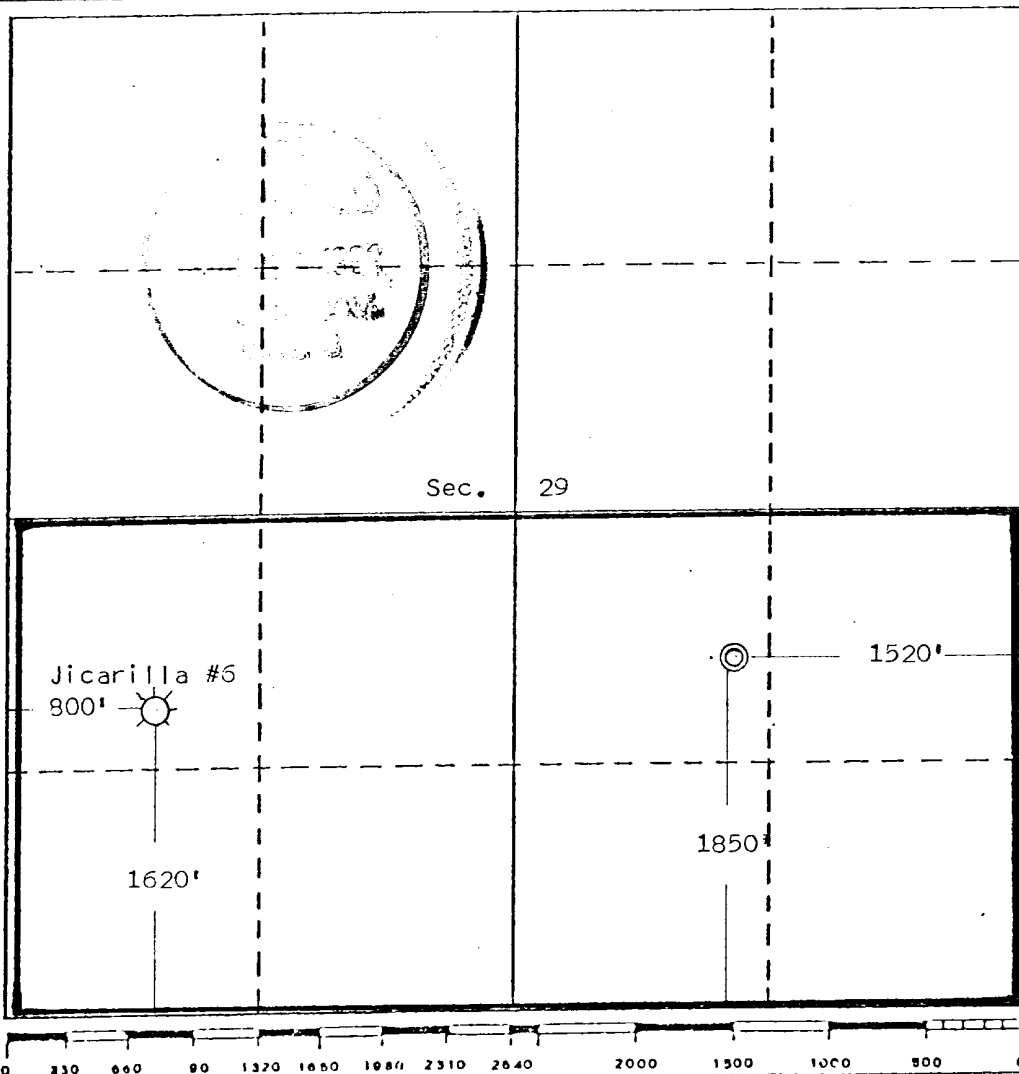

CERTIFICATION

I hereby certify that the information contained herein is true and complete to the best of my knowledge and belief.

Jerome P. McHugh Jr.
Name
Jerome P. McHugh Jr.

Position
Agent

Company
Dugan Production Corp.

Date
3-4-81

I hereby certify that the location shown on the plat is correct from field notes or other surveys made or under my supervision and that the same is true and correct to the best of my knowledge and belief.

Date Surveyed
February 12, 1981

Registered Professional Engineer and/or Land Surveyor

Edgar L. Risen
Certificate No.

