

Blow - Risk - bedrock
Sep - OK
BJS 74

SUBMIT 1 COPY TO
NATURAL RESOURCE DEPT
AND OIL & GAS ADMINISTRATION

**JICARILLA APACHE TRIBE
ENVIRONMENTAL PROTECTION OFFICE
P.O. BOX 507
DULCE, NEW MEXICO 87528**

PIT REMEDIATION AND CLOSURE REPORT

RECEIVED
AUG 20 1999

OIL CON. DIV.
DIST. 3

Operator: AMOCO PRODUCTION COMPANY **Telephone:** (505) 328-9200

Address: 200 Amoco Court, Farmington, NM 87401

Facility or Well Name: JICARILLA APACHE TRIBAL # 151 - S

Location: Unit or Qtr/Qtr Sec K Sec 9 T 26N R 5W County RIO ARriba

Pit Type: Separator Dehydrator Other BLOW

Land Type: RANGE

Pit Location: Pit dimensions: length 37', width 39', depth 12'
(Attach diagram)

Reference: wellhead X, other

Footage from reference: 190'

Direction from reference: 52 Degrees East of North
X West South X

Depth To Groundwater: (Vertical distance from contaminants to seasonal high water elevation of groundwater)	Less than 50 feet	(20 points)	
	50 feet to 99 feet	(10 points)	
	Greater than 100 feet	(0 points)	<u>0</u>
Distance to an Ephemeral Stream (Downgradient dry wash greater than ten feet in width)	Less than 100 feet	(10 points)	
	Greater than 100 feet	(0 points)	<u>0</u>
Distance to Nearest Lake, Playa, or Watering Pond (Downgradient lakes, playas and livestock or wildlife watering ponds)	Less than 100 feet	(10 points)	
	Greater than 100 feet	(0 points)	<u>0</u>
Wellhead Protection Area: (Less than 200 feet from a private domestic water source, or: less than 1000 feet from all other water sources)	Yes	(20 points)	
	No	(0 points)	<u>0</u>
Distance To Surface Water: (Horizontal distance to perennial lakes, ponds, rivers, streams, creeks, irrigation canals and ditches)	Less than 100 feet	(20 points)	
	100 feet to 1000 feet	(10 points)	
	Greater than 1000 feet	(0 points)	<u>0</u>

RANKING SCORE (TOTAL POINTS): 0

Date Remediation Started: _____ Date Completed: 7/10/98

Remediation Method: Excavation ☒ Approx. cubic yards 550
 Check all appropriate sections) Landfarmed ☒ Insitu Bioremediation _____
 Other _____

Remediation Location: Onsite ☒ Offsite _____
 (i.e. landfarmed onsite, name and location of offsite facility)

General Description of Remedial Action: Excavation . BEDROCK Bottom.

Groundwater Encountered: No ☒ Yes _____ Depth _____

Final Pit: Closure Sampling: (if multiple samples, attach sample results and diagram of sample locations and depths)
 Sample location see Attached Documents
 Sample depth 8' (EAST SIDEWALL)
 Sample date 6/29/98 Sample time 1300

Sample Results

Soil: Benzene	(ppm)	<u>0.316</u>	Water: Benzene	(ppb)	_____
Total BTEX	(ppm)	<u>0.400</u>	Toluene	(ppb)	_____
Field Headspace	(ppm)	<u>238.5</u>	Ethylbenzene	(ppb)	_____
TPH	(ppm)	<u>2.9</u>	Total Xylenes	(ppb)	_____

Groundwater Sample: Yes _____ No ☒ (If yes, attach sample results)

I HEREBY CERTIFY THAT THE INFORMATION ABOVE IS TRUE AND COMPLETE TO THE BEST OF MY KNOWLEDGE AND BELIEF

DATE 7/10/98 PRINTED NAME Buddy D. Shaw
 SIGNATURE Buddy D. Shaw AND TITLE Environmental Coordinator

AFTER REVIEW OF THE PIT CLOSURE INFORMATION, PIT CLOSURE IS APPROVED IN ACCORDANCE TO THE JICARILLA APACHE TRIBE PIT CLOSURE ORDINANCE.

APPROVED: YES ☒ NO _____ (REASON) _____

SIGNED: Kec' M... DATE: 7-27-98

CLIENT: <u>AMOCO</u>	BLAGG ENGINEERING, INC. P.O. BOX 87, BLOOMFIELD, NM 87413 (505) 632-1199	LOCATION NO: <u>8J574</u> C.O.C. NO: <u>6041</u>
----------------------	--	---

FIELD REPORT: CLOSURE VERIFICATION	PAGE No: <u>1</u> of <u>1</u>
---	-------------------------------

LOCATION: NAME: <u>JICA AP. TRIBAL IS1</u> WELL #: <u>5</u> PIT: <u>BLOW</u> QUAD/UNIT: <u>K</u> SEC: <u>9</u> TWP: <u>26N</u> RNG: <u>5W</u> PM: <u>NM</u> CNTY: <u>RA</u> ST: <u>NM</u> QTR/FOOTAGE: <u>1520' ESL / 1460' FWL</u> CONTRACTOR: <u>P+S</u>	DATE STARTED: <u>6/29/98</u> DATE FINISHED: _____ ENVIRONMENTAL SPECIALIST: <u>NV</u>
--	---

EXCAVATION APPROX. <u>37</u> FT. x <u>39</u> FT. x <u>12</u> FT. DEEP. CUBIC YARDAGE: <u>550</u>	DISPOSAL FACILITY: <u>ON-SITE</u> REMEDIATION METHOD: <u>LANDFARM</u>
LAND USE: <u>RANGE</u> LEASE: <u>JICA IS1</u> FORMATION: <u>DK</u>	

FIELD NOTES & REMARKS:	PIT LOCATED APPROXIMATELY <u>190</u> FT. <u>552W</u> FROM WELLHEAD. DEPTH TO GROUNDWATER: <u>>100'</u> NEAREST WATER SOURCE: <u>>1000'</u> NEAREST SURFACE WATER: <u>>1000'</u> NMOC RANKING SCORE: <u>0</u> NMOC TPH CLOSURE STD: <u>5000</u> PPM SOIL AND EXCAVATION DESCRIPTION:
------------------------	---

CHECK ONE:
☒ PIT ABANDONED
☐ STEEL TANK INSTALLED
☐ FIBERGLASS TANK INSTALLED

SIDEWALLS - MOSTLY VERY PALE ORANGE SILTY SAND TO SILTY CLAY NON COHESIVE, SLIGHTLY MOIST, FIRM TO VERY STIFF, NO APPARENT STAINING OR HC ODOR OBSERVED W/IN EXCAVATION, STRONG HC ODOR IN EAST SIDEWALL DUM SAMPLE ONLY, TOP HALF OF EXCAVATION APPEARS TO BE NATIVE SOIL - MOD. TO DK. YELL. BROWN SILTY SAND.

BOTTOM - BEDROCK (SHALE) VERY PALE ORANGE IN COLOR NO APPARENT STAINING, STRONG HC ODOR IN DUM SAMPLE.

BEDROCK BOTTOM

SCALE
 0 FT

RISK ASSESSED

FIELD 418.1 CALCULATIONS

TIME	SAMPLE I.D.	LAB No:	WEIGHT (g)	mL. FREON	DILUTION	READING	CALC. ppm
1300							

PIT PERIMETER

PIT PROFILE

OVM RESULTS		
SAMPLE ID	FIELD HEADSPACE PIG (ppm)	
1 @ 7'	37.4	
2 @ 8'	238.5	
3 @ 8'	0.0	
4 @ 8'	0.0	
5 @ 12'	573	

LAB SAMPLES		
SAMPLE ID	ANALYSIS	TIME
2 @ 8'	TPH / BTEX	1300
BOTH PASSED		

TRAVEL NOTES:	CALLOUT: <u>6/25/98 - AFTER.</u> ONSITE: <u>6/29/98 - MORN.</u>
---------------	---

Well Name:

Well Site location:

Pit Type:

Producing Formation:

Pit Category:

Horizontal Distance to Surface Water:

Vicinity Groundwater Depth:

Jicarilla Apache Tribal 151 #5

Unit K, Sec. 9, T26N, R5W

Blow Pit

Basin Dakota

Non Vulnerable

> 1000 ft.

> 100 ft.

RISK ASSESSMENT (non-vulnerable area)

Pit remediation activities were terminated when trackhoe encountered shale bedrock at 12 feet below grade.

No past or future threat to surface water or groundwater is likely based on the following considerations:

1. Past production fluids were contained locally by a relatively shallow shale bedrock located 12 feet below grade. Groundwater levels located on or close to the well pad are estimated to be at a much greater depth below shale bedrock.
2. Topographic information does not indicate off site lateral fluid migration near the earthen pit.
3. Daily discharge into the earthen pit has been terminated (pit abandoned). Prior discharge into the pit is believed to be under 5 barrels per day.
4. Well site located within the **non-vulnerable area** and is approximately 1.88 miles north of the nearest vulnerable area boundary (Tapacito Creek).

(Refer to Lapis Point Quadrangle, New Mexico - Rio Arriba County, 7.5 Minute Series (Topographic), 1963, (vulnerable area boundary developed by Mr. William C. Olson, Hydrogeologist, Environmental Bureau, New Mexico Oil Conservation Division).

Based upon the information given, we conclude that the shale bottom creates enough of an impermeable barrier as to subdue impact to groundwater below it (please refer to AMOCO's report "Post Excavation Pit Closure Investigation Summary, July, 1995", with cover letter dated November 30, 1995). AMOCO requests pit closure approval on this location.

ENVIROTECH LABS

PRACTICAL SOLUTIONS FOR A BETTER TOMORROW

EPA METHOD 8015 Modified Nonhalogenated Volatile Organics Total Petroleum Hydrocarbons

Client:	Blagg / AMOCO	Project #:	04034-10
Sample ID:	2 @ 8'	Date Reported:	07-02-98
Laboratory Number:	D574	Date Sampled:	06-29-98
Chain of Custody No:	6041	Date Received:	06-30-98
Sample Matrix:	Soil	Date Extracted:	07-01-98
Preservative:	Cool	Date Analyzed:	07-01-98
Condition:	Cool and Intact	Analysis Requested:	8015 TPH

Parameter	Concentration (mg/Kg)	Det. Limit (mg/Kg)
Gasoline Range (C5 - C10)	0.4	0.2
Diesel Range (C10 - C28)	2.5	0.1
Total Petroleum Hydrocarbons	2.9	0.2

ND - Parameter not detected at the stated detection limit.

References: Method 8015B, Nonhalogenated Volatile Organics, Test Methods for Evaluating Solid Waste, SW-846, USEPA, December 1996.

Comments: Jicarilla Apache Tribal #151 - 5 Blow Pit.

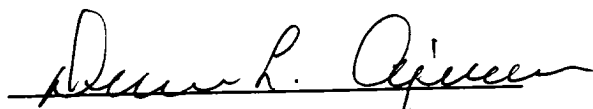
Analyst

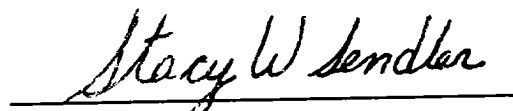
Review

ENVIROTECH LABS

PRACTICAL SOLUTIONS FOR A BETTER TOMORROW

EPA METHOD 8021 AROMATIC VOLATILE ORGANICS

Client:	Blagg / AMOCO	Project #:	04034-10
Sample ID:	2 @ 8'	Date Reported:	07-02-98
Laboratory Number:	D574	Date Sampled:	06-29-98
Chain of Custody:	6041	Date Received:	06-30-98
Sample Matrix:	Soil	Date Analyzed:	07-01-98
Preservative:	Cool	Date Extracted:	07-01-98
Condition:	Cool & Intact	Analysis Requested:	BTEX

Parameter	Concentration (ug/Kg)	Det. Limit (ug/Kg)
Benzene	316	8.8
Toluene	ND	8.4
Ethylbenzene	ND	7.6
p,m-Xylene	83.8	10.8
o-Xylene	ND	5.2
Total BTEX	400	

ND - Parameter not detected at the stated detection limit.

Surrogate Recoveries:	Parameter	Percent Recovery
	Trifluorotoluene	100 %
	Bromofluorobenzene	100 %

References: Method 5030B, Purge-and-Trap, Test Methods for Evaluating Solid Waste, SW-846, USEPA December 1996.

Method 8021B, Aromatic Volatile Organics, Test Methods for Evaluating Solid Waste, SW-846, USEPA, December 1996.

Comments: Jicarilla Apache Tribal #151 - 5 Blow Pit.

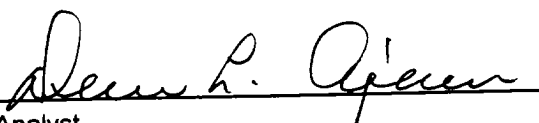
Analyst

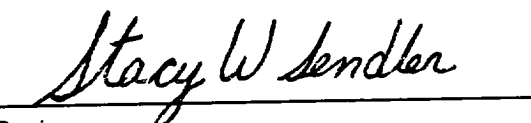
Review

**JICARILLA APACHE TRIBE
ENVIRONMENTAL PROTECTION OFFICE
P.O. BOX 507
DULCE, NEW MEXICO 87528**

87574

SUBMIT 1 COPY TO
NATURAL RESOURCE DEPT
AND OIL & GAS ADMINISTRATION

PIT REMEDIATION AND CLOSURE REPORT

Operator: AMOCO PRODUCTION COMPANY **Telephone:** (505) 326-9200
Address: 200 Amoco Court, Farmington, NM 87401
Facility or Well Name: JICARILLA APACHE TRIBAL 151-5
Location: Unit or Qtr/Qtr Sec 1K Sec 9 T 26N R 5W County RIO ARriba
Pit Type: Separator ☒ Dehydrator ☐ Other ☐
Land Type: RANGE

Pit Location: Pit dimensions: length 35', width 35', depth 15'
(Attach diagram) Reference: wellhead ☒, other ☐
Footage from reference: 165'
Direction from reference: 47 Degrees ☐ East ☒ North ☐ South
☒ West

Depth To Groundwater: (Vertical distance from contaminants to seasonal high water elevation of groundwater)	Less than 50 feet (20 points) 50 feet to 99 feet (10 points) Greater than 100 feet (0 points)	<u>0</u>
Distance to an Ephemeral Stream (Downgradient dry wash greater than ten feet in width)	Less than 100 feet (10 points) Greater than 100 feet (0 points)	<u>0</u>
Distance to Nearest Lake, Playa, or Watering Pond (Downgradient lakes, playas and livestock or wildlife watering ponds)	Less than 100 feet (10 points) Greater than 100 feet (0 points)	<u>0</u>
Wellhead Protection Area: (Less than 200 feet from a private domestic water source, or: less than 1000 feet from all other water sources)	Yes (20 points) No (0 points)	<u>0</u>
Distance To Surface Water: (Horizontal distance to perennial lakes, ponds, rivers, streams, creeks, irrigation canals and ditches)	Less than 100 feet (20 points) 100 feet to 1000 feet (10 points) Greater than 1000 feet (0 points)	<u>0</u>

RANKING SCORE (TOTAL POINTS): 0

BJ574

SEP. PIT

Date Remediation Started: _____ Date Completed: 7/10/98

Remediation Method: Excavation ☒ Approx. cubic yards 600
Check all appropriate sections) Landfarmed ☒ Insitu Bioremediation _____
Other _____

Remediation Location: Onsite ☒ Offsite _____
(i.e. landfarmed onsite, name and location of offsite facility)

General Description of Remedial Action: Excavation. BEDROCK Bottom.

Groundwater Encountered: No ☒ Yes _____ Depth _____

Final Pit: Sample location see Attached Documents
Closure Sampling: _____
(if multiple samples, attach sample results and diagram of sample locations and depths)
Sample depth 8' (EAST SIDEWALL)
Sample date 6/29/95 Sample time 1130

Sample Results

Soil: Benzene	(ppm)	<u>ND</u>	Water: Benzene	(ppb)	_____
Total BTEX	(ppm)	<u>0.301</u>	Toluene	(ppb)	_____
Field Headspace	(ppm)	<u>1,889</u>	Ethylbenzene	(ppb)	_____
TPH	(ppm)	<u>897</u>	Total Xylenes	(ppb)	_____

Groundwater Sample: Yes _____ No ☒ (If yes, attach sample results)

I HEREBY CERTIFY THAT THE INFORMATION ABOVE IS TRUE AND COMPLETE TO THE BEST OF MY KNOWLEDGE AND BELIEF

DATE 7/10/98 PRINTED NAME Buddy D. Shaw
SIGNATURE Buddy D. Shaw AND TITLE Environmental Coordinator

AFTER REVIEW OF THE PIT CLOSURE INFORMATION, PIT CLOSURE IS APPROVED IN ACCORDANCE TO THE JICARILLA APACHE TRIBE PIT CLOSURE ORDINANCE.

APPROVED: YES ☒ NO _____ (REASON) _____

SIGNED: [Signature] DATE: 7-27-98

3003920604

CLIENT: <u>AMOCO</u>	BLAGG ENGINEERING, INC. P.O. BOX 87, BLOOMFIELD, NM 87413 (505) 632-1199	LOCATION NO: <u>BJ574</u> C.D.C. NO: <u>6041</u>																																
FIELD REPORT: CLOSURE VERIFICATION		PAGE No: <u>1</u> of <u>1</u>																																
LOCATION: NAME: <u>JICA. AP. TRIBAL 151 WELL # 5</u> PIT: <u>SEP</u>		DATE STARTED: <u>6/29/98</u>																																
QUAD/UNIT: <u>K SEC 9</u> TWP: <u>26N</u> RNG: <u>5W</u> PM: <u>NM</u> CNTY: <u>RA</u> ST: <u>NM</u>		DATE FINISHED: _____																																
QTR/FOOTAGE: <u>1520' FSL / 1460' FWL</u> CONTRACTOR: <u>P & S</u>		ENVIRONMENTAL SPECIALIST: <u>NV</u>																																
EXCAVATION APPROX. <u>35</u> FT. x <u>35</u> FT. x <u>15</u> FT. DEEP. CUBIC YARDAGE: <u>600</u>																																		
DISPOSAL FACILITY: <u>ON-SITE</u> REMEDIATION METHOD: <u>LANDFARM</u>																																		
LAND USE: <u>RANGE</u> LEASE: <u>JIC 151</u> FORMATION: <u>DK</u>																																		
FIELD NOTES & REMARKS: PIT LOCATED APPROXIMATELY <u>165</u> FT. <u>N47W</u> FROM WELLHEAD.																																		
DEPTH TO GROUNDWATER: <u>>100'</u> NEAREST WATER SOURCE: <u>>1000'</u> NEAREST SURFACE WATER: <u>>1000'</u>																																		
NMOCD RANKING SCORE: <u>0</u> NMOCD TPH CLOSURE STD: <u>5000</u> PPM																																		
SOIL AND EXCAVATION DESCRIPTION:																																		
<p>SIDEWALLS - PREDOMINANTLY DUSKY RED/LT. TO MED. GRAY SILTY CLAY COHESIVE, SLIGHTLY MOIST, FIRM, NO APPARENT STAINING OBSERVED HC ODOR APPARENT @ EAST SIDEWALL ONLY, STRONG HC ODOR IN EAST SIDEWALL OVM SAMPLE ONLY.</p> <p>BOTTOM - BEDROCK (SHALE) DUSKY RED/MED. GRAY IN COLOR, VERY HARD, NO APPARENT HC ODOR OBSERVED W/IN EXCAVATION OR OVM SAMPLE.</p>																																		
<div style="display: flex; justify-content: space-between;"> <div style="width: 30%;"> <p>BEDROCK BOTTOM</p> <p>SCALE</p> <p>0 FT</p> </div> <div style="width: 30%;"> <p>CLOSED</p> </div> <div style="width: 30%;"> <p>FIELD 418.1 CALCULATIONS</p> <table border="1" style="width:100%; border-collapse: collapse;"> <thead> <tr> <th>TIME</th> <th>SAMPLE ID</th> <th>LAB No:</th> <th>WEIGHT (g)</th> <th>ML. FREON</th> <th>DILUTION</th> <th>READING</th> <th>CALC. ppm</th> </tr> </thead> <tbody> <tr> <td>1130</td> <td></td> <td></td> <td></td> <td></td> <td></td> <td></td> <td></td> </tr> <tr> <td></td> <td></td> <td></td> <td></td> <td></td> <td></td> <td></td> <td></td> </tr> <tr> <td></td> <td></td> <td></td> <td></td> <td></td> <td></td> <td></td> <td></td> </tr> </tbody> </table> </div> </div>			TIME	SAMPLE ID	LAB No:	WEIGHT (g)	ML. FREON	DILUTION	READING	CALC. ppm	1130																							
TIME	SAMPLE ID	LAB No:	WEIGHT (g)	ML. FREON	DILUTION	READING	CALC. ppm																											
1130																																		
<p>PIT PERIMETER</p>	<p>OVM RESULTS</p> <table border="1" style="width:100%; border-collapse: collapse;"> <thead> <tr> <th>SAMPLE ID</th> <th>FIELD HEADSPACE PID (ppm)</th> </tr> </thead> <tbody> <tr> <td>1 @ 9'</td> <td>0.0</td> </tr> <tr> <td>2 @ 8'</td> <td>1,889</td> </tr> <tr> <td>3 @ 9'</td> <td>10.4</td> </tr> <tr> <td>4 @ 9'</td> <td>0.0</td> </tr> <tr> <td>5 @ 15'</td> <td>0.0</td> </tr> <tr><td> </td><td> </td></tr> <tr><td> </td><td> </td></tr> <tr><td> </td><td> </td></tr> <tr><td> </td><td> </td></tr> <tr><td> </td><td> </td></tr> <tr><td> </td><td> </td></tr> <tr><td> </td><td> </td></tr> <tr><td> </td><td> </td></tr> </tbody> </table>	SAMPLE ID	FIELD HEADSPACE PID (ppm)	1 @ 9'	0.0	2 @ 8'	1,889	3 @ 9'	10.4	4 @ 9'	0.0	5 @ 15'	0.0																	<p>PIT PROFILE</p>				
SAMPLE ID	FIELD HEADSPACE PID (ppm)																																	
1 @ 9'	0.0																																	
2 @ 8'	1,889																																	
3 @ 9'	10.4																																	
4 @ 9'	0.0																																	
5 @ 15'	0.0																																	
<p>LAB SAMPLES</p> <table border="1" style="width:100%; border-collapse: collapse;"> <thead> <tr> <th>SAMPLE ID</th> <th>ANALYSIS</th> <th>TIME</th> </tr> </thead> <tbody> <tr> <td>2 @ 8'</td> <td>TPH/BTEX</td> <td>1130</td> </tr> <tr> <td colspan="3" style="text-align: center;">BOTH PASSED</td> </tr> <tr><td> </td><td> </td><td> </td></tr> <tr><td> </td><td> </td><td> </td></tr> <tr><td> </td><td> </td><td> </td></tr> </tbody> </table>			SAMPLE ID	ANALYSIS	TIME	2 @ 8'	TPH/BTEX	1130	BOTH PASSED																									
SAMPLE ID	ANALYSIS	TIME																																
2 @ 8'	TPH/BTEX	1130																																
BOTH PASSED																																		
TRAVEL NOTES: CALLOUT: <u>6/25/98 - AFTER.</u> ONSITE: <u>6/29/98 - MORN.</u>																																		

EPA METHOD 8015 Modified Nonhalogenated Volatile Organics Total Petroleum Hydrocarbons

Client:	Blagg / AMOCO	Project #:	04034-10
Sample ID:	2 @ 8'	Date Reported:	07-02-98
Laboratory Number:	D573	Date Sampled:	06-29-98
Chain of Custody No:	6041	Date Received:	06-30-98
Sample Matrix:	Soil	Date Extracted:	07-01-98
Preservative:	Cool	Date Analyzed:	07-01-98
Condition:	Cool and Intact	Analysis Requested:	8015 TPH

Parameter	Concentration (mg/Kg)	Det. Limit (mg/Kg)
Gasoline Range (C5 - C10)	124	0.2
Diesel Range (C10 - C28)	773	0.1
Total Petroleum Hydrocarbons	897	0.2

ND - Parameter not detected at the stated detection limit.

References: Method 8015B, Nonhalogenated Volatile Organics, Test Methods for Evaluating Solid Waste, SW-846, USEPA, December 1996.

Comments: Jicarilla Apache Tribal #151 - 5 Separator Pit.

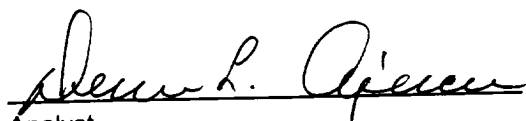
Analyst

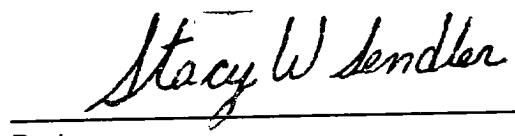
Review

ENVIROTECH LABS

PRACTICAL SOLUTIONS FOR A BETTER TOMORROW

EPA METHOD 8021 AROMATIC VOLATILE ORGANICS

Client:	Blagg / AMOCO	Project #:	04034-10
Sample ID:	2 @ 8'	Date Reported:	07-02-98
Laboratory Number:	D573	Date Sampled:	06-29-98
Chain of Custody:	6041	Date Received:	06-30-98
Sample Matrix:	Soil	Date Analyzed:	07-01-98
Preservative:	Cool	Date Extracted:	07-01-98
Condition:	Cool & Intact	Analysis Requested:	BTEX

Parameter	Concentration (ug/Kg)	Det. Limit (ug/Kg)
Benzene	ND	8.8
Toluene	ND	8.4
Ethylbenzene	61.3	7.6
p,m-Xylene	240	10.8
o-Xylene	ND	5.2
Total BTEX	301	

ND - Parameter not detected at the stated detection limit.

Surrogate Recoveries:	Parameter	Percent Recovery
	Trifluorotoluene	97 %
	Bromofluorobenzene	97 %

References: Method 5030B, Purge-and-Trap, Test Methods for Evaluating Solid Waste, SW-846, USEPA December 1996.

Method 8021B, Aromatic Volatile Organics, Test Methods for Evaluating Solid Waste, SW-846, USEPA, December 1996.

Comments: Jicarilla Apache Tribal #151 - 5 Separator Pit.

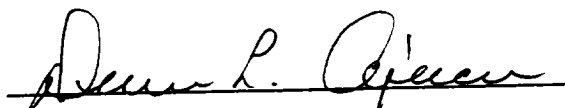
Analyst

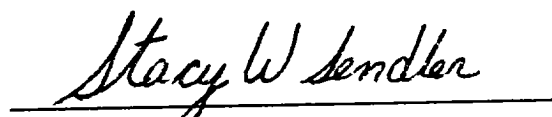
Review

6041

Client / Project Name			Project Location			ANALYSIS / PARAMETERS														
BASS/Amoco			TICALILLA TRIBAL # 151-5																	
Sampler: NTV			Client No. 04034-10																	
Sample No./ Identification	Sample Date	Sample Time	Lab Number	Sample Matrix	No. of Containers	TPH (8015)					BTX (8021)					Remarks				
(2) @ 8'	6/29/98	1130	D573	SOIL	1	✓	✓										BOTH SAMPLES PRESERV - COOL SEPARATOR PIT			
(2) @ 8'	6/29/98	1300	D574	SOIL	1	✓	✓										BROW PIT			
Relinquished by: (Signature)			Date			Time			Received by: (Signature)			Date			Time					
Relinquished by: (Signature)			4/30/98			1425			Received by: (Signature)			6.30.98			1425					
Relinquished by: (Signature)									Received by: (Signature)											
Relinquished by: (Signature)									Received by: (Signature)											
Sample Receipt																				
Received Intact																				
Cool - Ice/Blue Ice																				

B5574

JICARILLA APACHE TRIBE
ENVIRONMENTAL PROTECTION OFFICE
P.O. BOX 507
DULCE, NEW MEXICO 87528

SUBMIT 1 COPY TO
NATURAL RESOURCE DEPT
AND OIL & GAS ADMINISTRATION

ON-SITE SOIL REMEDIATION REPORT

Operator: AMOCO PRODUCTION COMPANY Telephone: (505) 326-9200

Address: 200 Amoco Court, Farmington, NM 87401

Facility or Well Name: JICARILLA APACHE TRIBAL 151-5

Location: Unit or Qtr/Qtr Sec K Sec 9 T 26N R 5W County RIO ARriba

Land Type: RANGE

Date Remediation Started: 6-29-98 Date Completed: 1-22-99

Remediation Method: Landfarmed ☒ Approx. cubic yards 1050

Composted ☐

Other ☐

Distance To Groundwater: (pts.) 0

Distance to an Ephemeral Stream (pts.) 0

Distance to Nearest Lake, Playa,
or Watering Pond (pts.) 0

Wellhead Protection Area: (pts.) 0

Distance To Surface Water: (pts.) 0

RANKING SCORE (TOTAL POINTS): 0

Final Closure Sampling:

Sampling Date: 1-20-99 Time: 1230

Sample Results:

Field Headspace (ppm) 0.0

TPH (ppm) 0.9 Method 8015

Other ☐

I HEREBY CERTIFY THAT THE INFORMATION ABOVE IS TRUE AND COMPLETE TO THE BEST OF MY KNOWLEDGE AND BELIEF

DATE 1/22/99 PRINTED NAME Buddy D. Shaw

SIGNATURE Buddy D. Shaw AND TITLE Environmental Coordinator

AFTER REVIEW OF THE SOIL REMEDIATION INFORMATION, ON-SITE REMEDIATION IS APPROVED IN ACCORDANCE TO THE JICARILLA APACHE TRIBE PIT CLOSURE ORDINANCE.

APPROVED: YES ☒ NO ☐ (REASON) ☐

SIGNED: K. C. Marshall DATE: 3-31-99

CLIENT: AMOCOBLAGG ENGINEERING, INC.
P.O. BOX 87, BLOOMFIELD, NM 87413
(505) 632-1199LOCATION NO: BJ574C.D.C. NO: 4559

FIELD REPORT: LANDFARM/COMPOST PILE CLOSURE VERIFICATION

LOCATION: NAME: SICATELLA APACHE TRIBAL 151 WELL #: 5 PITS: SEP, BLOW
QUAD/UNIT: K SEC: 9 TWP: 26N RNG: 5W PM: NM CNTY: RA ST: NM
QTR/FOOTAGE: NE/4 SW/4 CONTRACTOR: P+SDATE STARTED: 1.20.99
DATE FINISHED: 1.22.99ENVIRONMENTAL
SPECIALIST: REP

SOIL REMEDIATION:

REMEDIATION SYSTEM: LANDFARMAPPROX. CUBIC YARDAGE: 1050LAND USE: RANGELIFT DEPTH (ft): 0.5-1

FIELD NOTES & REMARKS:

DEPTH TO GROUNDWATER: >100' NEAREST WATER SOURCE: >1000' NEAREST SURFACE WATER: >1000'NMOCD RANKING SCORE: 0 NMOCD TPH CLOSURE STD: 5000 PPM

DK. YELLOWISH BROWN CLAYEY SAND, COHESIVE, SLIGHTLY MOIST, FIRM
NO STAINING OBSERVED OR NO ODOR DETECTED. SAMPLING DEPTHS
RANGE FROM 6"-12". TOOK A SPT. COMPOSITE SAMPLE FOR LAB ANALYSIS.

CLOSED

FIELD 418.1 CALCULATIONS

SAMP. TIME	SAMPLE I.D.	LAB No:	WEIGHT (g)	mL. FREON	DILUTION	READING	CALC. ppm

SKETCH/SAMPLE LOCATIONS

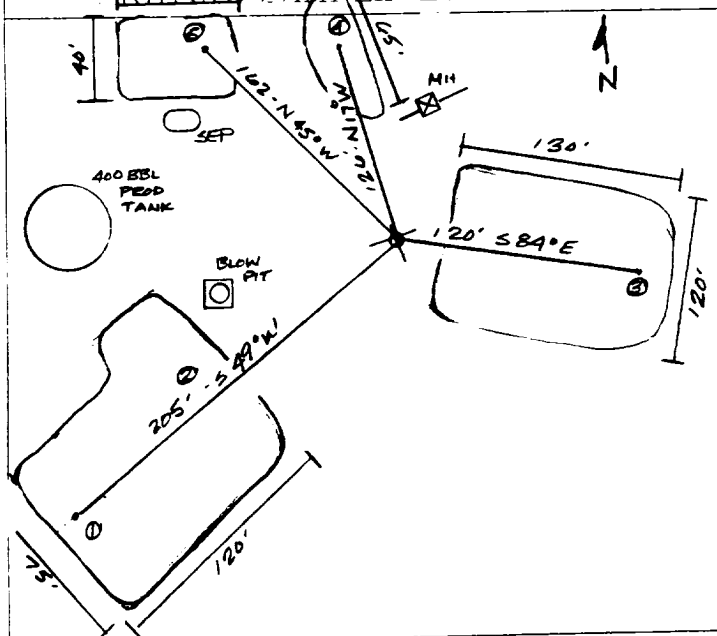

OVM RESULTS

LAB SAMPLES

SAMPLE ID	FIELD HEADSPACE PID (ppm)	SAMPLE ID	ANALYSIS	TIME	RESULTS
LF-1	0.0	LF-1	TPH (B015)	1230	6.9

SCALE

0 FT

TRAVEL NOTES:

CALLOUT: N/AONSITE: 1.20.99

ENVIROTECH LABS

PRACTICAL SOLUTIONS FOR A BETTER TOMORROW

EPA METHOD 8015 Modified Nonhalogenated Volatile Organics Total Petroleum Hydrocarbons

Client: Blagg / AMOCO
Sample ID: LF - 1
Laboratory Number: E561
Chain of Custody No: 6559
Sample Matrix: Soil
Preservative: Cool
Condition: Cool and Intact

Project #: 04034-10
Date Reported: 01-22-99
Date Sampled: 01-20-99
Date Received: 01-21-99
Date Extracted: 01-22-99
Date Analyzed: 01-22-99
Analysis Requested: 8015 TPH

Parameter	Concentration (mg/Kg)	Det. Limit (mg/Kg)
Gasoline Range (C5 - C10)	6.6	0.2
Diesel Range (C10 - C28)	0.3	0.1
Total Petroleum Hydrocarbons	6.9	0.2

ND - Parameter not detected at the stated detection limit.

References: Method 8015B, Nonhalogenated Volatile Organics, Test Methods for Evaluating Solid Waste, SW-846, USEPA, December 1996.

Comments: Jicarilla Apache Tribal 151 - 5 Landfarm. 5 Pt. Composite.

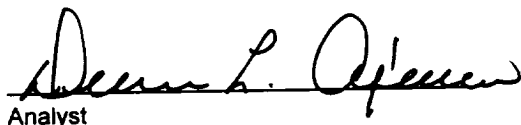
Analyst

Review

ה
ת
ת
ס

Ref cases 6556-6561