

UNITED STATES  
DEPARTMENT OF THE INTERIOR  
GEOLOGICAL SURVEY

## APPLICATION FOR PERMIT TO DRILL, DEEPEN, OR PLUG BACK

## 1a. TYPE OF WORK

DRILL ☒DEEPEN ☐PLUG BACK ☐

## b. TYPE OF WELL

OIL  
WELL ☐GAS  
WELL ☒

OTHER

SINGLE  
ZONE ☐MULTIPLE  
ZONE ☒

## 2. NAME OF OPERATOR

NORTHERN UNION PRODUCTION COMPANY

## 3. ADDRESS OF OPERATOR

P. O. Box 806, Farmington, New Mexico 87401

## 4. LOCATION OF WELL (Report location clearly and in accordance with any State requirements)

At surface

1160 FT. FROM THE NORTH LINE AND 1160 FT. FROM THE EAST LINE

At proposed prod. zone SAME AS ABOVE.

## 14. DISTANCE IN MILES AND DIRECTION FROM NEAREST TOWN OR POST OFFICE

11 MILES NORTHWEST OF QUITO, NEW MEXICO

## 15. DISTANCE FROM PROPOSED\*

LOCATION TO NEAREST  
PROPERTY OR LEASE LINE, FT.  
(Also to nearest drig. unit line, if any)

1160 FT.

18. DISTANCE FROM PROPOSED LOCATION\*  
TO NEAREST WELL, DRILLING, COMPLETED,  
OR APPLIED FOR, ON THIS LEASE, FT.

690 FT.

## 16. NO. OF MILES FROM

OIL CON. COM.  
2500 DIST. 3

## 19. PROPOSED DEPTH

7600 FT.

## 17. NO. OF ACRES ASSIGNED

TO THIS WELL  
750 ACRES

## 20. ROTARY OR CABLE TOOLS

ROTARY

## 21. ELEVATIONS (Show whether DF, RT, GR, etc.)

7123 FT. UNGRADED GROUND LEVEL.

## 22. APPROX. DATE WORK WILL START\*

JULY 15, 1973

## 23.

## PROPOSED CASING AND CEMENTING PROGRAM

SIZE OF HOLE	SIZE OF CASING	WEIGHT PER FOOT	SETTING DEPTH	QUANTITY OF CEMENT
12-3/4"	10-3/4"	32.75	325 FT.	250 BAGS
9-5/8"	7-5/8"	26.40	4050 FT.	1000 CU. FT.
6-3/4"	5-1/2"	15.50	(Lined) 3000 FT. - 7600 FT.	900 CU. FT.

WE PROPOSE TO DRILL A WELL TO BE DUALY COMPLETED IN THE BEAVERSIDE AND GALLUP FORMATIONS.  
ANTICIPATED TOTAL DEPTH 7600 FT. P.K.B.

## 1. CASING PROGRAM

SURFACE: 10-3/4", 32.75, H-40 SET @ 325 FT. CEMENTED TO SURFACE w/250 BAGS.

INTERMEDIATE: 7-5/8", 26.40, K-55 SET AT 4050 FT. 1ST STAGE CEMENTED w/APPROX.  
500 CU. FT. CEMENT; SPACE COLLAR SET AT APPROX. 2200 FT. CEMENTED  
w/APPROX. 500 CU. FT. OF CEMENT.

LINER: 5-1/2", 15.50, K-55 SET FROM 3000 - 7600 FT. CEMENTED w/500 CU. FT. CEM.

2. WELL WILL BE DRILL DEEPENED FROM SURFACE TO 4050 FT. AND GAS DRILLED FROM 4050 FT. TO  
TOTAL DEPTH OF 7600 FT.

## 3. BEAVERSIDE AND GALLUP ZONES WILL BE OILY FRACED TO OPTIMIZE PRODUCTION.

## 4. CEMENT 5-1/2" DUAL "D" PRODUCTION PACKER WILL BE SET AT APPROX. 7600 FT. P.K.B.

## 5. 1-1/2", E.U.E., 2.90, JCS-55 TUBING WILL BE RUN TO GALLUP AND SET AT APPROX. 7525' T.O.

## 6. 1-1/2", 2.76, JCS-55 INTERNAL JT. TUB. WILL BE RUN TO BEAVERSIDE AND SET @ APPROX. 7500' T.O.

IN ABOVE SPACE DESCRIBE PROPOSED PROGRAM: If proposal is to deepen or plug back, give data on present productive zone and proposed new productive zone. If proposal is to drill or deepen directionally, give pertinent data on subsurface locations and measured and true vertical depths. Give blowout preventer program, if any.

## 24.

Original signed by

SIGNED GILBERT D. NOLAND, JR.  
GILBERT D. NOLAND, JR.

TITLE DRILLING SUPERINTENDENT

DATE MAY 8, 1973

(This space for Federal or State office use)

PERMIT NO.

APPROVAL DATE

APPROVED BY

TITLE

DATE

CONDITIONS OF APPROVAL, IF ANY:

## Instructions

**General:** This form is designed for submitting proposals to perform certain well operations, as indicated, on all types of lands and leases for appropriate action by either a Federal or a State agency, or both, pursuant to applicable Federal and/or State laws and regulations. Any necessary special instructions concerning the use of this form and the number of copies to be submitted, particularly with regard to local, area, or regional procedures and practices, either are shown below or will be issued by, or may be obtained from, the local Federal and/or State office.

**Item 1:** If the proposal is to redrill to the same reservoir at a different subsurface location or to a new reservoir, use this form with appropriate notations. Consult applicable State or Federal regulations concerning subsequent work proposals or reports on the well.

**Item 4:** If there are no applicable State requirements, locations on Federal or Indian land should be described in accordance with Federal requirements. Consult local State or Federal office for specific instructions.

**Item 14:** Needed only when location of well cannot readily be found by road from the land or lease description. A plat, or plats, separate or on this reverse side, showing the roads to, and the surveyed location of, the well, and any other required information, should be furnished when required by Federal or State agency offices.

**Items 15 and 18:** If well is to be, or has been directionally drilled, give distances for subsurface location of hole in any present or objective production zone.

**Item 22:** Consult applicable Federal or State regulations, or appropriate officials, concerning approval of the proposal before operations are started.

U.S. GOVERNMENT PRINTING OFFICE : 1963—O-711-396

839-171











.....

.....





**INSERT**

**LARGE FORMAT**

**HERE**

\_\_\_\_\_

1. The following information is for informational purposes only and should not be used for any other purpose. It is not intended to be a substitute for professional advice. The information is provided as a service to our clients and is not a guarantee of any kind. The information is provided as a service to our clients and is not a guarantee of any kind.

**SOUTHERN UNION PRODUCTION COMPANY**

POST OFFICE BOX 803  
FARMINGTON, NEW MEXICO 88401  
MAY 8, 1973

RECEIVED

MAY 11 1973

U.S. GEOLOGICAL SURVEY  
DURANGO, COLORADO

UNITED STATES GEOLOGICAL SURVEY  
P. O. Box 1809  
DURANGO, COLORADO 81301

DEAR SIR:

SOUTHERN UNION PRODUCTION COMPANY PROPOSES TO DRILL ITS JICARILLA "A" NO. 14 (DUAL) MESAVARDE - GALLUP WELL LOCATED 1186 FEET FROM THE NORTH LINE AND 1160 FEET FROM THE EAST LINE OF SECTION 24, TOWNSHIP 26 NORTH, RANGE 4 WEST, N.M.P.M., RIO ARRIBA COUNTY, NEW MEXICO.

ATTACHED ARE MAPS SHOWING THE FOLLOWING DATA:

1. EXISTING ROADS.
2. PLANNED ACCESS ROADS.
3. LOCATION OF EXISTING WELLS.
4. LATERAL ROADS TO WELL LOCATIONS.
5. THE LOCATION OF TANK BATTERIES AND FLOW LINES ARE NOT PRESENTLY KNOWN. AFTER THE WELL HAS BEEN DRILLED AND THE LOCATION HAS BEEN CLEANED THIS EQUIPMENT WILL THEN BE INSTALLED ON THE EXISTING LOCATION. IT IS REQUESTED THAT A SUBSEQUENT MAP BE SUBMITTED AFTER DETERMINING THE EXACT LOCATION.
6. DRILLING AND COMPLETION WATER WILL BE OBTAINED FROM OUR WATER WELL LOCATED IN THE SW/4, SECTION 23, TOWNSHIP 26 NORTH, RANGE 4 WEST AND FROM A SUMP ON THE TAPACITO WASH LOCATED IN THE SE/4 OF SECTION 16, TOWNSHIP 26 NORTH, RANGE 4 WEST.
7. WASTE WILL BE DISPOSED OF BY BEING PLACED IN THE RESERVE PIT AND BURIED. SOME WILL BE BURNED IN BURN PIT WHICH WILL BE COVERED AFTER THE WELL HAS BEEN COMPLETED.
8. THERE WILL BE NO CAMP AT OR NEAR THE PROPOSED WELL SITE.
9. THERE WILL BE NO AIRSTRIP.
10. A MAP IS ATTACHED SHOWING THE LOCATION OF THE RIG, MUD TANKS, RESERVE PIT, BURN PIT, PIPE RACKS, ETC. THE ACCESS ROAD AND LOCATION WILL BE COMPACTED.
11. AFTER THE WELL IS COMPLETED THE LOCATION WILL BE CLEANED AND BLADED. THE RESERVE PIT WILL BE FENCED UNTIL IT HAS DRIED AND THEN IT WILL BE FILLED AND RESTORED TO ITS NATURAL STATE. THE ACCESS ROAD WILL BE LEFT AS IS FOR WELL MAINTENANCE.
12. THE WELLSITE IS LOCATED ON A LONG NARROW ROCKY MESA. THE MESA IS APPROXIMATELY 700 FEET WIDE AT THE POINT WHERE THE WELL IS TO BE LOCATED AND IS APPROXIMATELY 135 FEET HIGH TO SURROUNDING VALLYS. VEGETATION CONSISTS OF SCRUB CEDAR AND PINION WITH VERY LITTLE GRASS EVIDENT.

YOURS VERY TRULY,

SOUTHERN UNION PRODUCTION COMPANY

*Bill Vanderslice*  
BILL VANDERSLICE  
AREA SUPERINTENDENT

BV:ML















**INSERT**

**LARGE FORMAT**

**HERE**

SOUTHERN UNION PRODUCTION COMPANY  
JICARILLA "A" NO. 14  
1186 Ft./N line & 1160 Ft./E line, Sec. 24, T-26N, R-4W, N.M.P.M.  
RIO ARriba COUNTY, NEW MEXICO

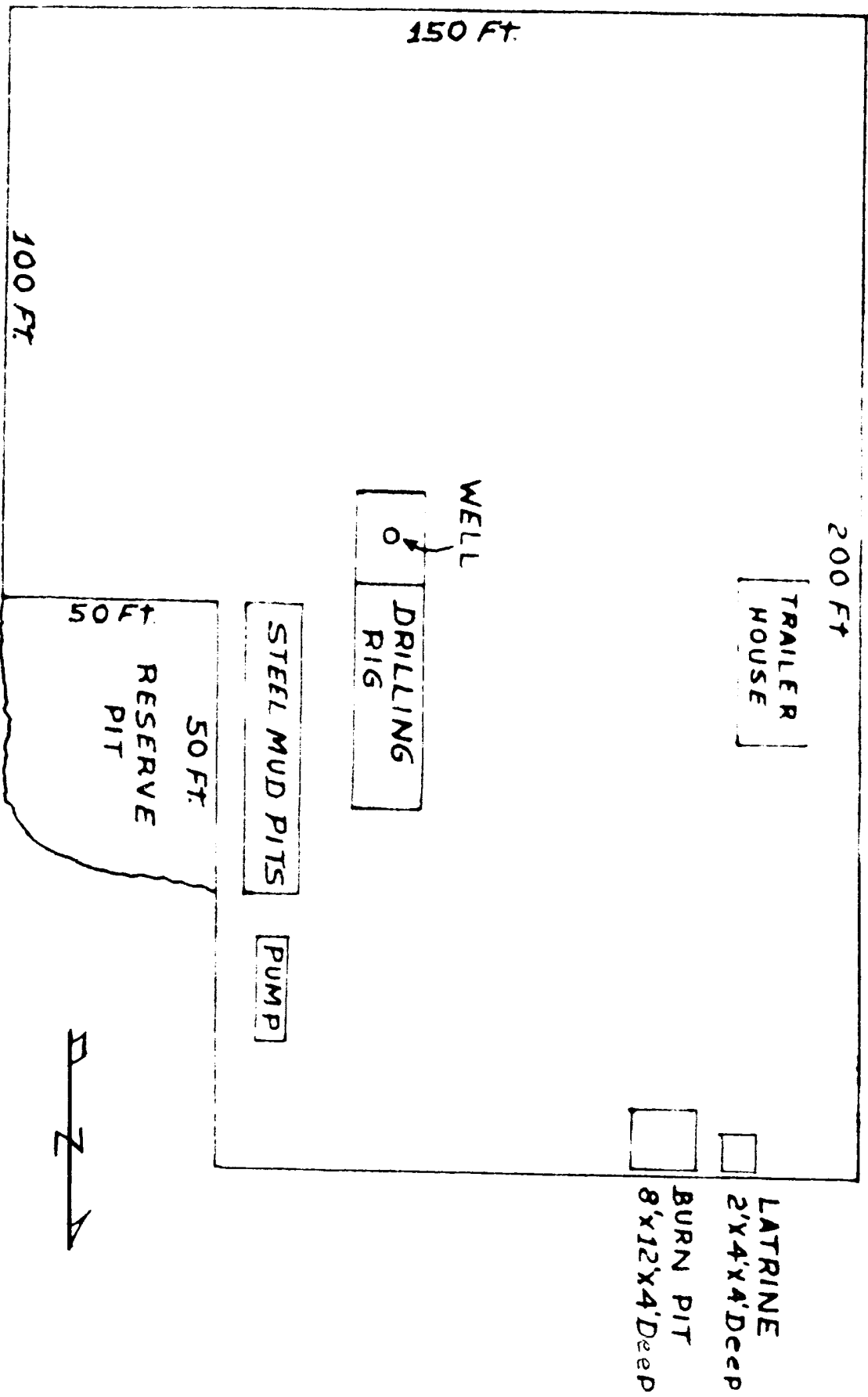

**INSERT**

**LARGE FORMAT**

**HERE**