

El Paso Natural Gas Company

El Paso, Texas 79918

May 22, 1974

ADDRESSES REPLY TO
POST OFFICE BOX 990
FARMINGTON, NEW MEXICO 87401

Mr. Jerry Long
U. S. Geological Survey
Post Office Box 1809
Durango, Colorado 81301

Re: Application for Permit to Drill
Canyon Largo Unit #256
SW/4 Section 27, T-25-N, R-7-W
Basin Dakota

Dear Mr. Long:

Details regarding existing roads, pipelines, wells, etc. relative to the above well location are included on the previously submitted base maps, "Field Road Map" and "Composite Map No. 1".

The proposed new well location, new roads and new pipeline are shown on the attached plat along with connecting existing roads and pipelines in the vicinity of the proposed new well.

Water for drilling and completion operations will be obtained from the following location: BLM Canyon Largo Water Hole, SWSE 11-24-6.

Waste material will be disposed of by burial in the burn pit, latrine, or reserve pit as applicable. There will be no camp nor air strip associated with drilling this well. Upon completion or abandonment of this well, the location will be cleaned and leveled and a dry hole marker placed, if applicable.

Yours very truly,

D. G. Brisco

D. G. Brisco
Drilling Clerk



pb

CANYON LANDS LIMIT No 256

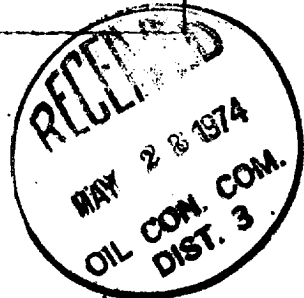
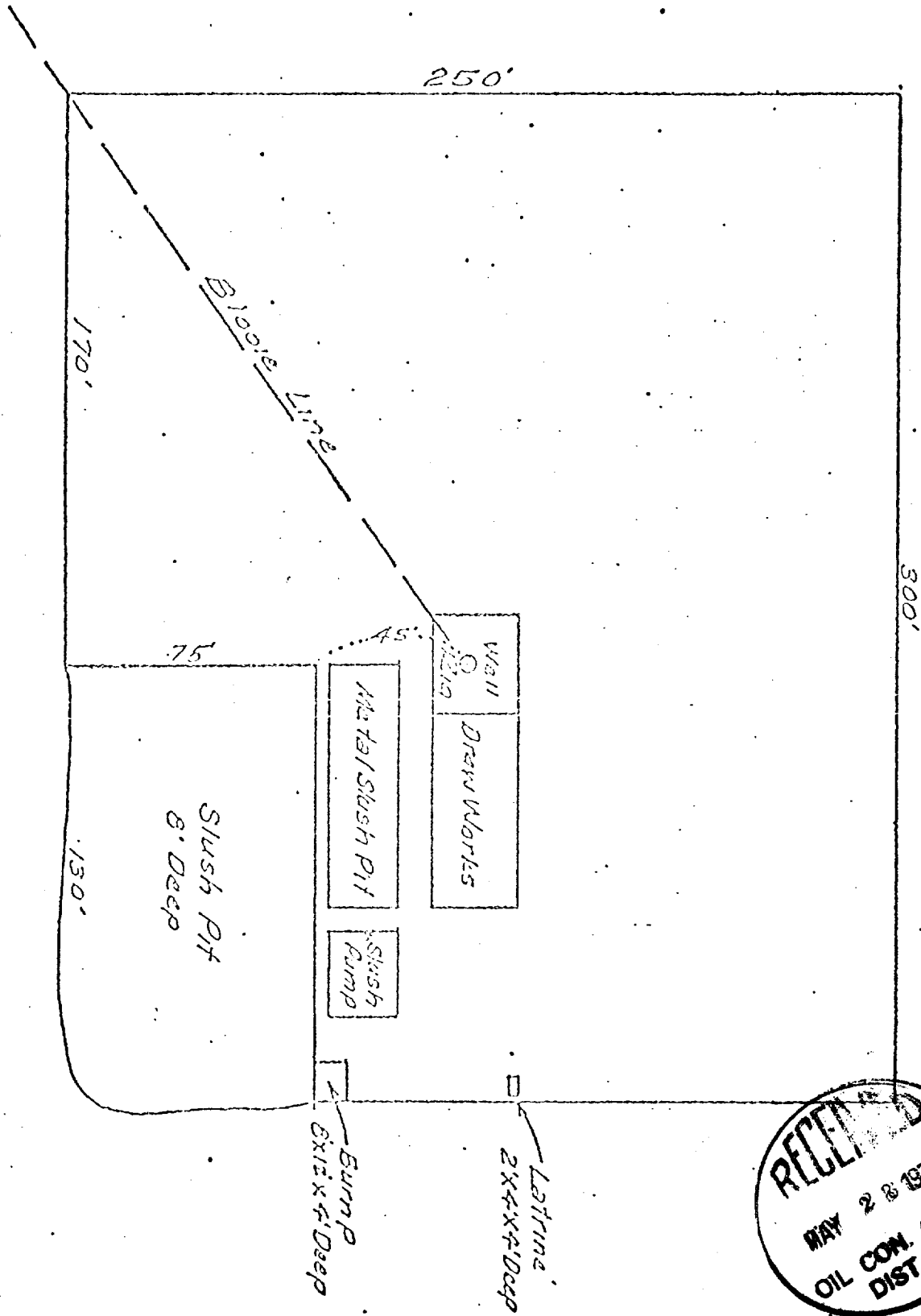

R. J. W.

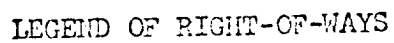

EXISTING ROADS	_____
EXISTING PIPELINES	-+ -+ -+ -+
EXISTING ROAD & PIPELINE	+--+--+--
PROPOSED ROADS	_____
PROPOSED PIPELINES	+ + + +
PROPOSED ROAD & PIPELINE	+--+--+--