

**NEW MEXICO OIL CONSERVATION COMMISSION
WELL LOCATION AND ACREAGE DEDICATION PLAT**

Form C-102
Supersedes C-128
Effective 1-1-65

All distances must be from the outer boundaries of the Section.

Operator MARATHON OIL COMPANY			Lease Jicarilla Apache		Well No. 17
Unit Letter H	Section 34	Township 26 North	Range 5 West	County Rio Arriba	
Actual Footage Location of Well: 1940 feet from the North line and 720 feet from the East line					
Ground Level Elev. 6624	Producing Formation Pictured Cliffs		Pool South Blanco		Dedicated Acreage: 160 Acres

1. Outline the acreage dedicated to the subject well by colored pencil or hachure marks on the plat below.
2. If more than one lease is dedicated to the well, outline each and identify the ownership thereof (both as to working interest and royalty).
3. If more than one lease of different ownership is dedicated to the well, have the interests of all owners been consolidated by communitization, unitization, force-pooling, etc?

☐ Yes ☐ No If answer is "yes," type of consolidation _____

If answer is "no," list the owners and tract descriptions which have actually been consolidated. (Use reverse side of this form if necessary.) _____

No allowable will be assigned to the well until all interests have been consolidated (by communitization, unitization, forced-pooling, or otherwise) or until a non-standard unit, eliminating such interests, has been approved by the Commission.

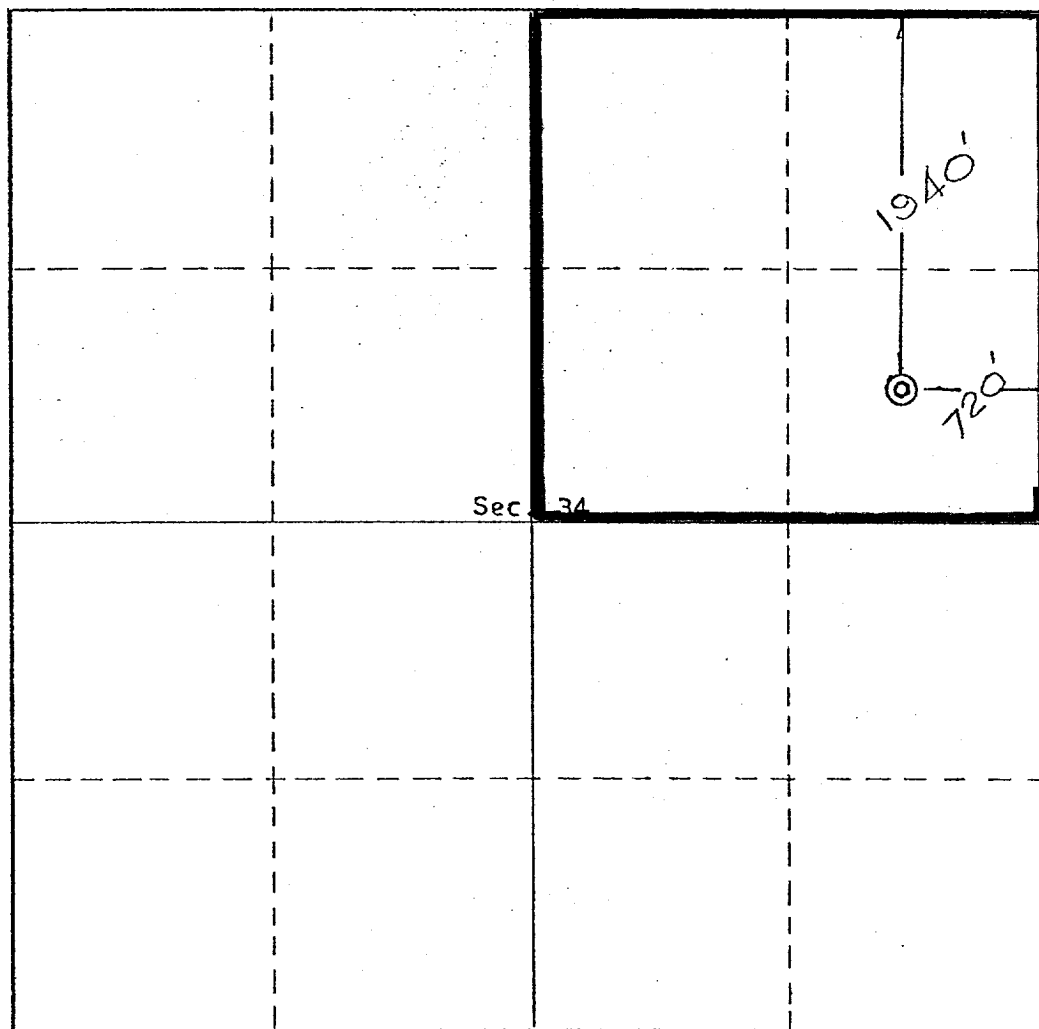

CERTIFICATION

I hereby certify that the information contained herein is true and complete to the best of my knowledge and belief.

Name
Carl M. Morris

Position
District Operations Manager

Company
Marathon Oil Company

Date
June 21, 1974

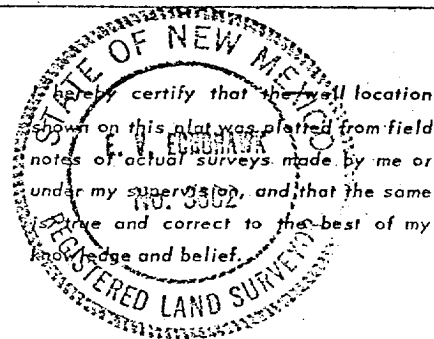

Date Surveyed
June 14, 1974

Registered Professional Engineer
and/or Land Surveyor

E.V. Echohawk

Certificate No. **3602**
E.V. Echohawk LS

