

DEPUTY OIL & GAS INSPECTOR

JUN 23 1998

P.O. BOX 507
DULCE, NEW MEXICO 87528

SUBMIT 1 COPY TO
NATURAL
RESOURCE DEPT
AND OIL-GAS
ADMINISTRATION

PIT REMEDIATION AND CLOSURE REPORT

Operator: PNM Gas Services (*Conoco*) **Telephone:** 324-3764

Address: 603 W. Elm Street Farmington, NM 87401

Facility or Well Name: TicArilla A-17

Location: Unit: F Sec. 14 T. 26 N R. 4 W County Rio Arriba

Pit Type: Separator ☒ Dehydrator ☐ Other ☐

Land Type: Jicarilla Apache

Pit Location: Pit dimensions: length 33' width 31' depth 11'

(Attach diagram) Reference: wellhead ☒ other

Footage from reference: 99

Direction from reference: Straight Degrees X East of North _____
West of South _____

Depth to Ground Water:

(Vertical distance from contaminants to seasonal high water elevation of ground water)

Less than 50 feet	(20 points)
50 feet to 99 feet	(10 points)
Greater than 100 feet	(0 points)

Wellhead Protection Area:

(Less than 200 feet from a private domestic water source, or, less than 1,000 feet from all other water sources)

Yes (20 points)
No (0 points)

Distance to Surface Water:

(Horizontal distance to perennial lakes, ponds, rivers, streams, creeks, irrigation canals and ditches)

Less than 200 feet	(20 points)
200 feet to 1,000 feet	(10 points)
Greater than 1,000 feet	(0 points)

Distance to Ephemeral Stream (dry wash):

(Horizontal distance to all downgradient streams having a width of at least 10 feet)

Less than or equal to 100 feet	(10 points)
Greater than 100 feet	(0 points)

Distance to Nearest Lake, Playa, or Watering Pond:

(Horizontal distance to all downgradient lakes, playas, and livestock or wildlife water ponds)

Less than or equal to 100 feet	(10 points)
Greater than 100 feet	(0 points)

RANKING SCORE (TOTAL POINTS) :

Date Remediation Started: 8/27/97 Date Completed: 11/4/97

Remediation Method: Excavation X Approx. Cubic Yards 417

(Check all appropriate sections)

Landfarmed X Amount Landfarmed (cubic yds): 417

Other _____

Remediation Location: Onsite X Offsite _____

(i.e., landfarmed onsite, name and location of offsite facility)

General Description of Remedial Action:

Removed contaminated soil from all four side walls as to get a below 100 ppm head space reading. Bottom is rock

Ground Water Encountered: No X Yes _____ Depth _____

Final Pit Closure Sampling:

Sample Location North, East, South, And West side walls

(if multiple samples, attach sample result and diagram of sample locations and depths.)

Sample depth 10'

Sample date 8/27/97 Sample time 1114

Sample Results

Soil: Benzene (ppm) ND Water: Benzene (ppb) _____

Total BTEX (ppm) 0.001 Toluene (ppb) _____

Field headspace (ppm) 28.8 Ethylbenzene (ppb) _____

TPH ND ppm Method 8015 Total Xylenes (ppb) _____

Ground Water Sample: Yes _____ No X (If yes, attach sample results)

I HEREBY CERTIFY THAT THE INFORMATION ABOVE IS TRUE AND COMPLETE TO THE BEST OF MY KNOWLEDGE AND MY BELIEF

DATE 9/3/97

PRINTED NAME Ronald A. Dedrick

SIGNATURE Ronald A. Dedrick

AND TITLE Environmental Technician II

AFTER REVIEW OF THE PIT CLOSURE INFORMATION, PIT CLOSURE IS APPROVED IN ACCORDANCE TO JICARILLA APACHE TRIBE PIT CLOSURE ORDINANCE.

APPROVED: YES X NO _____ (REASON): SPRAY + close

SIGNED: Ken C. Mann DATE: 9-3-97

Carilla A-17
Sec. 14 T26N R4W Unit E
Conoco

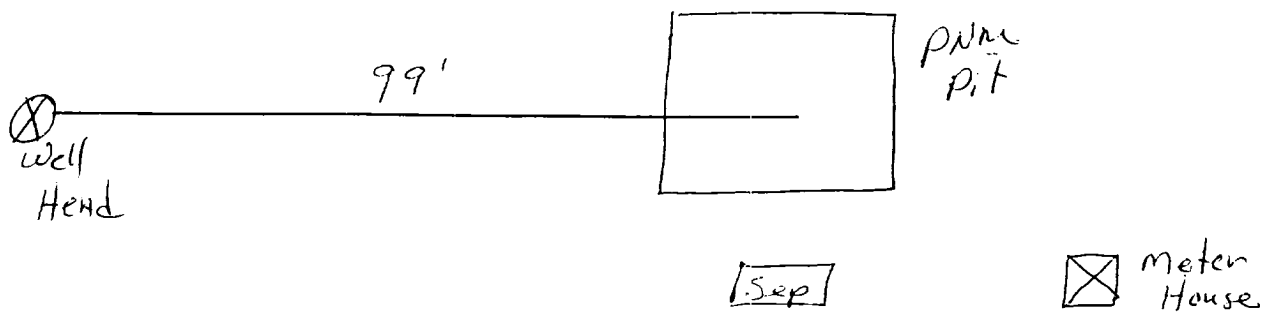

Carilla A-17
Sec. 14 T26N R4W Unit E
Conoco

33' x 31' x 11'

North Wall
Sample 10'
12.6 ppm

West Wall
Sample 10'
15.5 ppm

East Wall
Sample 10'
28.8 ppm

South Wall
Sample 10'
6.7 ppm

Bottom 11'
Rock

5' Sample - 362 ppm

10' Sample - 189 ppm

OFF: (505) 325-5667



LAB: (505) 325-1556

ANALYTICAL REPORT

Attn: *Denver Bearden*
Company: *PNM Gas Services*
Address: *603 W. Elm*
City, State: *Farmington, NM 87401*

Date: *2-Sep-97*
COC No.: *5573*
Sample No.: *15972*
Job No.: *2-1000*

Project Name: *PNM Gas Services - Jicarilla A-17*
Project Location: *9708271114; 4pt. Composite*
Sampled by: *PA*
Analyzed by: *DC/HR*
Sample Matrix: *Soil*

Date: *27-Aug-97* Time: *11:14*
Date: *2-Sep-97*

Laboratory Analysis

Parameter	Results as Received	Unit of Measure	Limit of Quantitation	Unit of Measure
<i>Diesel Range Organics (C10 - C28)</i>	ND	mg/kg	5	mg/kg

ND - Not Detected at Limit of Quantitation

Quality Assurance Report

DRO QC No.: 0548-STD

Continuing Calibration Verification

Parameter	Method Blank	Unit of Measure	True Value	Analyzed Value	RPD	RPD Limit
<i>Diesel Range (C10 - C28)</i>	ND	ppm	200	176	12.8	15%

Matrix Spike

Parameter	1- Percent Recovered	2 - Percent Recovered	Limit	RPD	RPD Limit
<i>Diesel Range (C10-C28)</i>	84	80	(70-130)	6	20%

Method - SW-846 EPA Method 8015A mod. - Nonhalogenated Volatile Hydrocarbons by Gas Chromatography

Approved by: *DC*

Date: *9/2/97*

P.O. BOX 2606 • FARMINGTON, NM 87499

WE DO NOT GUARANTEE THE ACCURACY OF THE DATA REPORTED HEREIN.

OFF: (505) 325-5667



LAB: (505) 325-1556

ANALYTICAL REPORT

Attn: *Denver Bearden*
Company: *PNM Gas Services*
Address: *603 W. Elm*
City, State: *Farmington, NM 87401*

Date: *2-Sep-97*
COC No.: *5573*
Sample No.: *15972*
Job No.: *2-1000*

Project Name: *PNM Gas Services - Jicarilla A-17*
Project Location: *9708271114; 4pt. Composite*
Sampled by: *PA* Date: *27-Aug-97* Time: *11:14*
Analyzed by: *HR* Date: *1-Sep-97*
Sample Matrix: *Soil*

Laboratory Analysis

Parameter	Results as Received	Unit of Measure	Limit of Quantitation	Unit of Measure
<i>Benzene</i>	ND	ug/kg	1	ug/kg
<i>Toluene</i>	ND	ug/kg	1	ug/kg
<i>Ethylbenzene</i>	ND	ug/kg	1	ug/kg
<i>m,p-Xylene</i>	1	ug/kg	1	ug/kg
<i>o-Xylene</i>	ND	ug/kg	1	ug/kg
	<i>TOTAL</i>	1	ug/kg	

ND - Not Detected at Limit of Quantitation

Method - SW-846 EPA Method 8020A Aromatic Volatile Organics by Gas Chromatography

Approved by: *[Signature]*
Date: *9/2/97*

P.O. BOX 2606 • FARMINGTON, NM 87499

JICARILLA APACHE TRIBE
ENVIRONMENTAL
PROTECTION OFFICE
P.O. BOX 507
DULCE, NEW MEXICO 87528

SUBMIT 1 COPY TO
NATURAL
RESOURCE DEPT
AND OIL GAS
ADMINISTRATION

ON-SITE SOIL REMEDIATION REPORT

Operator: PNM Gas Services (Conoco) Telephone: 324-3764	
Address: 603 W. Elm Street Farmington, NM 87401	
Facility or Well Name: Jicarilla A-17	
Location: Unit: E Sec. 14 T. 26 N R. 4 W County Rio Arriba	
Land Type: Jicarilla Apache	
Date Remediation Started: 8/27/97	Date Completed: 9/26/97
Remediation Method: Landfarmed <input checked="" type="checkbox"/> Composted <input type="checkbox"/> Other <input type="checkbox"/>	Approx. cubic yards: 417 cu. yds.
Depth to Ground Water: (pts.) 2	Final Closure Sampling: Sampling Date: 9/24/97 Time 0841 Sampling Results: Field Headspace (ppm) 12.1 TPH (ppm) 200 Method 8015 Other
Distance to an Ephemeral Stream: (pts.) 2	
Distance to Nearest Lake, Playa, or Watering Pond: (pts.) 2	
Wellhead Protection Area: (pts.) 2	
Distance to Surface Water: (pts.) 2	
Ranking Score (Total Points): 2	
I HEREBY CERTIFY THAT THE INFORMATION ABOVE IS TRUE AND COMPLETE TO THE BEST OF MY KNOWLEDGE AND BELIEF	
DATE: 9/30/97	PRINTED NAME: Ronald A. Dedrick
SIGNATURE: Ronald A. Dedrick	AND TITLE: Environmental Technician II
AFTER REVIEW OF THE SOIL REMEDIATION INFORMATION, ON-SITE REMEDIATION APPROVED IN ACCORDANCE TO THE JICARILLA APACHE TRIBE PIT CLOSURE ORDINANCE	
APPROVED: YES <input checked="" type="checkbox"/> NO <input type="checkbox"/> (REASON) use as Backfill	
SIGNED: K. C. Mammill	DATE: 9-30-97

ICARILLA A-17
Sec. 14 T26N R4W Unit E
Conoco

Land farm

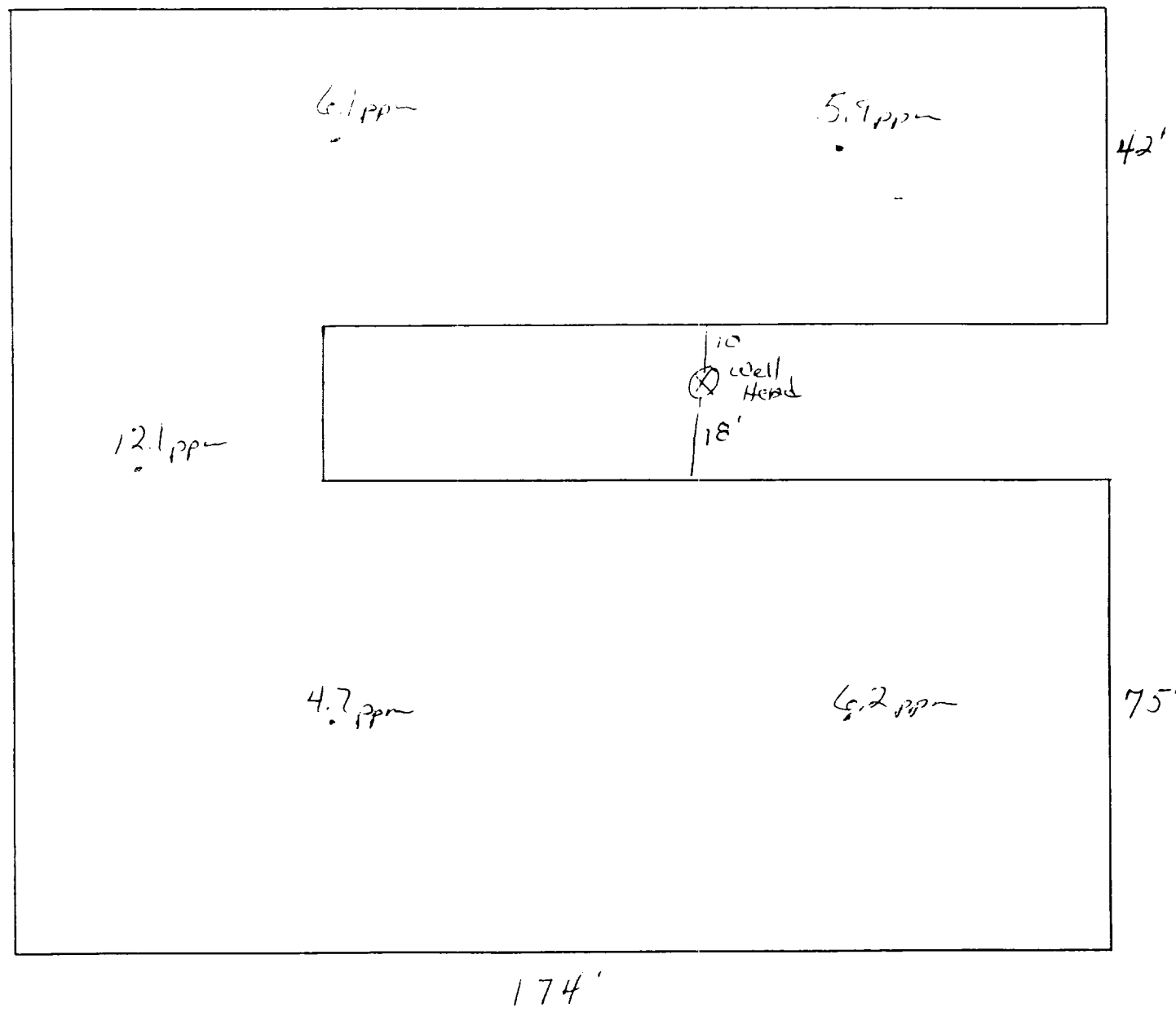

OFF: (505) 325-5667



LAB: (505) 325-1556

ANALYTICAL REPORT

Attn: *Denver Bearden*
Company: *PNM Gas Services*
Address: *603 W. Elm*
City, State: *Farmington, NM 87401*

Date: *30-Sep-97*
COC No.: *5600*
Sample No.: *16333*
Job No.: *2-1000*

Project Name: *PNM Gas Services - Jicarilla A-17 Landfarm*

Project Location: *9709240841; 5pt. Composite*

Sampled by: *RB* Date: *24-Sep-97* Time: *8:41*

Analyzed by: *HR/DC* Date: *26-Sep-97*

Sample Matrix: *Soil*

Laboratory Analysis

Parameter	Results as Received	Unit of Measure	Limit of Quantitation	Unit of Measure
<i>Diesel Range Organics (C10 - C28)</i>	ND	mg/kg	5	mg/kg

ND - Not Detected at Limit of Quantitation

Quality Assurance Report

DRO QC No.: 0555-STD

Continuing Calibration Verification

Parameter	Method Blank	Unit of Measure	True Value	Analyzed Value	RPD	RPD Limit
<i>Diesel Range (C10 - C28)</i>	ND	ppm	200	180	10.5	15%

Matrix Spike

Parameter	1- Percent Recovered	2 - Percent Recovered	Limit	RPD	RPD Limit
<i>Diesel Range (C10-C28)</i>	84	92	(70-130)	9	20%

Method - SW-846 EPA Method 8015A mod. - Nonhalogenated Volatile Hydrocarbons by Gas Chromatography

Approved by: *[Signature]*
Date: *9/30/97*

P.O. BOX 2606 • FARMINGTON, NM 87499