

30-039-21037

UNITED STATES
DEPARTMENT OF THE INTERIOR
GEOLOGICAL SURVEY

APPLICATION FOR PERMIT TO DRILL, DEEPEN, OR PLUG BACK

1a. TYPE OF WORK

DRILL ☒DEEPEN ☐PLUG BACK ☐

b. TYPE OF WELL

OIL
WELL ☐GAS
WELL ☒OTHER ☐SINGLE
ZONE ☒MULTIPLE
ZONE ☐

2. NAME OF OPERATOR

Aztec Oil & Gas Company

3. ADDRESS OF OPERATOR

P. O. Drawer 570, Farmington, New Mexico

4. LOCATION OF WELL (Report location clearly and in accordance with any State requirements.)*

At surface

1780' FNL & 930' FWL

At proposed prod. zone

14. DISTANCE IN MILES AND DIRECTION FROM NEAREST TOWN OR POST OFFICE*

15. DISTANCE FROM PROPOSED*

LOCATION TO NEAREST
PROPERTY OR LEASE LINE, FT.
(Also to nearest drlg. unit line, if any)18. DISTANCE FROM PROPOSED LOCATION*
TO NEAREST WELL, DRILLING, COMPLETED,
OR APPLIED FOR, ON THIS LEASE, FT.

21. ELEVATIONS (Show whether DF, RT, GR, etc.)

6521 GR

16. NO. OF ACRES IN LEASE

160

19. PROPOSED DEPTH

3300

17. NO. OF ACRES ASSIGNED
TO THIS WELL

160 159.77

20. ROTARY OR CABLE TOOLS

Rotary

22. APPROX. DATE WORK WILL START*

23. PROPOSED CASING AND CEMENTING PROGRAM

SIZE OF HOLE	SIZE OF CASING	WEIGHT PER FOOT	SETTING DEPTH	QUANTITY OF CEMENT
12-1/4"	8-5/8"	24#	150	100 sacks
7-7/8"	4-1/2"	15.50#	3300	100 sacks
	1-1/2"	1.7#	3250	

PROPOSE TO:

Drill 12-1/4" hole, set 150' of 8-5/8" casing.

Drill 7-7/8" hole to 3300', run 4-1/2" casing.

Perforate Pictured Cliffs zone.

Sand-water frac with 50,000# of sand and 50,000 gallons of water.

Run 1-1/2" tubing.

Install well head.

IN ABOVE SPACE DESCRIBE PROPOSED PROGRAM: If proposal is to deepen or plug back, give data on present productive zone and proposed new productive zone. If proposal is to drill or deepen directionally, give pertinent data on subsurface locations and measured and true vertical depths. Give blowout preventer program, if any.

24.

SIGNED

(This space for Federal or State office use)

TITLE

District Superintendent

DATE

10-22-74

PERMIT NO.

APPROVAL DATE

APPROVED BY

TITLE

DATE

CONDITIONS OF APPROVAL, IF ANY:

*See Instructions On Reverse Side

NEW MEXICO OIL CONSERVATION COMMISSION
WELL LOCATION AND ACREAGE DEDICATION PLAT

Form 7-17
Supersedes 6-17
Effective 1-1-77

All distances must be from the outer boundaries of the Section.

Lessor Aztec Oil & Gas Company			Lease Arizona Jicarilla "B"		Well No. #7
Section Letter E	Section 4	Township 26N	Range 5W	County Rio Arriba	
Actual Footage Location of Well: 1780 feet from the North line and 930 feet from the West line					
Ground Level Elev. 6521	Producing Formation Pictured Cliffs	Pool Tanapito S RIMCO		Dedicated Acreage: 159.77 160 Acres	

1. Outline the acreage dedicated to the subject well by colored pencil or hachure marks on the plat below.
2. If more than one lease is dedicated to the well, outline each and identify the ownership thereof (both as to working interest and royalty).
3. If more than one lease of different ownership is dedicated to the well, have the interests of all owners been consolidated by communitization, unitization, force-pooling, etc?

☐ Yes ☐ No If answer is "yes," type of consolidation _____

If answer is "no," list the owners and tract descriptions which have actually been consolidated. (Use reverse side of this form if necessary.) _____

No allowable will be assigned to the well until all interests have been consolidated (by communitization, unitization, forced-pooling, or otherwise) or until a non-standard unit, eliminating such interests, has been approved by the Commission.

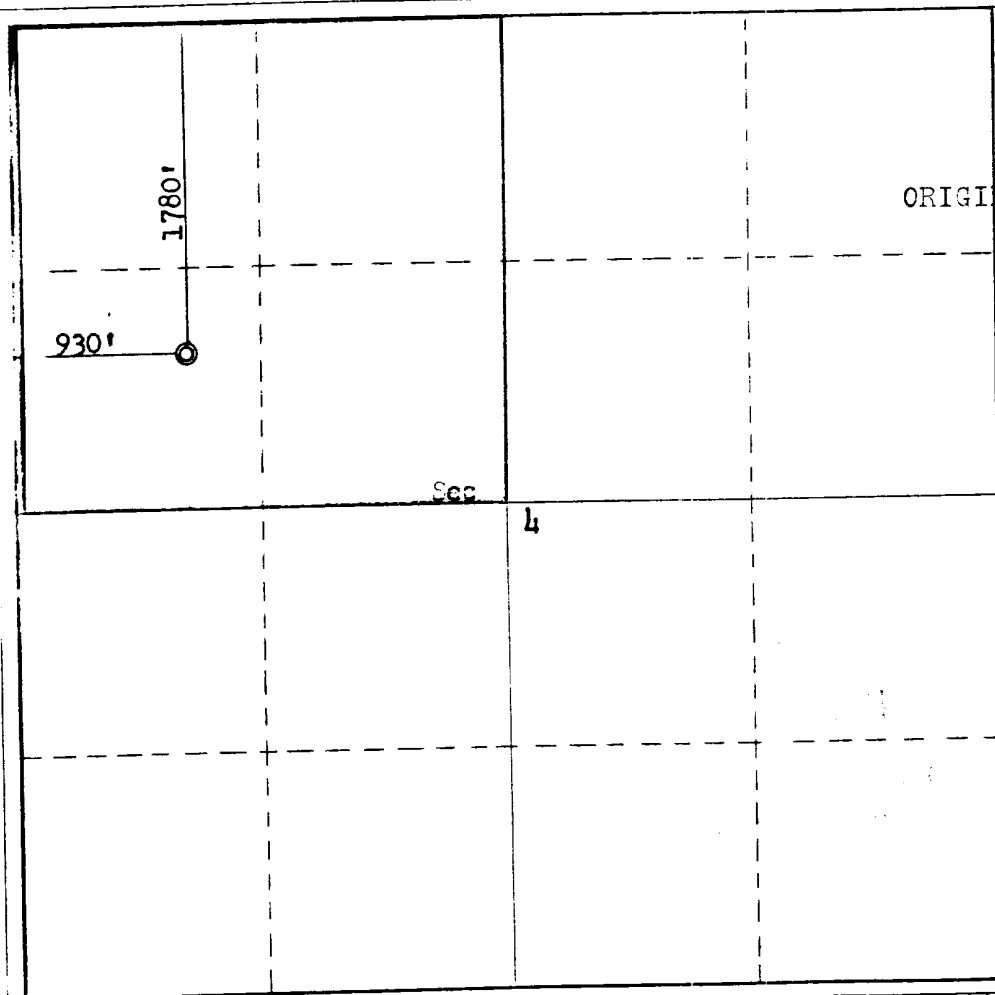

CERTIFICATION

I hereby certify that the information contained herein is true and complete to the best of my knowledge and belief.

ORIGINAL SIGNED BY JOE C. SALMON

Name
Joe C. Salmon
Position
District Superintendent
Company
Aztec Oil & Gas Company
Date
October 22, 1974

I hereby certify that the well location shown on this plat was plotted from field notes of actual surveys made by me or under my supervision, and that the same is true and correct to the best of my knowledge and belief.

Date Surveyed
October 17, 1974
Registered Professional Engineer and/or Land Surveyor
Fred B. Kern, Jr.
Certificate No.
3950

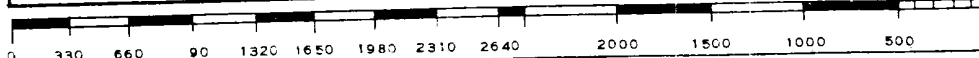

AZTEC OIL & GAS COMPANY

P. O. DRAWER 570
FARMINGTON, NEW MEXICO 87401

October 22, 1974

United States Geological Survey
P. O. Box 1809
Durango, Colorado 81301

Dear Sir:

Aztec Oil & Gas Company proposes to drill its Arizona Jicarilla "B" #7 Tapacitos Pictured Cliffs well located 1780 feet from the North line and 930 feet from the West line of Section 4, Township 26 North, Range 5 West, Rio Arriba County, New Mexico.

Attached are maps showing the following data:

1. Existing roads.
2. Planned access roads.
3. Location of existing wells.
4. Lateral roads to well locations.
5. A map is attached showing the location of the rig, mud tanks, reserve pit, burn pit, pipe racks, etc. The access road and location will be compacted.
6. Waste will be disposed of by being placed in the reserve pit and buried. Some will be burned in burn pit which will be covered after the well has been completed.
7. There will be no camp at or near the proposed well site.
8. There will be no airstrip.
9. The location of tank batteries and flow lines are not presently known. After the well has been drilled and the location has been cleaned this equipment will be installed on the existing location. It is requested that a subsequent map be submitted after determining the exact location.
10. After the well is completed the location will be cleaned and bladed. The reserve pit will be fenced until it has dried and then it will be filled and restored to its natural state. The access road will be left as is for well maintenance.
11. The location falls on a low relief mesa and is relatively flat. Pinon is the predominant vegetation.

Yours very truly,

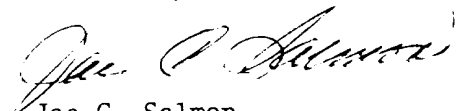

Joe C. Salmon
District Superintendent

JCS/se

AZTEC OIL & GAS COMPANY
 Arizona Jicarilla "B" #7
 1780/N - 930/W, Sec. 4, T26N, R5W
 Rio Arriba County, New Mexico

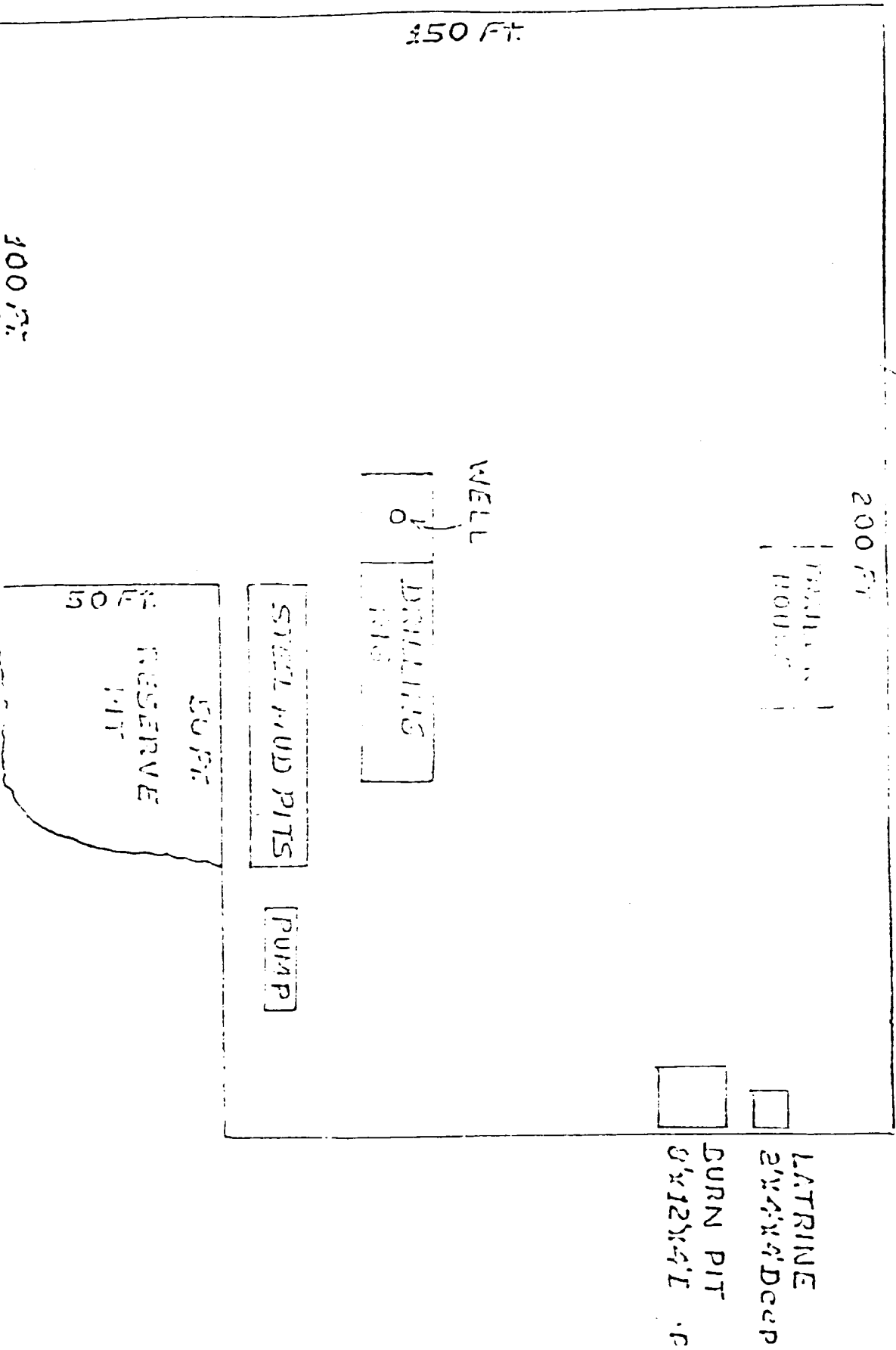



topography by the same methods from aerial photographs taken 1958–1962, 1967–1968, 1969–1970.

167°22'30"

Poly-*o*-ene groups from 1927 North American datum 10 (000) feet grid based on New Mexico coordinate system (vertical coordinate meter linear at Fairview station grid to zone 13, shown in table

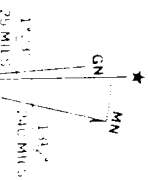

U.S. Navy, 1940-1945. Mr. N. H. Carter
1940-1945. Mr. N. H. Carter

1. *Introduction*

1 LAPIS POINT
4500 / V NL
SCALE 1:4000

THIS MAP COMPLETES WITH NATIONAL MAP ACCORDANCE THE
FOR SALE BY U.S. GEOLOGICAL SURVEY, DENVER, COLORADO 80225, C