

Denny & Faust
 District I
 P.O. Box 189110, Santa Fe, NM
DEPUTY OIL & GAS INSPECTOR
 District II
 P.O. Drawer DD, Artesia, NM 88221
FEB 26 1998
 District III
 1000 Rio Brazos Rd, Aztec, NM 87410

State of New Mexico
 Energy, Minerals and Natural Resources Department

SUBMIT 1 COPY TO
 APPROPRIATE
 DISTRICT OFFICE
 AND 1 COPY TO
 SANTA FE OFFICE

OIL CONSERVATION DIVISION

2040 South Pacheco Street
 Santa Fe, New Mexico 87505

Approved

PIT REMEDIATION AND CLOSURE REPORT

| | | | | | | | | | | |
|---|--|--------------------|-------------|--|------------------------|-------------|----------|-------------------------|-------------|----------|
| Operator: <u>PNM Gas Services (Caulkins)</u> Telephone: <u>324-3764</u> | | | | | | | | | | |
| Address: <u>603 W. Elm Street Farmington, NM 87401</u> | | | | | | | | | | |
| Facility or Well Name: <u>Breec E #99</u> | | | | | | | | | | |
| Location: | Unit <u>J</u> Sec <u>1</u> T <u>26 N</u> R <u>6 W</u> County <u>Rio Arriba</u> | | | | | | | | | |
| Pit Type: | Separator <input checked="" type="checkbox"/> Dehydrator <input type="checkbox"/> Other <input type="checkbox"/> | | | | | | | | | |
| Land Type: | BLM <input checked="" type="checkbox"/> State <input type="checkbox"/> Fee <input type="checkbox"/> Other <input type="checkbox"/> | | | | | | | | | |
| Pit Location: | Pit dimensions: length <u>20</u> width <u>20</u> depth <u>3</u> | | | | | | | | | |
| (Attach diagram) | Reference: wellhead <input checked="" type="checkbox"/> other <input type="checkbox"/> | | | | | | | | | |
| | Footage from reference: <u>65'</u> | | | | | | | | | |
| | Direction from reference: <u>20</u> Degrees <input type="checkbox"/> East <input type="checkbox"/> North <input type="checkbox"/> <input checked="" type="checkbox"/> West <input checked="" type="checkbox"/> South | | | | | | | | | |
| Depth to Ground Water: | <table style="width:100%; border: none;"> <tr> <td style="width: 50%;">Less than 50 feet</td> <td style="width: 20%; text-align: right;">(20 points)</td> <td style="width: 30%;"></td> </tr> <tr> <td>50 feet to 99 feet</td> <td style="text-align: right;">(10 points)</td> <td></td> </tr> <tr> <td>Greater than 100 feet</td> <td style="text-align: right;">(0 points)</td> <td style="text-align: right;"><u>0</u></td> </tr> </table> <small>(Vertical distance from contaminants to seasonal high water elevation of ground water)</small> | Less than 50 feet | (20 points) | | 50 feet to 99 feet | (10 points) | | Greater than 100 feet | (0 points) | <u>0</u> |
| Less than 50 feet | (20 points) | | | | | | | | | |
| 50 feet to 99 feet | (10 points) | | | | | | | | | |
| Greater than 100 feet | (0 points) | <u>0</u> | | | | | | | | |
| Wellhead Protection Area: | <table style="width:100%; border: none;"> <tr> <td style="width: 50%;">Yes</td> <td style="width: 20%; text-align: right;">(20 points)</td> <td style="width: 30%;"></td> </tr> <tr> <td>No</td> <td style="text-align: right;">(0 points)</td> <td style="text-align: right;"><u>0</u></td> </tr> </table> <small>(Less than 200 feet from a private domestic water source, or, less than 1,000 feet from all other water sources)</small> | Yes | (20 points) | | No | (0 points) | <u>0</u> | | | |
| Yes | (20 points) | | | | | | | | | |
| No | (0 points) | <u>0</u> | | | | | | | | |
| Distance to Surface Water: | <table style="width:100%; border: none;"> <tr> <td style="width: 50%;">Less than 200 feet</td> <td style="width: 20%; text-align: right;">(20 points)</td> <td style="width: 30%;"></td> </tr> <tr> <td>200 feet to 1,000 feet</td> <td style="text-align: right;">(10 points)</td> <td></td> </tr> <tr> <td>Greater than 1,000 feet</td> <td style="text-align: right;">(0 points)</td> <td style="text-align: right;"><u>0</u></td> </tr> </table> <small>(Horizontal distance to perennial lakes, ponds, rivers, streams, creeks, irrigation canals and ditches)</small> | Less than 200 feet | (20 points) | | 200 feet to 1,000 feet | (10 points) | | Greater than 1,000 feet | (0 points) | <u>0</u> |
| Less than 200 feet | (20 points) | | | | | | | | | |
| 200 feet to 1,000 feet | (10 points) | | | | | | | | | |
| Greater than 1,000 feet | (0 points) | <u>0</u> | | | | | | | | |
| RANKING SCORE (TOTAL POINTS): | | <u>0</u> | | | | | | | | |

RECEIVED
 NOV - 3 1997
 OIL CON. DIV.
 BPC: 3

Breach E #99

Date Remediation Started: 9/8/97

Date Completed: 9/8/97

Remediation Method: Excavation X

Approx. Cubic Yard 80

(Check all appropriate sections)

Landfarmed X

Amount Landfarmed (cubic yds) 80

Other _____

Remediation Location: Onsite X

Offsite _____

(i.e., landfarmed onsite, name and location of offsite facility)

Backfill Material Location: _____

General Description of Remedial Action:

Excavated contaminated soil to a pit size of 12' X 12' X 15' and landfarmed soil onsite within a bermed area at a depth of 6" to 12". Soil was aerated by disking/plowing until soil met regulatory levels.

Ground Water Encountered: No ✓ Yes _____ Depth _____

Final Pit Closure Sampling:

Sample Location 5 pt. composite - 4 side walls and center of pit bottom.

(if multiple samples, attach sample result and diagram of sample locations and depths.)

Sample depth 12' walls and 15' bottom.

Sample date 9/8/97 Sample time 1:00:00 PM

Sample Results

Benzene (ppm) < 0.0010

Total BTEX (ppm) 0.0040

Field headspace (ppm) _____

TPH (ppm) < 5.00 Method 8015A

Vertical Extent (ft) _____ Risk Assessment form attached Yes _____ No _____

Ground Water Sample: Yes _____ No ✓ (If yes, see attached Groundwater Site Summary Report)

I HEREBY CERTIFY THAT THE INFORMATION ABOVE IS TRUE AND COMPLETE TO THE BEST OF MY KNOWLEDGE AND MY BELIEF

DATE October 27, 1997

SIGNATURE



PRINTED NAME AND TITLE **Denver Bearden Administrator III**

Breach E #99

9-8-97

Caulking Oil

Sec. 1, 26N, 6W, J

start of excavation:

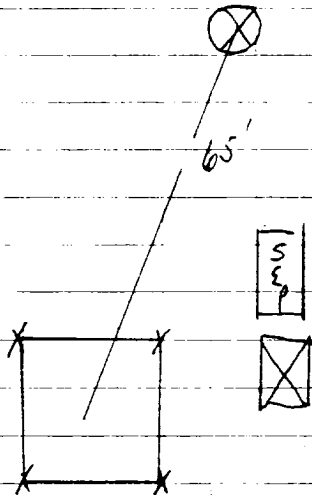

End of excavation:

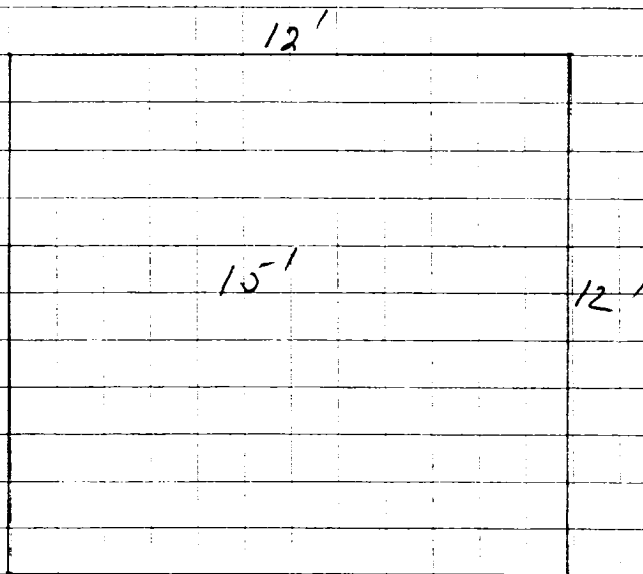

OFF: (505) 325-5667



LAB: (505) 325-1556

ANALYTICAL REPORT

Attn: *Denver Bearden*
 Company: *PNM Gas Services*
 Address: *603 W. Elm*
 City, State: *Farmington, NM 87401*

Date: *16-Sep-97*
 COC No.: *5683*
 Sample No.: *16086*
 Job No.: *2-1000*

Project Name: ***PNM Gas Services - Breech E #99***
 Project Location: ***9709081300; Composite, 4 Walls @ 12' and Bottom @ 15'***
 Sampled by: GC Date: *8-Sep-97* Time: *13:00*
 Analyzed by: DC/HR Date: *15-Sep-97*
 Sample Matrix: *Soil*

Laboratory Analysis

| Parameter | Results as Received | Unit of Measure | Limit of Quantitation | Unit of Measure |
|--|---------------------|-----------------|-----------------------|-----------------|
| <i>Diesel Range Organics (C10 - C28)</i> | ND | mg/kg | 5 | mg/kg |

ND - Not Detected at Limit of Quantitation

Quality Assurance Report

DRO QC No.: 0555-STD

Continuing Calibration Verification

| Parameter | Method Blank | Unit of Measure | True Value | Analyzed Value | RPD | RPD Limit |
|---------------------------------|--------------|-----------------|------------|----------------|-----|-----------|
| <i>Diesel Range (C10 - C28)</i> | ND | ppm | 200 | 197 | 1.5 | 15% |

Matrix Spike

| Parameter | 1- Percent Recovered | 2 - Percent Recovered | Limit | RPD | RPD Limit |
|-------------------------------|----------------------|-----------------------|----------|-----|-----------|
| <i>Diesel Range (C10-C28)</i> | 100 | 94 | (70-130) | 6 | 20% |

Method - SW-846 EPA Method 8015A mod. - Nonhalogenated Volatile Hydrocarbons by Gas Chromatography

Approved by: *[Signature]*
 Date: *9/16/97*

P.O. BOX 2606 • FARMINGTON, NM 87499

TELEPHONE: (505) 325-5667 FAX: (505) 325-1556

OFF: (505) 325-5667



LAB: (505) 325-1556

ANALYTICAL REPORT

Attn: *Denver Bearden*
 Company: *PNM Gas Services*
 Address: *603 W. Elm*
 City, State: *Farmington, NM 87401*

Date: *17-Sep-97*
 COC No.: *5683*
 Sample No.: *16086*
 Job No.: *2-1000*

Project Name: ***PNM Gas Services - Breech E #99***
 Project Location: ***9709081300; Composite, 4 Walls @ 12' and Bottom @ 15'***
 Sampled by: GC Date: *8-Sep-97* Time: *13:00*
 Analyzed by: DC Date: *11-Sep-97*
 Sample Matrix: *Soil*

Laboratory Analysis

| Parameter | Results as Received | Unit of Measure | Limit of Quantitation | Unit of Measure |
|---------------------|---------------------|-----------------|-----------------------|-----------------|
| <i>Benzene</i> | ND | ug/kg | 1 | ug/kg |
| <i>Toluene</i> | ND | ug/kg | 1 | ug/kg |
| <i>Ethylbenzene</i> | 1 | ug/kg | 1 | ug/kg |
| <i>m,p-Xylene</i> | 2 | ug/kg | 1 | ug/kg |
| <i>o-Xylene</i> | 1 | ug/kg | 1 | ug/kg |
| | <i>TOTAL</i> | 4 | | ug/kg |

ND - Not Detected at Limit of Quantitation

Method - SW-846 EPA Method 8020A Aromatic Volatile Organics by Gas Chromatography

Approved by: *[Signature]*
 Date: *9/17/97*

P.O. BOX 2606 • FARMINGTON, NM 87499

TECHNOLOGIES, LTD. SERVING INDUSTRY WITH THE BEST EQUIPMENT

↑
N

9-24-97 - @ 0445

Breach E # 99
Caulkins
(J) 1-26N-6W

Rio Arriba

Sample # 9709240445

Land Farm field head pool - 3 ppm

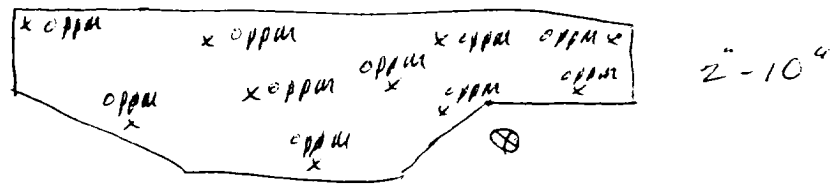



OFF: (505) 325-5667

LAB: (505) 325-1556

ANALYTICAL REPORT

Attn: *Denver Bearden*
 Company: *PNM Gas Services*
 Address: *603 W. Elm*
 City, State: *Farmington, NM 87401*

Date: *30-Sep-97*
 COC No.: *5674*
 Sample No.: *16315*
 Job No.: *2-1000*

Project Name: ***PNM Gas Services - Breech E #99 Landfarm***
 Project Location: ***9709240945; Composite***
 Sampled by: *RH* Date: *24-Sep-97* Time: *9:45*
 Analyzed by: *HR/DC* Date: *29-Sep-97*
 Sample Matrix: *Soil*

Laboratory Analysis

| Parameter | Results as Received | Unit of Measure | Limit of Quantitation | Unit of Measure |
|--|---------------------|-----------------|-----------------------|-----------------|
| <i>Diesel Range Organics (C10 - C28)</i> | ND | mg/kg | 5 | mg/kg |

ND - Not Detected at Limit of Quantitation

Quality Assurance Report

DRO QC No.: 0555-STD

Continuing Calibration Verification

| Parameter | Method Blank | Unit of Measure | True Value | Analyzed Value | RPD | RPD Limit |
|---------------------------------|--------------|-----------------|------------|----------------|-----|-----------|
| <i>Diesel Range (C10 - C28)</i> | ND | ppm | 200 | 182 | 9.4 | 15% |

Matrix Spike

| Parameter | 1- Percent Recovered | 2 - Percent Recovered | Limit | RPD | RPD Limit |
|-------------------------------|----------------------|-----------------------|----------|-----|-----------|
| <i>Diesel Range (C10-C28)</i> | 89 | 98 | (70-130) | 9 | 20% |

Method - *SW-846 EPA Method 8015A mod. - Nonhalogenated Volatile Hydrocarbons by Gas Chromatography*

Approved by: *[Signature]*
 Date: *9/30/97*

P.O. BOX 2606 • FARMINGTON, NM 87499

- THE QUALITY OF OUR ANALYTICAL SERVICES IS OUR TOP PRIORITY -