

*Denny R. Frost*  
DEPUTY OIL & GAS INSPECTOR

District I  
P.O. Box 1980 Hobbs NM  
JUN 23 1998  
District II  
P.O. Drawer DD Artesia NM 88221  
District III  
1000 Rio Brazos Rd. Aztec, NM 87410

State of New Mexico  
Energy, Minerals and Natural Resources Department

OIL CONSERVATION DIVISION

2040 South Pacheco Street  
Santa Fe, New Mexico 87505

SUBMIT 1 COPY TO  
APPROPRIATE  
DISTRICT OFFICE  
AND 1 COPY TO  
SANTA FE OFFICE

PIT REMEDIATION AND CLOSURE REPORT

<b>Operator:</b> PNM Gas Services (Caulkins)		<b>Telephone:</b> 324-3764	
<b>Address:</b> 603 W. Elm Street Farmington, NM 87401			
<b>Facility or Well Name:</b> State A #75			
<b>Location:</b>	Unit <u>E</u>	Sec <u>2</u>	T <u>26 N</u> R <u>6 W</u> County <u>Rio Arriba</u>
<b>Pit Type:</b>	Separator <input checked="" type="checkbox"/>	Dehydrator <input type="checkbox"/>	Other <input type="checkbox"/>
<b>Land Type:</b>	BLM <input checked="" type="checkbox"/>	State <input type="checkbox"/>	Fee <input type="checkbox"/> Other <input type="checkbox"/>
<b>Pit Location:</b>	Pit dimensions: length <u>20</u> width <u>20</u> depth <u>3</u>		
(Attach diagram)	Reference: wellhead <input checked="" type="checkbox"/> other <input type="checkbox"/>		
	Footage from reference: <u>60'</u>		
	Direction from reference: <u>10</u> Degrees <input type="checkbox"/> East <input checked="" type="checkbox"/> North <input type="checkbox"/> South <input checked="" type="checkbox"/> West		
<b>Depth to Ground Water:</b>	Less than 50 feet 50 feet to 99 feet Greater than 100 feet		(20 points) (10 points) (0 points) <u>0</u>
<small>(Vertical distance from contaminants to seasonal high water elevation of ground water)</small>			
<b>Wellhead Protection Area:</b>	Yes No		(20 points) (0 points) <u>0</u>
<small>(Less than 200 feet from a private domestic water source, or, less than 1,000 feet from all other water sources)</small>			
<b>Distance to Surface Water:</b>	Less than 200 feet 200 feet to 1,000 feet Greater than 1,000 feet		(20 points) (10 points) (0 points) <u>0</u>
<b>RANKING SCORE (TOTAL POINTS):</b>			<u>0</u>

State A #75

Date Remediation Started: 9/22/97

Date Completed: 9/22/97

Remediation Method: Excavation ☒

Approx. Cubic Yard 266

(Check all appropriate sections)

Landfarmed ☒

Amount Landfarmed (cubic yds) 266

Other \_\_\_\_\_

Remediation Location:

Onsite ☒

Offsite \_\_\_\_\_

(i.e., landfarmed onsite, name and location of offsite facility)

Backfill Material Location: \_\_\_\_\_

## General Description of Remedial Action:

Excavated contaminated soil to pit size of 20' X 20' X 18' and landfarmed soil onsite within a bermed area at a depth of 6" to 12". Soil was aerated by plowing until soil met regulatory levels.

Ground Water Encountered:

No ☒Yes ☐

Depth \_\_\_\_\_

## Final Pit Closure Sampling:

Sample Location

Bottom of excavation.

(if multiple samples, attach sample result and diagram of sample locations and depths.)

Sample depth

18'

Sample date

9/22/97

Sample time

10:15:00 AM

## Sample Results

Benzene (ppm)

0.4040

Total BTEX (ppm)

13.4870

Field headspace (ppm)

TPH (ppm)

80.00

Method

8015A

Vertical Extent (ft) \_\_\_\_\_

Risk Assessment form attached

Yes ☐No ☐

Ground Water Sample:

Yes ☐No ☒

(If yes, see attached Groundwater Site Summary Report)

I HEREBY CERTIFY THAT THE INFORMATION ABOVE IS TRUE AND COMPLETE TO THE BEST OF MY KNOWLEDGE AND MY BELIEF

DATE: January 27, 1998

SIGNATURE

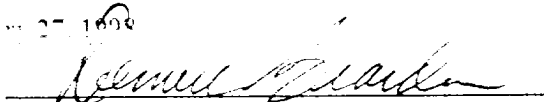

PREPARED BY AND TITLE

 Denver Bearden  
 Administrator III

State A # 75  
Can/Kins Cil  
Sec. 2, 26 N, 6 W, E

9/22/97

Start of excavation:

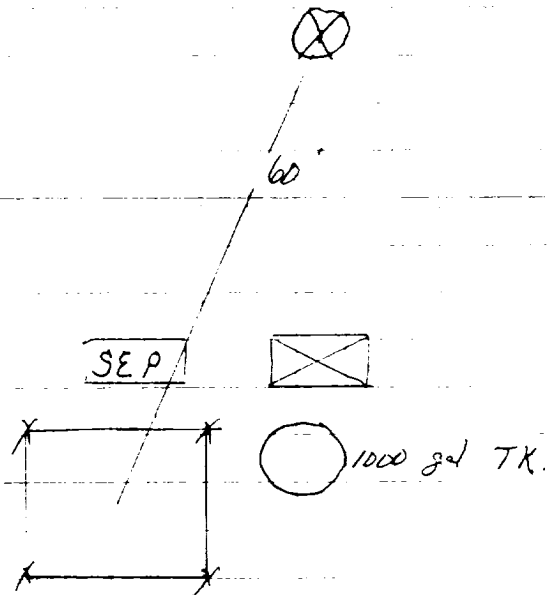

End of excavation:

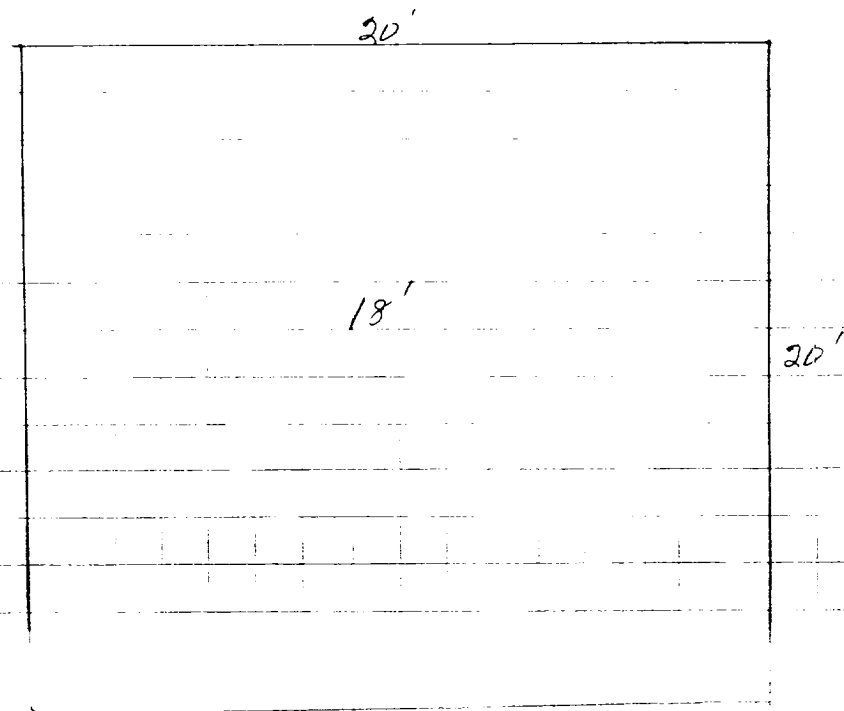

OFF: (505) 325-5667



LAB: (505) 325-1556

**ANALYTICAL REPORT**

Attn: *Denver Bearden*  
 Company: *PNM Gas Services*  
 Address: *603 W. Elm*  
 City, State: *Farmington, NM 87401*

Date: *30-Sep-97*  
 COC No.: *5697*  
 Sample No.: *16280*  
 Job No.: *2-1000*

Project Name: *PNM Gas Services - State A #75*  
 Project Location: *9709221015; Bottom @ 18'*  
 Sampled by: *GC* Date: *22-Sep-97* Time: *10:15*  
 Analyzed by: *HR/DC* Date: *30-Sep-97*  
 Sample Matrix: *Soil*

**Laboratory Analysis**

Parameter	Results as Received	Unit of Measure	Limit of Quantitation	Unit of Measure
<i>Diesel Range Organics (C10 - C28)</i>	<i>80</i>	<i>mg/kg</i>	<i>5</i>	<i>mg/kg</i>

ND - Not Detected at Limit of Quantitation

**Quality Assurance Report**

DRO QC No.: 0555-STD

**Continuing Calibration Verification**

Parameter	Method Blank	Unit of Measure	True Value	Analyzed Value	RPD	RPD Limit
<i>Diesel Range (C10 - C28)</i>	<i>ND</i>	<i>ppm</i>	<i>200</i>	<i>205</i>	<i>2.4</i>	<i>15%</i>

**Matrix Spike**

Parameter	1- Percent Recovered	2 - Percent Recovered	Limit	RPD	RPD Limit
<i>Diesel Range (C10-C28)</i>	<i>86</i>	<i>82</i>	<i>(70-130)</i>	<i>5</i>	<i>20%</i>

Approved by: *[Signature]*  
 Date: *9/30/97*

P.O. BOX 2606 • FARMINGTON, NM 87499

OFF: (505) 325-5667



LAB: (505) 325-1556

### ANALYTICAL REPORT

Attn: *Denver Bearden*  
Company: *PNM Gas Services*  
Address: *603 W. Elm*  
City, State: *Farmington, NM 87401*

Date: *29-Sep-97*  
COC No.: *5697*  
Sample No.: *16280*  
Job No.: *2-1000*

Project Name: *PNM Gas Services - State A #75*  
Project Location: *9709221015; Bottom @ 18'*  
Sampled by: *GC* Date: *22-Sep-97* Time: *10:15*  
Analyzed by: *DC* Date: *26-Sep-97*  
Sample Matrix: *Soil*

#### Laboratory Analysis

Parameter	Results as Received	Unit of Measure	Limit of Quantitation	Unit of Measure
<i>Benzene</i>	<i>404</i>	<i>ug/kg</i>	<i>200</i>	<i>ug/kg</i>
<i>Toluene</i>	<i>1041</i>	<i>ug/kg</i>	<i>200</i>	<i>ug/kg</i>
<i>Ethylbenzene</i>	<i>777</i>	<i>ug/kg</i>	<i>200</i>	<i>ug/kg</i>
<i>m,p-Xylene</i>	<i>8369</i>	<i>ug/kg</i>	<i>200</i>	<i>ug/kg</i>
<i>o-Xylene</i>	<i>2897</i>	<i>ug/kg</i>	<i>200</i>	<i>ug/kg</i>
<i>TOTAL</i>	<i>13487</i>	<i>ug/kg</i>		

ND - Not Detected at Limit of Quantitation

**Method** - *SW-846 EPA Method 8020A Aromatic Volatile Organics by Gas Chromatography*



OFF: (505) 325-5667



LAB: (505) 325-1556

### *ANALYTICAL REPORT*

Attn: *Denver Bearden*  
Company: *PNM Gas Services*  
Address: *603 W. Elm*  
City, State: *Farmington, NM 87401*

Date: *29-Sep-97*  
COC No.: *5697*  
Sample No.: *16281*  
Job No.: *2-1000*

Project Name: *PNM Gas Services - State A #75*

Project Location: *9709221130; Walls @ 15'*

Sampled by: GC Date: *22-Sep-97* Time: *11:30*

Analyzed by: DC Date: *26-Sep-97*

Sample Matrix: *Soil*

#### *Laboratory Analysis*

Parameter	Results as Received	Unit of Measure	Limit of Quantitation	Unit of Measure
<i>Benzene</i>	ND	ug/kg	1	ug/kg
<i>Toluene</i>	ND	ug/kg	1	ug/kg
<i>Ethylbenzene</i>	1	ug/kg	1	ug/kg
<i>m,p-Xylene</i>	9	ug/kg	1	ug/kg
<i>o-Xylene</i>	6	ug/kg	1	ug/kg
<i>TOTAL</i>	16	ug/kg		

ND - Not Detected at Limit of Quantitation

**Method** - SW-846 EPA Method 8020A Aromatic Volatile Organics by Gas Chromatography

↑  
N

10-6-97-@1050

State A #75

Caulkins

(E) 2-27N-6W

Rio Arriba

Sample # 871006105E

Landfarm field head space: 1.4 ppm

2'-12"

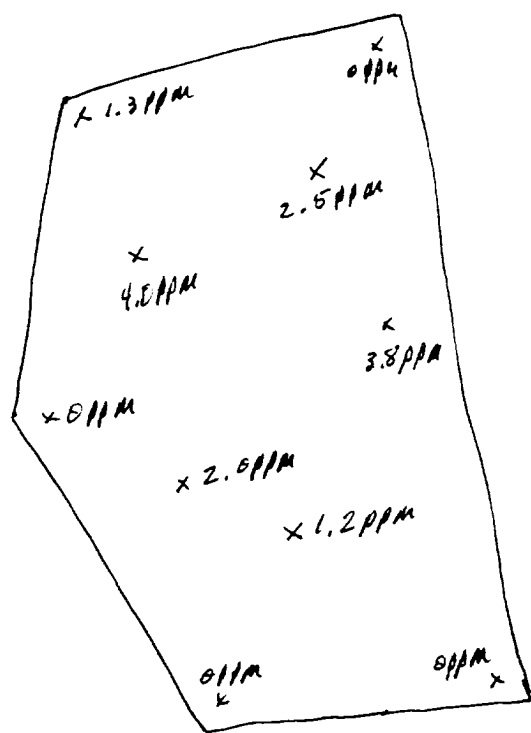

⊗ WH

SEP

MH

1000 gal.



OFF: (505) 325-5667



LAB: (505) 325-1556

## ANALYTICAL REPORT

Attn: *Denver Bearden*  
Company: *PNM Gas Services*  
Address: *603 W. Elm*  
City, State: *Farmington, NM 87401*

Date: *8-Oct-97*  
COC No.: *5663*  
Sample No.: *16517*  
Job No.: *2-1000*

Project Name: *PNM Gas Services - State A #75 Landfarm*  
Project Location: *9710061050; Composite*  
Sampled by: *RH* Date: *6-Oct-97* Time: *10:50*  
Analyzed by: *DC/HR* Date: *7-Oct-97*  
Sample Matrix: *Soil*

### Laboratory Analysis

Parameter	Results as Received	Unit of Measure	Limit of Quantitation	Unit of Measure
<i>Diesel Range Organics (C10 - C28)</i>	<i>385</i>	<i>mg/kg</i>	<i>5</i>	<i>mg/kg</i>

ND - Not Detected at Limit of Quantitation

### Quality Assurance Report

DRO QC No.: 0555-STD

#### Continuing Calibration Verification

Parameter	Method Blank	Unit of Measure	True Value	Analyzed Value	RPD	RPD Limit
<i>Diesel Range (C10 - C28)</i>	<i>ND</i>	<i>ppm</i>	<i>200</i>	<i>214</i>	<i>6.7</i>	<i>15%</i>

#### Matrix Spike

Parameter	1- Percent Recovered	2- Percent Recovered	Limit	RPD	RPD Limit
<i>Diesel Range (C10-C28)</i>	<i>94</i>	<i>86</i>	<i>(70-130)</i>	<i>9</i>	<i>20%</i>

Method: *ASTM D1531*

Approved by: *[Signature]*

Date: *10/6/97*