

UNITED STATES  
DEPARTMENT OF THE INTERIOR  
GEOLOGICAL SURVEY

## APPLICATION FOR PERMIT TO DRILL, DEEPEN, OR PLUG BACK

## 1a. TYPE OF WORK

DRILL ☒DEEPEN ☐PLUG BACK ☐

## b. TYPE OF WELL

OIL  
WELL ☐GAS  
WELL ☒OTHER ☐SINGLE  
ZONE ☒MULTIPLE  
ZONE ☐

## 2. NAME OF OPERATOR

Caulkins Oil Company

## 3. ADDRESS OF OPERATOR

Post Office Box 730, Farmington, New Mexico

## 4. LOCATION OF WELL (Report location clearly and in accordance with any State requirements.)\*

At surface

1450 from the North and 1090 from the East

At proposed prod. zone

Same

## 14. DISTANCE IN MILES AND DIRECTION FROM NEAREST TOWN OR POST OFFICE\*

30 miles Southeast of Blanco, New Mexico

## 15. DISTANCE FROM PROPOSED\*

LOCATION TO NEAREST  
PROPERTY OR LEASE LINE, FT.  
(Also to nearest drlg. unit line, if any)

1450

## 16. NO. OF ACRES IN LEASE

2240

18. DISTANCE FROM PROPOSED LOCATION\*  
TO NEAREST WELL, DRILLING, COMPLETED,  
OR APPLIED FOR, ON THIS LEASE, FT.

460

## 19. PROPOSED DEPTH

3100

## 21. ELEVATIONS (Show whether DF, RT, GR, etc.)

6773 Gr.

17. NO. OF ACRES ASSIGNED  
TO THIS WELL

160 159.97

## 20. ROTARY OR CABLE TOOLS

Rotary

## 22. APPROX. DATE WORK WILL START\*

Apr. 1, 1978

## 23.

## PROPOSED CASING AND CEMENTING PROGRAM

SIZE OF HOLE	SIZE OF CASING	WEIGHT PER FOOT	SETTING DEPTH	QUANTITY OF CEMENT
12 1/4"	8 5/8"	24#	100'	Sufficient to circulate
7 7/8"	4 1/2"	10.5#	3100	425 sacks.

It is proposed to drill well to 3100' using 9# Gel based mud. Drill pipe float will be run in drill string at bit. ES Ind. log will be run in open hole.

Surface formation San Jose. No abnormal pressure or temperature anticipated.

New 4 1/2" 10.5# H-40 casing will be cemented at TD with 325 sacks 50-50 pos followed by 100 sacks Neat cement.

Casing will have rotating scratchers and centralizers through PC zone.

New 1" 10 rd thd. V-55 tubing will be run to top of Pictured Cliffs zone.

A Shaffer 8" Model LWP, 6000# test, 3000# WP blowout preventor will be in use at all times while drilling below 100'. Blowout preventor will be tested at least once during each day.

*Gas is dedicated*  
IN ABOVE SPACE DESCRIBE PROPOSED PROGRAM: If proposal is to deepen or plug back, give data on present productive zone and proposed new productive zone. If proposal is to drill or deepen directionally, give pertinent data on subsurface locations and measured and true vertical depths. Give blowout preventer program, if any.

## 24.

SIGNED

*Richard E. Ely*

TITLE

Superintendent

DATE

Oct. 26, 1977

(This space for Federal or State office use)

PERMIT NO.

APPROVAL DATE

APPROVED BY

TITLE

DATE

CONDITIONS OF APPROVAL, IF ANY:

*OK*

\*See Instructions On Reverse Side

**NEW MEXICO OIL CONSERVATION COMMISSION  
WELL LOCATION AND ACREAGE DEDICATION PLAT**

Form O-102  
Supersedes O-128  
Effective 1-1-65

All distances must be from the outer boundaries of the Section

Lessee <b>Caulkins Oil Company</b>			Lease <b>MM 03551</b>		Well No. <b>70</b>
Section <b>6</b>	Range <b>4</b>	Township <b>26 North</b>	Meridian <b>6 West</b>	County <b>Rio Arriba</b>	
Actual Horizontal Position of Well:					
North <b>1450</b>		East <b>1090</b>			
Ground Level Elev. <b>6773</b>	Section <b>Pictured Cliffs</b>		Pool <b>South Blanco</b>		Certified Acreage <b>160 159.97</b> Acre

1. Outline the acreage dedicated to the subject well by colored pencil or hatchure marks on the plat below.
2. If more than one lease is dedicated to the well, outline each and identify the ownership thereof (both as to working interest and royalty).
3. If more than one lease of different ownership is dedicated to the well, have the interests of all owners been consolidated by communitization, unitization, force-pooling, etc?

☐ Yes    ☐ No    If answer is "yes," type of consolidation \_\_\_\_\_

If answer is "no," list the owners and tract descriptions which have actually been consolidated. (Use reverse side of this form if necessary.) \_\_\_\_\_

No allowable will be assigned to the well until all interests have been consolidated (by communitization, unitization, forced-pooling, or otherwise) or until a non-standard unit, eliminating such interests, has been approved by the Commission.

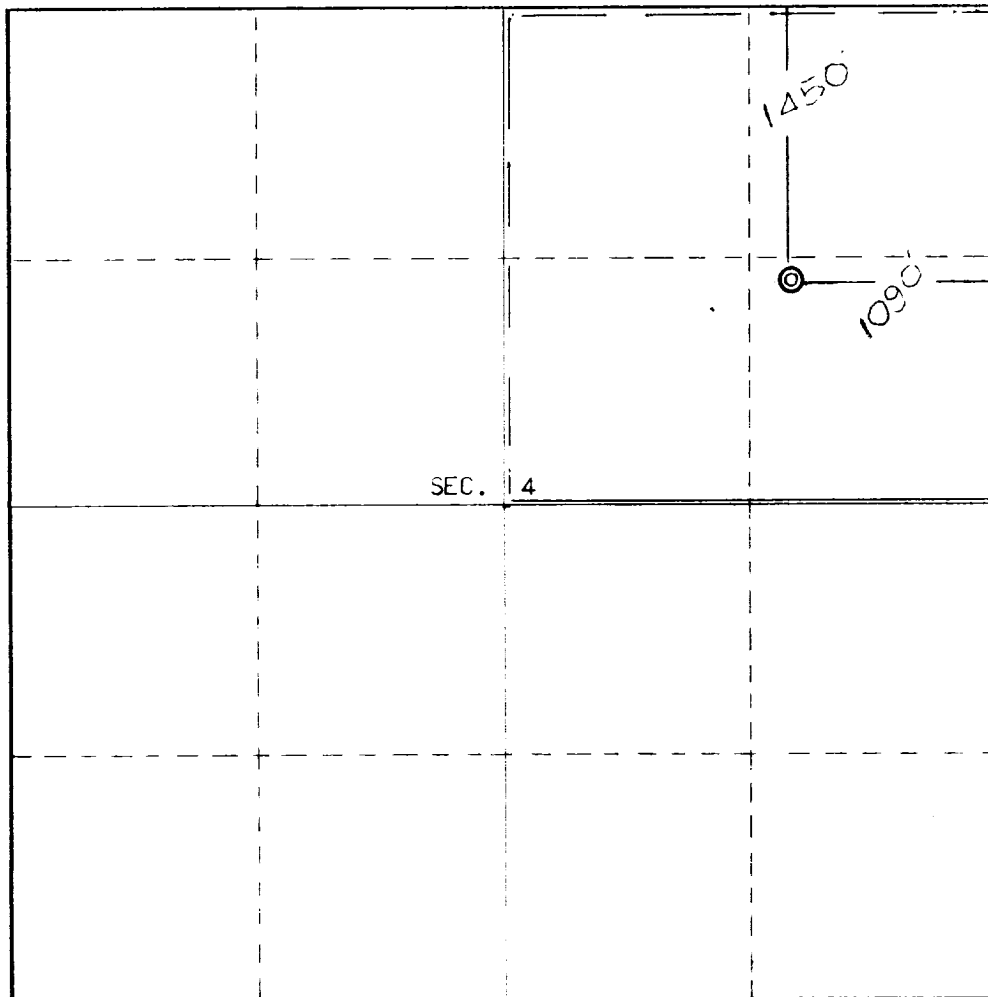

**CERTIFICATION**

I hereby certify that the information contained herein is true and complete to the best of my knowledge and belief.

Name Richard E. Echowawk  
 Position Superintendent  
 Company Caulkins Oil Company  
 Date Oct. 26, 1977

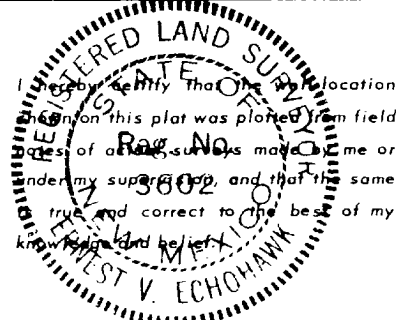

Date Surveyed October 18, 1977  
 Registered Professional Engineer and Land Surveyor  
E. V. Echowawk  
 Certificate No. 3602  
**E.V. Echowawk LS**



# CAULKINS OIL CO.

Post Office Box 780  
Farmington, New Mexico 87401

Date Oct. 26, 1977

United States Dept. of the Interior  
Geological Survey  
Post Office Box 1809  
Durango, Colorado 81301

Gentlemen:

Following is our multi-point development plan for surface use and restoration for our well No. 70, located in NE $\frac{1}{4}$  of Section 4, 26 North, 6 West, Rio Arriba County, New Mexico.

- (1) (3) Existing roads and wells in area shown on Topo Map.
- (2) No New Roads Required. Location will be built in fork of roads and use old pit for reserve pit. Old pit formally used to store water from Caulkins Oil Co. water well # 1.
- (4) No tank battery or production facilities required. Note: Gas Company of New Mexico as purchaser of Gas will apply for permit for pipelines and production equipment.
- (5) Water will be hauled from Caulkins Oil Company well No. 130, located in NW $\frac{1}{4}$  of Section 9, 26 North, 6 West, Rio Arriba County, New Mexico. Water well identified on Topo Map with red Circle. Roads used to transport water also marked in red.
- (6) No construction materials needed for roads or location.
- (7) All cuttings, trash, garbage and etc. will be confined to reserve pit and small fenced pit on location. After rig is moved out, area will be cleaned up, small pit covered and reserve pit fenced until fluid in pit evaporates. Reserve pit will be covered as soon as it dries sufficiently to proceed without damage to outside surface area.
- (8) No Camp required.
- (9) Layout plat for location and reserve pit attached. Location lays on Slight slope. A 1' cut on North side of location will be required to build location. Reserve pit will be built from earth materials, banks will be packed by tractor. Reserve pit will not be lined.
- (10) All disturbed area will be cleaned up then reseeded with BLM recommended seeding program, 2 1/2# Crested Wheatgrass, 2 1/2# Smooth Brome, 1/2# Fourwing Saltbrush (dewinged) and 1# Nomad Alfalfa per acre. Reseeded area will include all location and reserve pit area to within 5' of all facilities. Seeding shall be done between July 15 and Oct. 15. All facilities maintained by Caulkins Oil Company shall be painted Grey, Number 36357.

(11) New location will be on ~~from~~ existing road. Vegetation  
on area to be disturbed for roads and location is Gama and Sage  
Brush

(12) Operator's representative:

Charles E. Verquer, Supt.  
Post Office Box 780  
Farmington, New Mexico 87401

Phone: 325 0481

(13) Certification:

I hereby certify that I, or persons under my direct supervision, have inspected the proposed drillsite and access route; that I am familiar with the conditions which presently exist; that the statements made in this plan are, to the best of my knowledge, true and correct; and, that the work associated with the operations proposed will be performed by CAULKINS OIL COMPANY and its contractors and subcontractors in conformity with this plan and the terms and conditions under which it is approved.

Oct. 26, 1977  
Date

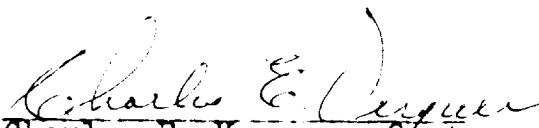
  
Charles E. Verquer, Supt.  
Caulkins Oil Company

