

UNITED STATES
DEPARTMENT OF THE INTERIOR
GEOLOGICAL SURVEY

APPLICATION FOR PERMIT TO DRILL, DEEPEN, OR PLUG BACK

1a. TYPE OF WORK
DRILL ☒ DEEPEN ☐ PLUG BACK ☐

b. TYPE OF WELL
OIL WELL ☐ GAS WELL ☒ OTHER ☐ SINGLE ZONE ☒ MULTIPLE ZONE ☐

2. NAME OF OPERATOR
Consolidated Oil & Gas, Inc.

3. ADDRESS OF OPERATOR
1860 Lincoln Street, Denver, Colorado 80295

4. LOCATION OF WELL (Report location clearly and in accordance with any State requirements.)*
At surface 845' FSL & 1065' FEL
At proposed prod. zone Same as above

14. DISTANCE IN MILES AND DIRECTION FROM NEAREST TOWN OR POST OFFICE*
31 miles northwest of Lindrith, New Mexico

15. DISTANCE FROM PROPOSED* LOCATION TO NEAREST PROPERTY OR LEASE LINE, FT. (Also to nearest drlg. unit line, if any) 845'

16. NO. OF ACRES IN LEASE 320

17. NO. OF ACRES ASSIGNED TO THIS WELL 320

18. DISTANCE FROM PROPOSED LOCATION* TO NEAREST WELL, DRILLING, COMPLETED, OR APPLIED FOR, ON THIS LEASE, FT. 800'

19. PROPOSED DEPTH 6025

20. ROTARY OR CABLE TOOLS Rotary

21. ELEVATIONS (Show whether DF, RT, GR, etc.) 7075 GR

22. APPROX. DATE WORK WILL START* April 1, 1978

5. LEASE DESIGNATION AND SERIAL NO.
Contract #106

6. IF INDIAN, ALLOTTEE OR TRIBE NAME
Jicarilla Apache

7. UNIT AGREEMENT NAME

8. FARM OR LEASE NAME
Jicarilla "B"

9. WELL NO.
1-A

10. FIELD AND POOL, OR WILDCAT
Blanco Mesaverde

11. SEC., T., R., M., OR BLK. AND SURVEY OR AREA
Sec. 26, T26N, R4W

12. COUNTY OR PARISH
Rio Arriba

13. STATE
New Mexico

23. PROPOSED CASING AND CEMENTING PROGRAM

SIZE OF HOLE	SIZE OF CASING	WEIGHT PER FOOT	SETTING DEPTH	QUANTITY OF CEMENT
15"	10-3/4"	40.5#	300'	300 sx. circulated
8-3/4"	7"	23#	3980	250 sx.
6-1/4"	4-1/2"	10.50#	6025	250 sx.

1. Drill 15" hole to 300'+. Set new 10-3/4" casing and circulate cement.
2. WOC 12 hrs. Install double ram hydraulic BOP. Test 10-3/4" to 600 psi.
3. Drill 8-3/4" hole to 3980'+. Set new 7" casing and cement. WOC 12 hrs. and test to 1000 psi.
4. Nipple up for air drilling. Drill 6-1/4" hole with air to 6025' and log.
5. Run and cement 4-1/2" liner.
6. Perforate and stimulate Mesaverde zone.
7. The E/2 of Section 26 is dedicated to this well.
8. This acreage is dedicated to gas contract.

IN ABOVE SPACE DESCRIBE PROPOSED PROGRAM: If proposal is to deepen or plug back, give data on present productive zone and proposed new productive zone. If proposal is to drill or deepen directionally, give pertinent data on subsurface locations and measured and true vertical depths. Give blowout preventer program, if any.

24.

SIGNED D.T. Stogner, Jr. TITLE Chief Drilling and Production Engineer DATE Jan. 4, 1978
(This space for Federal or State office use)

PERMIT NO. _____ APPROVAL DATE _____

APPROVED BY _____ TITLE _____
CONDITIONS OF APPROVAL, IF ANY:

RECEIVED
DATE

JAN 10 1978

U. S. GEOLOGICAL SURVEY
DURANGO, COLO.

**NEW MEXICO OIL CONSERVATION COMMISSION
WELL LOCATION AND ACERAGE DEDICATION PLAT**

All distances must be from the outer boundaries of the Section

Operator CONSOLIDATED OIL AND GAS, INC.			Lease JICARILLA B		Well No. 1 - A
Unit Letter P	Section 26	Township 26 NORTH	Range 4 WEST	County RIO ARriba	
Actual Footage Location of Well:					
845 feet from the SOUTH line and		1065 feet from the EAST line			
Ground Level Elev. 7075	Producing Formation Mesaverde	Pool Blanco	Dedicated Acreage: 320 Acres		

1. Outline the acreage dedicated to the subject well by colored pencil or hatchure marks on the plat below.
2. If more than one lease is dedicated to the well, outline each and identify the ownership thereof (both as to working interest and royalty).
3. If more than one lease of different ownership is dedicated to the well, have the interests of all owners been consolidated by communitization, unitization, force-pooling, etc?

() Yes () No If answer is "yes," type of consolidation

If answer is "no," list the owners and tract descriptions which have actually consolidated. (Use reverse side of this form if necessary.)

No allowable will be assigned to the well until all interests have been consolidated (by communitization, unitization, forced-pooling, or otherwise) or until a non standard unit, eliminating such interests, has been approved by the Commission.

CERTIFICATION

I hereby certify that the information contained herein is true and complete to the best of my knowledge and belief.

D. T. Stogner Jr.

Name
D. T. Stogner, Jr.

Position
Chief Drilling and Production Engineer

Company
Consolidated Oil & Gas, Inc.

Date
January 4, 1978

I hereby certify that the well location shown on this plat was plotted from field notes of actual surveys made by me or under my supervision, and that the same is true and correct to the best of my knowledge and belief.

29 November 1977

Date Surveyed

James P. Leese

Registered Professional Engineer
and/or Land Surveyor **James P. Leese**

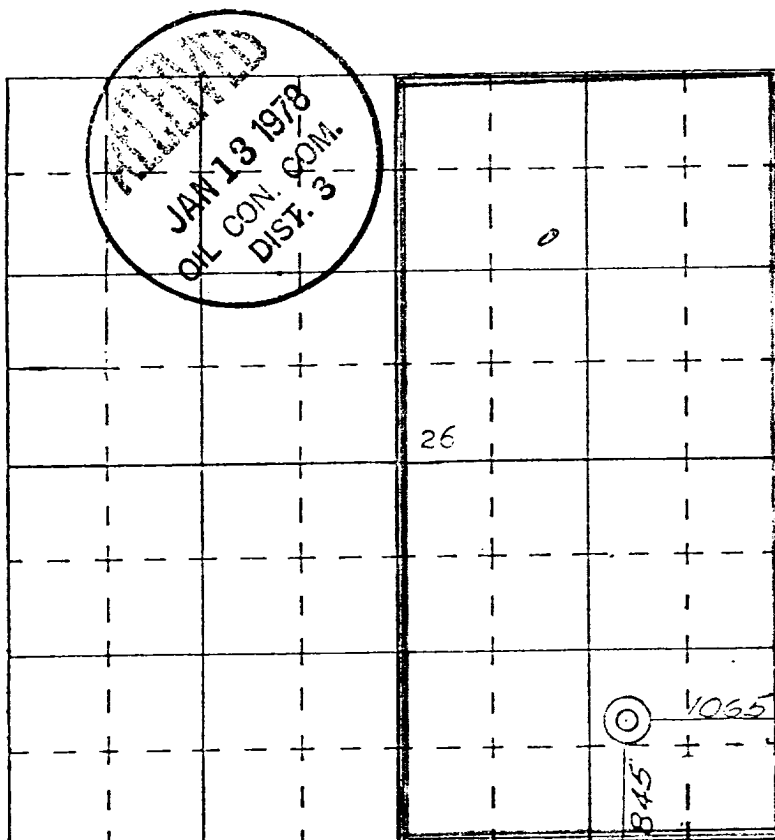

SCALE—4 INCHES EQUALS 1 MILE