

UNITED STATES
DEPARTMENT OF THE INTERIOR
GEOLOGICAL SURVEY

APPLICATION FOR PERMIT TO DRILL, DEEPEN, OR PLUG BACK

1a. TYPE OF WORK DRILL <input checked="" type="checkbox"/> DEEPEN <input type="checkbox"/> PLUG BACK <input type="checkbox"/>		5. LEASE DESIGNATION AND SERIAL NO. NM 03733	
b. TYPE OF WELL OIL WELL <input type="checkbox"/> GAS WELL <input checked="" type="checkbox"/> OTHER <input type="checkbox"/>		6. IF INDIAN, ALLOTTEE OR TRIBE NAME	
2. NAME OF OPERATOR Caulkins Oil Company		7. UNIT AGREEMENT NAME	
3. ADDRESS OF OPERATOR Post Office Box 780, Farmington, New Mexico 87401		8. FARM OR LEASE NAME Breech	
4. LOCATION OF WELL (Report location clearly and in accordance with any State requirements.) At surface 790' from the West and 978' from the North At proposed prod. zone Same		9. WELL NO. 224-A	
14. DISTANCE IN MILES AND DIRECTION FROM NEAREST TOWN OR POST OFFICE* 35 miles Southeast of Blanco, New Mexico		10. FIELD AND POOL, OR WILDCAT Basin Dakota <i>Blanco M.C. Cifers Canyon</i>	
15. DISTANCE FROM PROPOSED* LOCATION TO NEAREST PROPERTY OR LEASE LINE, FT. (Also to nearest drig. unit line, if any)		11. SEC., T., R., M., OR BLK. AND SURVEY OR AREA Sec. 13 26N 7W	
16. NO. OF ACRES IN LEASE 2400		12. COUNTY OR PARISH Rio Arriba	
17. NO. OF ACRES ASSIGNED TO THIS WELL N/320, 160		13. STATE New Mexico	
18. DISTANCE FROM PROPOSED LOCATION* TO NEAREST WELL, DRILLING, COMPLETED, OR APPLIED FOR, ON THIS LEASE, FT.		14. COUNTY OR PARISH Rio Arriba	
19. PROPOSED DEPTH 7300'		15. STATE New Mexico	
20. ROTARY OR CABLE TOOLS Rotary		16. STATE New Mexico	
21. ELEVATIONS (Show whether DF, RT, GR, etc.) 6499 GR.		22. APPROX. DATE WORK WILL START*	

23. PROPOSED CASING AND CEMENTING PROGRAM

SIZE OF HOLE	SIZE OF CASING	WEIGHT PER FOOT	SETTING DEPTH	QUANTITY OF CEMENT
13 3/4"	9 5/8"	36#	300	Sufficient to circulate
8 3/4"	7"	23 and 26#	7300	1250 Sacks

Surface formation San Jose. No abnormal pressure or temperature anticipated.

It is proposed to drill well to 7300' using 9# Gel based mud. Float will be run in Drill Pipe at Bit. ES Ind., Density and Caliper logs will be run in open hole.

New 7" 23# & 26# J-55 Smls Casing will be cemented at TD with sufficient cement to circulate to surface. Pipe will be cemented in 3 stages. Casing will have rotating scratchers over Pictured Cliffs, Chacra, Mesa Verde and Dakota Zones. Stage tools will be run below base of Point Lookout and below base of Pictured Cliffs sands. Centralizers and cement baskets will also be run on casing thru pay zones.

A Shaffer 10" Model LWP, 6000# test blowout preventor will be in use at all times while drilling and cementing. Blowout prevntor will be tested each day.

(over)

gas is liberated

IN ABOVE SPACE DESCRIBE PROPOSED PROGRAM: If proposal is to deepen or plug back, give data on present productive zone and proposed new productive zone. If proposal is to drill or deepen directionally, give pertinent data on subsurface locations and measured and true vertical depths. Give blowout preventer program, if any.

24. SIGNED Charles E. Vergara TITLE Superintendent DATE 1-10-79
(This space for Federal or State office use)

PERMIT NO. _____ APPROVAL DATE _____

APPROVED BY _____ TITLE _____

CONDITIONS OF APPROVAL, IF ANY:

ok Smith

*See Instructions On Reverse Side

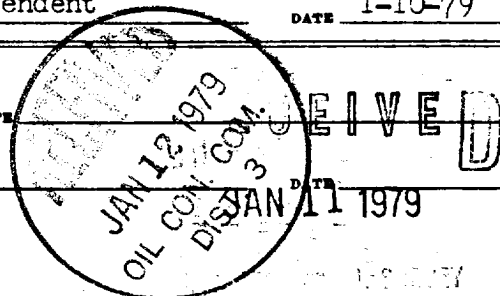

Instructions

General: This form is designed for submitting proposals to perform certain well operations, as indicated, on all types of lands and leases for appropriate action by either a Federal or a State agency, or both, pursuant to applicable Federal and/or State laws and regulations. Any necessary special instructions concerning the use of this form and the number of copies to be submitted, particularly with regard to local, area, or regional procedures and practices, either are shown below or will be issued by, or may be obtained from, the local Federal and/or State office.

Item 1: If the proposal is to redrill to the same reservoir at a different subsurface location or to a new reservoir, use this form with appropriate notations. Consult applicable State or Federal regulations concerning subsequent work proposals or reports on the well.

Item 4: If there are no applicable State requirements, locations on Federal or Indian land should be described in accordance with Federal requirements. Consult local State or Federal office for specific instructions.

Item 14: Needed only when location of well cannot readily be found by road from the land or lease description. A plat, or plats, separate or on this reverse side, showing the roads to, and the surveyed location of, the well, and any other required information, should be furnished when required by Federal or State agency offices.

Items 15 and 18: If well is to be, or has been directionally drilled, give distances for subsurface location of hole in any present or objective production zone.

Item 22: Consult applicable Federal or State regulations, or appropriate officials, concerning approval of the proposal before operations are started.

It is proposed to run New 2 3/8" tubing to Dakota zone with packer set between Mesa Verde zone and Dakota zone.

2 3/8" EUE tubing will be run to Mesa Verde for Mesa Verde, Chacra and Pictured Cliffs Production.

Completion of this well as shown above subject to approval by New Mexico Oil Conservation Commission for commingling of Mesa Verde, Chacra and Pictured Cliffs in wellbore. If commingling denied well will be completed as Mesa Verde - Dakota Dual.

All zones to be completed will be fractured to stimulate production.

**NEW MEXICO OIL CONSERVATION COMMISSION
WELL LOCATION AND ACREAGE DEDICATION PLAT**

Form C-102
Supersedes C-128
Effective 1-1-65

All distances must be from the outer boundaries of the Section.

Operator Caulkins Oil Company			Lease NM 03733		Well No. 224 A ✓
Unit Letter D	Section 13	Township 46 North	Range 7 West	County Rio Arriba ✓	
Actual Footage Location of Well: 978 feet from the North line and 790 feet from the West line					
Ground Level Elev. 6499	Producing Formation Dakota		Pool Basin Dakota	Dedicated Acreage: 320 Acres	

1. Outline the acreage dedicated to the subject well by colored pencil or hachure marks on the plat below.
2. If more than one lease is dedicated to the well, outline each and identify the ownership thereof (both as to working interest and royalty).
3. If more than one lease of different ownership is dedicated to the well, have the interests of all owners been consolidated by communitization, unitization, force-pooling, etc?

☐ Yes ☐ No If answer is "yes," type of consolidation _____

If answer is "no," list the owners and tract descriptions which have actually been consolidated. (Use reverse side of this form if necessary.) _____

No allowable will be assigned to the well until all interests have been consolidated (by communitization, unitization, forced-pooling, or otherwise) or until a non-standard unit, eliminating such interests, has been approved by the Commission.

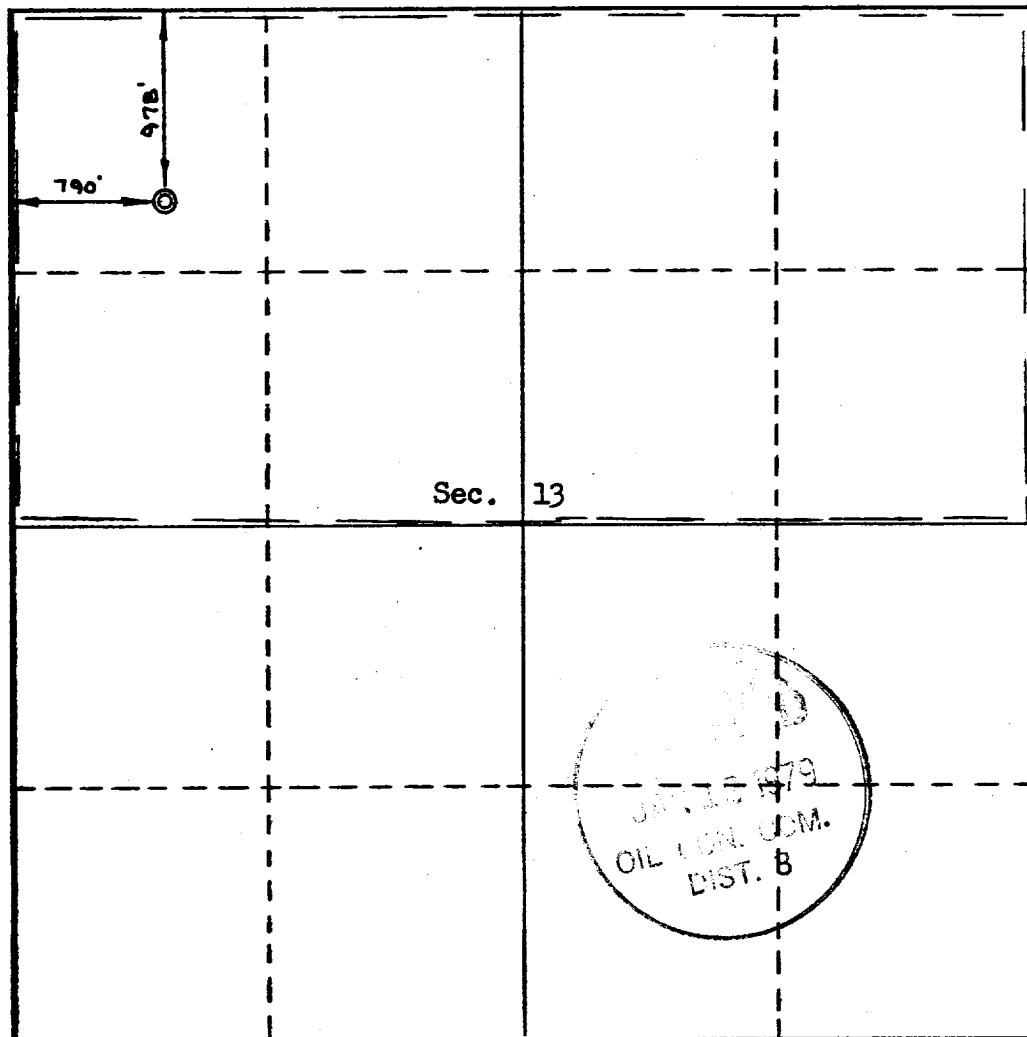

CERTIFICATION

I hereby certify that the information contained herein is true and complete to the best of my knowledge and belief.

Name Charles E. Vesper
Position Superintendent
Company Caulkins Oil Company
Date 1-10-79

I hereby certify that the location shown on this plat was plotted from field notes of actual surveys made by me or under my supervision, and that the same is true and correct to the best of my knowledge and belief.

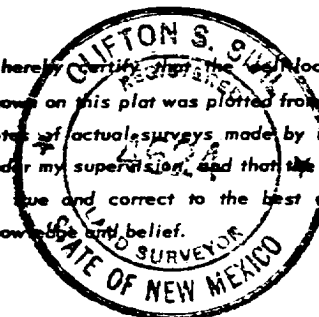

Date Surveyed
December 29, 1978
Registered Professional Engineer
and/or Land Surveyor

Certificate No. 4624
Clifton S. Sivil LS

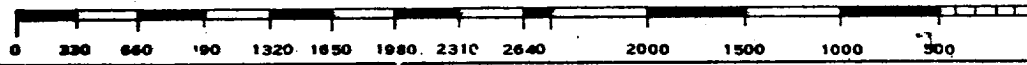

**NEW MEXICO OIL CONSERVATION COMMISSION
WELL LOCATION AND ACREAGE DEDICATION PLAT**

Form C-102
Supersedes C-128
Effective 1-1-65

All distances must be from the outer boundaries of the Section.

Operator Caulkins Oil Company			Lease Nm 03733		Well No. 224 A
Unit Letter D	Section 13	Township 46 North	Range 7 West	County Rio Arriba	
Actual Footage Location of Well: 978 feet from the North line and 790 feet from the West line					
Ground Level Elev: 6499	Producing Formation Mesa Verde		Pool Blanco Mesa Verde		Dedicated Acreage: Infil 320 Acres

1. Outline the acreage dedicated to the subject well by colored pencil or hachure marks on the plat below.
2. If more than one lease is dedicated to the well, outline each and identify the ownership thereof (both as to working interest and royalty).
3. If more than one lease of different ownership is dedicated to the well, have the interests of all owners been consolidated by communitization, unitization, force-pooling, etc?

☐ Yes ☐ No If answer is "yes," type of consolidation _____

If answer is "no," list the owners and tract descriptions which have actually been consolidated. (Use reverse side of this form if necessary.) _____

No allowable will be assigned to the well until all interests have been consolidated (by communitization, unitization, forced-pooling, or otherwise) or until a non-standard unit, eliminating such interests, has been approved by the Commission.

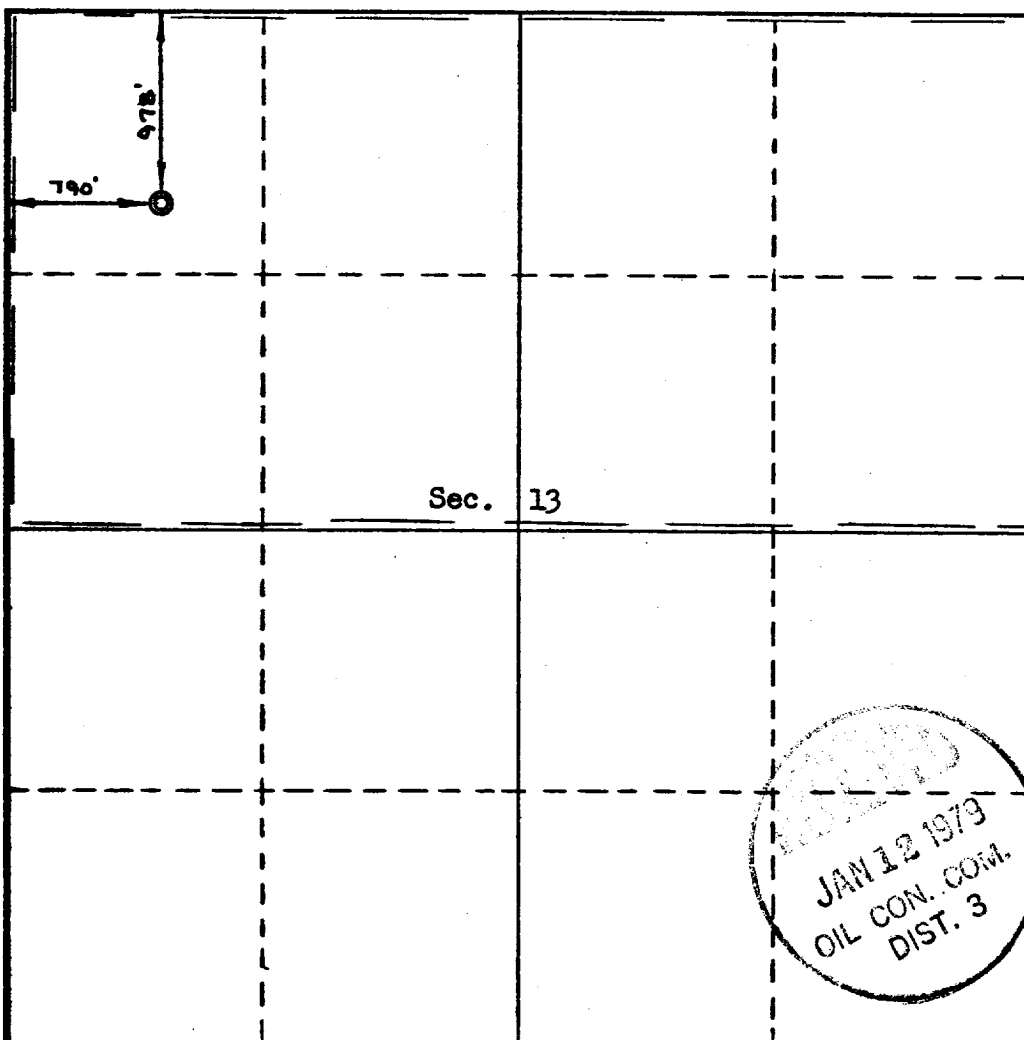

CERTIFICATION

I hereby certify that the information contained herein is true and complete to the best of my knowledge and belief.

Name Charles E. Vergara

Position
Superintendent

Company
Caulkins Oil Company

Date
1-10-79

I hereby certify that the well location shown on this plat was plotted from field notes of actual surveys made by me or under my supervision, and that the same is true and correct to the best of my knowledge and belief.

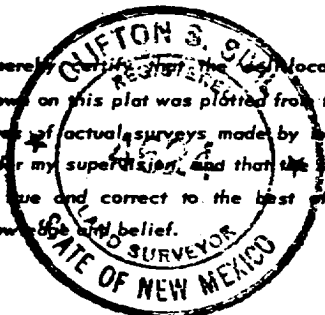

Date Surveyed
December 29, 1978

Registered Professional Engineer and/or Land Surveyor

Certificate No. **4624**
Clifton S. Sivil LS

0 200 400 600 800 1000 1200 1400 1600 1800 2000 2200 2400 2600 2800 3000 3200 3400 3600 3800 4000

**NEW MEXICO OIL CONSERVATION COMMISSION
WELL LOCATION AND ACREAGE DEDICATION PLAT**

Form C-102
Supersedes C-128
Effective 1-1-65

All distances must be from the outer boundaries of the Section.

Operator Caulkins Oil Company			Lease NM 03733		Well No. 224 A
Unit Letter D	Section 13	Township 46 North	Range 7 West	County Rio Arriba	
Actual Footage Location of Well: 978 feet from the North line and 790 feet from the West line					
Ground Level Elev. 6499	Producing Formation Chacra		Pool Otero Chacra		Dedicated Acreage: 160 Acres

1. Outline the acreage dedicated to the subject well by colored pencil or hachure marks on the plat below.
2. If more than one lease is dedicated to the well, outline each and identify the ownership thereof (both as to working interest and royalty).
3. If more than one lease of different ownership is dedicated to the well, have the interests of all owners been consolidated by communitization, unitization, force-pooling, etc?

☐ Yes ☐ No If answer is "yes," type of consolidation _____

If answer is "no," list the owners and tract descriptions which have actually been consolidated. (Use reverse side of this form if necessary.) _____

No allowable will be assigned to the well until all interests have been consolidated (by communitization, unitization, forced-pooling, or otherwise) or until a non-standard unit, eliminating such interests, has been approved by the Commission.

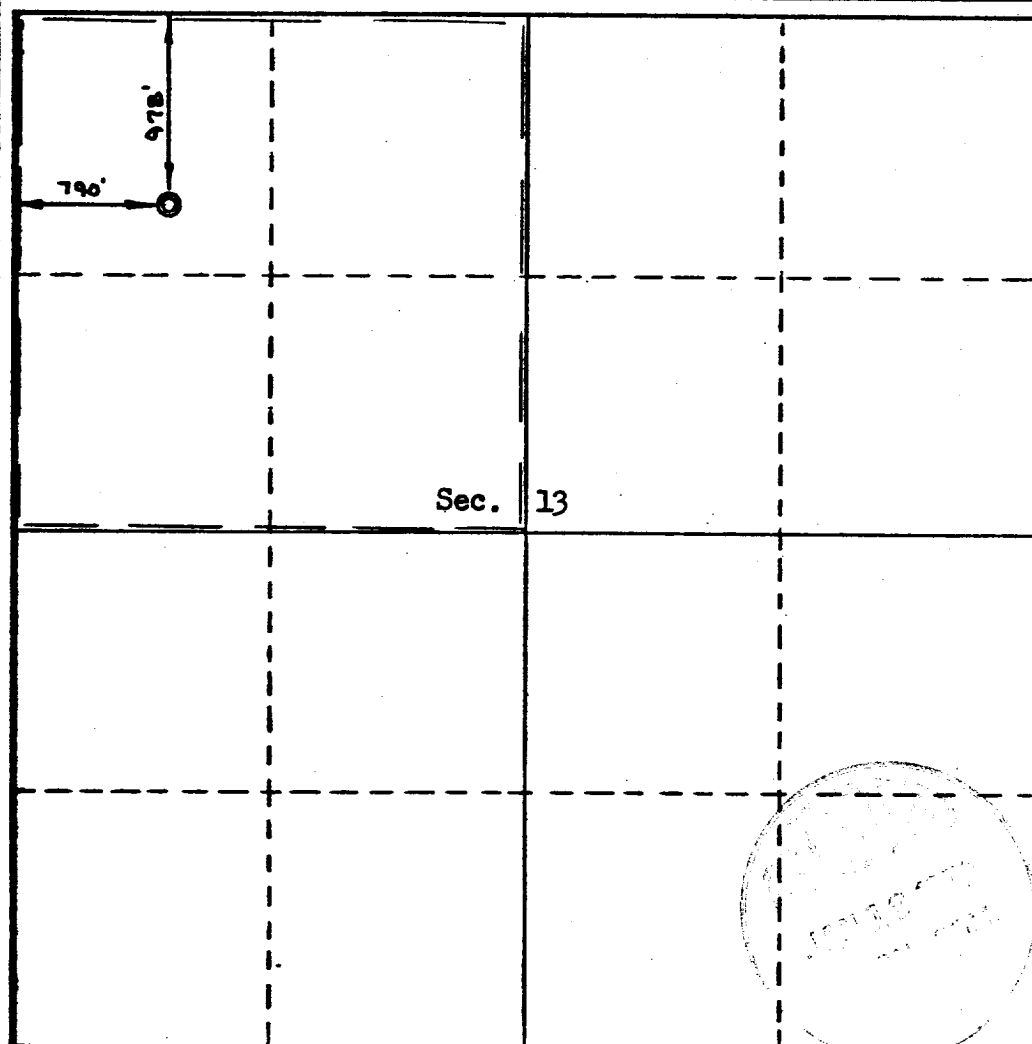

CERTIFICATION

I hereby certify that the information contained herein is true and complete to the best of my knowledge and belief.

Name: Charles E. Virguez
 Position: Superintendent
 Company: Caulkins Oil Company
 Date: 1-1079

I hereby certify that the location shown on this plat was plotted from field notes of actual surveys made by me or under my supervision, and that the same is true and correct to the best of my knowledge and belief.

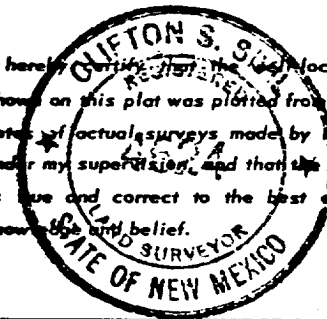

Date Surveyed: December 29, 1978
 Registered Professional Engineer and/or Land Surveyor

Certificate No. 4624
Clifton S. Sivil IS

CAULKINS OIL CO.

Post Office Box 780
Farmington, New Mexico 87401

Date January 10, 1979

United States Dept. of the Interior
Geological Survey
Post Office Box 1809
Durango, Colorado 81301

Gentlemen:

Following is our multi-point development plan for surface use and restoration for our well No. 224 A, located in NW $\frac{1}{4}$ of Section 13, 26 North, 7 West, Rio Arriba County, New Mexico.

(1) (3) Existing roads and wells in area shown on Topo Map.

(2) No new road required for this location.

(4) A 210 bbl. stock tank and water, oil and gas separator will be set on location approx. 100' from well. Oil produced will be hauled as needed to pipeline delivery tank located in NW $\frac{1}{4}$ of Section 9, 26 North 6West, Rio Arriba County, New Mexico. Gas Company of New Mexico will purchase gas and furnish all facilities downstream of oil, water and gas separator. A pit 12' X 12' X 4' will be built next to separator and tank, then firewall will be built around tank, pit and separator. Fence will be built outside of firewall. Note: Permission for unlined pit will be requested after well completed and daily water production determined.

(5) Water will be hauled from Caulkins Oil Company water well No. 130, located in NW $\frac{1}{4}$ of Section 9 26N 6W, Rio Arriba County, New Mexico. Water well identified on topo map with red circle. Roads used to transport water also marked in red.

(6)(8) No camp or construction materials needed for roads or location.

(9) Layout plat for location and reserve pit attached. Location lays on 5% slope. A 5' cut on East side of location will be required to build location. Reserve pit will be built from earth materials, banks will be packed by tractor. Reserve pit will not be lined.

(10) All disturbed area will be cleaned up then reseeded with 2 1/2# Crested Wheatgrass, 2 1/2# Smooth Brome, 1/2# Fourwing Saltbrush (dewinged) and 1# Nomad Alfalfa per acre. Reseeded area will include all location and reserve pit area to within 5' of all facilities. Seeding shall be done between July 15 and October 15. All facilities maintained by Caulkins Oil Company shall be painted Grey, number 36357.

(11) New location will be on ~~from~~ existing road. Vegetation on area to be disturbed for roads and location is Sage Brush, Blue Gama Juniper and Cedar.

(12) Operator's representative:

Charles E. Verquer, Supt.
Post Office Box 780
Farmington, New Mexico 87401

Phone: 325 0481

(13) Certification:

I hereby certify that I, or persons under my direct supervision, have inspected the proposed drillsite and access route; that I am familiar with the conditions which presently exist; that the statements made in this plan are, to the best of my knowledge, true and correct; and, that the work associated with the operations proposed will be performed by CAULKINS OIL COMPANY and its contractors and subcontractors in conformity with this plan and the terms and conditions under which it is approved.

January 10, 1979
Date

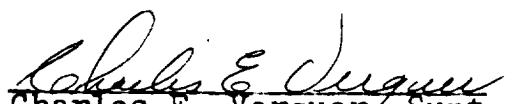
Charles E. Verquer, Supt.
Caulkins Oil Company