

UNITED STATES
DEPARTMENT OF THE INTERIOR
GEOLOGICAL SURVEY

APPLICATION FOR PERMIT TO DRILL, DEEPEN, OR PLUG BACK

1a. TYPE OF WORK

DRILL ☒DEEPEN ☐PLUG BACK ☐

b. TYPE OF WELL

OIL
WELL ☐GAS
WELL ☒

OTHER

SINGLE
ZONE ☐MULTIPLE
ZONE ☒

2. NAME OF OPERATOR

Consolidated Oil & Gas, Inc.

3. ADDRESS OF OPERATOR

1860 Lincoln Street, Denver, Colorado 80295

4. LOCATION OF WELL (Report location clearly and in accordance with any State requirements.*)

At surface 1120' FSL & 980' FWL

At proposed prod. zone Same

14. DISTANCE IN MILES AND DIRECTION FROM NEAREST TOWN OR POST OFFICE*

4.8 miles NW of Ojito, New Mexico

15. DISTANCE FROM PROPOSED*

LOCATION TO NEAREST
PROPERTY OR LEASE LINE, FT.
(Also to nearest drig. unit line, if any)

980

16. NO. OF ACRES IN LEASE

640.00

18. DISTANCE FROM PROPOSED LOCATION*

TO NEAREST WELL, DRILLING, COMPLETED,
OR APPLIED FOR, ON THIS LEASE, FT.

220

19. PROPOSED DEPTH

8360'

17. NO. OF ACRES ASSIGNED
TO THIS WELL

160 7/320.80

20. ROTARY OR CABLE TOOLS

Rotary

21. ELEVATIONS (Show whether DF, RT, GR, etc.)

7149 GR

22. APPROX. DATE WORK WILL START*

July 1, 1979

23.

PROPOSED CASING AND CEMENTING PROGRAM

SIZE OF HOLE	SIZE OF CASING	WEIGHT PER FOOT	SETTING DEPTH	QUANTITY OF CEMENT
15"	10-3/4"	40.5#	300'	Circ (approx 300 sx.)
9-7/8"	7-5/8"	26.4#	4200'	250 sx
6-3/4"	5-1/2"	15.5#	8360'	250 sx

Drill 15" hole to \pm 300'. Set 10-3/4" casing. Circulate cement to surface.

WOC 12 hrs.

Install blowout preventers. Pressure test surface casing and blowout preventer to 1000#.

Drill 9-7/8" hole to approximately 300' below top of Pictured Cliff or to approximately 4200' with fresh water gel mud. Log. Run 7-5/8" casing and cement with approximately 250 sx. WOC 12 hrs.

Air or gas drill 6-3/4" hole to 8360', log.

Set 5-1/2" casing with approximately 250 sx.

Selectively perforate and stimulate the Gallup and Dakota and ~~complete~~ as required by rules and regulations.*gas is liberated*

IN ABOVE SPACE DESCRIBE PROPOSED PROGRAM: If proposal is to deepen or plug back, give data on present productive zone and proposed new productive zone. If proposal is to drill or deepen directionally, give pertinent data on subsurface locations and measured and true vertical depths. Give blowout preventer program, if any.

24.

SIGNED

TITLE Senior Production Engr.

DATE

6-19-79

(This space for Federal or State office use)

PERMIT NO.

APPROVAL DATE

APPROVED BY

TITLE

DATE

CONDITIONS OF APPROVAL, IF ANY:

ok Frank

30-039-22100

5. LEASE DESIGNATION AND SERIAL NO.

Contract #101

6. IF INDIAN, ALLOTTEE OR TRIBE NAME

Jicarilla Apache

7. UNIT AGREEMENT NAME

8. FARM OR LEASE NAME

Huron

9. WELL NO.

2-E

10. FIELD AND POOL, OR WILDCAT

BS Mesa Gallup/Bsn Dakota

11. SEC., T., R., M., OR BLK.
AND SURVEY OR AREA

'M' Sec 2, T26N, R4W NMPM

12. COUNTY OR PARISH

Rio Arriba

New Mexico

NEW MEXICO OIL CONSERVATION COMMISSION
WELL LOCATION AND ACREAGE DEDICATION PLAT

Form C-102
Supersedes C-128
Effective 1-1-65

All distances must be from the outer boundaries of the Section.

Operator CONSOLIDATED OIL AND GAS, INC.			Lease HURON		Well No. 2-E
Unit Letter M	Section 2	Township 26 NORTH	Range 4 WEST	County RIO ARriba	
Actual Footage Location of Well: 1120 feet from the SOUTH line and 980 feet from the WEST line					
Ground Level Elev. 7149	Producing Formation Gallup	Pool BS Mesa Gallup			Dedicated Acreage: 160.00 Acres

1. Outline the acreage dedicated to the subject well by colored pencil or hatchure marks on the plat below.
2. If more than one lease is dedicated to the well, outline each and identify the ownership thereof (both as to working interest and royalty).
3. If more than one lease of different ownership is dedicated to the well, have the interests of all owners been consolidated by communitization, unitization, force-pooling, etc?

☒ Yes ☐ No If answer is "yes," type of consolidation Communitization

If answer is "no," list the owners and tract descriptions which have actually been consolidated. (Use reverse side of this form if necessary.)

No allowable will be assigned to the well until all interests have been consolidated (by communitization, unitization, forced-pooling, or otherwise) or until a non-standard unit, eliminating such interests, has been approved by the Commission.

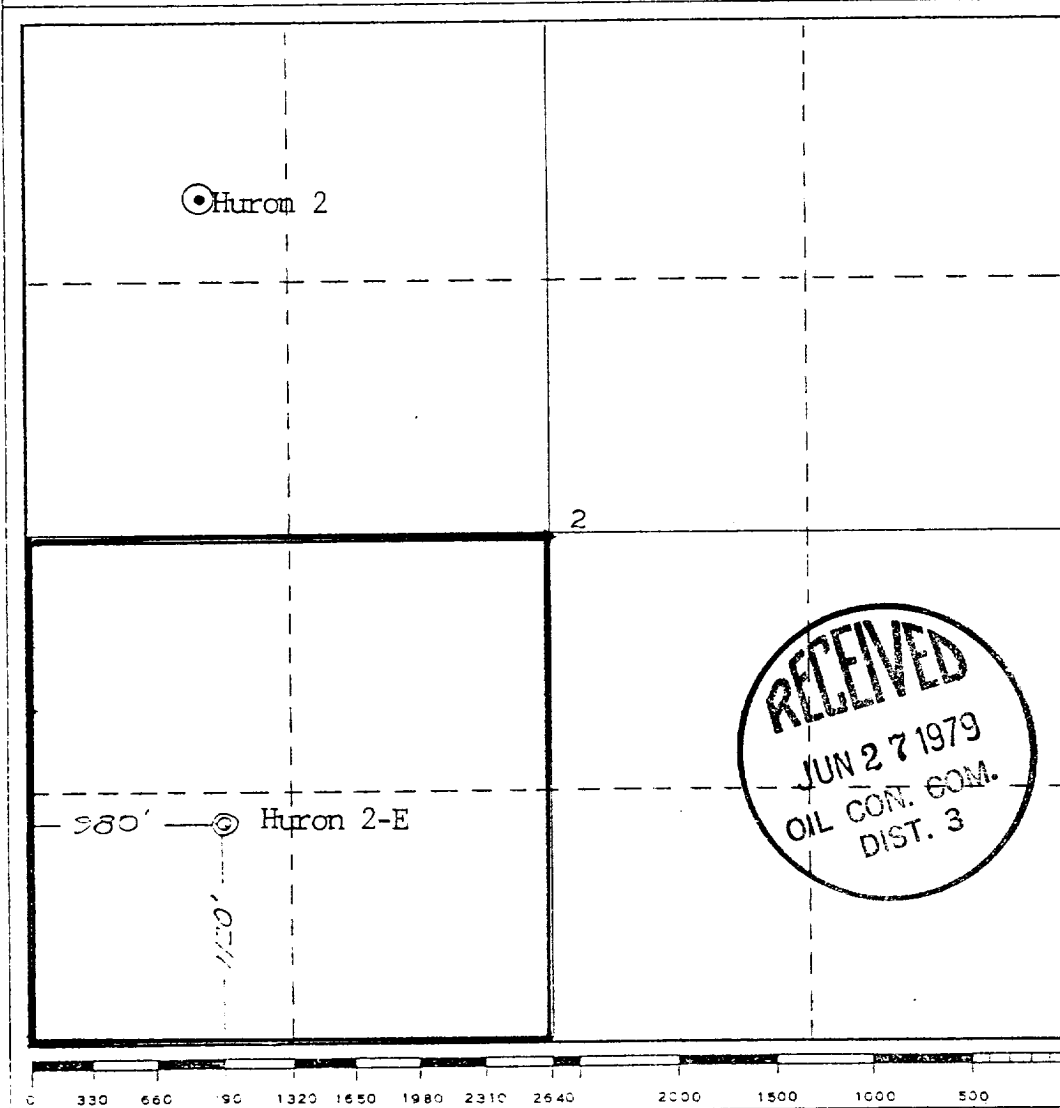

CERTIFICATION

I hereby certify that the information contained herein is true and complete to the best of my knowledge and belief.

C. M. Parham

Name
C. M. Parham

Position
Senior Production Engineer

Company
Consolidated Oil & Gas, Inc.

Date

I hereby certify that the information shown on this plat was plotted from notes of a survey made by me under my supervision, and that the same is true and correct to the best of my knowledge and belief.

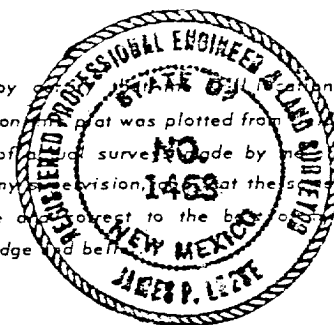

Date Surveyed
28 May 1979

Registered Professional Engineer
and/or Land Surveyor

James P. Leese
James P. Leese

Certificate No. **1463**

NEW MEXICO OIL CONSERVATION COMMISSION
WELL LOCATION AND ACREAGE DEDICATION PLAT

Form C-102
Supersedes C-128
Effective 1-1-65

All distances must be from the outer boundaries of the Section.

Operator CONSOLIDATED OIL AND GAS, INC.		Lease HURON		Well No. 2-E	
Unit Letter M	Section 2	Township 26 NORTH	Range 4 WEST	County RIO ARriba	
Actual Footage Location of Well: 1120 feet from the SOUTH line and 980 feet from the WEST line					
Ground Level Elev 7149	Producing Formation Dakota		Pool Basin Dakota	Dedicated Acreage: 320.80 Acres	

1. Outline the acreage dedicated to the subject well by colored pencil or hachure marks on the plat below.
2. If more than one lease is dedicated to the well, outline each and identify the ownership thereof (both as to working interest and royalty).
3. If more than one lease of different ownership is dedicated to the well, have the interests of all owners been consolidated by communitization, unitization, force-pooling, etc?

☒ Yes ☐ No If answer is "yes" type of consolidation Communitization

If answer is "no" list the owners and tract descriptions which have actually been consolidated. (Use reverse side of this form if necessary.)

No allowable will be assigned to the well until all interests have been consolidated (by communitization, unitization, forced-pooling, or otherwise) or until a non-standard unit, eliminating such interests, has been approved by the Commission.

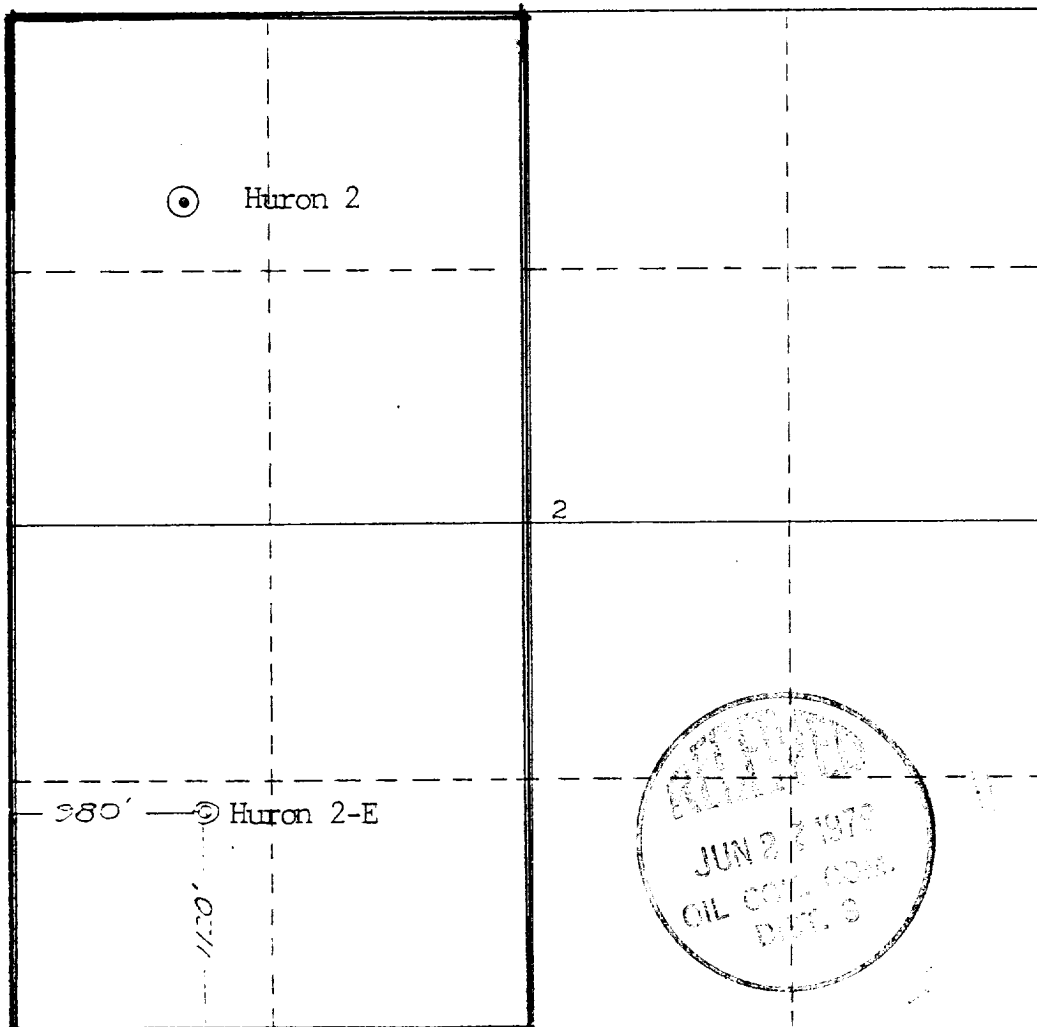

CERTIFICATION

I hereby certify that the information contained herein is true and complete to the best of my knowledge and belief.

C. M. Parham

Name
C. M. Parham
Position
Senior Production Engineer
Company
Consolidated Oil & Gas, Inc.
Date

I hereby certify that the information shown on this plat was plotted from notes of actual surveys made by me under my supervision, and that the same is true and correct to the best of my knowledge and belief.

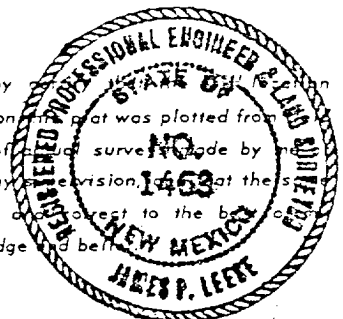

Date Surveyed
28 May 1979
Registered Professional Engineer
and/or Land Surveyor
James P. Leese
James P. Leese

Certificate No. **1463**