

UNITED STATES
DEPARTMENT OF THE INTERIOR
GEOLOGICAL SURVEY

APPLICATION FOR PERMIT TO DRILL, DEEPEN, OR PLUG BACK

1a. TYPE OF WORK

DRILL ☒DEEPEN ☐PLUG BACK ☐

b. TYPE OF WELL

OIL
WELL ☐GAS
WELL ☒

OTHER

SINGLE
ZONE ☒MULTIPLE
ZONE ☐

2. NAME OF OPERATOR

SUPRON ENERGY CORPORATION

3. ADDRESS OF OPERATOR

P.O. Box 808, Farmington, New Mexico 87401

4. LOCATION OF WELL (Report location clearly and in accordance with any State requirements.*)

At surface

1120 ft./North line and 950 ft./West line

At proposed prod. zone

Same as above

14. DISTANCE IN MILES AND DIRECTION FROM NEAREST TOWN OR POST OFFICE*

16 miles northwest of Ojito, New Mexico

15. DISTANCE FROM PROPOSED*

LOCATION TO NEAREST
PROPERTY OR LEASE LINE, FT.
(Also to nearest drlg. unit line, if any)

950 ft.

950 ft.

18. DISTANCE FROM PROPOSED LOCATION*

TO NEAREST WELL, DRILLING, COMPLETED,
OR APPLIED FOR, ON THIS LEASE, FT.

130 ft.

16. NO. OF ACRES IN LEASE

2560

19. PROPOSED DEPTH

7500

17. NO. OF ACRES ASSIGNED
TO THIS WELL320 N $\frac{1}{2}$

20. ROTARY OR CABLE TOOLS

Rotary

21. ELEVATIONS (Show whether DF, RT, GR, etc.)

6539 Gr.

22. APPROX. DATE WORK WILL START*

July 1, 1980

23. PROPOSED CASING AND CEMENTING PROGRAM

SIZE OF HOLE	SIZE OF CASING	WEIGHT PER FOOT	SETTING DEPTH	QUANTITY OF CEMENT
12-1/4"	8-5/8"	24.0	250	175 sx
7-7/8"	4-1/2"	10.5	7440	1100 sx

The surface hole will be drilled to +250 ft. Casing will be run and cemented with the cement being circulated back to the surface. The surface casing will be pressure tested. The well will be drilled to T.D. of approx. 7642 ft. using a starch base mud as the circulating medium. Pipe will be run and cemented in three stages as follows: First stage 450 sx of 50-50 POZ mix, Second stage 450 sx of 50-50 POZ mix followed by 50 sx of class "B" cement and the Third stage 100 sx of HOWCO Lite followed by 50 sx of class "B" with the estimated cement top to be at 2100 ft. The pipe will be pressure tested and the Dakota zone will be perforated and fractured to stimulate produciton. The well will be cleaned up and tubing run and landed above the Dakota zone. The wellhead will be nipped down and the well tested.

IN ABOVE SPACE DESCRIBE PROPOSED PROGRAM: If proposal is to deepen or plug back, give data on present productive zone and proposed new productive zone. If proposal is to drill or deepen directionally, give pertinent data on subsurface locations and measured and true vertical depths. Give blowout preventer program, if any.

24.

SIGNED

Rudy P. Motto

TITLE Area Superintendent

DATE 6-12-80

(This space for Federal or State office use)

PERMIT NO.

APPROVAL DATE

APPROVED BY

TITLE

DATE

CONDITIONS OF APPROVAL, IF ANY:

ok 3 m

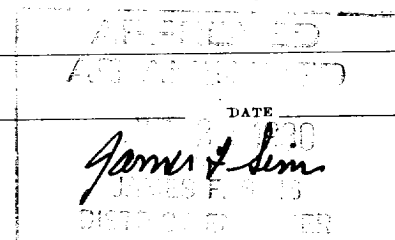
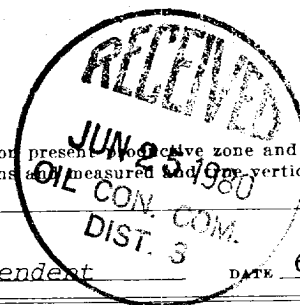

All distances must be from the outer boundaries of the Section.

Operator SUPRON ENERGY CORPORATION			Lease JICARILLA "J"		Well No. 9-E
Unit Letter D	Section 26	Township 26 NORTH	Range 5 WEST	County RIO ARriba	
Actual Postage Location of Well: 1120 feet from the NORTH line and 950 feet from the WEST line					
Ground Level Elev. 6539	Producing Formation DAKOTA		Pool BASIN Dakota		Dedicated Acres: W/2 320 Acres

1. Outline the acreage dedicated to the subject well by colored pencil or hatchure marks on the plat below.
2. If more than one lease is dedicated to the well, outline each and identify the ownership thereof (both as to working interest and royalty).
3. If more than one lease of different ownership is dedicated to the well, have the interests of all owners been consolidated by communitization, unitization, force-pooling, etc?

☐ Yes ☐ No If answer is "yes," type of consolidation _____

If answer is "no," list the owners and tract descriptions which have actually been consolidated. (Use reverse side of this form if necessary.) _____

No allowable will be assigned to the well until all interests have been consolidated (by communitization, unitization, forced-pooling, or otherwise) or until a non-standard unit, eliminating such interests, has been approved by the Division.

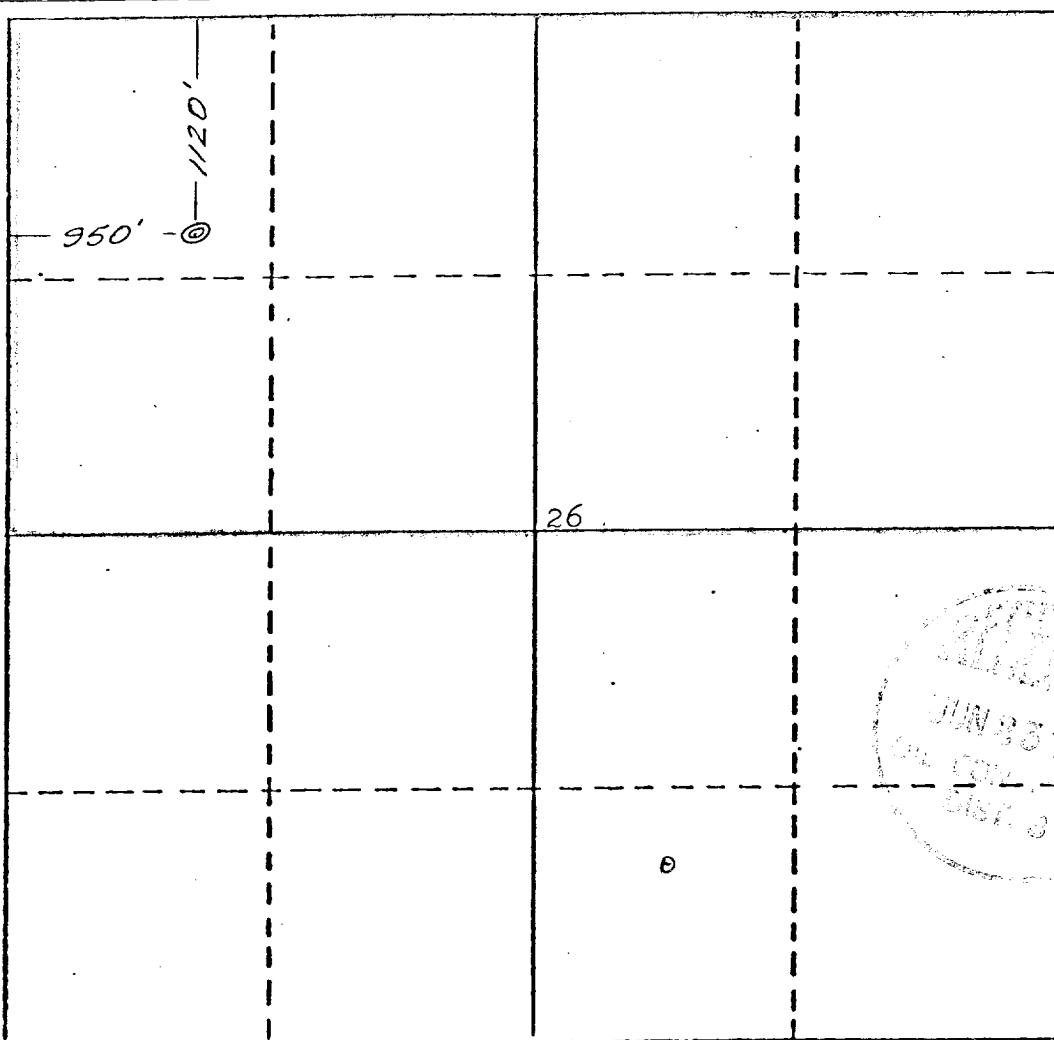

CERTIFICATION

I hereby certify that the information contained herein is true and complete to the best of my knowledge and belief.

Rudy D. Motto

Name

Rudy D. Motto

Position

Area Superintendent

Company

SUPRON ENERGY CORPORATION

Date

February 29, 1980

I hereby certify that the location shown on this plat is based on field notes of actual surveys made by me or under my supervision, and that the same is true and correct to the best of my knowledge and belief.

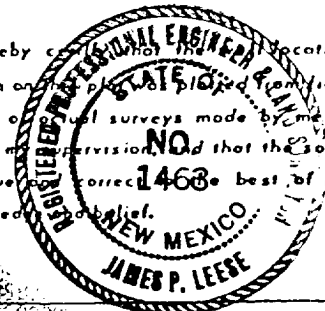

Date Surveyed

February 5, 1980

Registered Professional Engineer
or Land Surveyor

James P. Leese
James P. Leese

Certificate No.

1463

SUPRON ENERGY CORPORATION

JICARILLA "J" No. 9-E
NW ¼ Sec. 26, T-26N, R-5W, NMPM
Rio Arriba County, New Mexico

1. The Geologic name of the surface formation is, "Wasatch".
2. The estimated tops of important Geologic markers are:
 - A. Ojo Alamo 2570 ft.
 - B. Fruitland 2691 ft.
 - C. Pictured Cliffs 2988 ft.
 - D. Chacra 3433 ft.
 - E. Cliff House 4665 ft.
 - F. Point Lookout 5190 ft.
 - G. Gallup 6338 ft.
 - H. Greenhorn 7100 ft.
 - I. Dakota 7183 ft.
3. The estimated depths at which anticipated water, oil or other mineral bearing formations are expected to be encountered are:
 - A. Ojo Alamo 2570 ft. Water
 - B. Fruitland 2691 ft. Water
 - C. Pictured Cliffs 2988 ft. Gas
 - D. Chacra 3433 fr. Dry
 - E. Cliff House 4665 ft. Gas
 - F. Point Lookout 5190 ft. Gas
 - G. Gallup 6338 ft. Gas
 - H. Greenhorn 7100 ft. Shale
 - I. Dakota 7183 ft. Gas
4. The casing program is shown on form 9-331C and all casing is new.
5. The lessee's pressure control equipment schematics are attached, along with minimum specifications, testing procedures, and frequencies.
6. The type, estimated volumes, and characteristics of the circulating medium are as follows:
 - A. 0 - 250 ft. Natural Mud
 - B. 250 - 7462 ft. Permaloid non dispersed mud containing approx. 180 sx gel, 70 sx of permaloid and 20 sx of CMC.
7. The auxiliary equipment to be used will be floats at the bit and a sub on the floor with a full opening valve to be stabbed into the drill pipe when the kelly is not in the string.
8. The well is in an area which is partially developed; therefore we will not have a testing and coring program. The logging program is as follows:
 - A. E.S. Induction
 - B. Gamma Ray Density
 - C. Gamma Ray Correlation
 - D. Cement Bond Log
9. We do not expect to find any abnormal pressures, temperatures or hydrogen sulfide problems in this partially developed area.
10. The anticipated starting date for this well is July 1, 1980.

SUPRON ENERGY CORPORATION
JICARILLA "J" NO. 9-E
NW/4 Sec. 26, T-26N, R-5W, N.M.P.M.
Rio Arriba County, New Mexico

The following attachments are included with this application:

1. Topographical map showing proposed location and access road.
2. Access road not required.
3. Map showing existing producing facilities.
4. Location of surface equipment if required.
5. Drilling and completion water will be obtained from the Jicarilla "J" Water well.
6. All pits will be fenced and constructed in such a way as to prevent litter on the location.
7. We will dispose of all waste by placing it in the reserve pit and burying it when the well is completed.
8. There will be no camp at or near the well site.
9. There will be no air strip.
10. A plat is attached showing the location of the rig, mud tanks, reserve pit, burn pit, etc.
11. A letter of certification is attached. The operator representative for compliance purposes is Rudy D. Motto, Area Superintendent, P.O. Box 808, Farmington, New Mexico 87401. Phone (505) 325-3587.
12. After the well is completed, the location will be cleaned up, and bladed. The reserve pit will be allowed to dry and then filled and restored to its natural state.
13. The soil is sandy clayey loam, the principal vegetation is sagebrush, greasewood, saltbush, rabbitbrush, galleta, grama, alkali sacaton, brome.

Supron Energy Corporation
Jicarilla J #9-E
NW $\frac{1}{4}$ Sec. 26, T26N, R5W, N.M.P.M.
Rio Arriba County N.M.



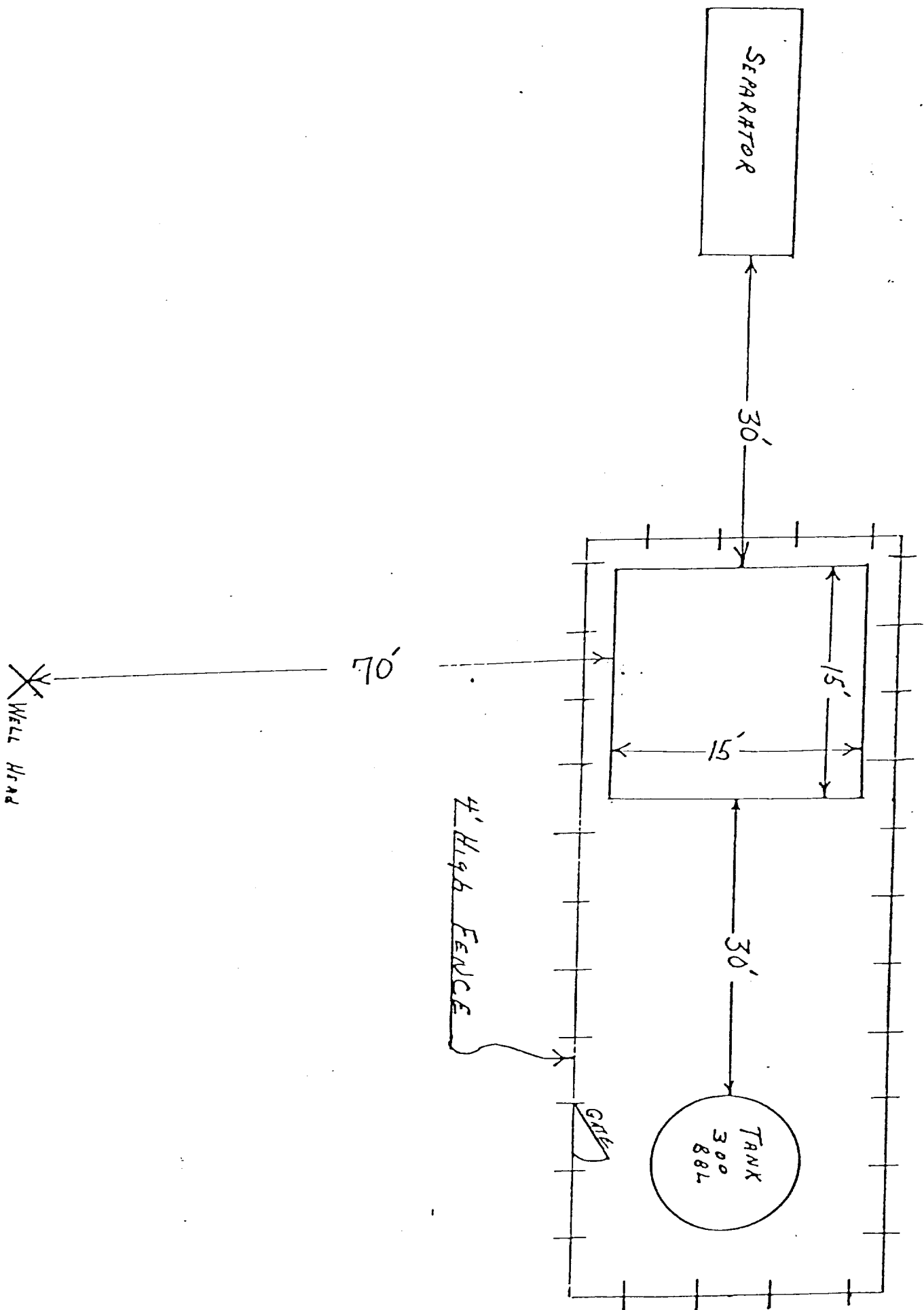

Blowout Preventer will be tested daily and prior to drilling out with the results to be logged on the drillers report.

The B.O.P. and all valve and fittings are rated at 3000 psi working pressure, and hydraulically operated

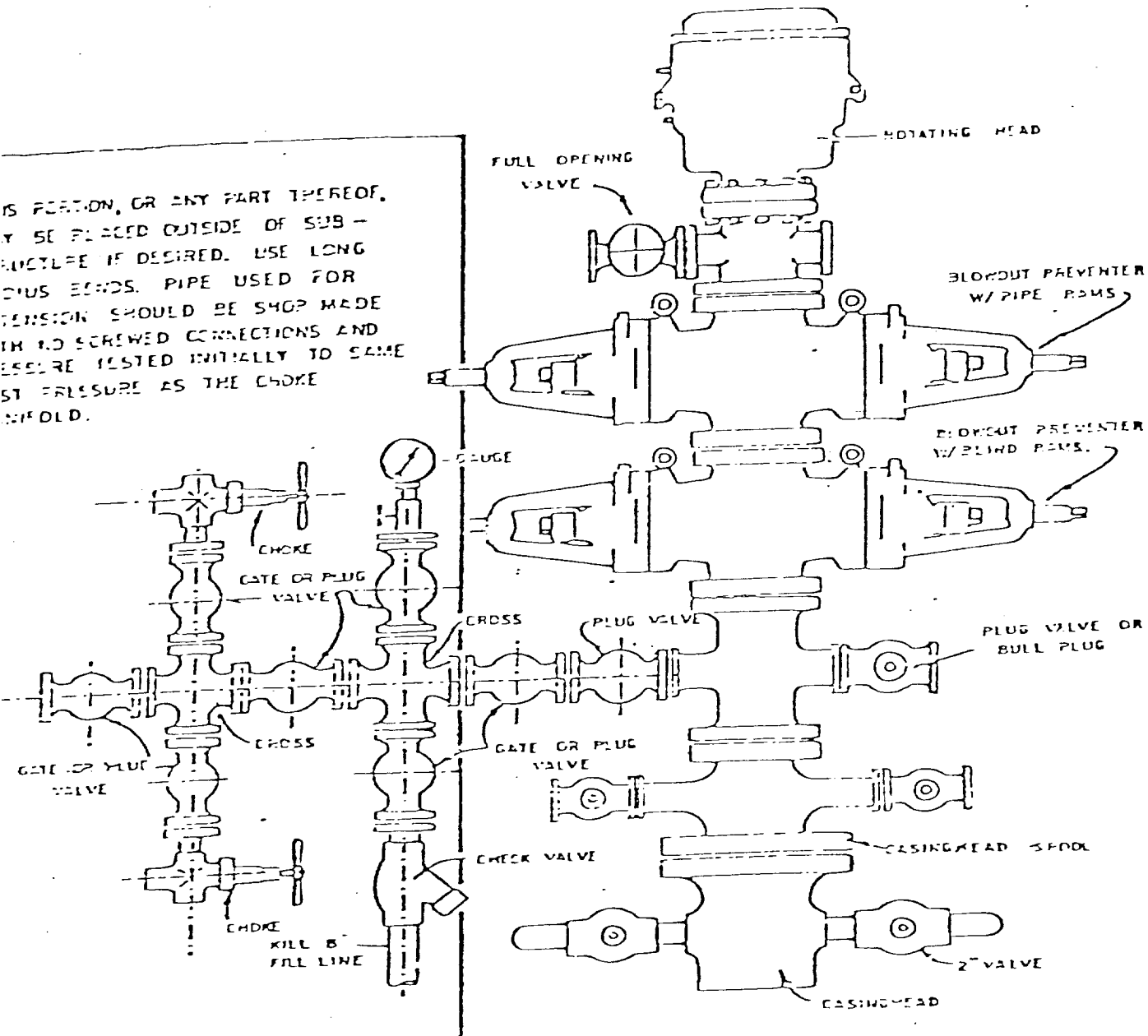

BLOWOUT PREVENTER HOOKUP

LOCATION AND EQUIPMENT LAYOUT
JICARILLA "J" NO. 9-E
1120 Ft./N; 950 ft./W line
Sec. 26, T-26N, R-5W
Rio Arriba County, New Mexico

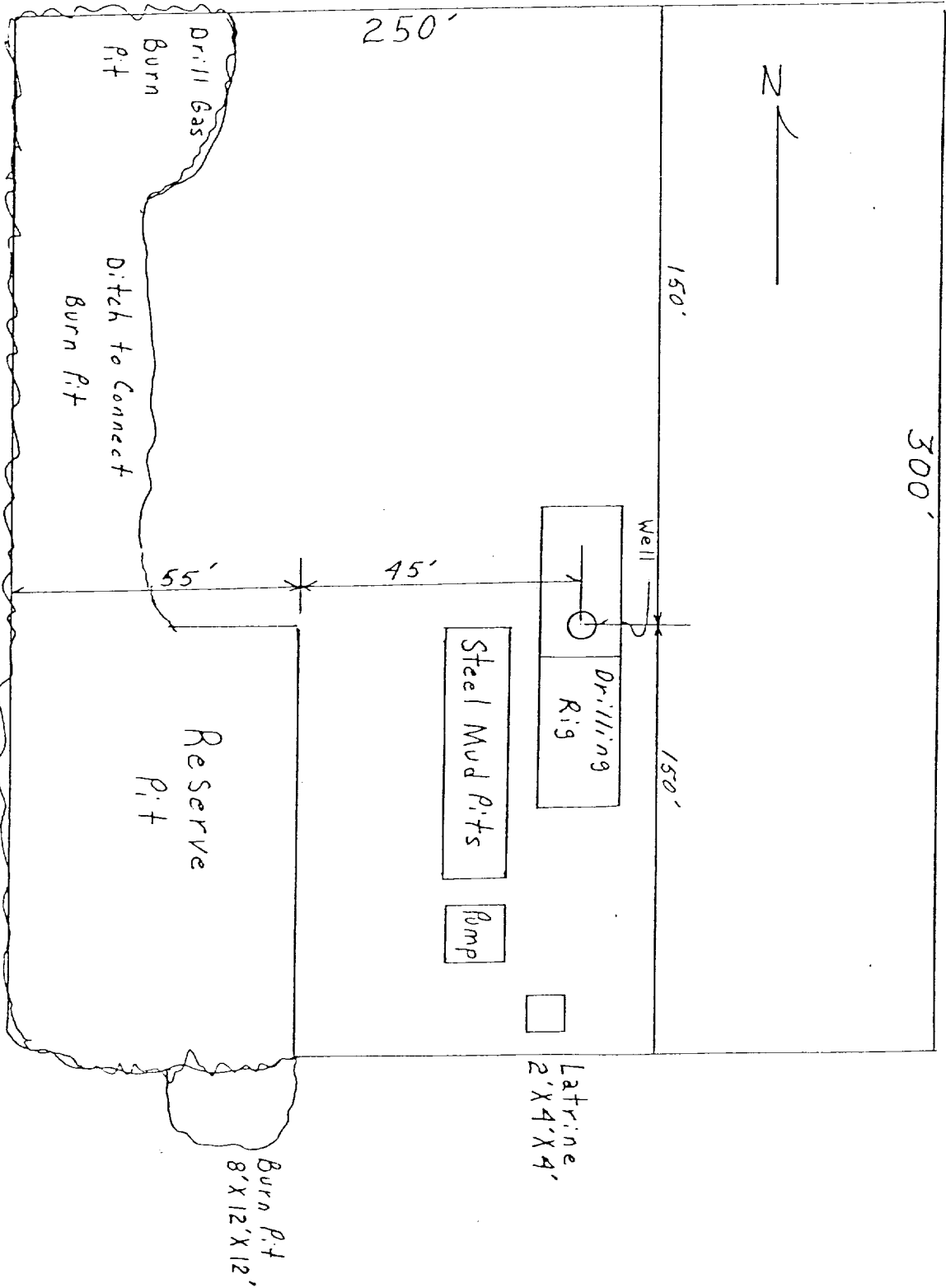

SUPRON ENERGY CORPORATION
Post Office Box 808
FARMINGTON, NEW MEXICO 87401

I hereby certify that I, or persons under my direct supervision, have inspected the proposed drillsite and access route; that I am familiar with the conditions which presently exist; that the statements made in this plan are, to the best of my knowledge, true and correct; and, that the work associated with the operations proposed herein will be performed by SUPRON ENERGY CORPORATION and its contractors subcontractors in conformity with this plan and the terms and conditions under which it is approved.

SUPRON ENERGY CORPORATION

A handwritten signature in cursive script, reading "Rudy D. Motto".

Rudy D. Motto
Area Superintendent
Phone: 325-3587