



Date Remediation Started: 7/30/96 Date Completed: 4/5/96

Remediation Method: Excavation  Approx. Cubic Yards 207

(Check all appropriate sections) Landfarmed  Amount Landfarmed (cubic yds): 90-TNT  
117-Onsite

Other \_\_\_\_\_

Remediation Location: Onsite  Offsite  TNT Landfarm  
(i.e., landfarmed onsite, name and location of offsite facility) Schmitz Ranch, N Mex

General Description of Remedial Action:  
Removed contaminated soil from all four walls and pit bottom as to get a below 100 ppm head space reading

Ground Water Encountered: No  Yes \_\_\_\_\_ Depth \_\_\_\_\_

Final Pit Closure Sampling: Sample Location North, East, South, West side walls and pit bottom

(if multiple samples, attach sample result and diagram of sample locations and depths.) Sample depth 10'

Sample date 7/30/96 Sample time 1340

Sample Results

Soil: Benzene (ppm) \_\_\_\_\_ Water: Benzene (ppb) \_\_\_\_\_

Total BTEX (ppm) \_\_\_\_\_ Toluene (ppb) \_\_\_\_\_

Field headspace (ppm) 50.1 Ethylbenzene (ppb) \_\_\_\_\_

TPH <5.0 ppm Method 8015 Total Xylenes (ppb) \_\_\_\_\_

Ground Water Sample: Yes \_\_\_\_\_ No  (If yes, attach sample results)

I HEREBY CERTIFY THAT THE INFORMATION ABOVE IS TRUE AND COMPLETE TO THE BEST OF MY KNOWLEDGE AND MY BELIEF

DATE 8/3/96 PRINTED NAME Ronald A. Dedrick

SIGNATURE Ronald A. Dedrick AND TITLE Environmental Technician II

AFTER REVIEW OF THE PIT CLOSURE INFORMATION, PIT CLOSURE IS APPROVED IN ACCORDANCE TO JICARILLA APACHE TRIBE PIT CLOSURE ORDINANCE.

APPROVED: YES  NO \_\_\_\_\_ (REASON): \_\_\_\_\_

SIGNED: Kevin C. Manull DATE: 8-5-96

Ticamilla J-9E  
Sec. 26 T26N R5W  
Meridian

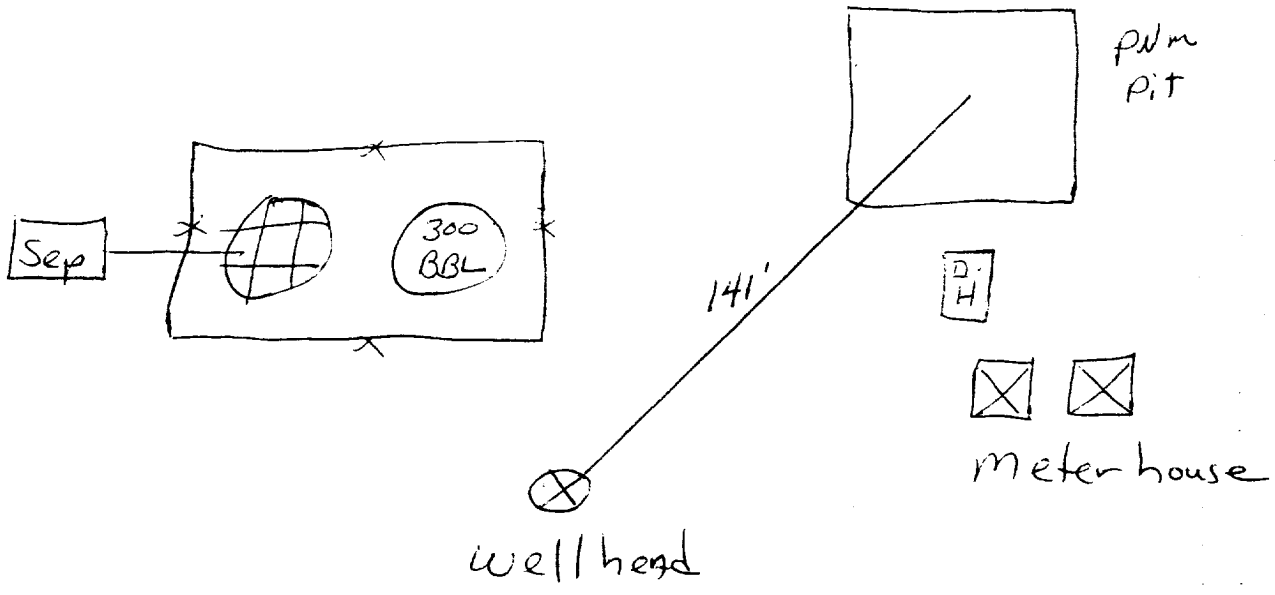

OFF: (505) 325-5667



LAB: (505) 325-1556

***Diesel Range Organics***

Attn: *Denver Bearden*  
 Company: *PNM Gas Services*  
 Address: *603 W. Elm*  
 City, State: *Farmington, NM 87401*

Date: *2-Aug-96*  
 COC No.: *4808*  
 Sample No. *11659*  
 Job No. *2-1000*

Project Name: ***PNM Gas Services - Jicarilla J-9E Run 12-01***  
 Project Location: ***9607301340; 5pt. Composite***  
 Sampled by: EP Date: 30-Jul-96 Time: 13:40  
 Analyzed by: DC/HR Date: 1-Aug-96  
 Sample Matrix: *Soil*

***Laboratory Analysis***

<i>Parameter</i>	<i>Result</i>	<i>Unit of Measure</i>	<i>Detection Limit</i>	<i>Unit of Measure</i>
<i>Diesel Range Organics (C10 - C28)</i>	<i>&lt;5.0</i>	<i>mg/kg</i>	<i>5.0</i>	<i>mg/kg</i>

***Quality Assurance Report***

*DRO QC No.: 0479-QC*

***Calibration Check***

<i>Parameter</i>	<i>Method Blank</i>	<i>Unit of Measure</i>	<i>True Value</i>	<i>Analyzed Value</i>	<i>% Diff</i>	<i>Limit</i>
<i>Diesel Range (C10 - C28)</i>	<i>&lt;5.0</i>	<i>ppm</i>	<i>2,000</i>	<i>1,994</i>	<i>0.3</i>	<i>15%</i>

***Matrix Spike***

<i>Parameter</i>	<i>1- Percent Recovered</i>	<i>2- Percent Recovered</i>	<i>Limit</i>	<i>%RSD</i>	<i>Limit</i>
<i>Diesel Range (C10-C28)</i>	<i>109</i>	<i>99</i>	<i>(70-130)</i>	<i>7</i>	<i>20%</i>

**Method** - SW-846 EPA Method 8015A mod. - Nonhalogenated Volatile Hydrocarbons by Gas Chromatography

Approved by: *JaG*  
 Date: *8/2/96*

P.O. BOX 2606 • FARMINGTON, NM 87499

- TECHNOLOGY BLENDING INDUSTRY WITH THE ENVIRONMENT -

JICARILLA APACHE TRIBE  
ENVIRONMENTAL  
PROTECTION OFFICE  
P.O. BOX 507  
DULCE, NEW MEXICO 87528

SUBMIT 1 COPY TO  
NATURAL  
RESOURCE DEPT  
AND OIL GAS  
ADMINISTRATION

ON-SITE SOIL REMEDIATION REPORT

Operator: PNM Gas Services ( <u>Meridian</u> ) Telephone: 324-3764	
Address: 603 W. Elm Street Farmington, NM 87401	
Facility or Well Name: <u>Jicarilla J-9E</u>	
Location: Unit: <u>D</u> Sec. <u>26</u> T. <u>26</u> N R. <u>5</u> W County <u>Rio Arriba</u>	
Land Type: <u>Jicarilla Apache</u>	
Date Remediation Started: <u>7/30/96</u>	Date Completed: <u>8/20/96</u>
Remediation Method: Landfarmed <input checked="" type="checkbox"/>	Approx. cubic yards: <u>117</u>
Composted <input type="checkbox"/>	
Other <input type="checkbox"/>	
Depth to Ground Water: (pts.) <u>0</u>	Final Closure Sampling: Sampling Date: <u>8/20/96</u> Time <u>1849</u> Sampling Results: Field Headspace (ppm) <u>77.7</u> TPH (ppm) <u>446</u> Method <u>8015</u> Other _____
Distance to an Ephemeral Stream: (pts.) <u>10</u>	
Distance to Nearest Lake, Playa, or Watering Pond: (pts.) <u>0</u>	
Wellhead Protection Area: (pts.) <u>0</u>	
Distance to Surface Water: (pts.) <u>0</u>	
Ranking Score (Total Points): <u>10</u>	
I HEREBY CERTIFY THAT THE INFORMATION ABOVE IS TRUE AND COMPLETE TO THE BEST OF MY KNOWLEDGE AND BELIEF	
DATE: <u>8/25/96</u>	PRINTED NAME: <u>Ronald A. Dedrick</u>
SIGNATURE: <u>Ronald A. Dedrick</u>	AND TITLE: <u>Environmental Technician II</u>
AFTER REVIEW OF THE SOIL REMEDIATION INFORMATION, ON-SITE REMEDIATION APPROVED IN ACCORDANCE TO THE JICARILLA APACHE TRIBE PIT CLOSURE ORDINANCE	
APPROVED: YES <input checked="" type="checkbox"/> NO <input type="checkbox"/> (REASON) _____	
SIGNED: <u>[Signature]</u>	DATE: <u>8-26-96</u>

Jicarilla J-9E  
Sec. 26 T26N R5W  
Meridian

Land Farm

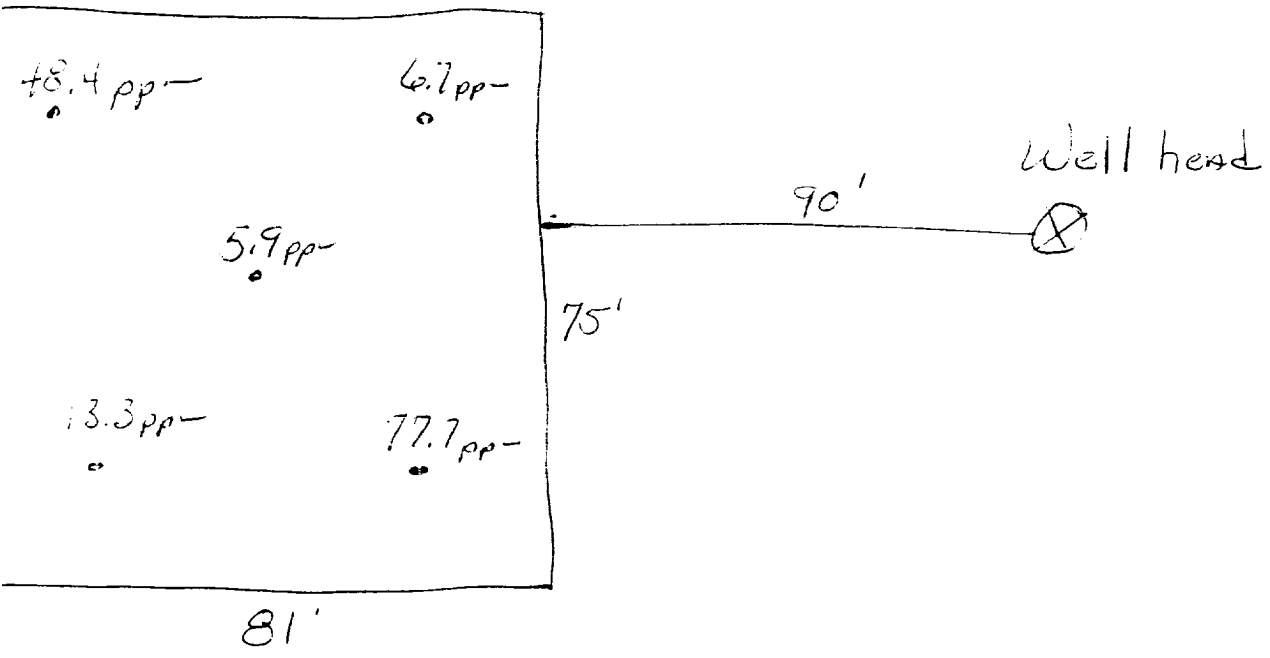

OFF: (505) 325-5667



LAB: (505) 325-1556

**Diesel Range Organics**

Attn: *Denver Bearden*  
 Company: *PNM Gas Services*  
 Address: *603 W. Elm*  
 City, State: *Farmington, NM 87401*

Date: *23-Aug-96*  
 COC No.: *4850*  
 Sample No. *11860*  
 Job No. *2-1000*

Project Name: **PNM Gas Services - Jicarilla J-9E Landfarm Run 12-01**  
 Project Location: **9608201905; 5pt. Composite**  
 Sampled by: RD Date: 20-Aug-96 Time: 19:05  
 Analyzed by: DC/HR Date: 22-Aug-96  
 Sample Matrix: Soil

**Laboratory Analysis**

Parameter	Result	Unit of Measure	Detection Limit	Unit of Measure
Diesel Range Organics (C10 - C28)	445.7	mg/kg	5.0	mg/kg

**Quality Assurance Report**

DRO QC No.: 0489-QC

**Calibration Check**

Parameter	Method Blank	Unit of Measure	True Value	Analyzed Value	% Diff	Limit
Diesel Range (C10 - C28)	<5.0	ppm	100	104	3.9	15%

**Matrix Spike**

Parameter	1- Percent Recovered	2- Percent Recovered	Limit	%RSD	Limit
Diesel Range (C10-C28)	88	101	(70-130)	10	20%

**Method** - SW-846 EPA Method 8015A mod. - Nonhalogenated Volatile Hydrocarbons by Gas Chromatography

Approved by: *[Signature]*  
 Date: *8/23/96*

P.O. BOX 2606 • FARMINGTON, NM 87499

- TECHNOLOGY BLENDING INDUSTRY WITH THE ENVIRONMENT -