



STATE OF NEW MEXICO
ENERGY AND MINERALS DEPARTMENT

OIL CONSERVATION DIVISION
AZTEC DISTRICT OFFICE

1000 RIO BRAZOS ROAD
AZTEC, NEW MEXICO 87410
(505) 334-6178

OIL CONSERVATION DIVISION
BOX 2088
SANTA FE, NEW MEXICO 87501

MC 3-001

DATE 11-9-81

RE: Proposed MC ☒
Proposed DHC ☐
Proposed NSL ☐
Proposed SWD ☐
Proposed WFX ☐
Proposed PMX ☐

Gentlemen:

I have examined the application dated 11-5-81
for the Sennew Jimilla A # 1M F-1926N-SW
Operator Lease and Well No. Unit, S-T-R

and my recommendations are as follows:

Approve

Yours truly,

NEW MEXICO OIL CONSERVATION COMMISSION
SANTA FE, NEW MEXICO
APPLICATION FOR MULTIPLE COMPLETION

Form C-107
5-1-61

| | | | | |
|---|------|-----------------------------|-------------|-------------------------|
| Operator Tenneco Oil Company | | County Rio Arriba | | Date 10/29/81 |
| Address P. O. Box 3249, Englewood, CO 80155 | | Lease Jicarilla A | | Well No. 1M |
| Location of Well | Unit | Section | Township | Range |
| | | 18 | T26N | R5W |

1. Has the New Mexico Oil Conservation Commission heretofore authorized the multiple completion of a well in these same pools or in the same zones within one mile of the subject well? YES X NO
2. If answer is yes, identify one such instance: Order No. R-5707 ; Operator Lease, and Well No.: Jicarilla A1

| 3. The following facts are submitted: | Upper Zone | Intermediate Zone | Lower Zone |
|--|------------|-------------------|------------|
| a. Name of Pool and Formation | Chacra | | Dakota |
| b. Top and Bottom of Pay Section (Perforations) | 4024-4109' | | 7338-7560' |
| c. Type of production (Oil or Gas) | Gas | | Gas |
| d. Method of Production (Flowing or Artificial Lift) | Flowing | | Flowing |

4. The following are attached. (Please check YES or NO)

| Yes | No | |
|-------------------------------------|--------------------------|---|
| <input checked="" type="checkbox"/> | <input type="checkbox"/> | a. Diagrammatic Sketch of the Multiple Completion, showing all casing strings, including diameters and setting depths, perforators and/or turbolizers and location thereof, quantities used and top of cement, perforated intervals, tubing strings including diameters and setting depth, location and type of packers and side door chokes, and such other information as may be pertinent. |
| <input checked="" type="checkbox"/> | <input type="checkbox"/> | b. Plat showing the location of all wells on applicant's lease, all offset wells on offset leases, and the names and addresses of operators of all leases offsetting applicant's lease. |
| <input checked="" type="checkbox"/> | <input type="checkbox"/> | c. Waivers consenting to such multiple completion from each offset operator, or in lieu thereof, evidence that each offset operator has been furnished copies of the application.* |
| <input checked="" type="checkbox"/> | <input type="checkbox"/> | d. Electrical log of the well or other acceptable log with tops and bottoms of producing zones and intervals of perforation indicated thereon. (If such log is not available at the time application is filed it shall be submitted as provided by Rule 112-A.) |

5. List all offset operators to the lease on which this well is located together with their correct mailing address.

Caulkins Oil & Gas, 2100 Colorado State Bank Bldg., Denver, CO 80202

El Paso Natural Gas, P. O. Box 990, Farmington, New Mexico 87401

N. W. Exploration, Denver National Bank Bldg., 1125 - 17th St., #2100, Denver, CO 80202

Occidental Exploration, 5000 Stockdale Highway, Bakersfield, California 93309

6. Were all operators listed in Item 5 above notified and furnished a copy of this application? YES X NO . If answer is yes, give date of such notification 10/29/81.

CERTIFICATE: I, the undersigned, state that I am the Production Analyst of the Tenneco Oil Company (company), and that I am authorized by said company to make this report; and that this report was prepared under my supervision and direction and that the facts stated therein are true, correct and complete to the best of my knowledge.

Aurora J. Peron
Signature

*Should waivers from all offset operators not accompany an application for administrative approval, the New Mexico Oil Conservation Commission will hold the application for a period of twenty (20) days from date of receipt by the Commission's Santa Fe office. If, after said twenty-day period, no protest nor request for hearing is received by the Santa Fe office, the application will then be processed.

NOTE: If the proposed multiple completion will result in an unorthodox well location and/or a non-standard proration unit in one or more of the producing zones, then separate application for approval of the same should be filed simultaneously with this application.

WELL LOCATION AND ACREAGE DEDICATION PLAT

Revised 10-81
Effective 10-81

All distances must be from the outer boundaries of the Section.

| | | | | |
|--|---|-----------------------------|---|-----------------------------|
| Operator Tenneco Oil Company | | Lease Jicarilla A | | Well No. 1M |
| Unit Letter F | Section 18 | Township 26N | Range 5W | County Rio Arriba |
| Actual Footage Location of Well: 1670 feet from the North line and 1780 feet from the West line | | | | |
| Ground Level Elev. 6614' | Producing Formation Dakota/Chacra | Pool | Dedicated Acreage: 319.20 Acres | |

1. Outline the acreage dedicated to the subject well by colored pencil or hachure marks on the plat below.
2. If more than one lease is dedicated to the well, outline each and identify the ownership thereof (both as to working interest and royalty).
3. If more than one lease of different ownership is dedicated to the well, have the interests of all owners been consolidated by communitization, unitization, force-pooling, etc?

☐ Yes ☐ No If answer is "yes," type of consolidation _____

If answer is "no," list the owners and tract descriptions which have actually been consolidated. (Use reverse side of this form if necessary.) _____

No allowable will be assigned to the well until all interests have been consolidated (by communitization, unitization, forced-pooling, or otherwise) or until a non-standard unit, eliminating such interests, has been approved by the Commission.

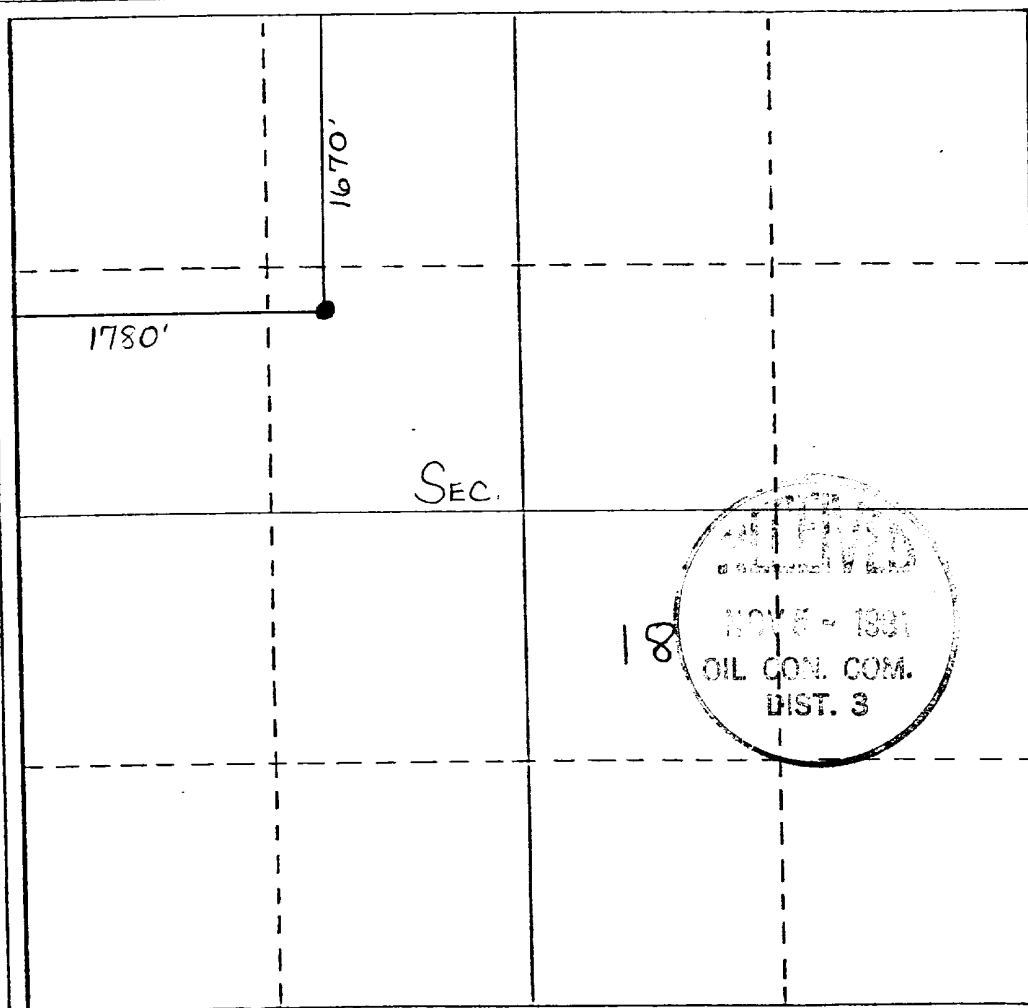

CERTIFICATION

I hereby certify that the information contained herein is true and complete to the best of my knowledge and belief.

Sandra Peron

Name
Sandra Peron

Position
Production Analyst

Company
Tenneco Oil Company

Date
October 29, 1981

I hereby certify that the well location shown on this plat was plotted from field notes of actual surveys made by me or under my supervision, and that the same is true and correct to the best of my knowledge and belief.

Date Surveyed

Registered Professional Engineer
and/or Land Surveyor

Certificate No.

0 330 660 990 1320 1650 1980 2310 2640 2000 1500 1000 500 0

LEASE Jicarilla A

WELL NO. 1E

9-5/8 "OD, 36 LB, K-55 CSG.W/ 250 SX

TOC @ surface.

7 "OD, 23 LB, K-55 CSG.W/ 825 SX

TOC @ surface.

4-1/2" "OD, 10.5 LB, K-55 CSG.W/ 250 SX

TOC @ circ. to liner top.

DETAILED PROCEDURE

*1 1/4" tbg
@ 4030'*

4024'
CHACRA
4109'

4160'

5800'

*2 3/8" tbg
@ 7544'*

7338'

DAKOTA

7560'

7500'

7588'

7605'

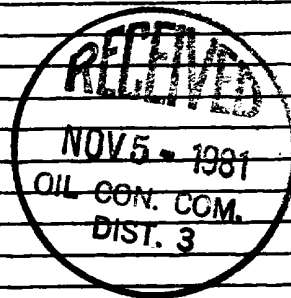

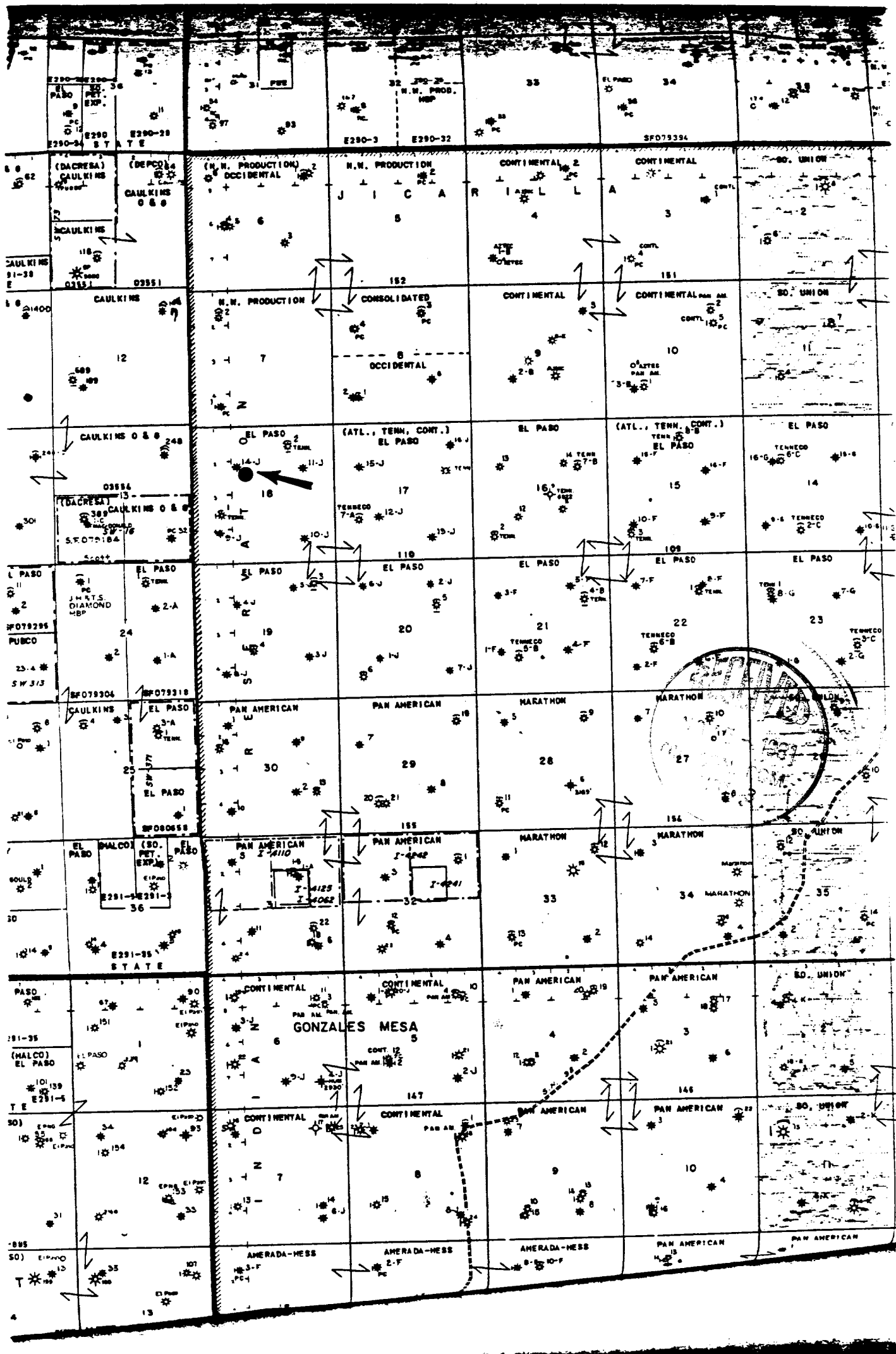

T26N

R5W