

RECEIVED
JUL 13 1999

JICARILLA APACHE TRIBE
ENVIRONMENTAL PROTECTION OFFICE
P.O. BOX 507
DULCE, NEW MEXICO 87528

8J679

SUBMIT 1 COPY TO:
NATURAL RESOURCE DEPT.
AND OIL & GAS ADMINISTRATION

OIL CON. DIV. PIT REMEDIATION AND CLOSURE REPORT
DIST. 3

Operator: AMOCO PRODUCTION COMPANY Telephone: (505) 326-9200
Address: 200 Amoco Court, Farmington, NM 87401 Dennis E. Faust
Facility or Well Name: JICARILLA A #5E AUG 13 1999
Location: Unit or Qtr/Qtr Sec J Sec 20 T 26N R 5W County RIO ARriba
Pit Type: Separator Dehydrator Other PRODUCTION TANK
Land Type: RANGE

Pit Location: Pit dimensions: length 14', width 16', depth 11'
(Attach diagram) Reference: wellhead X, other
Footage from reference: 132'
Direction from reference: 26 Degrees East of North
X West X South

Depth To Groundwater:

(Vertical distance from
contaminants to seasonal
high water elevation of
groundwater)

Less than 50 feet (20 points)
50 feet to 99 feet (10 points)
Greater than 100 feet (0 points) 0

Distance to an Ephemeral Stream

(Downgradient dry wash greater than
ten feet in width)

Less than 100 feet (10 points)
Greater than 100 feet (0 points) 0

Distance to Nearest Lake, Playa, or Watering Pond

(Downgradient lakes, playas and
livestock or wildlife watering ponds)

Less than 100 feet (10 points)
Greater than 100 feet (0 points) 0

Wellhead Protection Area:

(Less than 200 feet from a private
domestic water source, or: less than
1000 feet from all other water sources)

Yes (20 points)
No (0 points) 0

Distance To Surface Water:

(Horizontal distance to perennial
lakes, ponds, rivers, streams, creeks,
irrigation canals and ditches)

Less than 100 feet (20 points)
100 feet to 1000 feet (10 points)
Greater than 1000 feet (0 points) 0

RANKING SCORE (TOTAL POINTS): 0

Date Remediation Started: _____ Date Completed: 12/2/98

Remediation Method: Excavation ☒ Approx. cubic yards 75
Check all appropriate sections) Landfarmed ☒ Insitu Bioremediation _____
Other _____

Remediation Location: Onsite ☒ Offsite _____
(i.e. landfarmed onsite, name and location of offsite facility) _____

General Description of Remedial Action: Excavation, BEDROCK BOTTOM - RISK ASSESSED.

Groundwater Encountered: No ☒ Yes _____ Depth _____

Final Pit:
Closure Sampling:
(if multiple samples, attach sample results and diagram of sample locations and depths)

Sample location see Attached Documents

Sample depth 6' (EAST SIDEWALL)

Sample date 11/30/98

Sample time 0930

Sample Results

Soil: Benzene	(ppm)	<u>2.790</u>	Water: Benzene	(ppb)	_____
Total BTEX	(ppm)	<u>34.080</u>	Toluene	(ppb)	_____
Field Headspace	(ppm)	<u>588</u>	Ethylbenzene	(ppb)	_____
TPH	(ppm)	<u>10,050</u>	Total Xylenes	(ppb)	_____

Groundwater Sample: Yes _____ No ☒ (If yes, attach sample results)

I HEREBY CERTIFY THAT THE INFORMATION ABOVE IS TRUE AND COMPLETE TO THE BEST OF MY KNOWLEDGE AND BELIEF

DATE 12/2/98 PRINTED NAME Buddy D. Shaw

SIGNATURE Buddy D. Shaw AND TITLE Environmental Coordinator

AFTER REVIEW OF THE PIT CLOSURE INFORMATION, PIT CLOSURE IS APPROVED IN ACCORDANCE TO THE JICARILLA APACHE TRIBE PIT CLOSURE ORDINANCE.

APPROVED: YES ☒ NO _____ (REASON) RA Attached

SIGNED: Kate C Mammell

DATE: 12-28-98

CLIENT: <u>AMOCO</u>	BLAGG ENGINEERING, INC. P.O. BOX 87, BLOOMFIELD, NM 87413 (505) 632-1199	LOCATION NO: <u>8J679</u> C.O.C. NO: <u>6412</u>																																								
FIELD REPORT: CLOSURE VERIFICATION		PAGE No: <u>1</u> of <u>1</u>																																								
LOCATION: NAME: <u>JICA</u> A WELL #: <u>SE</u> PIT: <u>PROD.</u>		DATE STARTED: <u>11/30/98</u> DATE FINISHED: _____																																								
QUAD/UNIT: <u>T</u> SEC: <u>20</u> TWP: <u>26N</u> RNG: <u>5W</u> PM: <u>NM CNTY RA ST: NM</u>		ENVIRONMENTAL SPECIALIST: <u>NV</u>																																								
DTP/FOOTAGE: <u>1560' PSL (1610' FCL)</u> CONTRACTOR: <u>P+S</u>																																										
EXCAVATION APPROX. <u>14</u> FT. x <u>16</u> FT. x <u>11</u> FT. DEEP. CUBIC YARDAGE: <u>75</u>																																										
DISPOSAL FACILITY: <u>ON-SITE</u> REMEDIATION METHOD: <u>LANDFARM</u>																																										
LAND USE: <u>RANGE</u> LEASE: <u>TIC A</u> FORMATION: <u>OK</u>																																										
FIELD NOTES & REMARKS: PIT LOCATED APPROXIMATELY <u>132</u> FT. <u>SW</u> FROM WELLHEAD.																																										
DEPTH TO GROUNDWATER: <u>>100'</u> NEAREST WATER SOURCE: <u>>1000'</u> NEAREST SURFACE WATER: <u>>1000'</u>																																										
NMDCD RANKING SCORE: <u>0</u> NMDCD TPH CLOSURE STD: <u>5000</u> PPM																																										
SOIL AND EXCAVATION DESCRIPTION:																																										
<p><u>SIDEWALLS -</u></p> <p>OK. YELL. ORANGE SAND (NORTH SIDEWALL), OLIVE TO MED. GRAY SAND ON REMAINING SIDEWALLS, NOW COHESIVE TO COHESIVE, SLIGHTLY MOIST TO MOIST, FIRM TO DENSE, DARKER COLOR APPARENTLY ASSOCIATED W/ HC ODOOR (HC ODOOR ALSO DETECTED WITH EXCAVATION), STRONG HC ODOOR IN ALL OVM SAMPLES EXCEPT NORTH SIDEWALL.</p> <p>BOTTOM - BEDROCK (SHALE) OLIVE GRAY IN COLOR, VERY HARD, STRONG HC ODOOR IN OVM SAMPLE.</p>																																										
<div style="display: flex; justify-content: space-between;"> <div style="width: 30%;"> <p>BEDROCK BOTTOM</p> <p>SCALE</p> <p>0 FT</p> </div> <div style="width: 30%;"> <p>RISK ASSESSED</p> </div> <div style="width: 35%;"> <p>FIELD 418.1 CALCULATIONS</p> <table border="1" style="width:100%; border-collapse: collapse;"> <thead> <tr> <th>TIME</th> <th>SAMPLE I.D.</th> <th>LAB No:</th> <th>WEIGHT (g)</th> <th>mL. FREON</th> <th>DILUTION</th> <th>READING</th> <th>CALC. ppm</th> </tr> </thead> <tbody> <tr> <td>0930</td> <td></td> <td></td> <td></td> <td></td> <td></td> <td></td> <td></td> </tr> <tr><td> </td><td></td><td></td><td></td><td></td><td></td><td></td><td></td></tr> <tr><td> </td><td></td><td></td><td></td><td></td><td></td><td></td><td></td></tr> <tr><td> </td><td></td><td></td><td></td><td></td><td></td><td></td><td></td></tr> </tbody> </table> </div> </div>			TIME	SAMPLE I.D.	LAB No:	WEIGHT (g)	mL. FREON	DILUTION	READING	CALC. ppm	0930																															
TIME	SAMPLE I.D.	LAB No:	WEIGHT (g)	mL. FREON	DILUTION	READING	CALC. ppm																																			
0930																																										
<p>PIT PERIMETER</p>		<p>PIT PROFILE</p>																																								
<p>OVM RESULTS</p> <table border="1" style="width:100%; border-collapse: collapse;"> <thead> <tr> <th>SAMPLE ID</th> <th>FIELD HEADSPACE PID (ppm)</th> </tr> </thead> <tbody> <tr><td>1 @ 7'</td><td>2.0</td></tr> <tr><td>2 @ 6'</td><td>588</td></tr> <tr><td>3 @ 6'</td><td>509</td></tr> <tr><td>4 @ 6'</td><td>486</td></tr> <tr><td>5 @ 11'</td><td>369</td></tr> <tr><td> </td><td></td></tr> <tr><td> </td><td></td></tr> <tr><td> </td><td></td></tr> <tr><td> </td><td></td></tr> <tr><td> </td><td></td></tr> </tbody> </table>		SAMPLE ID	FIELD HEADSPACE PID (ppm)	1 @ 7'	2.0	2 @ 6'	588	3 @ 6'	509	4 @ 6'	486	5 @ 11'	369											<p>LAB SAMPLES</p> <table border="1" style="width:100%; border-collapse: collapse;"> <thead> <tr> <th>SAMPLE ID</th> <th>ANALYSIS</th> <th>TIME</th> </tr> </thead> <tbody> <tr> <td>2 @ 6'</td> <td>TPH/STEX</td> <td>0930</td> </tr> <tr> <td colspan="3" style="text-align: center;"> <p>TPH - RAILED STEX - PASSED</p> </td> </tr> <tr><td> </td><td></td><td></td></tr> <tr><td> </td><td></td><td></td></tr> <tr><td> </td><td></td><td></td></tr> </tbody> </table>	SAMPLE ID	ANALYSIS	TIME	2 @ 6'	TPH/STEX	0930	<p>TPH - RAILED STEX - PASSED</p>											
SAMPLE ID	FIELD HEADSPACE PID (ppm)																																									
1 @ 7'	2.0																																									
2 @ 6'	588																																									
3 @ 6'	509																																									
4 @ 6'	486																																									
5 @ 11'	369																																									
SAMPLE ID	ANALYSIS	TIME																																								
2 @ 6'	TPH/STEX	0930																																								
<p>TPH - RAILED STEX - PASSED</p>																																										
TRAVEL NOTES: CALLOUT: _____ ONSITE: _____																																										

Well Name:

Well Site location:

Pit Type:

Producing Formation:

Pit Category:

Horizontal Distance to Surface Water:

Vicinity Groundwater Depth:

Jicarilla A #5E

Unit J, Sec. 20, T26N, R5W

Production Tank Pit

Basin Dakota

Non Vulnerable

> 1000 ft.

> 100 ft.

RISK ASSESSMENT (non-vulnerable area)

Pit remediation activities were terminated when trackhoe encountered shale bedrock at 11 feet below grade.

No past or future threat to surface water or groundwater is likely based on the following considerations:

1. Past production fluids were contained locally by a relatively shallow shale bedrock located 11 feet below grade. Groundwater levels located on or close to the well pad are estimated to be at a much greater depth below shale bedrock.
2. Topographic information does not indicate off site lateral fluid migration near the earthen pit.
3. Daily discharge into the earthen pit has been terminated (pit abandoned). Prior discharge into the pit is believed to be under 5 barrels per day.
4. Well site located within the **non-vulnerable area** and is approximately 0.46 miles northwest of the nearest vulnerable area boundary (Tapacito Creek).

(Refer to Gonzales Mesa Quadrangle, New Mexico - Rio Arriba County, 7.5 Minute Series (Topographic), 1963, (vulnerable area boundary developed by Mr. William C. Olson, Hydrogeologist, Environmental Bureau, New Mexico Oil Conservation Division).

Based upon the information given, we conclude that the subsurface lateral impact from the earthen pit is very limited and that the shale bottom creates enough of an impermeable barrier as to subdue impact to groundwater below it (please refer to AMOCO's report "Post Excavation Pit Closure Investigation Summary, July, 1995", with cover letter dated November 30, 1995). AMOCO requests pit closure approval on this location.

ENVIROTECH LABS

PRACTICAL SOLUTIONS FOR A BETTER TOMORROW

EPA METHOD 8015 Modified Nonhalogenated Volatile Organics Total Petroleum Hydrocarbons

Client:	Blagg / AMOCO	Project #:	04034-10
Sample ID:	2 @ 6'	Date Reported:	12-02-98
Laboratory Number:	E237	Date Sampled:	11-30-98
Chain of Custody No:	6412	Date Received:	12-02-98
Sample Matrix:	Soil	Date Extracted:	12-02-98
Preservative:	Cool	Date Analyzed:	12-02-98
Condition:	Cool and Intact	Analysis Requested:	8015 TPH

Parameter	Concentration (mg/Kg)	Det. Limit (mg/Kg)
Gasoline Range (C5 - C10)	5,750	0.2
Diesel Range (C10 - C28)	4,300	0.1
Total Petroleum Hydrocarbons	10,050	0.2

ND - Parameter not detected at the stated detection limit.

References: Method 8015B, Nonhalogenated Volatile Organics, Test Methods for Evaluating Solid Waste, SW-846, USEPA, December 1996.

Comments: Jicarilla A #5E Production Tank Pit.

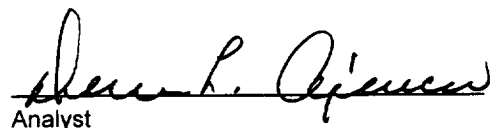
Analyst

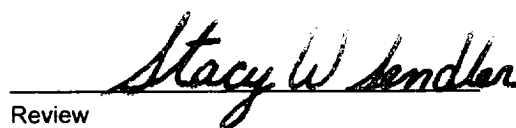
Review

ENVIROTECH LABS

PRACTICAL SOLUTIONS FOR A BETTER TOMORROW

EPA METHOD 8021 AROMATIC VOLATILE ORGANICS

Client:	Blagg / AMOCO	Project #:	04034-10
Sample ID:	2 @ 6'	Date Reported:	12-02-98
Laboratory Number:	E237	Date Sampled:	11-30-98
Chain of Custody:	6412	Date Received:	12-02-98
Sample Matrix:	Soil	Date Analyzed:	12-02-98
Preservative:	Cool	Date Extracted:	12-02-98
Condition:	Cool & Intact	Analysis Requested:	BTEX

Parameter	Concentration (ug/Kg)	Det. Limit (ug/Kg)
Benzene	2,790	8.8
Toluene	3,370	8.4
Ethylbenzene	3,440	7.6
p,m-Xylene	16,150	10.8
o-Xylene	8,330	5.2
Total BTEX	34,080	

ND - Parameter not detected at the stated detection limit.

Surrogate Recoveries:	Parameter	Percent Recovery
	Trifluorotoluene	101 %
	Bromofluorobenzene	101 %

References: Method 5030B, Purge-and-Trap, Test Methods for Evaluating Solid Waste, SW-846, USEPA, December 1996.

Method 8021B, Aromatic Volatile Organics, Test Methods for Evaluating Solid Waste, SW-846, USEPA, December 1996.

Comments: Jicarilla A #5E Production Tank Pit.

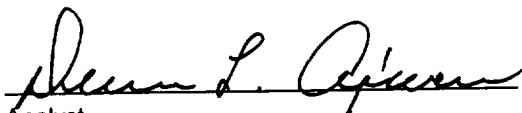
Analyst

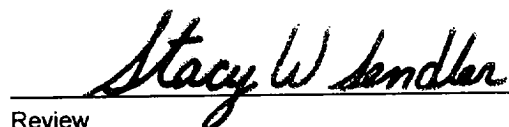
Review

6412

[illegible]

JICARILLA APACHE TRIBE
ENVIRONMENTAL PROTECTION OFFICE
P.O. BOX 507
DULCE, NEW MEXICO 87528

8J679

SUBMIT 1 COPY TO:
NATURAL RESOURCE DEPT.
AND OIL & GAS ADMINISTRATION

PIT REMEDIATION AND CLOSURE REPORT

Operator: AMOCO PRODUCTION COMPANY Telephone: (505) 326-9200
Address: 200 Amoco Court, Farmington, NM 87401
Facility or Well Name: JICARILLA A # 5E
Location: Unit or Qtr/Qtr Sec I Sec 20 T 26N R 5W County RIO ARIZONA
Pit Type: Separator ☒ Dehydrator ☐ Other ☐
Land Type: RANGE

Pit Location: Pit dimensions: length 36', width 21', depth 13'
(Attach diagram) Reference: wellhead ☒, other ☐
Footage from reference: 120'
Direction from reference: 14 Degrees ☒ East of North ☐
West of South ☒

Depth To Groundwater:

(Vertical distance from
contaminants to seasonal
high water elevation of
groundwater)

Less than 50 feet	(20 points)	
50 feet to 99 feet	(10 points)	<u>0</u>
Greater than 100 feet	(0 points)	

Distance to an Ephemeral Stream

(Downgradient dry wash greater than
ten feet in width)

Less than 100 feet	(10 points)	<u>0</u>
Greater than 100 feet	(0 points)	

Distance to Nearest Lake, Playa, or Watering Pond

(Downgradient lakes, playas and
livestock or wildlife watering ponds)

Less than 100 feet	(10 points)	<u>0</u>
Greater than 100 feet	(0 points)	

Wellhead Protection Area:

(Less than 200 feet from a private
domestic water source, or: less than
1000 feet from all other water sources)

Yes	(20 points)	<u>0</u>
No	(0 points)	

Distance To Surface Water:

(Horizontal distance to perennial
lakes, ponds, rivers, streams, creeks,
irrigation canals and ditches)

Less than 100 feet	(20 points)	
100 feet to 1000 feet	(10 points)	<u>0</u>
Greater than 1000 feet	(0 points)	

RANKING SCORE (TOTAL POINTS): 0

Date Remediation Started: _____

Date Completed: 11/23/98Remediation Method: Excavation ☒
(check all appropriate sections)Approx. cubic yards 300Landfarmed ☒

Insitu Bioremediation _____

Other _____

Remediation Location:
(i.e. landfarmed onsite,
name and location of
offsite facility)Onsite ☒ Offsite _____General Description of Remedial Action: Excavation. BEDROCK BOTTOM.Groundwater Encountered: No ☒ Yes _____ Depth _____

Final Pit:

Closure Sampling:
(if multiple samples,
attach sample results
and diagram of sample
locations and depths)Sample location see Attached DocumentsSample depth 9' (NORTH SIDEWALL)Sample date 11/19/98 Sample time 1045

Sample Results

Soil: Benzene	(ppm)	<u>0.249</u>	Water: Benzene	(ppb)	_____
Total BTEX	(ppm)	<u>6.840</u>	Toluene	(ppb)	_____
Field Headspace	(ppm)	<u>112.1</u>	Ethylbenzene	(ppb)	_____
TPH	(ppm)	<u>3280</u>	Total Xylenes	(ppb)	_____

Groundwater Sample: Yes _____ No ☒ (If yes, attach sample results)

I HEREBY CERTIFY THAT THE INFORMATION ABOVE IS TRUE AND COMPLETE TO THE BEST OF MY KNOWLEDGE AND BELIEF

DATE 11/23/98 PRINTED NAME Buddy D. ShawSIGNATURE Buddy D. Shaw AND TITLE Environmental Coordinator

AFTER REVIEW OF THE PIT CLOSURE INFORMATION, PIT CLOSURE IS APPROVED IN ACCORDANCE TO THE JICARILLA APACHE TRIBE PIT CLOSURE ORDINANCE.

APPROVED: YES ☒ NO _____ (REASON) _____SIGNED: Kenneth C. McNeill DATE: 12-28-98

CLIENT: <u>Amoco</u>	BLAGG ENGINEERING, INC. P.O. BOX 87, BLOOMFIELD, NM 87413 (505) 632-1199	LOCATION NO: <u>57679</u> C.D.C. NO: <u>6307</u>
----------------------	--	---

FIELD REPORT: CLOSURE VERIFICATION	PAGE No: <u>1</u> of <u>1</u>
LOCATION: NAME: <u>JICA</u> A WELL #: <u>5E</u> PIT: <u>SEP</u>	DATE STARTED: <u>11/19/98</u>
QUAD/UNIT: <u>J</u> SEC: <u>20</u> TWP: <u>26N</u> RNG: <u>5W</u> PM: <u>NM</u> CNTY: <u>RA</u> ST: <u>NM</u>	DATE FINISHED: _____
OTR/FOOTAGE: <u>1560' F-1/1610' FEL</u> CONTRACTOR: <u>P+S</u>	ENVIRONMENTAL SPECIALIST: <u>NV</u>

EXCAVATION APPROX. <u>36</u> FT. x <u>21</u> FT. x <u>13</u> FT. DEEP. CUBIC YARDAGE: <u>300</u>
DISPOSAL FACILITY: <u>ON-SITE</u> REMEDIATION METHOD: <u>LANDFARM</u>
LAND USE: <u>RANGE</u> LEASE: <u>JICA</u> FORMATION: <u>DK</u>

FIELD NOTES & REMARKS:	PIT LOCATED APPROXIMATELY <u>120</u> FT. <u>S14E</u> FROM WELLHEAD.
DEPTH TO GROUNDWATER: <u>>100'</u>	NEAREST WATER SOURCE: <u>>1000'</u> NEAREST SURFACE WATER: <u>>1000'</u>
NMOC RANKING SCORE: <u>0</u>	NMOC TPH CLOSURE STD: <u>5000</u> PPM
SOIL AND EXCAVATION DESCRIPTION:	

SIDEWALLS-DK. YELL. ORANGE SAND NON COHESIVE SLIGHTLY MOIST, FIRM, STAINING OBSERVED ON NORTH SIDEWALL BEI. 2'-7' BELOW GRADE IN MOSTLY CENTER ON SIDEWALL DK. YELL. BROWN CLAY BOTTOM 6' OF SIDEWALLS, HC ODOOR DETECTED IN NORTH & SOUTH SIDEWALL DUM SAMPLES.

BOTTOM - BEDROCK (SHALE), LT. GRAY, HARD, HC ODOOR DETECTED IN DUM SAMPLE.

BEDROCK BOTTOM

CLOSED

FIELD 4131 CALCULATIONS

TIME	SAMPLE I.D.	LAB No:	WEIGHT (g)	mL. FREON	DILUTION	READING	CALC. ppm

SCALE
0 FT

PIT PERIMETER

OVM RESULTS

PIT PROFILE

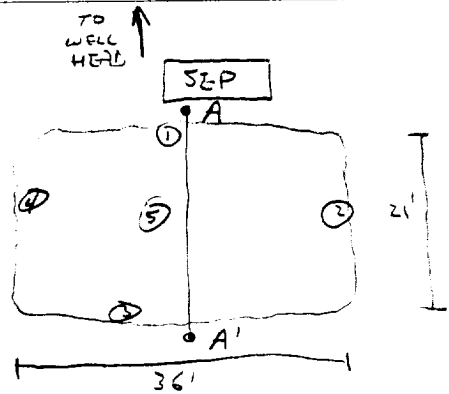

SAMPLE ID	FIELD HEADSPACE PID (ppm)
1 @ 9'	112.1
2 @ 9'	0.0
3 @ 8'	77.6
4 @ 9'	0.0
5 @ 13'	99.6

SAMPLE ID	ANALYSIS	TIME
1 @ 9'	TPH/BTEX	1045
<u>BOTH PASSED</u>		

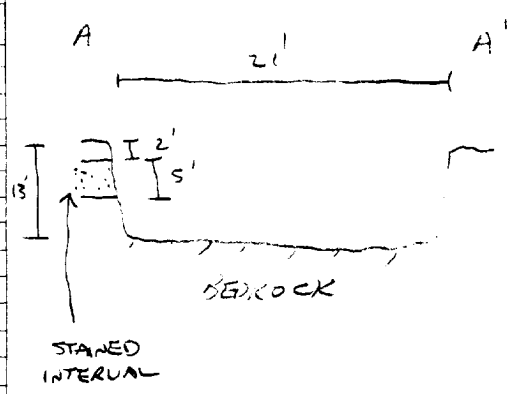

TRAVEL NOTES:	CALLOUT: _____	ONSITE: _____
---------------	----------------	---------------

ENVIROTECH LABS

PRACTICAL SOLUTIONS FOR A BETTER TOMORROW

EPA METHOD 8015 Modified Nonhalogenated Volatile Organics Total Petroleum Hydrocarbons

Client:	Blagg / AMOCO	Project #:	04034-10
Sample ID:	1 @ 9'	Date Reported:	11-23-98
Laboratory Number:	E200	Date Sampled:	11-19-98
Chain of Custody No:	6307	Date Received:	11-20-98
Sample Matrix:	Soil	Date Extracted:	11-23-98
Preservative:	Cool	Date Analyzed:	11-23-98
Condition:	Cool and Intact	Analysis Requested:	8015 TPH

Parameter	Concentration (mg/Kg)	Det. Limit (mg/Kg)
Gasoline Range (C5 - C10)	1,950	0.2
Diesel Range (C10 - C28)	1,330	0.1
Total Petroleum Hydrocarbons	3,280	0.2

ND - Parameter not detected at the stated detection limit.

References: Method 8015B, Nonhalogenated Volatile Organics, Test Methods for Evaluating Solid Waste, SW-846, USEPA, December 1996.

Comments: Jicarilla A #5E Separator Pit.

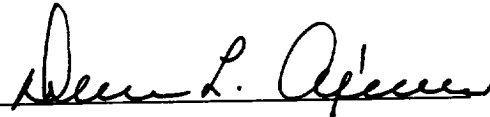
Analyst

Review

ENVIROTECH LABS

PRACTICAL SOLUTIONS FOR A BETTER TOMORROW

EPA METHOD 8021 AROMATIC VOLATILE ORGANICS

Client:	Blagg / AMOCO	Project #:	04034-10
Sample ID:	1 @ 9'	Date Reported:	11-23-98
Laboratory Number:	E200	Date Sampled:	11-19-98
Chain of Custody:	6307	Date Received:	11-20-98
Sample Matrix:	Soil	Date Analyzed:	11-23-98
Preservative:	Cool	Date Extracted:	11-23-98
Condition:	Cool & Intact	Analysis Requested:	BTEX

Parameter	Concentration (ug/Kg)	Det. Limit (ug/Kg)
Benzene	249	8.8
Toluene	1,010	8.4
Ethylbenzene	859	7.6
p,m-Xylene	4,160	10.8
o-Xylene	565	5.2
Total BTEX	6,840	

ND - Parameter not detected at the stated detection limit.

Surrogate Recoveries:	Parameter	Percent Recovery
	Trifluorotoluene	95 %
	Bromofluorobenzene	95 %

References: Method 5030B, Purge-and-Trap, Test Methods for Evaluating Solid Waste, SW-846, USEPA, December 1996.

Method 8021B, Aromatic Volatile Organics, Test Methods for Evaluating Solid Waste, SW-846, USEPA, December 1996.

Comments: Jicarilla A #5E Separator Pit.

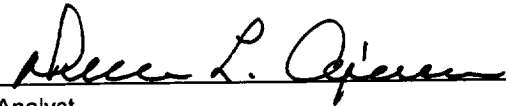
Analyst

Review

6307

Client / Project Name			Project Location		SEPARATOR PIT		ANALYSIS / PARAMETERS					
BURGG / Amoco			TICARILL A # 5 E									
Sampler: NTV			Client No. 04034-10		No. of Containers		Remarks					
Sample No./ Identification	Sample Date	Sample Time	Lab Number	Sample Matrix	1	TPH (8015)	BTX (8021)					
① @ 9'	11/19/98	1045	E 200	SOIL	✓	✓	RESERV. - COOL					
Relinquished by: (Signature)			Date	Time	Received by: (Signature)		Date	Time				
[Signature]			11/20/98	0749	[Signature]		11/20/98	0749				
Relinquished by: (Signature)					Received by: (Signature)							
[Signature]					[Signature]							
Relinquished by: (Signature)					Received by: (Signature)							
[Signature]					[Signature]							
Ref C&C's 6306-6309			ENVIROTECH INC.									
5796 U.S. Highway 64			Farmingington, New Mexico 87401									
(505) 632-0615												
Sample Receipt												
Received Intact			Y N N/A									
Cool - Ice/Blue Ice			✓									

**JICARILLA APACHE TRIBE
ENVIRONMENTAL PROTECTION OFFICE
P.O. BOX 507
DULCE, NEW MEXICO 87528**

SUBMIT 1 COPY TO
NATURAL RESOURCE DEPT
AND OIL & GAS ADMINISTRATION

ON-SITE SOIL REMEDIATION REPORT

Operator: <u>AMOCO PRODUCTION COMPANY</u>		Telephone: <u>(505) 326-9200</u>	
Address: <u>200 Amoco Court, Farmington, NM 87401</u>			
Facility or Well Name: <u>JICARILLA A SE</u>			
Location: Unit or Qtr/Qtr Sec <u>3</u> Sec <u>20</u> T <u>26N</u> R <u>5W</u> County <u>RIO ARIZONA</u>			
Land Type: <u>RANGE</u>			
Date Remediation Started: <u>11 30 98</u>		Date Completed: <u>6/4/99</u>	
Remediation Method: Landfarmed <input checked="" type="checkbox"/>		Approx. cubic yards <u>375</u>	
Composted <input type="checkbox"/>			
Other <input type="checkbox"/>			
Depth To Groundwater: (pts.) <u>0</u>		Final Closure Sampling:	
Distance to an Ephemeral Stream (pts.) <u>0</u>		Sampling Date: <u>6 2 99</u> Time: <u>1350</u>	
Distance to Nearest Lake, Playa, or Watering Pond (pts.) <u>0</u>		Sample Results:	
Wellhead Protection Area: (pts.) <u>0</u>		Field Headspace (ppm) <u>36.8</u>	
Distance To Surface Water: (pts.) <u>0</u>		TPH (ppm) <u>97.8</u> Method <u>TPH (FOIS)</u>	
RANKING SCORE (TOTAL POINTS): <u>0</u>		Other <input type="checkbox"/>	
I HEREBY CERTIFY THAT THE INFORMATION ABOVE IS TRUE AND COMPLETE TO THE BEST OF MY KNOWLEDGE AND BELIEF			
DATE <u>6/4/99</u>		PRINTED NAME <u>Buddy D. Shaw</u>	
SIGNATURE <u>Buddy D. Shaw</u>		AND TITLE <u>Environmental Coordinator</u>	
AFTER REVIEW OF THE SOIL REMEDIATION INFORMATION, ON-SITE REMEDIATION IS APPROVED IN ACCORDANCE TO THE JICARILLA APACHE TRIBE PIT CLOSURE ORDINANCE.			
APPROVED: YES <input checked="" type="checkbox"/> NO <input type="checkbox"/> (REASON) _____			
SIGNED: <u>K. C. Man</u>		DATE: <u>6-18-99</u>	

CLIENT: <u>AMOCO</u>	BLAGG ENGINEERING, INC. P.O. BOX 87, BLOOMFIELD, NM 87413 (505) 632-1199	LOCATION NO: <u>BJ679</u> C.D.C. NO: <u>7062</u>
----------------------	---	---

FIELD REPORT: LANDFARM/COMPOST PILE CLOSURE VERIFICATION

LOCATION: NAME: <u>JICARILLA A</u> WELL #: <u>5E</u> PITS: <u>SEP, PROD.</u> QUAD/UNIT: <u>J</u> SEC: <u>20</u> TWP: <u>26N</u> RNG: <u>5W</u> PM: <u>NM</u> CNTY: <u>RA</u> ST: <u>NM</u> QTR/FOOTAGE: <u>NW/4 SE/4</u> CONTRACTOR: <u>P+S</u>	DATE STARTED: <u>6-2-99</u> DATE FINISHED: _____ ENVIRONMENTAL SPECIALIST: <u>REP</u>
---	---

SOIL REMEDIATION:

REMEDIATION SYSTEM: <u>LANDFARM</u>	APPROX. CUBIC YARDAGE: <u>375</u>
LAND USE: <u>RANGE</u>	LIFT DEPTH (ft): <u>1'</u>

FIELD NOTES & REMARKS:

DEPTH TO GROUNDWATER: >100' NEAREST WATER SOURCE: >1000' NEAREST SURFACE WATER: >1000'

NMOCB RANKING SCORE: 0 NMOCB TPH CLOSURE STD: 5000 PPM

DK. YELLOWISH BROWN-ORANGE SAND, NON COHESIVE, SLIGHTLY MOIST, FIEM.
 LARGE AREA OF STAINING OBSERVED IN LANDFARM AREA. (SEE SKETCH BELOW)
 HC. ODDOR DETECTED IN SAMPLING PTS ④ & ⑤. SAMPLING DEPTHS RANGE FROM 6"-10". COLLECTED A SPT. COMPOSITE SAMPLE FOR LAB ANALYSIS!

CLOSED

FIELD 418.1 CALCULATIONS

SAMP. TIME	SAMPLE I.D.	LAB No:	WEIGHT (g)	mL. FREON	DILUTION	READING	CALC. ppm

SKETCH/SAMPLE LOCATIONS

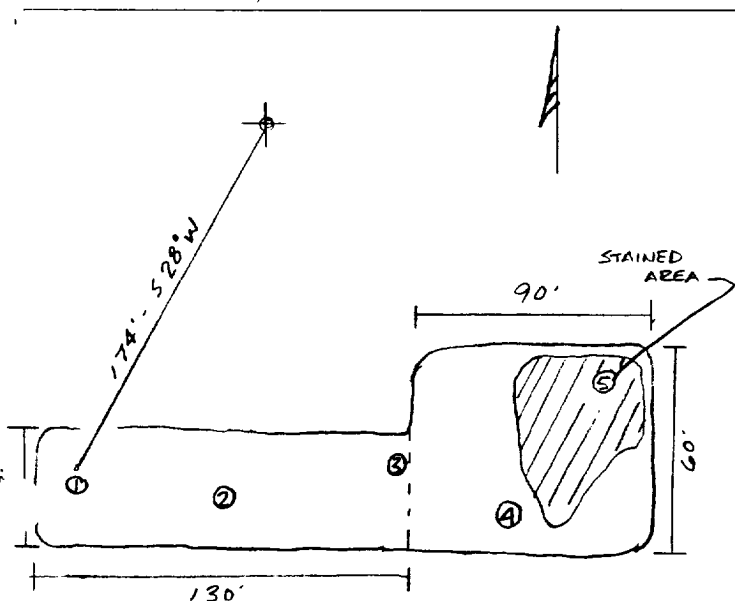

OVM RESULTS

LAB SAMPLES

SAMPLE ID	FIELD HEADSPACE PID (ppm)	SAMPLE ID	ANALYSIS	TIME	RESULTS
LF-1	36.8	LF-1	TPH (8015)	1350	97.8

SCALE

0 FT

TRAVEL NOTES:

CALLOUT: NA

ONSITE: 6-2-99

ENVIROTECH LABS

PRACTICAL SOLUTIONS FOR A BETTER TOMORROW

EPA METHOD 8015 Modified
Nonhalogenated Volatile Organics
Total Petroleum Hydrocarbons

Client:	Blagg / AMOCO	Project #:	403410
Sample ID:	LF - 1	Date Reported:	06-04-99
Laboratory Number:	F452	Date Sampled:	06-02-99
Chain of Custody No:	7062	Date Received:	06-03-99
Sample Matrix:	Soil	Date Extracted:	06-03-99
Preservative:	Cool	Date Analyzed:	06-04-99
Condition:	Cool and Intact	Analysis Requested:	8015 TPH

Parameter	Concentration (mg/Kg)	Det. Limit (mg/Kg)
Gasoline Range (C5 - C10)	13.5	0.2
Diesel Range (C10 - C28)	84.3	0.1
Total Petroleum Hydrocarbons	97.8	0.2

ND - Parameter not detected at the stated detection limit.

References: Method 8015B, Nonhalogenated Volatile Organics, Test Methods for Evaluating Solid Waste, SW-846, USEPA, December 1996.

Comments: Jicarilla A - 5E Landfarm. 5 Pt. Composite.

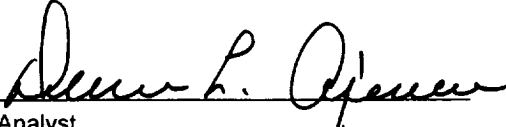
Analyst

Review

7062

[illegible]