

OIL CONSERVATION DIVISIO.

STATE OF NEW MEXICO
ENERGY AND MINERALS DEPARTMENT

P. O. BOX 2088

SANTA FE, NEW MEXICO 87501

Form C-107
Revised 10-1-73

All distances must be from the outer boundaries of the Section.

Operator MARATHON OIL COMPANY		Lease JICARILLA APACHE		Well No. 12E
Unit Letter J	Section 33	Township 26N	Range 5W	County Rio Arriba
Actual Footage Location of Well: 1685 feet from the South line and 1685 feet from the East line				
Ground Level Elev: 6573	Producing Formation Point Lookout	Pool Blanco Mesaverde	Dedicated Acreage: 320 Acres	

1. Outline the acreage dedicated to the subject well by colored pencil or hachure marks on the plat below.
2. If more than one lease is dedicated to the well, outline each and identify the ownership thereof (both as to working interest and royalty).
3. If more than one lease of different ownership is dedicated to the well, have the interests of all owners been consolidated by communitization, unitization, force-pooling, etc?

☐ Yes ☐ No If answer is "yes," type of consolidation N/A

If answer is "no," list the owners and tract descriptions which have actually been consolidated. (Use reverse side of this form if necessary.)

No allowable will be assigned to the well until all interests have been consolidated (by communitization, unitization, forced-pooling, or otherwise) or until a non-standard unit, eliminating such interests, has been approved by the Commission. **BLANCO MESAVERDE CERTIFICATION 11-16-81. DALE T. CADDY**

CERTIFICATION

I hereby certify that the information contained herein is true and complete to the best of my knowledge and belief.

Name
Dale T. Caddy
Position
District Operations Manager
Company
Marathon Oil Company
Date
November 21, 1980

I hereby certify that the well location shown on this plat was plotted from field notes of actual surveys made by me or under my supervision, and that the same is true and correct to the best of my knowledge and belief.

Date Surveyed
November 11, 1980
Registered Professional Engineer
and Land Surveyor
James B. Kery Jr.
Certification No. **3950**
FEB 1981

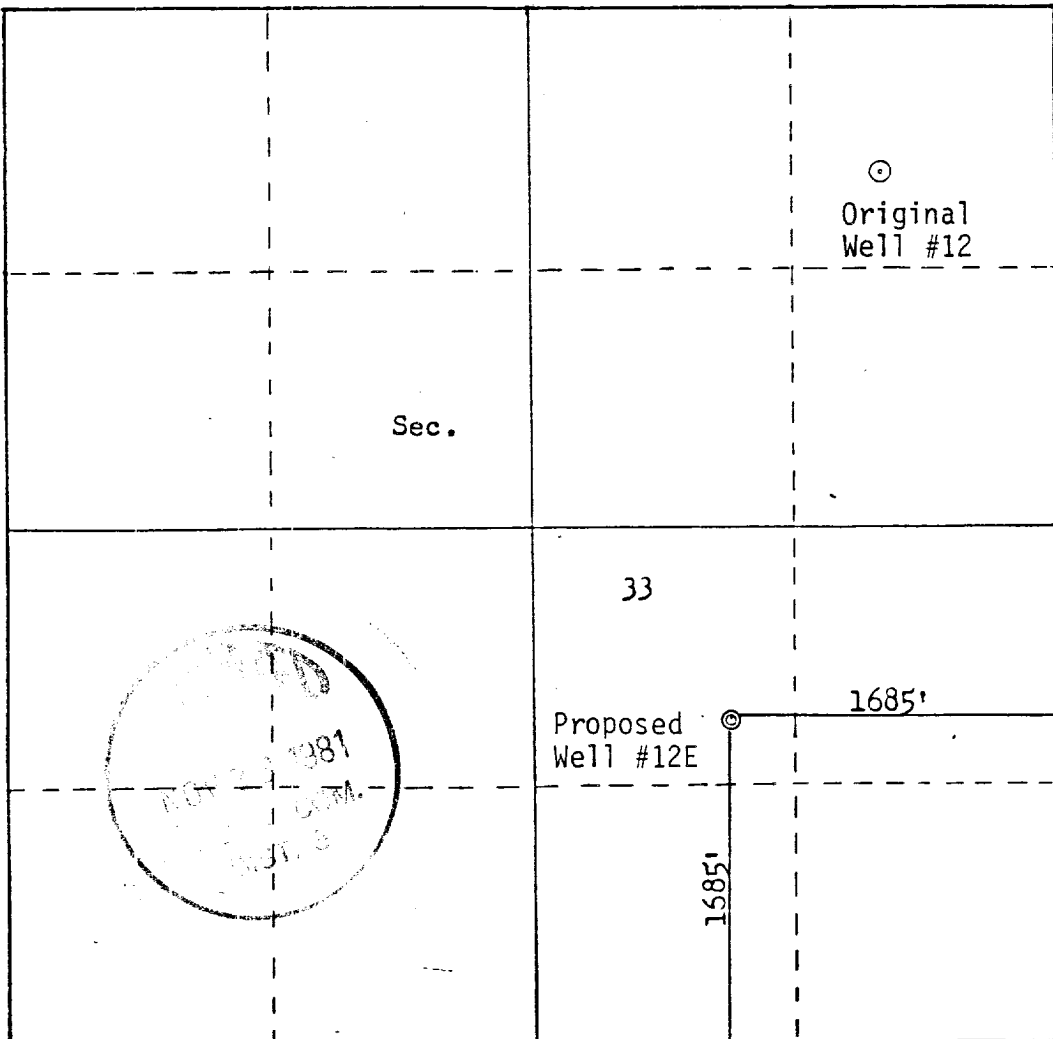

Scale: 1"=1000'