

UNITED STATES  
DEPARTMENT OF THE INTERIOR  
GEOLOGICAL SURVEY

## APPLICATION FOR PERMIT TO DRILL, DEEPEN, OR PLUG BACK

## 1a. TYPE OF WORK

DRILL ☒DEEPEN ☐PLUG BACK ☐

## b. TYPE OF WELL

OIL  
WELL ☐GAS  
WELL ☒

OTHER

SINGLE  
ZONE ☒MULTIPLE  
ZONE ☐

## 2. NAME OF OPERATOR

Curtis J. Little

## 3. ADDRESS OF OPERATOR

Box 2487, Farmington, New Mexico 87404

## 4. LOCATION OF WELL (Report location clearly and in accordance with appropriate requirements.)

At surface

1820' FNL and 1840 FEL

At proposed prod. zone

Same

## 14. DISTANCE IN MILES AND DIRECTION FROM NEAREST TOWN OR POST OFFICE\*

25 miles SE of Blanco, New Mexico

## 15. DISTANCE FROM PROPOSED\*

LOCATION TO NEAREST  
PROPERTY OR LEASE LINE, FT.  
(Also to nearest drig. unit line, if any)

1820'

## 18. DISTANCE FROM PROPOSED LOCATION\*

TO NEAREST WELL, DRILLING, COMPLETED,  
OR APPLIED FOR, ON THIS LEASE, FT.

## 16. NO. OF ACRES IN LEASE

1280

## 19. PROPOSED DEPTH

2905'

17. NO. OF ACRES ASSIGNED  
TO THIS WELL

160

## 20. ROTARY OR CABLE TOOLS

Rotary

## 21. ELEVATIONS (Show whether DF, RT, GR, etc.)

6931 GL

DRILLING OPERATIONS AUTHORIZED ARE  
SUBJECT TO COMPLIANCE WITH ATTACHED

## 22. APPROX. DATE WORK WILL START\*

9-1-81

## 23.

PROPOSED CASING AND CEMENTING PROGRAM

This action is subject to administrative  
appeal pursuant to 30 CFR 290.

SIZE OF HOLE	SIZE OF CASING	WEIGHT PER FOOT	SETTING DEPTH	
8 3/4	7.000	23#	120'	100 sx. circulate
6 1/4	2 7/8	6.4#	2905'	225 sx. cover Ojo Alamo

Propose to drill with mud, run mechanical logs, and selectively perforate and sand water fracture the Picture Cliff formation. BHP is not expected to exceed 800 psi. A 10" 3000 psi working pressure and 6000 psi test BOP with blind and pipe rams will be used for blow out prevention.

The gas is ~~not~~ dedicated to EVAC

IN ABOVE SPACE DESCRIBE PROPOSED PROGRAM: If proposal is to deepen or plug back, give data on present productive zone and proposed new productive zone. If proposal is to drill or deepen directionally, give pertinent data on subsurface locations and measured and true vertical depths. Give blowout prevention program, if any.

## 24.

SIGNED

Curtis J. Little

TITLE

Operator

DATE

7-10-81

(This space for Federal or State office use)

PERMIT NO.

APPROVAL DATE

APPROVED BY

TITLE

CONDITIONS OF APPROVAL, IF ANY:

APPROVED  
AS AMENDED

DATE

AUG 7 1981  
JAMES F. SIMS  
DISTRICT ENGINEER

NMOCC

## OIL CONSERVATION DIVISION

P. O. BOX 2088

SANTA FE, NEW MEXICO 87501

Form C-107  
Revised 10-1-77

STATE OF NEW MEXICO

ENERGY AND MINERALS DEPARTMENT

All distances must be from the outer boundaries of the Section.

Operator <b>CURTIS J. LITTLE</b>			Lease <b>Salazar</b>		Well No. <b>2</b>
Unit Letter <b>G</b>	Section <b>5</b>	Township <b>25N</b>	Range <b>7W</b>	County <b>Rio Arriba</b>	
Actual Footage Location of Well: <b>1820</b> feet from the <b>North</b> line and <b>1840</b> feet from the <b>East</b> line					
Ground Level Elev: <b>6931</b>	Producing Formation <b>Pictured Cliff</b>		Pool <b>Ballard</b>		Dedicated Acreage: <b>160</b> Acres

1. Outline the acreage dedicated to the subject well by colored pencil or hachure marks on the plat below.
2. If more than one lease is dedicated to the well, outline each and identify the ownership thereof (both as to working interest and royalty).
3. If more than one lease of different ownership is dedicated to the well, have the interests of all owners been consolidated by communitization, unitization, force-pooling, etc?

☐ Yes ☐ No If answer is "yes," type of consolidation \_\_\_\_\_

If answer is "no," list the owners and tract descriptions which have actually been consolidated. (Use reverse side of this form if necessary.) \_\_\_\_\_

No allowable will be assigned to the well until all interests have been consolidated (by communitization, unitization, forced-pooling, or otherwise) or until a non-standard unit, eliminating such interests, has been approved by the Commission.

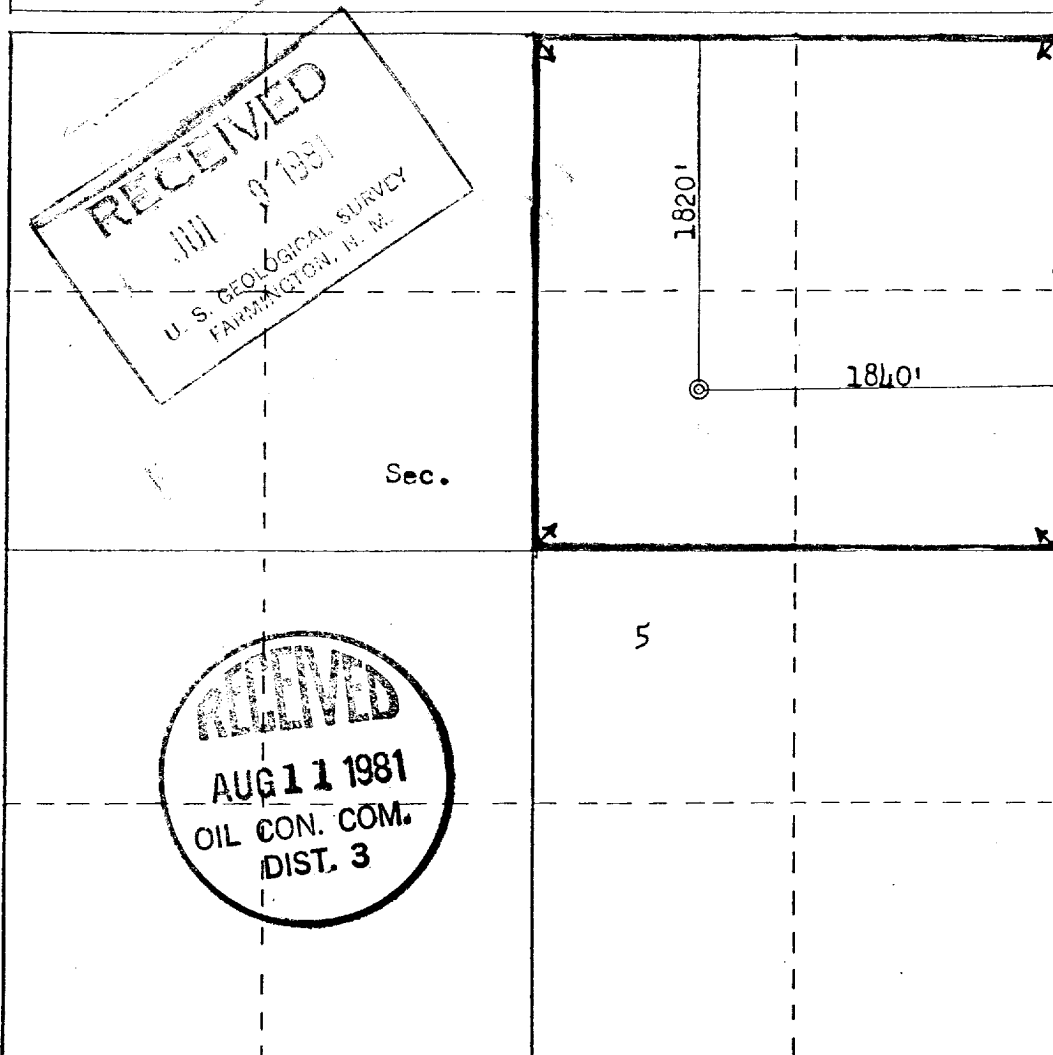

Scale: 1"=1000'

## CERTIFICATION

I hereby certify that the information contained herein is true and complete to the best of my knowledge and belief.

Name  
**Curtis J. Little**  
Position  
**Operator**  
Company  
**Curtis J. Little**  
Date  
**7-10-81**

I hereby certify that the well location shown on this plat was plotted from field notes of actual surveys made by me or under my supervision, and that the same is true and correct to the best of my knowledge and belief.

Date Surveyed  
**June 25, 1981**  
Registered Professional Engineer  
and Land Surveyor  
**Fred B. Kerr, Jr.**  
Certificate No.  
**3950**

R 7 W

<div>Kindall *3</div> <div>CJL 025,</div>	<div>Foghorn *10</div>
<div>Kindall *4</div> <div>CJL 020</div> <div>Kindall *1</div>	<div>Kindall *2</div> <div>CJL 020</div>

I  
25  
N

Operation Plan                      Salazar #2

Company: Curtis J. Little  
County: Rio Arriba, New Mexico

1. Location: G-5-25N-7W  
Field: Ballard Pictured Cliff  
Elevation: 6931 GL
2. Geology:  
Formation Tops:    Surface:    San Jose  
Ojo Alamo                      2065'  
Kirtland                        2215'  
Fruitland                       2515'  
Pictured Cliff                 2765'  
TD                                2905'

Logging Program: I-ES and Gamma Ray Density logs.

Coring Program: None planned

3. Drilling:  
Mud Program: Water base mud system with 9.0 / 9.4 ppg. wt.  
35-45 seconds vis. Surface to TD.

4. Materials:  
Casing Program:                      

<u>Hole Size</u>	<u>Depth</u>	<u>Casing</u>	<u>Wt. &amp; Grade</u>	
8 3/4	120'	7"	23#	K-55
6 1/4	2345'	2 7/8	6.4#	J-55

Float Equipment: Insert float

Tubing: None/ Slim hole

Wellhead Equipment: 2000 psi WP and 4000 psi test.

5. Cementing: Long string will be calculated to 20% excess  
to cover the Ojo Alamo with class B neat.

1. Existing Roads Refer to Map which shows the existing roads. New roads which will be required have been marked on this map. All existing and new roads will be properly maintained during this period.
2. Planned Access Roads The grade of the access roads will be consistent with that of the local terrain. The road surface will not exceed 20 feet (20') in width. Upon completion all roads will be adequately drained to control soil erosion. Drainage facilities may include ditches, water bars, culverts or other measures necessary to insure proper drainage.
3. Location of Existing Wells See Attached map.
4. Location of Tank Batteries, Production facilities, and production Gathering and Service Lines If well is productive, it would be dry gas. No oil is anticipated. All flow lines will be buried across the location.
5. Location and Type of water supply No arrangement for water had been made at this time.
6. Source of Construction Materials All construction material will be purchased and hauled to the location. No additional Materials will be required.
7. Methods of Handling Waste Materials
  - a. Cuttings will be buried 3' below surface.
  - b. Drilling fluid will be left in a fenced, open pit to evaporate.
  - c. Portable toilet to be provided.
  - d. Trash will be burned in burn pit then buried.
  - e. After pit area is dry, cuttings will be pushed into pit and sub soil will be placed on any remaining fluid and cutting then top soil will be placed over both pit and location area.

8. - Ancillary Facilities

No camps or airstrip will be associated with this project.

9. Well site Layout

Refer to attached plat.

10. Plans for Restoration

After completion of the proposed project, the location will be cleaned and leveled. The location will be left in such a condition that will enable reseeding operations to be carried out as controlled by the regulatory body.

11. Other Information

Terrain is low hills with grass, cedar, and pinon. Slope is to the North and South.

12. Operator's Representative

Curtis J. Little  
P.O. Box 2487  
Farmington, New Mexico 87401

Home: 505-327-6673

Office: 505-327-6176

---

Agent: Joe Elledge  
200 West 25th Street  
Farmington, New Mexico 87401

505-327-9267

---

13. Certification

I hereby certify that I, or persons under my supervision, have inspected the proposed drill site and access route, that I am familiar with the conditions which presently exist; that the statements made in this plan are, to the best of my knowledge, true and correct; and, that the work associated with the operations proposed herein will be performed by Curtis J. Little, and its contractors and sub-contractors in conformity with this plan and the terms and conditions under which it is approved.

Date: 7-10-81

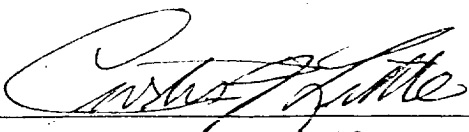
  
Curtis J. Little.

Curtis J. Little  
Salazar #2  
G-5-25-7  
Rio Arriba, New Mexico

### BLOWOUT PREVENTOR DIAGRAM

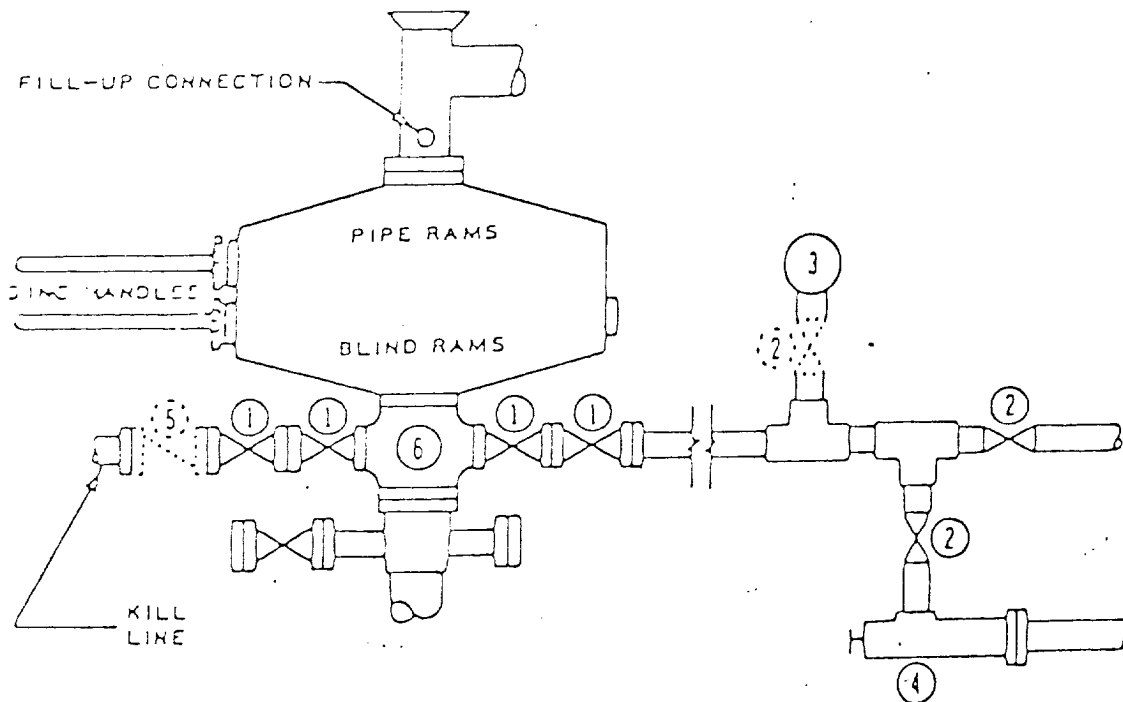

- ① 2" SERIES 900 FE VALVE
- ② 2" SERIES 900 SE VALVE
- ③ 2" 3000 LB MUD PRESSURE GAUGE
- ④ 2" SERIES 900 CHOKE
- ⑤ 2" SERIES 900 CHECK VALVE
- ⑥ SERIES 900 DRLG SPOOL

NOTE:

- 1. 3000 PSI W/P CLAMP HUBS  
MAY BE SUBSTITUTED FOR  
FLANGES

Curtis J. Little  
Salazar #2  
G-5-25-7  
Rio Arriba, N.M.  
Ballard P.C.

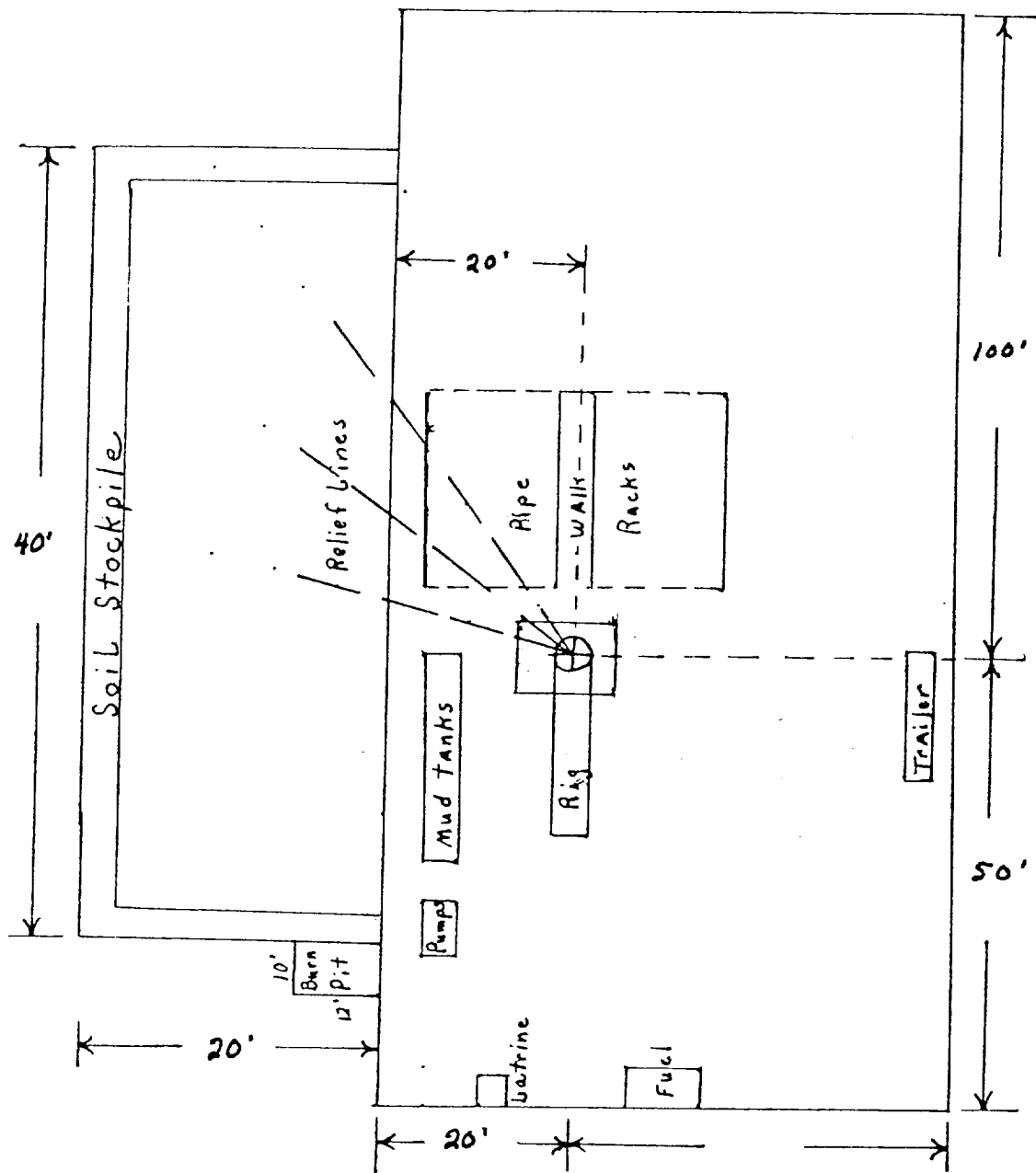



1820' FNL 1840' FEL Sec. 5-T25N-R7W  
Salazar #2

Vicinity Map for

CURTIS J. LITTLE #

