

All distances must be from the outer boundaries of the Section.

AMENDED

Operator MERRION OIL & GAS CORPORATION			Lease Fikes Com		Well No. No. 2
Unit Letter F	Section 27	Township 25N	Range 6W	County Rio Arriba	
Actual Footage Location of Well: 2110 feet from the North line and 1650 feet from the West line					
Ground Level Elev. 6353	Producing Formation Gallup		Pool Devils Fork Gallup		Dedicated Acreage: 160

1. Outline the acreage dedicated to the subject well by colored pencil or hatchure marks on the plat below.
2. If more than one lease is dedicated to the well, outline each and identify the ownership thereof (both as to working interest and royalty).
3. If more than one lease of different ownership is dedicated to the well, have the interests of all owners been consolidated by communitization, unitization, force-pooling, etc?

☒ Yes ☐ No If answer is "yes," type of consolidation - communitized

If answer is "no," list the owners and tract descriptions which have actually been consolidated. (Use reverse side of this form if necessary.)

No allowable will be assigned to the well until all interests have been consolidated (by communitization, unitization, forced-pooling, or otherwise) or until a non-standard unit, eliminating such interests, has been approved by the Commission.

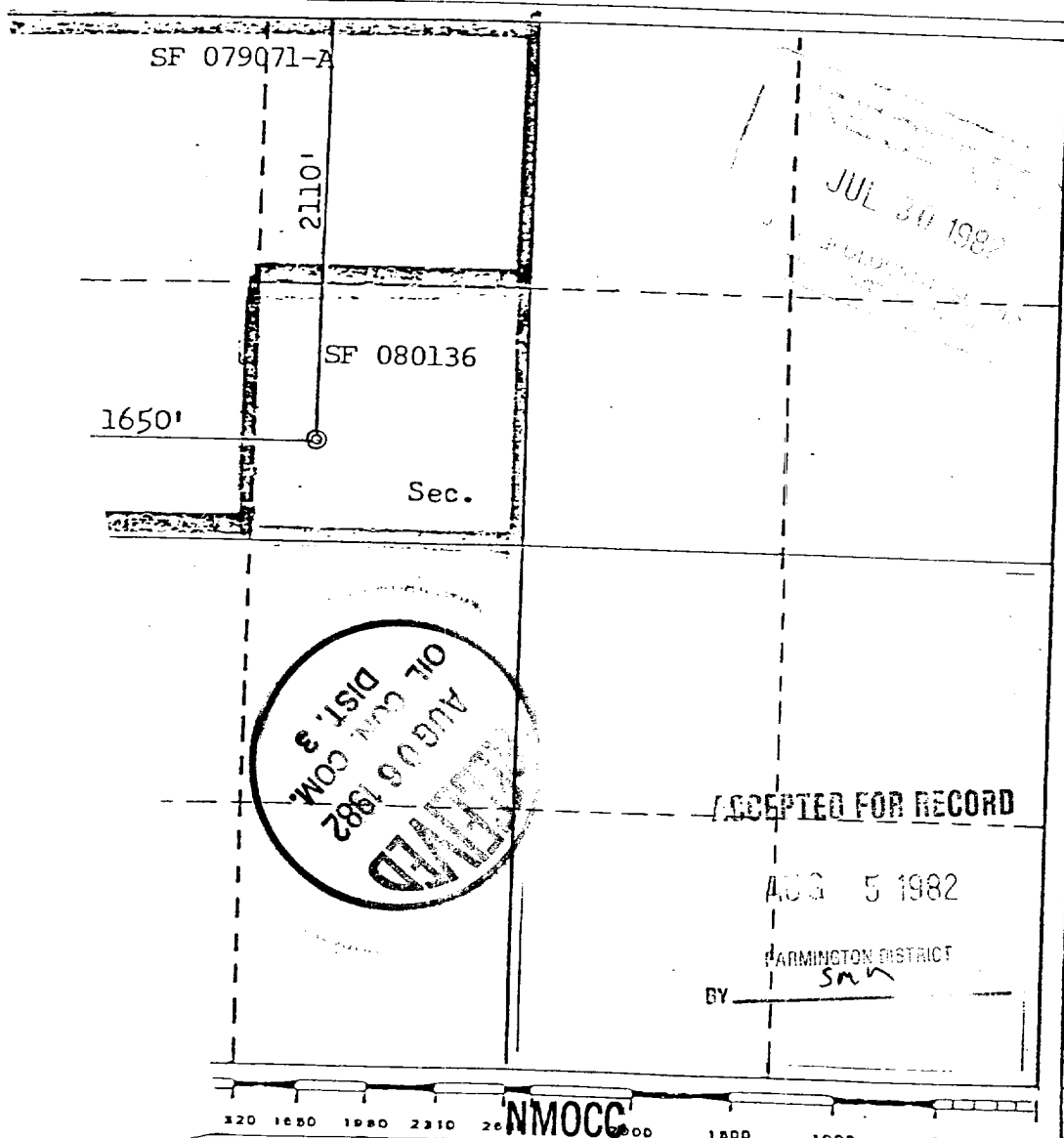

CERTIFICATION

I hereby certify that the information contained herein is true and complete to the best of my knowledge and belief.

Name
J. Gregory Merrion

Position
President

Company
Merrion Oil & Gas Corp.

Date
7/28/82

I hereby certify that the well location shown on this plat was plotted from field notes of actual surveys made by me or under my supervision, and that the same is true and correct to the best of my knowledge and belief.

Date Surveyed

March 1982

Registered Professional Engineer and/or Land Surveyor

Fred B. Kerr Jr.

Certificate No.