

UNITED STATES
DEPARTMENT OF THE INTERIOR
GEOLOGICAL SURVEY

30-039-230 66

APPLICATION FOR PERMIT TO DRILL, DEEPEN, OR PLUG BACK

1a. TYPE OF WORK DRILL <input checked="" type="checkbox"/> DEEPEN <input type="checkbox"/> PLUG BACK <input type="checkbox"/>			5. LEASE DESIGNATION AND SERIAL NO. SF-079139-A + SF080136		
b. TYPE OF WELL OIL WELL <input type="checkbox"/> GAS WELL <input checked="" type="checkbox"/> OTHER <input type="checkbox"/>			6. IF INDIAN, ALLOTTEE OR TRIBE NAME		
2. NAME OF OPERATOR CURTIS J. LITTLE			7. UNIT AGREEMENT NAME Warren		
3. ADDRESS OF OPERATOR P.O. Box 2487 Farmington, N.M. 87401			8. FARM OR LEASE NAME #8		
4. LOCATION OF WELL (Report location clearly and in accordance with any State requirements.) At surface 1820' FSL & 1830' FWL Sec 26, T25N, R6W At proposed prod. zone same			9. WELL NO. #8		
14. DISTANCE IN MILES AND DIRECTION FROM NEAREST TOWN OR POST OFFICE* 12 miles northwest of Counselor, N.M.			10. FIELD AND POOL, OR WILDCAT Ballard PC Ext		
15. DISTANCE FROM PROPOSED* LOCATION TO NEAREST PROPERTY OR LEASE LINE, FT. (Also to nearest drlg. unit line, if any) 1820'			11. SEC., T., R., M., OR BLK. AND SURVEY OR AREA K Sec. 26, T25N, R6W		
16. NO. OF ACRES IN LEASE 1040			12. COUNTY OR PARISH Rio Arriba		
17. NO. OF ACRES ASSIGNED TO THIS WELL 160			13. STATE NM		
18. DISTANCE FROM PROPOSED LOCATION* TO NEAREST WELL, DRILLING, COMPLETED, OR APPLIED FOR, ON THIS LEASE, FT. 1/2 mile			19. PROPOSED DEPTH 2855'		
20. ROTARY OR CABLE TOOLS rotary			21. ELEVATIONS (Show whether DF, RT, GR, etc.) 6820' GR		
22. APPROX. DATE WORK WILL START* July 1, 1982					

23. PROPOSED CASING AND CEMENTING PROGRAM

SIZE OF HOLE	SIZE OF CASING	WEIGHT PER FOOT	SETTING DEPTH	QUANTITY OF CEMENT
9 3/4"	7"	23#	100'	50 Sacks
5 1/4"	2 7/8"	6.5#	2855'	270 Sacks

Propose to drill with mud, run mechanical logs, selectively perforate, test and sand/water fracture the Pictured Cliffs Formation. BHP is not expected to exceed 800 psi.

A 10" 3000 psi WP and 6000 psi test double gate BOP with blind and pipe rams will be used for blowout prevention.

The gas is dedicated to El Paso.

Anticipated Tops

Ojo Alamo	2230'
Kirtland	2350'
Fruitland	2555'
Pictured Cliffs	2695'

IN ABOVE SPACE DESCRIBE PROPOSED PROGRAM: If proposal is to deepen or plug back, give data on present productive zone and proposed new productive zone. If proposal is to drill or deepen directionally, give pertinent data on subsurface locations and measured and true vertical depths. Give blowout prevention program, if any.

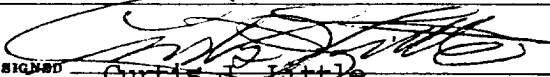
24.  Operator 14 June 1982
SIGNED Curtis J. Little TITLE _____ DATE _____

(This space for Federal or State office use)

PERMIT NO. _____ APPROVAL DATE _____

APPROVED BY _____ TITLE _____
CONDITIONS OF APPROVAL, IF ANY:

Hold C104 for communitization

*See Instructions On Reverse Side

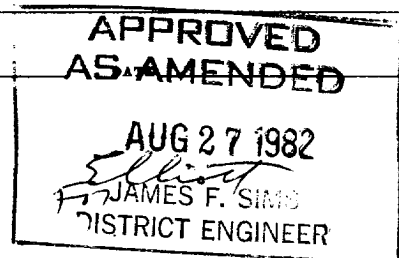

All distances must be from the outer boundaries of the Section.

Operator CURTIS J. LITTLE		Lease WARREN		Well No. 8
Unit Letter K	Section 26	Township 25N	Range 6W	County Rio Arriba

Actual Footage Location of Well:

1820	feet from the South	line and 1830	feet from the West	line
Ground Level Elev. 6820	Producing Formation Pictured Cliffs	Pool Ballard Ext	Dedicated Acreage: 160 Acres	

1. Outline the acreage dedicated to the subject well by colored pencil or hatchure marks on the plat below.
2. If more than one lease is dedicated to the well, outline each and identify the ownership thereof (both as to working interest and royalty).
3. If more than one lease of different ownership is dedicated to the well, have the interests of all owners been consolidated by communitization, unitization, force-pooling, etc?

☒ Yes ☐ No If answer is "yes," type of consolidation Communitization pending

If answer is "no," list the owners and tract descriptions which have actually been consolidated. (Use reverse side of this form if necessary.)

No allowable will be assigned to the well until all interests have been consolidated (by communitization, unitization, forced-pooling, or otherwise) or until a non-standard unit, eliminating such interests, has been approved by the Commission.

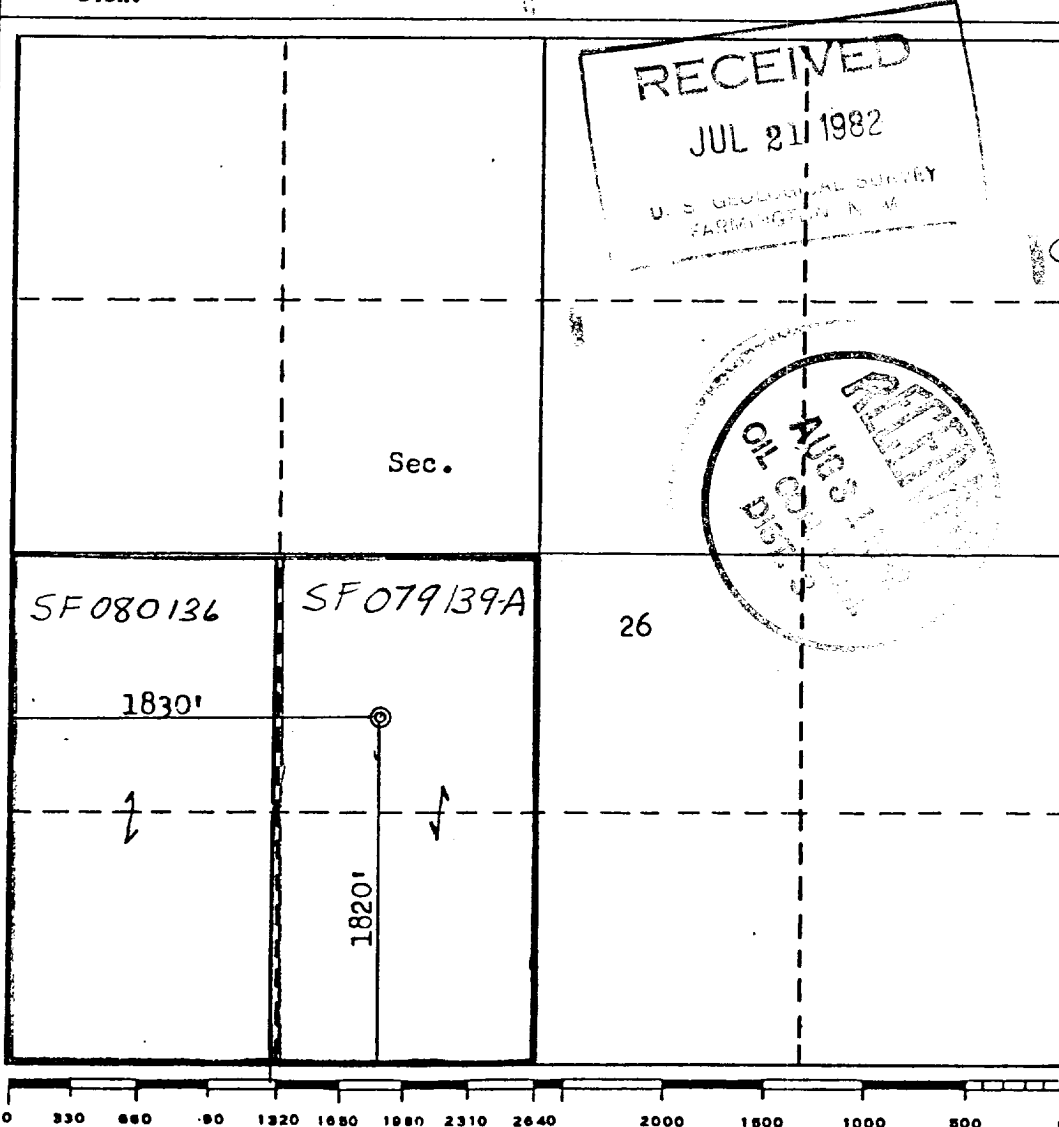

CERTIFICATION

I hereby certify that the information contained herein is true and complete to the best of my knowledge and belief.

Name
CURTIS J. LITTLE

Position
Operator

Company
Curtis J. Little

Date
14 June 1982

I hereby certify that the well location shown on this plat was plotted from field notes of actual surveys made by me or under my supervision, and that the same is true and correct to the best of my knowledge and belief.

Date Surveyed

June 14, 1982

Registered Professional Engineer and/or Land Surveyor

Fred E. Kerr Jr.

Certificate No.

3950

