

UNITED STATES
DEPARTMENT OF THE INTERIOR
GEOLOGICAL SURVEY

APPLICATION FOR PERMIT TO DRILL, DEEPEN, OR PLUG BACK

1a. TYPE OF WORK

DRILL ☒DEEPEN ☐PLUG BACK ☐

b. TYPE OF WELL

OIL
WELL ☒GAS
WELL ☐OTHER ☐

2. NAME OF OPERATOR

Merrion Oil & Gas Corporation

3. ADDRESS OF OPERATOR

P. O. Box 1017, Farmington, New Mexico 87401

4. LOCATION OF WELL (Report location clearly and in accordance with any State requirements.)

At surface

1650' FSL and 1840' FEL

At proposed prod. zone Same

14. DISTANCE IN MILES AND DIRECTION FROM NEAREST TOWN OR POST OFFICE*

10 miles NE of Counselor, New Mexico

10. DISTANCE FROM PROPOSED*

LOCATION TO NEAREST
PROPERTY OR LEASE LINE, FT.
(Also to nearest drlg. unit line, if any)

2200'

18. DISTANCE FROM PROPOSED LOCATION*
TO NEAREST WELL, DRILLING, COMPLETED,
OR APPLIED FOR, ON THIS LEASE, FT.

2600'

21. ELEVATIONS (Show whether DF, RT, GR, etc.)

6368' G.L.

23. PROPOSED CASING AND CEMENTING PROGRAM

SIZE OF HOLE	SIZE OF CASING	WEIGHT PER FOOT	SETTING DEPTH	QUANTITY OF CEMENT
12-1/4"	8-5/8"	20 #/ft	200	175 sx.
7-7/8"	4-1/2"	10.5 #/ft	5950'	875 sx.

Propose to drill 12-1/4" hole to 200 ft., set 200 ft. of 8-5/8" 20 #/ft. new surface casing w/175 sx Class 'B' 2% CACL₂. Will drill 7-7/8" hole to TD and run open hole logs. If logs appear productive, will run 4-1/2", K-55, 10.5 #/ft. new casing to TD and 2 stage cement. 1st stage 175 sx Class 'H' 2% gel to cover Gallup. Stage tool below Point Lookout @ 4750'est. 2nd stage 600 sx Class 'B' w/2% D-79 followed by 100 sx Class 'H' 2% gel. Will bring cement above Ojo Alamo. Drilling mud will be low water loss gel, fresh water, starch. Will perforate and frac as necessary. Blowout prevention equipment will be 10" 900 series double ram.

ESTIMATED TOPS

San Jose	Surface
Ojo Alamo	1600'
Pictured Cliffs	2060'
Mesa Verde	3706'

Gallup 5556'

IN ABOVE SPACE DESCRIBE PROPOSED PROGRAM: If proposal is to deepen or plug back, give data on present productive zone and proposed new productive zone. If proposal is to drill or deepen directionally, give pertinent data on subsurface locations and measured and true vertical depths. Give blowout preventer program, if any.

24. SIGNED John A. Sal TITLE Operations Manager

DATE 7/19/82

(This space for Federal or State office use)

PERMIT NO. _____

APPROVAL DATE _____

APPROVED BY _____

TITLE _____

CONDITIONS OF APPROVAL, IF ANY: _____

NMOC

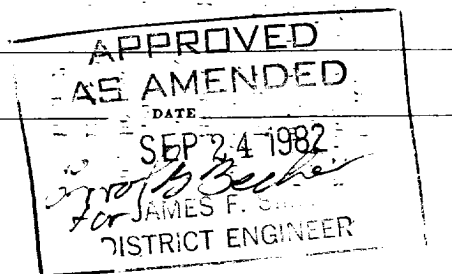

All distances must be from the outer boundaries of the Section.

Operator MERRION OIL & GAS CORPORATION			Lease SALAZAR "G" 27		Well No. 1
Unit Letter J	Section 27	Township 25N	Range 6W	County Rio Arriba	
Actual Footage Location of Well: 1650 feet from the South line and 1840 feet from the East line					
Ground Level Elev. 6368	Producing Formation Gallup	Pool Devils Fork Gallup Ext.		Dedicated Acreage: 160 Acres	

1. Outline the acreage dedicated to the subject well by colored pencil or hachure marks on the plat below.
2. If more than one lease is dedicated to the well, outline each and identify the ownership thereof (both as to working interest and royalty).
3. If more than one lease of different ownership is dedicated to the well, have the interests of all owners been consolidated by communitization, unitization, force-pooling, etc?

☐ Yes ☐ No If answer is "yes," type of consolidation _____

If answer is "no," list the owners and tract descriptions which have actually been consolidated. (Use reverse side of this form if necessary.) _____

No allowable will be assigned to the well until all interests have been consolidated (by communitization, unitization, forced-pooling, or otherwise) or until a non-standard unit, eliminating such interests, has been approved by the Commission.

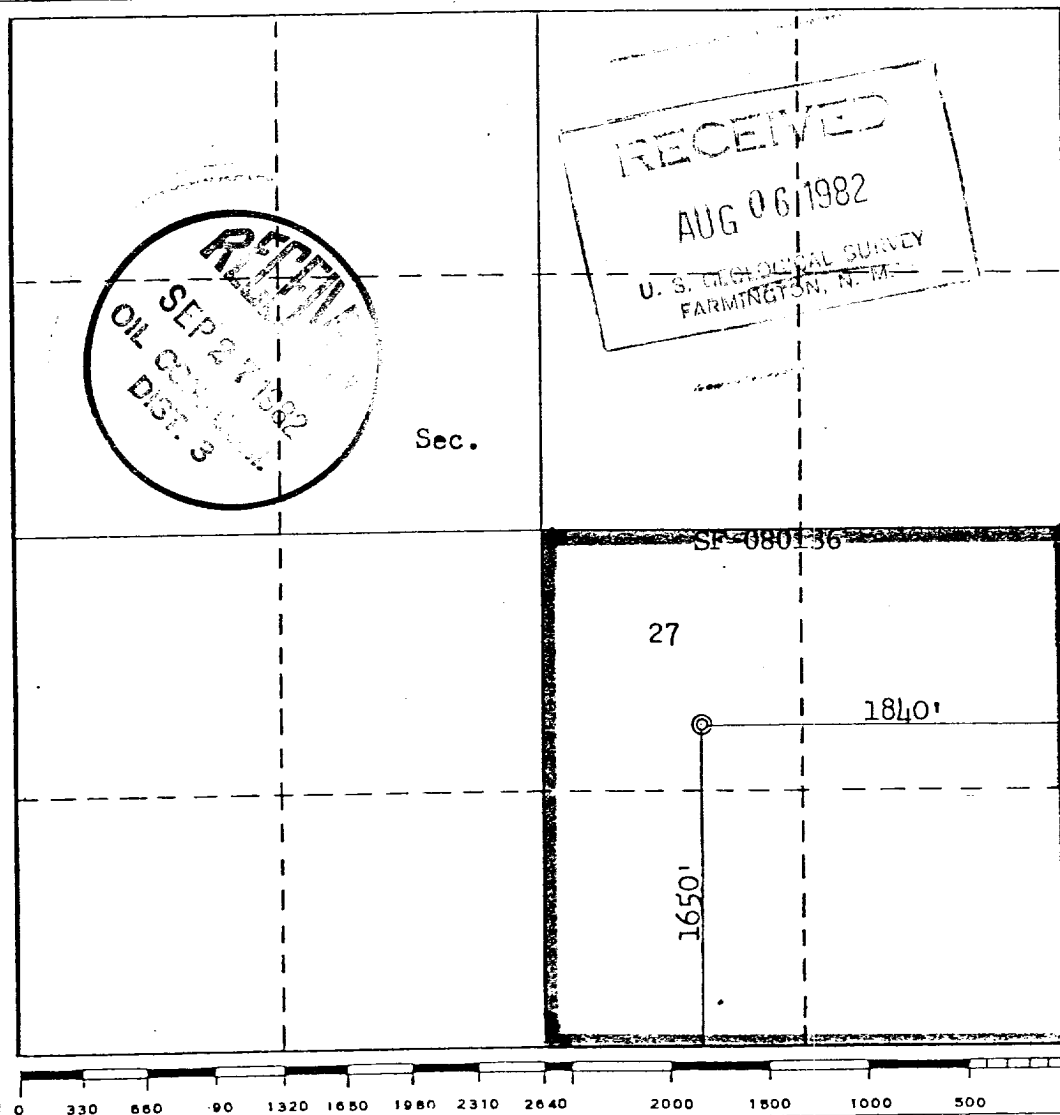

CERTIFICATION

I hereby certify that the information contained herein is true and complete to the best of my knowledge and belief.

Steve S. Dunn
Name

Steve S. Dunn

Position
Operations Manager

Company
Merrion Oil & Gas Corporation

Date
7/19/82

I hereby certify that the well location shown on this plat was plotted from field notes of actual surveys made by me or under my supervision, and that the same is true and correct to the best of my knowledge and belief.

Date Surveyed

June 22, 1982

Registered Professional Engineer and/or Land Surveyor

Fred B. Kerr Jr.
Fred B. Kerr Jr.

Certificate No.

3950

