

UNITED STATES
DEPARTMENT OF THE INTERIOR
GEOLOGICAL SURVEY

30-039-23104

APPLICATION FOR PERMIT TO DRILL, DEEPEN, OR PLUG BACK

1a. TYPE OF WORK

DRILL ☒

DEEPEN ☐

PLUG BACK ☐

b. TYPE OF WELL

OIL
WELL ☒

GAS
WELL ☐

OTHER

SINGLE
ZONE ☐

MULTIPLE
ZONE ☐

2. NAME OF OPERATOR

Benson-Montin-Greer Drilling Corp.

3. ADDRESS OF OPERATOR

221 Petroleum Center Building, Farmington, NM 87401

4. LOCATION OF WELL (Report location clearly and in accordance with any State requirements.*)

At surface

2260' FNL, 2285 FEL, Sec. 3, T-26N, R-1E

At proposed prod. zone

5. LEASE DESIGNATION AND SERIAL NO.

NM-16997

6. IF INDIAN, ALLOTTEE OR TRIBE NAME

7. UNIT AGREEMENT NAME

8. FARM OR LEASE NAME

Smith

9. WELL NO.

1(23)

10. FIELD AND POOL, OR WILDCAT

Wildcat Entrada

11. SEC., T., R., M., OR BLK.
AND SURVEY OR AREA

6
Sec. 3, T-26N, R-1E

12. COUNTY OR PARISH

Rio Arriba

13. STATE

New Mexico

14. DISTANCE IN MILES AND DIRECTION FROM NEAREST TOWN OR POST OFFICE*

10 miles north of Llaves, New Mexico Post Office

15. DISTANCE FROM PROPOSED*

LOCATION TO NEAREST
PROPERTY OR LEASE LINE, FT.
(Also to nearest drlg. unit line, if any)

18. DISTANCE FROM PROPOSED LOCATION*

TO NEAREST WELL, DRILLING, COMPLETED,
OR APPLIED FOR, ON THIS LEASE, FT.

16. NO. OF ACRES IN LEASE

959.02

17. NO. OF ACRES ASSIGNED

TO THIS WELL

40.00

19. PROPOSED DEPTH

2250'

20. ROTARY OR CABLE TOOLS

Rotary

21. ELEVATIONS (Show whether DF, RT, GR, etc.)

6981' GR

22. APPROX. DATE WORK WILL START*

as soon as approved

23.

PROPOSED CASING AND CEMENTING PROGRAM

SIZE OF HOLE	SIZE OF CASING	WEIGHT PER FOOT	SETTING DEPTH	QUANTITY OF CEMENT
8 3/4"	7"	20#	150	100 sacks (circulated)
6 3/8"	5 1/2"	14#	1450	150 sacks
4 3/4"	3 1/2"	9.30#	2250	75 sacks

See Exhibit III attached - Schematic drawing of Blow-out Preventer Stack.

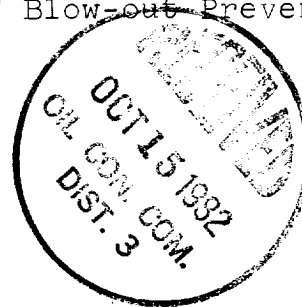

IN ABOVE SPACE DESCRIBE PROPOSED PROGRAM: If proposal is to deepen or plug back, give data on present productive zone and proposed new productive zone. If proposal is to drill or deepen directionally, give pertinent data on subsurface locations and measured and true vertical depths. Give blowout preventer program, if any.

24.

SIGNED [Signature] TITLE Vice-President

DATE Sept. 30, 1982

(This space for Federal or State office use)

PERMIT NO. _____

APPROVAL DATE _____

APPROVED BY _____

TITLE _____

CONDITIONS OF APPROVAL, IF ANY:

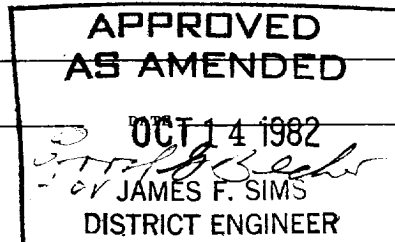

NOV 06

All distances must be from the outer boundaries of the Section.

Operator BENSON-MONTIN-GREER DRILLING CORP.			Lease Smith		Well No. 1 (13)
Unit Letter G	Section 3	Township 26 NORTH	Range 1 EAST	County RIO ARriba	
Actual Footage Location of Well: 2260 feet from the NORTH line and 2285 feet from the EAST line					
Ground Level Elev. 6981	Producing Formation Entrada	Pool Wildcat	Dedicated Acreage: 40.00 Acres		

1. Outline the acreage dedicated to the subject well by colored pencil or hachure marks on the plat below.
2. If more than one lease is dedicated to the well, outline each and identify the ownership thereof (both as to working interest and royalty).
3. If more than one lease of different ownership is dedicated to the well, have the interests of all owners been consolidated by communitization, unitization, force-pooling, etc?

☐ Yes ☐ No If answer is "yes," type of consolidation _____

If answer is "no," list the owners and tract descriptions which have actually been consolidated. (Use reverse side of this form if necessary.) _____

No allowable will be assigned to the well until all interests have been consolidated (by communitization, unitization, forced-pooling, or otherwise) or until a non-standard unit, eliminating such interests, has been approved by the Division

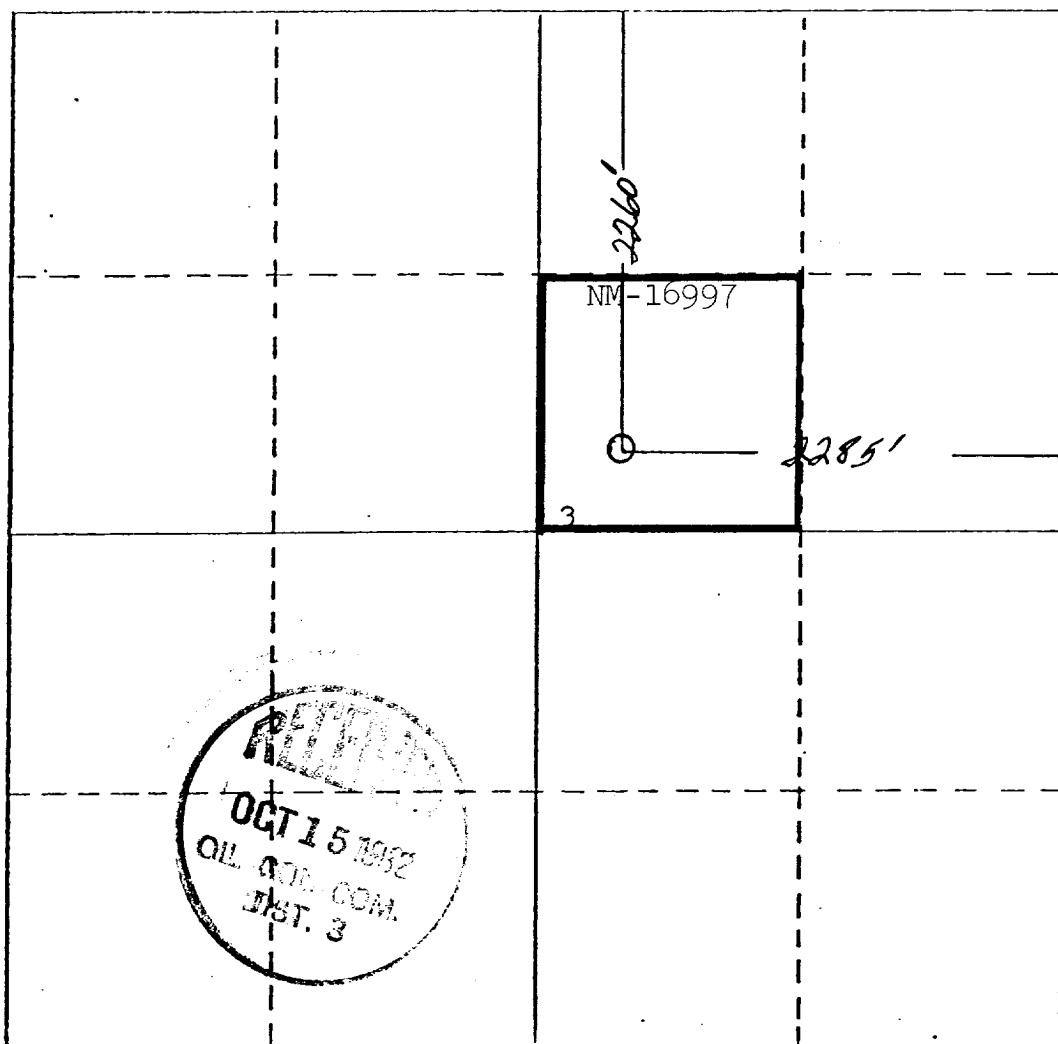

CERTIFICATION

I hereby certify that the information contained herein is true and complete to the best of my knowledge and belief.

Virgil L. Stoabs

Name

Virgil L. Stoabs

Position

Vice-President

Company Benson-Montin-Greer
Drilling Corp.

Date

September 30, 1982

I hereby certify that the well location shown on this plot was plotted from field notes of actual surveys made by me or under my supervision and that the same is true and correct to the best of my knowledge and belief.

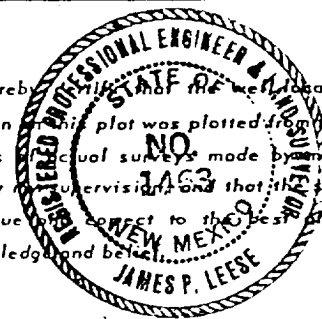

Date Surveyed

September 30, 1982

Registered Professional Engineer
and/or Land Surveyor

James P. Leese
James P. Leese

Certificate No.

1463

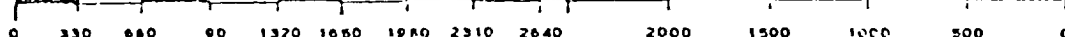

R;1 E.

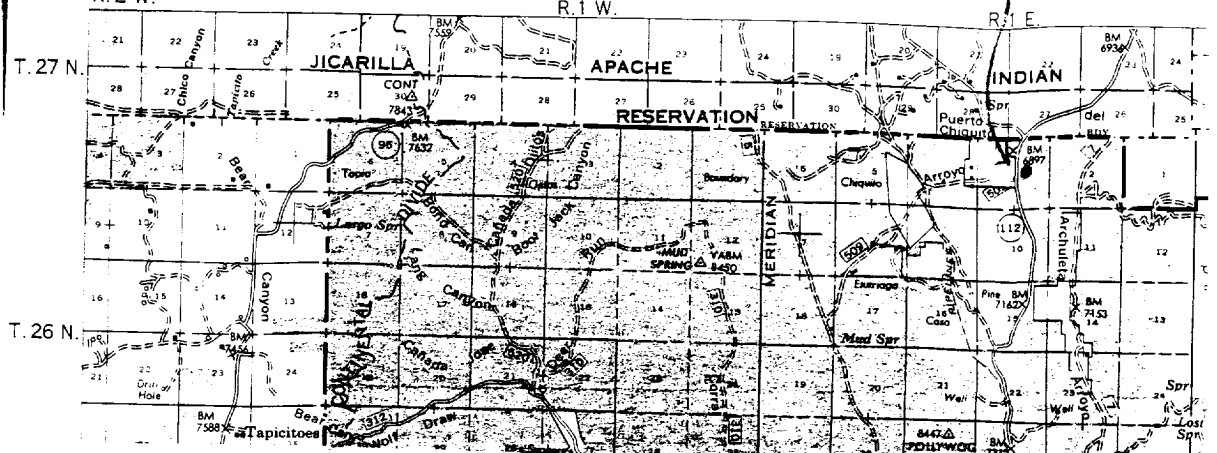

Directions to well:

Go north of Regina, New Mexico approximately 4 miles on State Highway 96 (blacktop), then straight ahead on State Highway 112 for 19 miles to location on right hand side of highway.

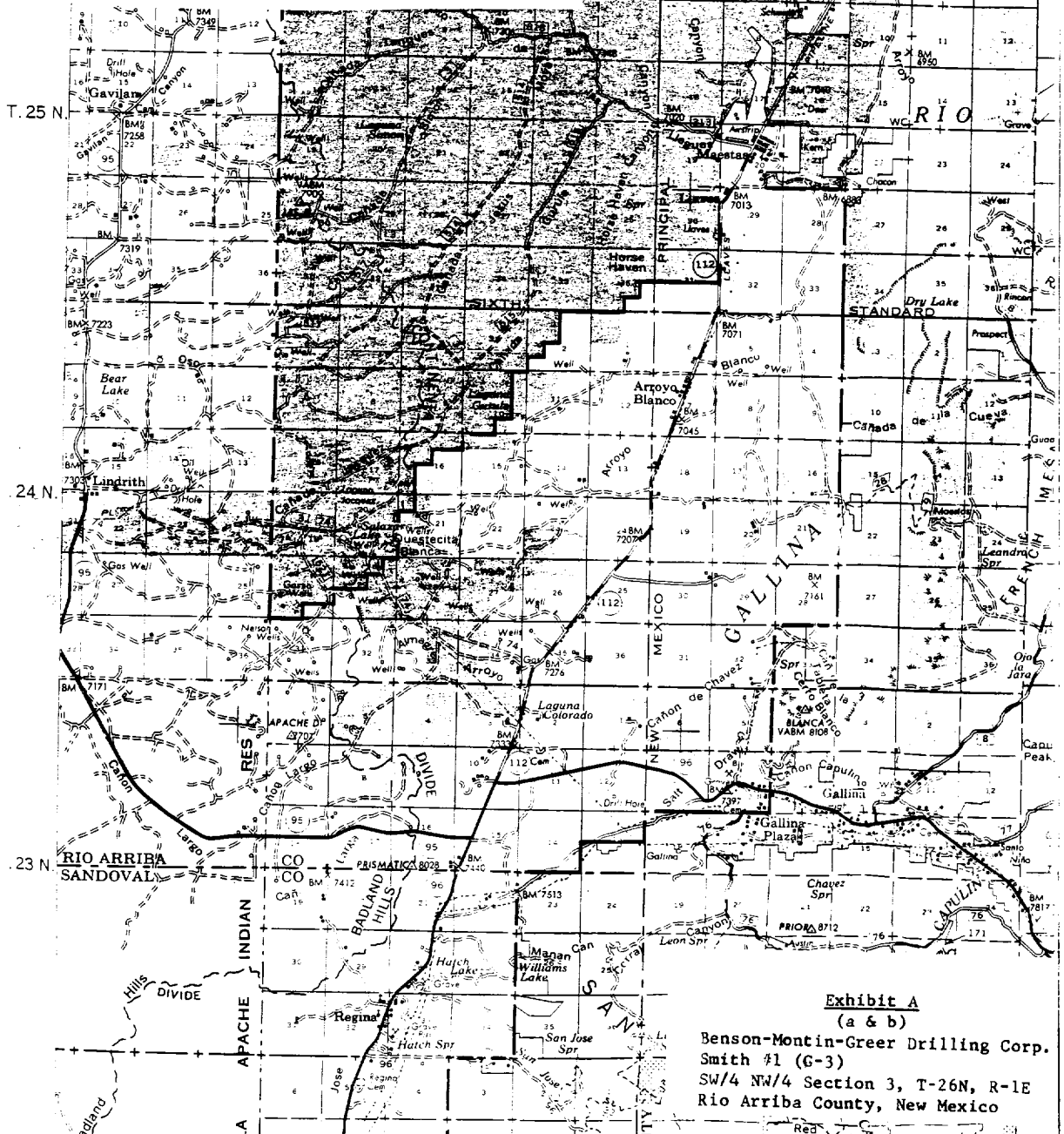

Exhibit A
(a & b)

Benson-Montin-Greer Drilling Corp.
Smith #1 (G-3)
SW/4 NW/4 Section 3, T-26N, R-1E
Rio Arriba County, New Mexico