

**UNITED STATES  
DEPARTMENT OF THE INTERIOR  
GEOLOGICAL SURVEY**

(Other instructions on reverse side)

Budget Bureau No. 42-R1425.

30-039-23356

**APPLICATION FOR PERMIT TO DRILL, DEEPEN, OR PLUG BACK****1a. TYPE OF WORK**DRILL ☒DEEPEN ☐PLUG BACK ☐**b. TYPE OF WELL**OIL WELL ☐GAS WELL ☒OTHER ☐SINGLE ZONE ☒MULTIPLE ZONE ☐**2. NAME OF OPERATOR**

El Paso Natural Gas Company

**3. ADDRESS OF OPERATOR**

Box 4289, Farmington, New Mexico 87499

**4. LOCATION OF WELL (Report location clearly and in accordance with any State requirements.)**

At surface

1650'S, 1850'W

At proposed prod. zone

**14. DISTANCE IN MILES AND DIRECTION FROM NEAREST TOWN OR POST OFFICE**

10 Miles North of Lybrook, New Mexico

**15. DISTANCE FROM PROPOSED\* LOCATION TO NEAREST PROPERTY OR LEASE LINE, FT.**

(Also to nearest drilg. unit line, if any) 1650

**18. DISTANCE FROM PROPOSED LOCATION\* TO NEAREST WELL, DRILLING, COMPLETED, OR APPLIED FOR, ON THIS LEASE, FT.**

1000

**16. NO. OF ACRES IN LEASE**

Unit

**19. PROPOSED DEPTH**

6435'

**17. NO. OF ACRES ASSIGNED TO THIS WELL**

320/60

**20. ROTARY OR CABLE TOOLS**

Rotary

**21. ELEVATIONS (Show whether DF, RT, GR, etc.)**

6773' GL

RECEIVED  
FEB 6 1984  
BUREAU OF LAND MANAGEMENT  
FARMINGTON RESOURCE AREA

**23. PROPOSED CASING AND CEMENTING PROGRAM**

DRILLING OPERATIONS AUTHORIZED ARE  
SUBJECT TO COMPLIANCE WITH ATTACHED  
"GENERAL REQUIREMENTS"

This action is subject to administrative  
appeal pursuant to 30 CFR 290.

SIZE OF HOLE	SIZE OF CASING	WEIGHT PER FOOT	SETTING DEPTH	QUANTITY OF CEMENT
12 1/4"	8 5/8"	24.0#	300'	248 cu. ft. circulated to surf.
7 7/8"	4 1/2"	10.5 & 11.6#	6435'	1205 cu. ft. to cover Ojo-Alamo

Selectively perforate and sand water fracture the Gallup formation

A 3000 psi WP and 6000 psi test double gate preventor equipped with blind and pipe rams will be used for blow out prevention on this well.

This gas is dedicated.

RECEIVED

FEB 29 1984

OIL CON. DIV.  
DIST. 3

IN ABOVE SPACE DESCRIBE PROPOSED PROGRAM: If proposal is to deepen or plug back, give data on present productive zone and proposed new productive zone. If proposal is to drill or deepen directionally, give pertinent data on subsurface locations and measured and true vertical depths. Give blowout preventer program, if any.

24.

SIGNED

*A. G. Duico*

TITLE Drilling Clerk

DATE Feb. 3, 1984

(This space for Federal or State office use)

PERMIT NO. \_\_\_\_\_

APPROVAL DATE \_\_\_\_\_

APPROVED BY \_\_\_\_\_

TITLE \_\_\_\_\_

CONDITIONS OF APPROVAL, IF ANY:

APPROVED

AS AMENDED

DATE

FEB 27 1984

AST AREA MANAGER  
FARMINGTON RESOURCE AREA

\*See Instructions On Reverse Side

NMOCC

All distances must be from the outer boundaries of the Section.

Operator El Paso Natural Gas Company			Lease Canyon Largo Unit(SF 078875)		Well No. 343
Unit Letter K	Section 29	Township 25-N	Range 6-W	County Rio Arriba	
Actual Footage Location of Well: 1650 feet from the South line and 1850 feet from the West line					
Ground Level Elev. 6773	Producing Formation Gallup		Pool Devils Fork Gallup Ext.		Dedicated Acreage: 320.00/60 Acres

1. Outline the acreage dedicated to the subject well by colored pencil or hatchure marks on the plat below.
2. If more than one lease is dedicated to the well, outline each and identify the ownership thereof (both as to working interest and royalty).
3. If more than one lease of different ownership is dedicated to the well, have the interests of all owners been consolidated by communitization, unitization, force-pooling, etc?

☒ Yes ☐ No If answer is "yes," type of consolidation Unitization

If answer is "no," list the owners and tract descriptions which have actually been consolidated. (Use reverse side of this form if necessary.)

No allowable will be assigned to the well until all interests have been consolidated (by communitization, unitization, forced-pooling, or otherwise) or until a non-standard unit, eliminating such interests, has been approved by the Division.

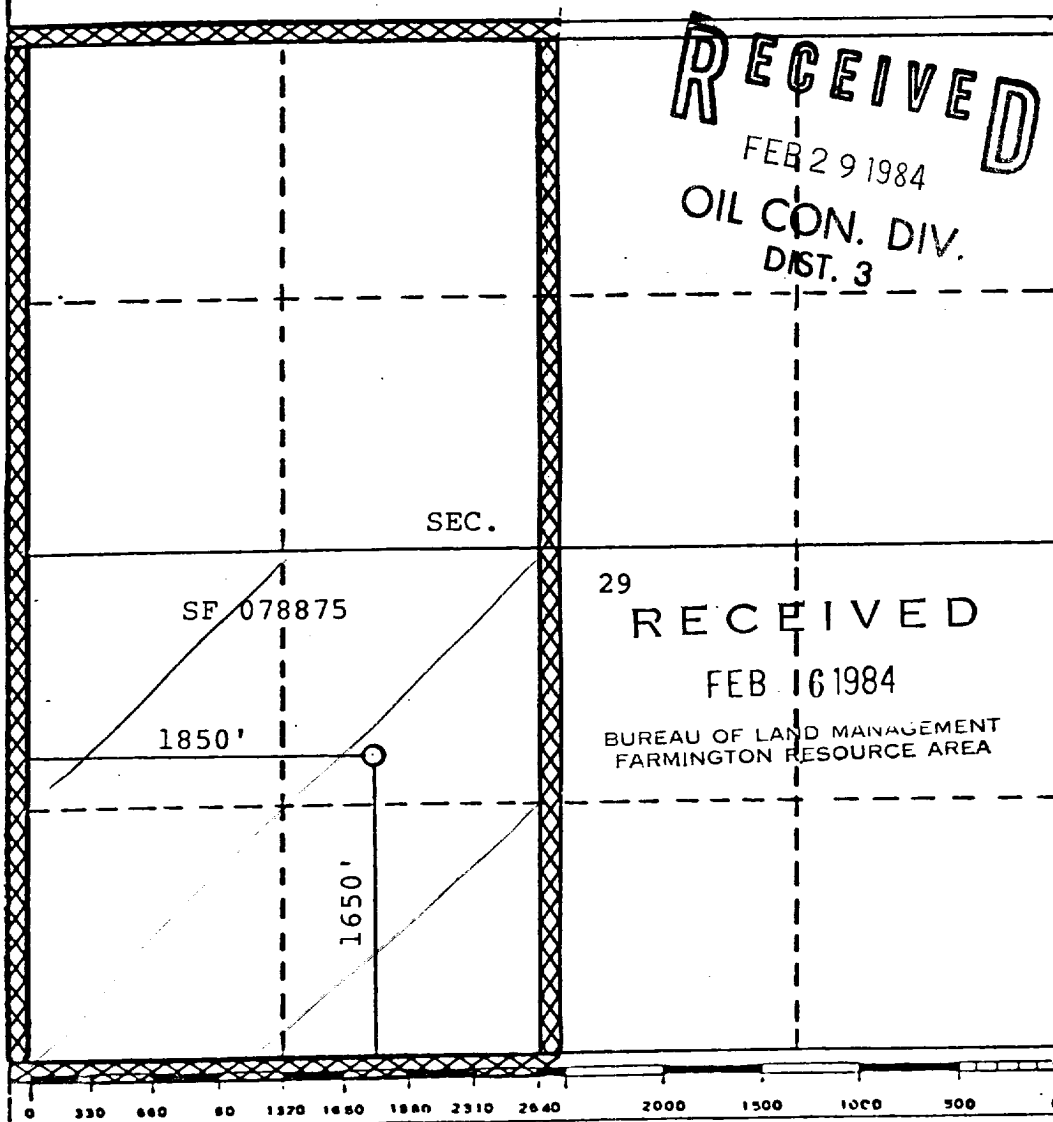

## CERTIFICATION

I hereby certify that the information contained herein is true and complete to the best of my knowledge and belief.

*D. G. Grisco*  
Name

Drilling Clerk  
Position  
El Paso Natural Gas Company

Company  
February 3, 1984

Date

I hereby certify that the well location shown on this plat was plotted from field notes of actual surveys made by me or under my supervision, and that the same is true and correct to the best of my knowledge and belief.

Date Surveyed  
January 24, 1984

Registered Professional Engineer  
and/or Land Surveyor

*David W. Kilmer*  
Certificate No.

1760