

District I
P.O. Box 1998 Hobbs, NM
District II
P.O. Drawer DD, Artesia, NM 88221
District III
1500 Rio Brazos Rd. Aztec, NM 87410

State of New Mexico
Energy, Minerals and Natural Resources Department

SUBMIT 1 COPY TO
APPROPRIATE
DISTRICT OFFICE
AND 1 COPY TO
SANTA FE OFFICE

OIL CONSERVATION DIVISION

2640 South Pacheco Street
Santa Fe, New Mexico 87505

JUN 23 1998

PIT REMEDIATION AND CLOSURE REPORT

Approved

Operator: PNM Gas Services (Caulkins) Telephone: 324-3764

Address: 603 W. Elm Street Farmington, NM 87401

Facility or Well Name: Breach E #58M

Location: Unit J Sec 3 T 26 N R 6 W County Rio Arriba

Pit Type: Separator ☒ Dehydrator ☐ Other ☐

Land Type: BLM ☒ State ☐ Fee ☐ Other ☐

Pit Location: Pit dimensions: length 20 width 20 depth 2

(Attach diagram) Reference: wellhead ☒ other ☐

Footage from reference: 110'

Direction from reference: 20 Degrees ☒ East ☐ North ☐
☐ West ☒ South

Depth to Ground Water: Less than 50 feet (20 points)
50 feet to 99 feet (10 points)
Greater than 100 feet (0 points) 0

(Vertical distance from contaminants to seasonal high water elevation of ground water)

Wellhead Protection Area:

(Less than 200 feet from a private domestic water source, or, less than 1,000 feet from all other water sources)

Yes (20 points)
No (0 points) 0

Distance to Surface Water:

Less than 200 feet (20 points)
200 feet to 1,000 feet (10 points)
Greater than 1,000 feet (0 points) 0

RANKING SCORE (TOTAL POINTS): 0

RECEIVED
FEB - 3 1998
OIL CON. DIV.
DIST. 3

Q37192911

1010 1010 1010
1010 1010 1010

Breach E #58M

Date Remediation Started: 9/10/97

Date Completed: 9/10/97

Remediation Method: Excavation ☒

Approx. Cubic Yard 148

(Check all appropriate sections)

Landfarmed ☒

Amount Landfarmed (cubic yds) 148

Other

Remediation Location: Onsite ☒

Offsite

(i.e., landfarmed onsite, name and location of offsite facility)

Backfill Material Location:

General Description of Remedial Action:

Excavated contaminated soil to a pit size of 20' X 20' X 10' and landfarmed soil onsite within a bermed area at a depth of 6" to 12". Soil was aerated by disking/plowing until soil met regulatory levels.

Ground Water Encountered:

No

☒

Yes

☐

Depth

Final Pit Closure Sampling:

Sample Location

5 pt. composite; 4 side walls and center of pit bottom.

(if multiple samples, attach sample result and diagram of sample locations and depths.)

Sample depth

7' walls and 10' bottom.

Sample date

9/10/97

Sample time

10:00:00 AM

Sample Results

Benzene (ppm) < 0.0010

Total BTEX (ppm) 0.0010

Field headspace (ppm)

TPH (ppm) < 5.00

Method

8015A

Vertical Extent (ft)

Risk Assessment form attached

Yes

No

Ground Water Sample:

Yes

No

☒

(If yes, see attached Groundwater Site Summary Report)

I HEREBY CERTIFY THAT THE INFORMATION ABOVE IS TRUE AND COMPLETE TO THE BEST OF MY KNOWLEDGE AND MY BELIEF

DATE January 27, 1998

SIGNATURE

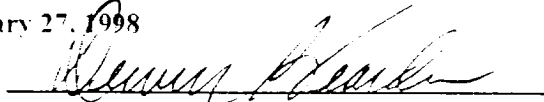

PRINTED NAME AND TITLE

Denver Bearden
Administrator III

Breach E #58m
Caulkins Oil
Sec. 3, 26N, 6W, J

9/10/97

start of excavation:

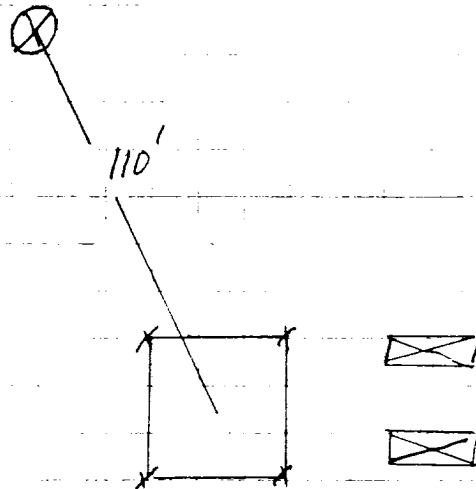

End of excavation:

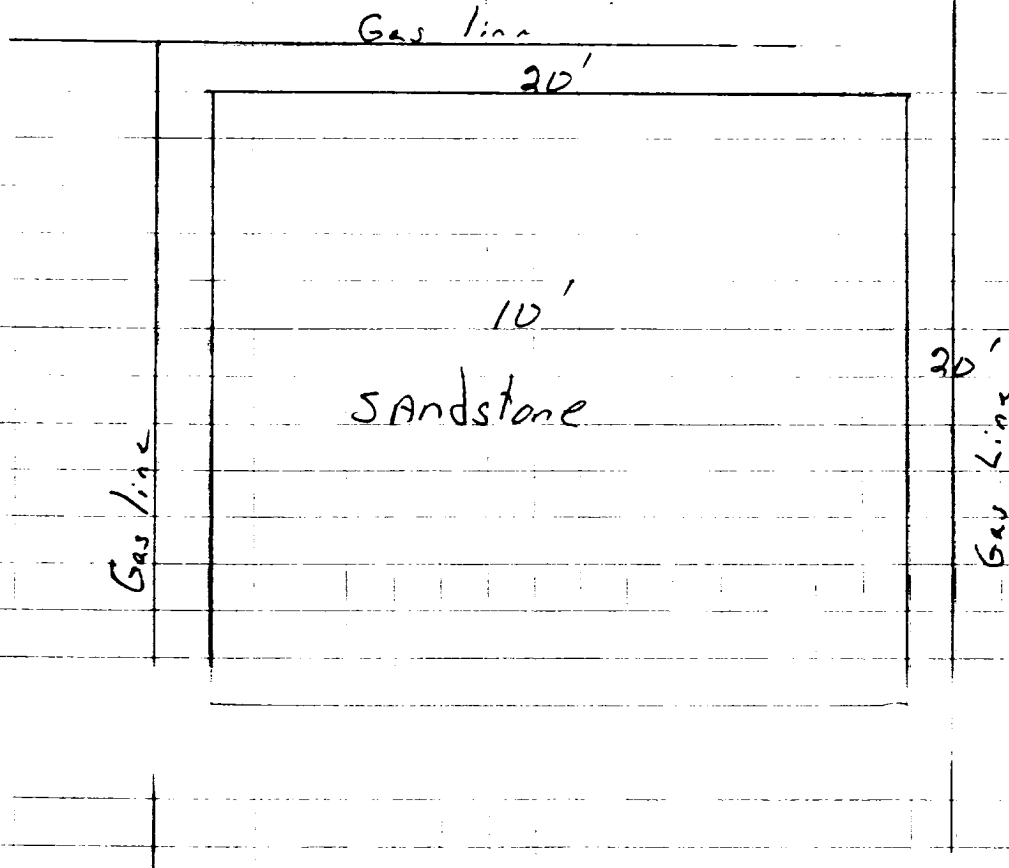

P.O. BOX 2606 • FARMINGTON, NM 87499

OFF: (505) 325-5667



LAB: (505) 325-1556

ANALYTICAL REPORT

Attn: *Denver Bearden*
Company: *PNM Gas Services*
Address: *603 W. Elm*
City, State: *Farmington, NM 87401*

Date: *17-Sep-97*
COC No.: *5686*
Sample No.: *16123*
Job No.: *2-1000*

Project Name: *PNM Gas Services - Breech E #58M*
Project Location: *9709101000; Walls @ 7' and Bottom @ 10'*
Sampled by: *GC* Date: *10-Sep-97* Time: *10:00*
Analyzed by: *DC* Date: *12-Sep-97*
Sample Matrix: *Soil*

Laboratory Analysis

Parameter	Results as Received	Unit of Measure	Limit of Quantitation	Unit of Measure
<i>Benzene</i>	ND	ug/kg	1	ug kg
<i>Toluene</i>	ND	ug/kg	1	ug kg
<i>Ethylbenzene</i>	ND	ug/kg	1	ug kg
<i>m,p-Xylene</i>	1	ug/kg	1	ug kg
<i>o-Xylene</i>	ND	ug/kg	1	ug kg
	<i>TOTAL</i>	1		ug/kg

ND - Not Detected at Limit of Quantitation

Method - SW-846 EPA Method 8020A Aromatic Volatile Organics by Gas Chromatography

↑
N

10-1-97 @ 0845

Breesh E #58M

Caulkins

(P) 3-260-600

Rio Arriba

Sample # 9710010845

Land farm field head space: 0 ppm

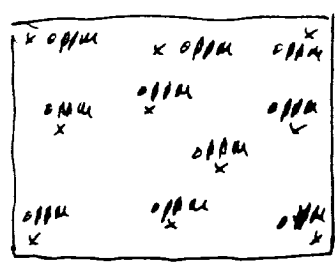
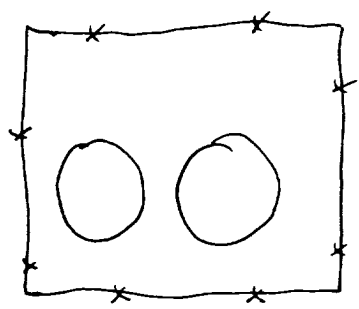

2" - 10"

WH



OFF: (505) 325-5667



LAB: (505) 325-1556

ANALYTICAL REPORT

Attn: *Denver Bearden*
Company: *PNM Gas Services*
Address: *603 W. Elm*
City, State: *Farmington, NM 87401*

Date: *6-Oct-97*
COC No.: *5676*
Sample No.: *16462*
Job No.: *2-1000*

Project Name: *PNM Gas Services - Breech E #58M*
Project Location: *9710010845; Composite (Landfarm)*
Sampled by: *RH* Date: *1-Oct-97* Time: *8:45*
Analyzed by: *DC/HR* Date: *2-Oct-97*
Sample Matrix: *Soil*

Laboratory Analysis

Parameter	Results as Received	Unit of Measure	Limit of Quantitation	Unit of Measure
<i>Diesel Range Organics (C10 - C28)</i>	<i>40</i>	<i>mg/kg</i>	<i>5</i>	<i>mg/kg</i>

ND - Not Detected at Limit of Quantitation

Quality Assurance Report

DRO QC No.: 0555-STD

Continuing Calibration Verification

Parameter	Method Blank	Unit of Measure	True Value	Analyzed Value	RPD	RPD Limit
<i>Diesel Range (C10 - C28)</i>	<i>ND</i>	<i>ppm</i>	<i>200</i>	<i>188</i>	<i>6.4</i>	<i>15%</i>

Matrix Spike

Parameter	1 - Percent Recovered	2 - Percent Recovered	Limit	RPD	RPD Limit
<i>Diesel Range (C10-C28)</i>	<i>91</i>	<i>89</i>	<i>(70-130)</i>	<i>2</i>	<i>20%</i>

Method: *ASTM D5185-97* (Soil) *ASTM D5185-97* (Soil) *ASTM D5185-97* (Soil)

Approved by: *[Signature]*
Date: *10/6/97*

P.O. BOX 2606 • FARMINGTON, NM 87499