

UNITED STATES
DEPARTMENT OF THE INTERIOR
BUREAU OF LAND MANAGEMENT

APPLICATION FOR PERMIT TO DRILL, DEEPEN, OR PLUG BACK

1a. TYPE OF WORK

DRILL ☒

DEEPEN ☐

PLUG BACK ☐

b. TYPE OF WELL

OIL
WELL ☐

GAS
WELL ☒

OTHER

SINGLE
ZONE ☐

MULTIPLE
ZONE ☐

2. NAME OF OPERATOR

Caulkins Oil Company

3. ADDRESS OF OPERATOR

P.O. Box 780 Farmington, New Mexico

4. LOCATION OF WELL (Report location clearly and in accordance with any State requirements.)*

At surface

1733' From North & 1795' From West

At proposed prod. zone

Same

MAR 16 1984

14. DISTANCE IN MILES AND DIRECTION FROM NEAREST TOWN OR POST OFFICE*

37 Miles Southeast of Blanco, New Mexico

15. DISTANCE FROM PROPOSED*

LOCATION TO NEAREST
PROPERTY OR LEASE LINE, FT.
(Also to nearest drlg. unit line, if any)

907'

16. NO. OF ACRES IN LEASE

1920

18. DISTANCE FROM PROPOSED LOCATION*
TO NEAREST WELL, DRILLING, COMPLETED,
OR APPLIED FOR, ON THIS LEASE, FT.

805'

19. PROPOSED DEPTH

7400

17. NO. OF ACRES ASSIGNED
TO THIS WELL

320

20. ROTARY OR CABLE TOOLS

Rotary

21. ELEVATIONS (Show whether DF, RT, GR, etc.)

6463' Gr

DRILLING OPERATIONS AUTHORIZED ARE
SUBJECT TO COMPLIANCE WITH ATTACHED

22. APPROX. DATE WORK WILL START*

6-10-84

23. PROPOSED Casing and Cementing Program

This action is subject to administrative
appeal pursuant to 30 CFR 290.

SIZE OF HOLE	SIZE OF CASING	WEIGHT PER FOOT	SETTING DEPTH	QUANTITY OF CEMENT
13 3/4"	9 5/8"	32.30#	400'	Sufficient to circulate to surface.
7 7/8"	5 1/2"	15.5# & 17#	7400'	3 stages - 2000 Cu.Ft.

Surface formation San Jose. No abnormal pressure or temperature anticipated.

It is proposed to drill new hole, surface to 7400' using 9.0 Gel based mud.
Float will be run in drill pipe at bit. ES Induction Log will be run in open
hole if possible.

A Schaeffer 10" Model LWP 6000# test BOP will be in use at all times while
drilling below surface casing. BOP will be tested at least one time during
each 24 hour period and results recorded on daily report.

New 9 5/8" 32.30# H-40 8rd thd, short collars surface casing will be set at
approx 400' and cemented with sufficient cement to circulate to surface.

New 5 1/2" 15.5# & 17# K-55 short & long collar 8rd thd Smls casing will be

IN ABOVE SPACE DESCRIBE PROPOSED PROGRAM: If proposal is to deepen or plug back, give data on present productive zone and proposed new productive zone. If proposal is to drill or deepen directionally, give pertinent data on subsurface locations and measured and true vertical depths. Give blowout preventer program, if any.

24.

SIGNED

Charles E. Vesper

TITLE

Superintendent

(This space for Federal or State office use)

PERMIT NO.

APPROVAL DATE

APPROVED BY

TITLE

CONDITIONS OF APPROVAL, IF ANY:

APPROVED

AS AMENDED

MAR 30 1984

DATE

James S. Chisholm
AREA MANAGER
FARMINGTON RESOURCE AREA

NMOCC

*See Instructions On Reverse Side

RECEIVED

APR 03 1984

OIL CON. DIV.

cemented top to bottom, in 3 stages. First stage thru shoe with 412.5 Cu.Ft. 50-50 Poz, 6% Gel, 12 1/4# Gilsonite per sack followed by 118 Cu.Ft. Neat Cement.

Second stage thru too set at approx 5400' with 412.5 Cu.Ft. 50-50 Poz, 6% Gel, 12 1/4# Gilsonite per sack followed by 118 Cu.Ft. Neat Cement.

Thrid stage thru tool set at approx 3400' with 825 Cu.Ft. 50-50 Poz, 6% Gel, 12 1/4# Gilsonite per sack followed by 118 Cu.Ft. Neat Cement.

Centralizers will be run on casing thru Mesa Verde and Dakota Zones.

Well will be completed in Mesa Verde and Dakota Zones.

All Zones will be perforated and fractured to stimulate production.

Packer will be set between Mesa Verde and Dakota Zone.

New 1 1/2" EUE 2.90# V-55 10rd thd Smls tubing will be run thru Packer to Dakota Zone.

New 1 1/4" NU 2.33# V-55 10rd thd Smls tubing will be run for Mesa Verde production.

Gas produced from this well contracted to Gas Company of New Mexico.

Estimated Formation Tops:

Alamo	2245'
Pictured Cliffs	2845'
Chacra	3725'
Mesa Verde	4507'
Graneros	6969'
Dakota	7164'

All distances must be from the outer boundaries of the Section

Operator CAULKINS OIL COMPANY			Lease Breach D		Well No. 240 E
Unit Letter 3F	Section 15	Township 26 NORTH	Range 6 WEST	County RIO ARriba	
Actual Footage Location of Well: 1733 feet from the NORTH line and 1795 feet from the WEST line					
Ground Level Elev. 6463	Producing Formation Dakota - Mesa Verde		Pool Basin Dakota-Blanco Mesa Verde		Dedicated Acreage: 320 Acres

1. Outline the acreage dedicated to the subject well by colored pencil or hatchure marks on the plat below.
2. If more than one lease is dedicated to the well, outline each and identify the ownership thereof (both as to working interest and royalty).
3. If more than one lease of different ownership is dedicated to the well, have the interests of all owners been consolidated by communization, unitization, force-pooling, etc?

☐ Yes ☐ No If answer is "yes," type of consolidation _____

If answer is "no," list the owners and tract descriptions which have actually been consolidated. (Use reverse side of this form if necessary.) _____

No allowable will be assigned to the well until all interests have been consolidated (by communization, unitization, forced-pooling, or otherwise) or until a non-standard unit, eliminating such interests, has been approved by the Division

CERTIFICATION

I hereby certify that the information contained herein is true and complete to the best of my knowledge and belief.

Charles E. Verquer
Name

Charles E. Verquer

Position

Superintendent

Company

Caulkins Oil Company

Date

11-29-83

I hereby certify that the well location shown on this plat was plotted from field notes of actual surveys made by me or under my supervision, and that the same is true and correct to the best of my knowledge and belief.

14 November 1983

Curtis C. Stoecking
Date Certified
Registered Professional Engineer
and/or Surveyor

Curtis C. Stoecking
CURTIS C. STOECKING

Certificate No.
5980

RECEIVED
APR 3 1984
OIL CON. DIV.
DIST. 3

RECEIVED

MAR 16 1984

BUREAU OF LAND MANAGEMENT
FARMINGTON RESOURCE AREA

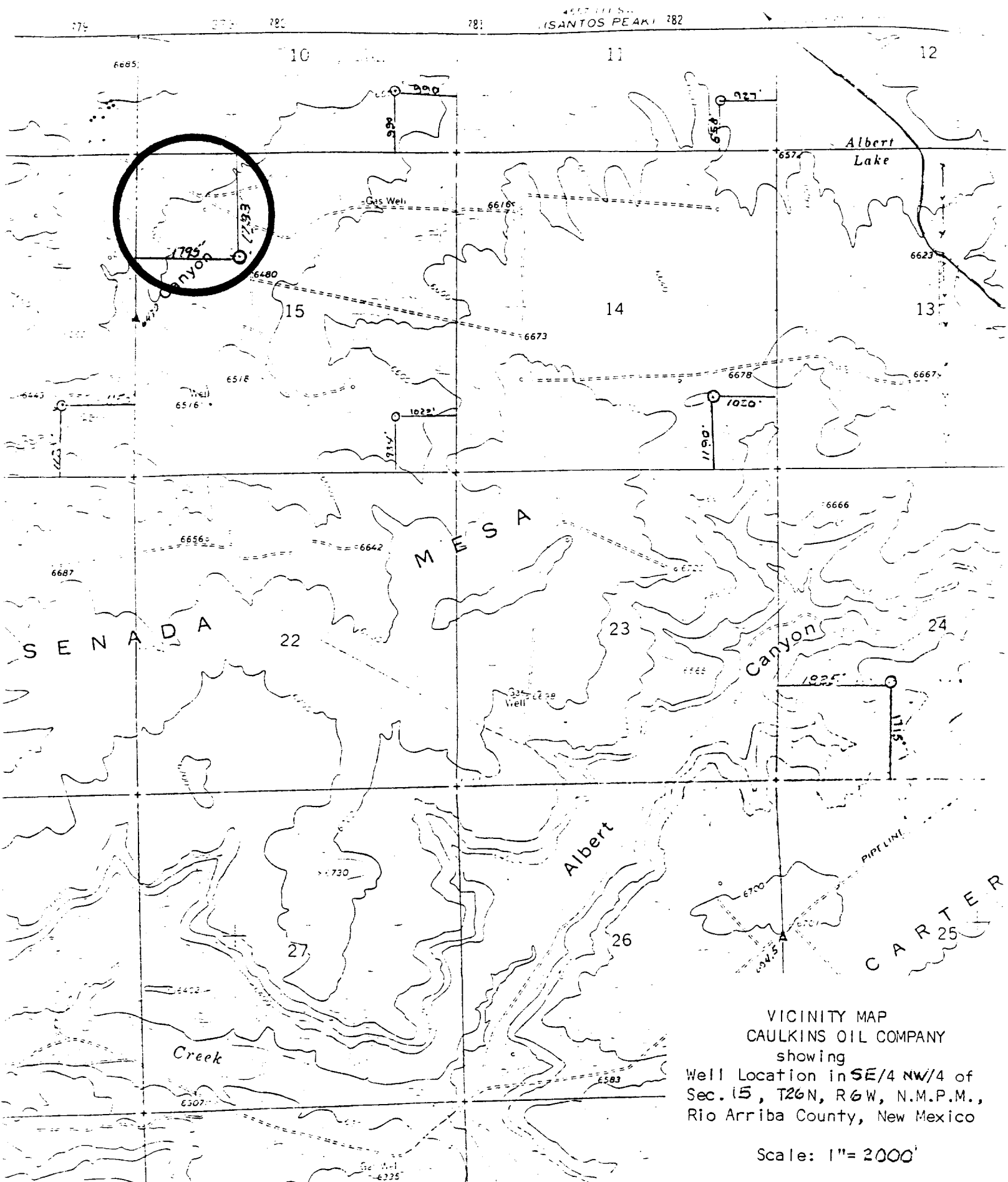

VICINITY MAP
CAULKINS OIL COMPANY
showing
Well Location in SE/4 NW/4 of
Sec. 15, T26N, R6W, N.M.P.M.,
Rio Arriba County, New Mexico

Scale: 1" = 2000'