

*Denny & Best*  
DEPUTY OIL & GAS INSPECTOR

MAR 28 1997

JICARILLA APACHE TRIBE

ENVIRONMENTAL PROTECTION OFFICE

P.O. BOX 507  
DULCE, NEW MEXICO 87528

SUBMIT 1 COPY TO  
NATURAL  
RESOURCE DEPT  
AND OIL-GAS  
ADMINISTRATION

*Approved*  
**PIT REMEDIATION AND CLOSURE REPORT**

Operator: PNM Gas Services (Conoco) Telephone: 324-3764  
Address: 603 W. Elm Street Farmington, NM 87401  
Facility or Well Name: Jicarilla D-19  
Location: Unit: I Sec. 31 T. 26 N R. 3 W County Rio Arriba  
Pit Type: Separator ☒ Dehydrator ☐ Other ☐  
Land Type: Jicarilla Apache

Pit Location: Pit dimensions: length 14' width 14' depth 5'  
(Attach diagram) Reference: wellhead ☒ other ☐  
Footage from reference: 84'  
Direction from reference: 45 Degrees ☐ East ☒ North ☐  
of  
☐ West ☐ South ☐

**Depth to Ground Water:**

(Vertical distance from contaminants to seasonal high water elevation of ground water)

Less than 50 feet (20 points)  
50 feet to 99 feet (10 points)  
Greater than 100 feet (0 points)

**Wellhead Protection Area:**

(Less than 200 feet from a private domestic water source, or; less than 1,000 feet from all other water sources)

Yes (20 points)  
No (0 points)

**Distance to Surface Water:**

(Horizontal distance to perennial lakes, ponds, rivers, streams, creeks, irrigation canals and ditches)

Less than 200 feet (20 points)  
200 feet to 1,000 feet (10 points)  
Greater than 1,000 feet (0 points)

**Distance to Ephemeral Stream (dry wash):**

(Horizontal distance to all downgradient streams having a width of at least 10 feet)

Less than or equal to 100 feet (10 points)  
Greater than 100 feet (0 points)

**Distance to Nearest Lake, Playa, or Watering Pond:**

(Horizontal distance to all downgradient lakes, playas, and livestock or wildlife water ponds)

Less than or equal to 100 feet (10 points)  
Greater than 100 feet (0 points)

**RANKING SCORE (TOTAL POINTS):**

Date Remediation Started: 9/10/96 Date Completed: 10/8/96

Remediation Method: Excavation X Approx. Cubic Yards 36

(Check all appropriate sections)

Landfarmed X Amount Landfarmed (cubic yds): 36

Other \_\_\_\_\_

Remediation Location: Onsite X Offsite \_\_\_\_\_

(i.e., landfarmed onsite, name and location of offsite facility)

General Description of Remedial Action:

Removed contaminated soil from all four side walls as to get a below 100 ppm head space readings. Bottom was solid sandstone rock.

Ground Water Encountered: No X Yes \_\_\_\_\_ Depth \_\_\_\_\_

Final Pit Closure Sampling:

Sample Location North, East, South, and West side walls.

(if multiple samples, attach sample result and diagram of sample locations and depths.)

Sample depth 5'

Sample date 9/10/96 Sample time 1530

Sample Results

Soil: Benzene (ppm) <0.0002 Water: Benzene (ppb) \_\_\_\_\_

Total BTEX (ppm) 0.0215 Toluene (ppb) \_\_\_\_\_

Field headspace (ppm) 72.2 Ethylbenzene (ppb) \_\_\_\_\_

TPH <5.0 ppm Method 8015 Total Xylenes (ppb) \_\_\_\_\_

Ground Water Sample: Yes \_\_\_\_\_ No X (If yes, attach sample results)

I HEREBY CERTIFY THAT THE INFORMATION ABOVE IS TRUE AND COMPLETE TO THE BEST OF MY KNOWLEDGE AND MY BELIEF

DATE 9/15/96 PRINTED NAME Ronald A. Dedrick

SIGNATURE Ronald A. Dedrick AND TITLE Environmental Technician II

AFTER REVIEW OF THE PIT CLOSURE INFORMATION, PIT CLOSURE IS APPROVED IN ACCORDANCE TO JICARILLA APACHE TRIBE PIT CLOSURE ORDINANCE.

APPROVED: YES X NO \_\_\_\_\_ (REASON): \_\_\_\_\_

SIGNED: Ronald A. Dedrick DATE: 9-17-96

Jicarilla D-19  
Sec. 31 T26N R3W Unit I  
Conoco

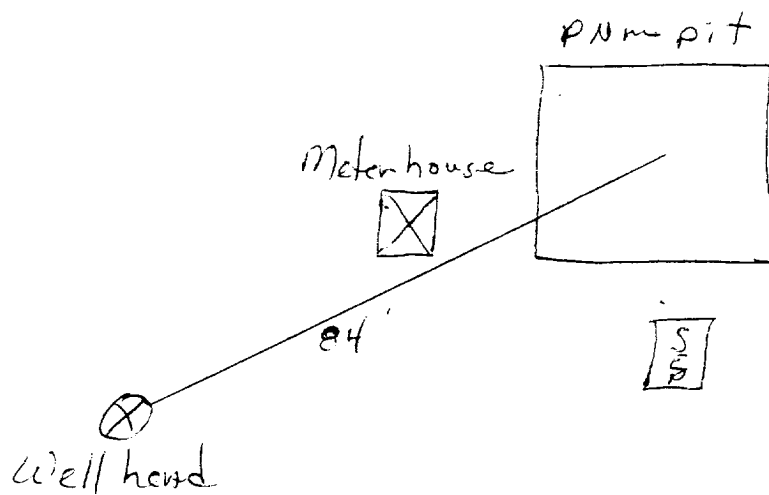

OFF: (505) 325-5667



LAB: (505) 325-1556

***Diesel Range Organics***

Attn: *Denver Bearden*  
Company: *PNM Gas Services*  
Address: *603 W. Elm*  
City, State: *Farmington, NM 87401*

Date: *11-Sep-96*  
COC No.: *5264*  
Sample No. *12123*  
Job No. *2-1000*

Project Name: ***PNM Gas Services - Jicarilla D-19 Run 12-71***  
Project Location: ***9609101530; 4pt. Composite***  
Sampled by: *EP* Date: *10-Sep-96* Time: *15:30*  
Analyzed by: *DC/BV* Date: *11-Sep-96*  
Sample Matrix: *Soil*

***Laboratory Analysis***

<b><i>Parameter</i></b>	<b><i>Result</i></b>	<b><i>Unit of Measure</i></b>	<b><i>Detection Limit</i></b>	<b><i>Unit of Measure</i></b>
<b><i>Diesel Range Organics (C10 - C28)</i></b>	<b><i>&lt;5.0</i></b>	<b><i>mg/kg</i></b>	<b><i>5.0</i></b>	<b><i>mg/kg</i></b>

***Quality Assurance Report***

DRO QC No.: *0489-QC*

***Calibration Check***

<b><i>Parameter</i></b>	<b><i>Method Blank</i></b>	<b><i>Unit of Measure</i></b>	<b><i>True Value</i></b>	<b><i>Analyzed Value</i></b>	<b><i>% Diff</i></b>	<b><i>Limit</i></b>
<b><i>Diesel Range (C10 - C28)</i></b>	<b><i>&lt;5.0</i></b>	<b><i>ppm</i></b>	<b><i>100</i></b>	<b><i>99</i></b>	<b><i>0.6</i></b>	<b><i>15%</i></b>

***Matrix Spike***

<b><i>Parameter</i></b>	<b><i>1 - Percent Recovered</i></b>	<b><i>2 - Percent Recovered</i></b>	<b><i>Limit</i></b>	<b><i>%RSD</i></b>	<b><i>Limit</i></b>
<b><i>Diesel Range (C10-C28)</i></b>	<b><i>98</i></b>	<b><i>114</i></b>	<b><i>(70-130)</i></b>	<b><i>11</i></b>	<b><i>20%</i></b>

***Method - SW-846 EPA Method 8015A mod. - Nonhalogenated Volatile Hydrocarbons by Gas Chromatography***

Approved by: *Jag*  
Date: *9/12/96*

OFF: (505) 325-5667



LAB: (505) 325-1556

### AROMATIC VOLATILE ORGANICS

Attn: *Denver Bearden*  
Company: *PNM Gas Services*  
Address: *603 W. Elm*  
City, State: *Farmington, NM 87401*

Date: *12-Sep-96*  
COC No.: *5264*  
Sample No.: *12123*  
Job No.: *2-1000*

Project Name: *PNM Gas Services - Jicarilla D-19 Run 12-71*

Project Location: *9609101530; 4pt. Composite*

Sampled by: *EP* Date: *10-Sep-96* Time: *15:30*

Analyzed by: *DC* Date: *11-Sep-96*

Sample Matrix: *Soil*

#### Laboratory Analysis

Parameter	Result	Unit of Measure	Detection Limit	Unit of Measure
Benzene	<0.2	ug/kg	0.2	ug/kg
Toluene	1.5	ug/kg	0.2	ug/kg
Ethylbenzene	<0.2	ug/kg	0.2	ug/kg
m,p-Xylene	12.9	ug/kg	0.2	ug/kg
o-Xylene	7.1	ug/kg	0.2	ug/kg
TOTAL		21.5	ug/kg	

**Method** - SW-846 EPA Method 8020 Aromatic Volatile Organics by Gas Chromatography

Approved by: *Jack*  
Date: *9/12/96*

P.O. BOX 2606 • FARMINGTON, NM 87499

- TECHNOLOGY BLENDING INDUSTRY WITH THE ENVIRONMENT -

JICARILLA APACHE TRIBE  
ENVIRONMENTAL  
PROTECTION OFFICE  
P.O. BOX 507  
DULCE, NEW MEXICO 87528

SUBMIT 1 COPY TO  
NATURAL  
RESOURCE DEPT  
AND OIL GAS  
ADMINISTRATION

ON-SITE SOIL REMEDIATION REPORT

Operator: PNM Gas Services (Conoco) Telephone: 324-3764  
Address: 603 W. Elm Street Farmington, NM 87401  
Facility or Well Name: Jicarilla D-19  
Location: Unit: I Sec. 31 T. 26 N. R. 3 W. County Rio Arriba  
Land Type: Jicarilla Apache

Date Remediation Started: 9/10/96 Date Completed: 9/27/96  
Remediation Method: Landfarmed X Approx. cubic yards 36  
Composted —  
Other —

Depth to Ground Water: (pts.) 0  
Distance to an Ephemeral Stream: (pts.) 0  
Distance to Nearest Lake, Playa,  
or Watering Pond: (pts.) 0  
Wellhead Protection Area: (pts.) 0  
Distance to Surface Water: (pts.) 0  
Ranking Score (Total Points): 0

Final Closure Sampling:

Sampling Date: 9/24/96 Time 0914  
Sampling Results:  
Field Headspace (ppm) 12.9  
TPH (ppm) <5.0 Method 8015  
Other —

I HEREBY CERTIFY THAT THE INFORMATION ABOVE IS TRUE AND COMPLETE TO THE BEST OF MY KNOWLEDGE AND BELIEF

DATE 9/27/96 PRINTED NAME Ronald A. Dedrick  
SIGNATURE Ronald A. Dedrick AND TITLE Environmental Technician II

AFTER REVIEW OF THE SOIL REMEDIATION INFORMATION, ON-SITE REMEDIATION APPROVED IN ACCORDANCE TO THE  
JICARILLA APACHE TRIBE PIT CLOSURE ORDINANCE

APPROVED: YES X NO — (REASON) —

SIGNED: [Signature] DATE: 9-30-96

Jicarilla D-19

Sec. 31 T26N R3W Unit I

Conoco

Land Farm

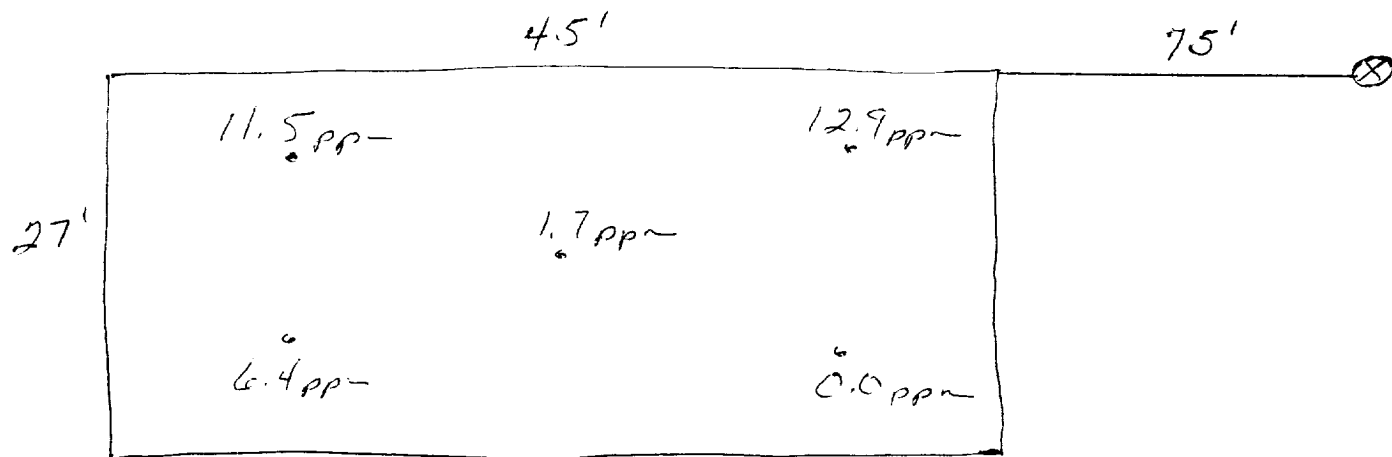

OFF: (505) 325-5667



LAB: (505) 325-1556

### *Diesel Range Organics*

Attn: *Denver Bearden*  
Company: *PNM Gas Services*  
Address: *603 W. Elm*  
City, State: *Farmington, NM 87401*

Date: *26-Sep-96*  
COC No.: *5305*  
Sample No. *12279*  
Job No. *2-1000*

Project Name: *PNM Gas Services - Jicarilla D-19 Landfarm Run 12-71*

Project Location: *9609240914; 5pt. Composite*

Sampled by: *RD* Date: *24-Sep-96* Time: *9:14*

Analyzed by: *DC/HR* Date: *25-Sep-96*

Sample Matrix: *Soil*

### *Laboratory Analysis*

<i>Parameter</i>	<i>Result</i>	<i>Unit of Measure</i>	<i>Detection Limit</i>	<i>Unit of Measure</i>
<i>Diesel Range Organics (C10 - C28)</i>	<i>&lt; 5.0</i>	<i>mg/kg</i>	<i>5.0</i>	<i>mg/kg</i>

### *Quality Assurance Report*

*DRO QC No.: 0489-QC*

#### *Calibration Check*

<i>Parameter</i>	<i>Method Blank</i>	<i>Unit of Measure</i>	<i>True Value</i>	<i>Analyzed Value</i>	<i>% Diff</i>	<i>Limit</i>
<i>Diesel Range (C10 - C28)</i>	<i>&lt; 5.0</i>	<i>ppm</i>	<i>100</i>	<i>101</i>	<i>1.3</i>	<i>15%</i>

#### *Matrix Spike*

<i>Parameter</i>	<i>1 - Percent Recovered</i>	<i>2 - Percent Recovered</i>	<i>Limit</i>	<i>%RSD</i>	<i>Limit</i>
<i>Diesel Range (C10-C28)</i>	<i>111</i>	<i>95</i>	<i>(70-130)</i>	<i>11</i>	<i>20%</i>

**Method** - *SW-846 EPA Method 8015A mod. - Nonhalogenated Volatile Hydrocarbons by Gas Chromatography*

Approved by:   
Date: *9/26/96*

**P.O. BOX 2606 • FARMINGTON, NM 87499**

*- TECHNOLOGY BLENDING INDUSTRY WITH THE ENVIRONMENT -*