

NO. OF COPIES RECEIVED	
DISTRIBUTION	
SANTA FE	
FILE	
U.S.G.S.	
LAND OFFICE	
OPERATOR	

NEW MEXICO OIL CONSERVATION COMMISSION

Form C-101
Revised 1-1-65

30-039-23802

5A. Indicate Type of Lease
STATE <input checked="" type="checkbox"/> FEE <input type="checkbox"/>
5. State Oil & Gas Lease No.
E-291-5

APPLICATION FOR PERMIT TO DRILL, DEEPEN, OR PLUG BACK

1a. Type of Work		7. Unit Agreement Name	
b. Type of Well DRILL <input checked="" type="checkbox"/> DEEPEN <input type="checkbox"/> PLUG BACK <input type="checkbox"/> OIL WELL <input type="checkbox"/> GAS WELL <input checked="" type="checkbox"/> OTHER <input type="checkbox"/> SINGLE ZONE <input checked="" type="checkbox"/> MULTIPLE ZONE <input type="checkbox"/>		Canyon Largo Unit	
2. Name of Operator		8. Farm or Lease Name	
El Paso Natural Gas Company		Canyon Largo Unit	
3. Address of Operator		9. Well No.	
PO Box 4289, Farmington, NM 87499		95E	
4. Location of Well UNIT LETTER <u>0</u> LOCATED <u>1170</u> FEET FROM THE <u>South</u> LINE AND <u>1840</u> FEET FROM THE <u>East</u> LINE OF SEC. <u>36</u> TWP. <u>25N</u> RGE. <u>6W</u> NMPM		10. Field and Pool, or Wildcat	
		Basin Dakota	
		E-320	
		12. County	
		Rio Arriba	
		19. Proposed Depth	
		7175'	
		19A. Formation	
		Dakota	
		20. Rotary or C.T.	
		Rotary	
21. Elevations (Show whether DF, RT, etc.)		21A. Kind & Status Plug. Bond	
6761' GL		statewide	
		21B. Drilling Contractor	
		22. Approx. Date Work will start	

23.

PROPOSED CASING AND CEMENT PROGRAM

SIZE OF HOLE	SIZE OF CASING	WEIGHT PER FOOT	SETTING DEPTH	SACKS OF CEMENT	EST. TOP
12 1/4"	9 5/8"	36.0#	200'	130 cu.ft.	circ.
7 7/8"	4 1/2"	11.6#/10.5#	7175'	1244 cu.ft.	3 stages

1st stage - 393 cu.ft. to cover Gallup
2nd stage - 486 cu.ft. to cover Mesa Verde
3rd Stage - 365 cu.ft. to cover Ojo Alamo

Selectively perforate and sandwater fracture the Dakota formation.

A 3000 psi WP and 6000 psi test double gate preventer equipped with blind and pipe rams will be used for blow out prevention on this well.

This gas is dedicated.

The E/2 of Section 36 is dedicated to this well.

APPROVAL EXPIRES 2-7-86
UNLESS DRILLING IS COMMENCED.
SPUD NOTICE MUST BE SUBMITTED
WITHIN 10 DAYS.

RECEIVED

AUG 06 1985

OIL CON
DIST. 8

IN ABOVE SPACE DESCRIBE PROPOSED PROGRAM; IF PROPOSAL IS TO DEEPEN OR PLUG BACK, GIVE DATA ON PRESENT PRODUCTIVE ZONE AND PROPOSED NEW PRODUCTIVE ZONE. GIVE BLOWOUT PREVENTER PROGRAM, IF ANY.

I hereby certify that the information above is true and complete to the best of my knowledge and belief.

Signed Peggy Deal Title Drilling Clerk Date August 6, 1985

(This space for State Use)

APPROVED BY Eric Busch TITLE Geologist DATE 8-7-85
AUG 07 1985

CONDITIONS OF APPROVAL, IF ANY:

All distances must be from the outer boundaries of the Section.

Operator EL PASO NATURAL GAS COMPANY			Lease CANYON LARGO UNIT (E-291-5)		Well No. 95E
Unit Letter 0	Section 36	Township 25N	Range 6W	County Rio Arriba	
Actual Footage Location of Well: 1170 feet from the South line and 1840 feet from the East line					
Ground Level Elev: 6761	Producing Formation Dakota		Pool Basin		Dedicated Acreage: 320 Acres

1. Outline the acreage dedicated to the subject well by colored pencil or hachure marks on the plat below.
2. If more than one lease is dedicated to the well, outline each and identify the ownership thereof (both as to working interest and royalty).
3. If more than one lease of different ownership is dedicated to the well, have the interests of all owners been consolidated by communitization, unitization, force-pooling, etc?

☒ Yes ☐ No If answer is "yes," type of consolidation Unitization

If answer is "no," list the owners and tract descriptions which have actually been consolidated. (Use reverse side of this form if necessary.)

No allowable will be assigned to the well until all interests have been consolidated (by communitization, unitization, forced-pooling, or otherwise) or until a non-standard unit, eliminating such interests, has been approved by the Commission.

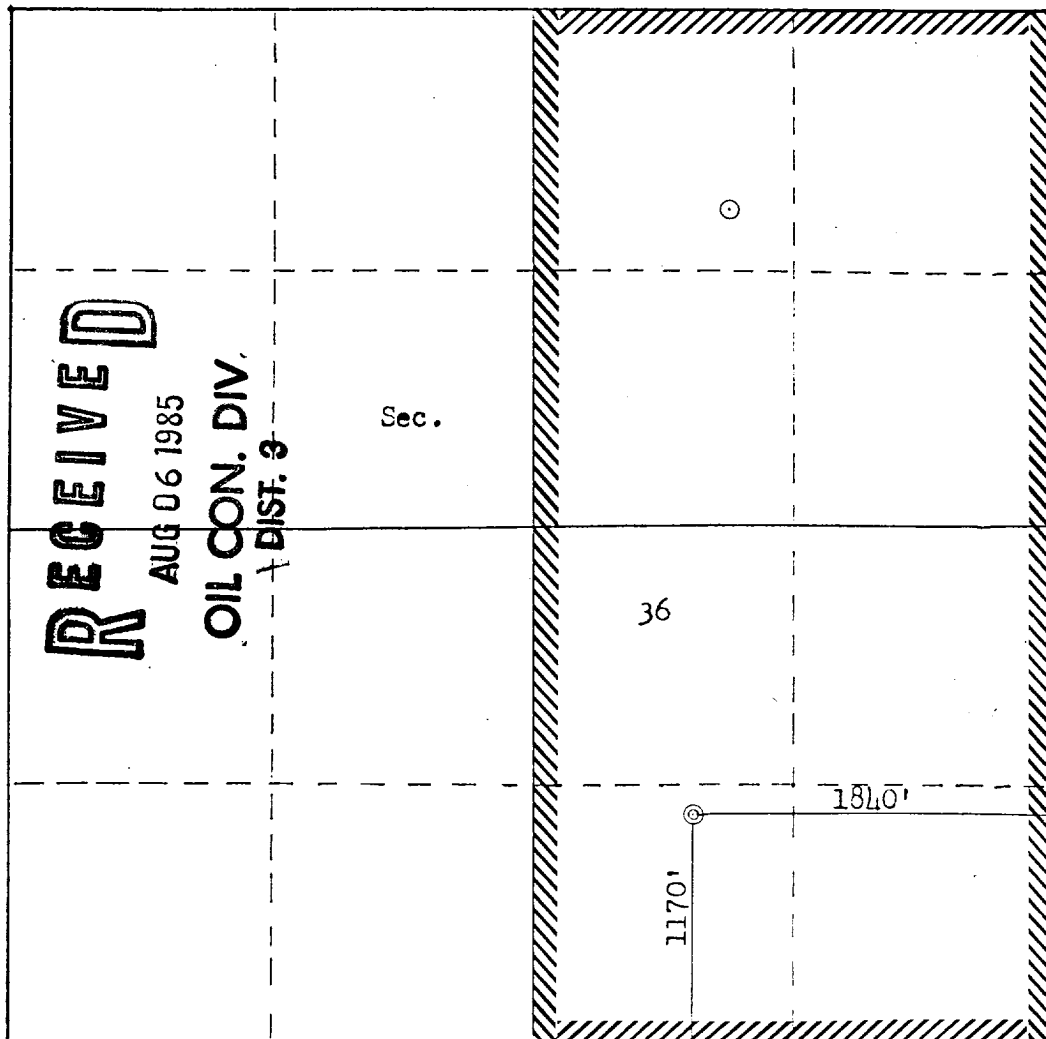

CERTIFICATION

I hereby certify that the information contained herein is true and complete to the best of my knowledge and belief.

Name
El Paso Natural Gas

Position
Drilling Clerk

Company
August 6, 1985

Date

I hereby certify that the well location shown on this plat was plotted from field notes of actual surveys made by me or under my supervision, and that the same is true and correct to the best of my knowledge and belief.

Date Surveyed
March 1985

Registered Professional Engineer
and Land Surveyor

Fred B. Kerr JR.

Certificate No.