

RECEIVED

SUBMIT IN TRIPLICATE*
(Other instructions on
reverse side)

Form approved.
Budget Bureau No. 1004-0136
Expires August 31, 1985

UNITED STATES
DEPARTMENT OF THE INTERIOR
BUREAU OF LAND MANAGEMENT

OCT 15 1985

APPLICATION FOR PERMIT TO DRILL, DEEPEN, OR PLUG BACK

1a. TYPE OF WORK

DRILL ☒

DEEPEN ☐

PLUG BACK ☐

b. TYPE OF WELL

OIL
WELL ☒

GAS
WELL ☐

OTHER

SINGLE
ZONE ☒

MULTIPLE
ZONE ☐

2. NAME OF OPERATOR

Amoco Production Co.

3. ADDRESS OF OPERATOR

501 Airport Drive, Farmington, N M 87401

4. LOCATION OF WELL (Report location clearly and in accordance with any State requirements.)*

At surface

1890' FSL X 1670' FWL

At proposed prod. zone

Same

14. DISTANCE IN MILES AND DIRECTION FROM NEAREST TOWN OR POST OFFICE*

39 miles Northeast of Counselors, New Mexico

10. DISTANCE FROM PROPOSED*

LOCATION TO NEAREST

PROPERTY OR LEASE LINE, FT.

(Also to nearest drlg. unit line, if any)

490'

16. NO. OF ACRES IN LEASE

2566.44

17. NO. OF ACRES ASSIGNED

TO THIS WELL

40

18. DISTANCE FROM PROPOSED LOCATION*

TO NEAREST WELL, DRILLING, COMPLETED,

OR APPLIED FOR, ON THIS LEASE, FT.

1500' NE

19. PROPOSED DEPTH

8445

20. ROTARY OR CABLE TOOLS

Rotary

21. ELEVATIONS (Show whether DF, RT, GR, etc.)

DRILLING OPERATIONS AUTHORIZED ARE
SUBJECT TO COMPLIANCE WITH ATTACHED
"GENERAL REQUIREMENTS".

7409' GR

PROPOSED CASING AND CEMENTING PROGRAM

This action is subject to technical and
procedural review pursuant to 43 CFR 3165.3
and appeal pursuant to 43 CFR 3165.4.

SIZE OF HOLE	SIZE OF CASING	WEIGHT PER FOOT	SETTING DEPTH
12 1/4"	8 5/8"	24#, J-55	330'
7 7/8"	5 1/2"	15.5#, K-55	8445'

QUANTITY OF CEMENT
380 c.f. class B 2% CaCl₂
1st-675 c.f. 65:35:6 class
B, 2 ppsk tuffplug 10.9
gal/sk 12 ppg. Top @ 5900
Tail with 650 c.f. 50:50:2
class B, 10% salt, .7 Fla
25#/sk celloflake, 5.24
gal/sk, 13.9 ppg. Top @
7500'.
2nd-500 c.f. 65:35:6 class
B 10.9 gal/sk, 12 ppg. To
@ surface.

(See the attached supplement)

The gas from this well is dedicated
to Northwest Pipeline.

RECEIVED
OCT 31 1985
OIL CON. DIV.
DIST. 3

IN ABOVE SPACE DESCRIBE PROPOSED PROGRAM: If proposal is to deepen or plug back, give data on present productive zone and proposed new productive zone. If proposal is to drill or deepen directionally, give pertinent data on subsurface locations and measured and true vertical depths. Give blowout preventer program, if any.

24.

SIGNED

BDS Shaw

TITLE Adm. Supervisor

DATE

APPROVED
AS AMENDED

(This space for Federal or State office use)

PERMIT NO.

APPROVAL DATE

APPROVED BY

TITLE

DATE

OCT 30 1985
J. Stan McKee

CONDITIONS OF APPROVAL, IF ANY:

M. MILLENBACH
AREA MANAGER

NMOCC

*See Instructions On Reverse Side

Title 18 U.S.C. Section 1001 makes it a crime for any person knowingly and willfully to make to any department or agency of the United States any false, fictitious or fraudulent statements or representations as to any matter within its jurisdiction.

OIL CONSERVATION DIVISION

STATE OF NEW MEXICO
ENERGY AND MINERALS DEPARTMENTP. O. BOX 2088
SANTA FE, NEW MEXICO 87501Form C-102
Revised 10-1-78

All distances must be from the outer boundaries of the Section.

Operator AMOCO PRODUCTION COMPANY		Lease JICARILLA APACHE TRIBAL "A" 118		Well No. 21
Unit Letter K	Section 26	Township 26 NORTH	Range 3 WEST	County RIO ARriba
Actual Footage Location of Well: 1890 feet from the SOUTH line and 1670 feet from the WEST line				
Ground Level Elev. 7409	Producing Formation Gallup-Dakota	Pool Ojito Gallup-Dakota	Dedicated Acreage 40 Acres	

1. Outline the acreage dedicated to the subject well by colored pencil or hachure marks on the plat below.
2. If more than one lease is dedicated to the well, outline each and identify the ownership thereof (both as to working interest and royalty).
3. If more than one lease of different ownership is dedicated to the well, have the interests of all owners been consolidated by communitization, unitization, force-pooling, etc?

☐ Yes ☐ No If answer is "yes," type of consolidation _____

If answer is "no," list the owners and tract descriptions which have actually been consolidated. (Use reverse side of this form if necessary.) _____

No allowable will be assigned to the well until all interests have been consolidated (by communitization, unitization, forced-pooling, or otherwise) or until a non-standard unit, eliminating such interests, has been approved by the Division.

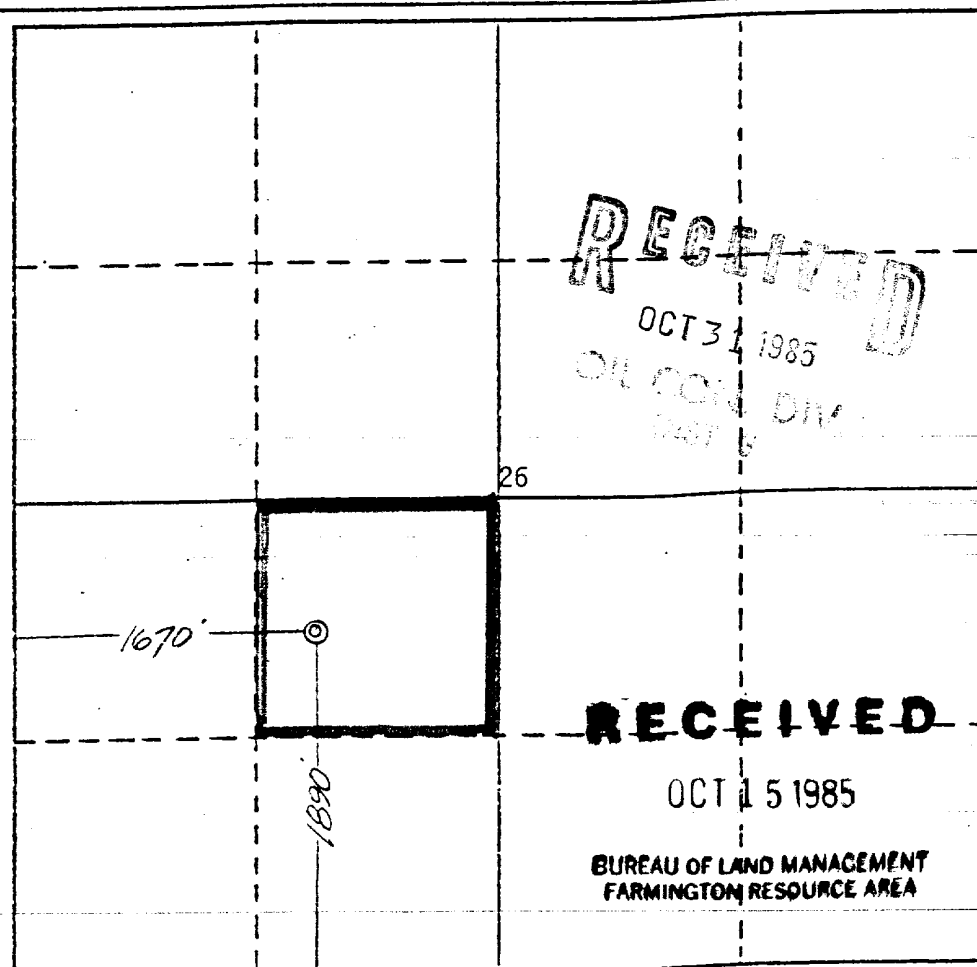

CERTIFICATION

I hereby certify that the information contained herein is true and complete to the best of my knowledge and belief.

BDS Shaw

Name

B. D. Shaw

Position

Adm. Supervisor

Company

Amoco Production Co.

Date

October 10, 1985

I hereby certify that the location shown on this plat was obtained from field notes of actual surveys made by me or under my supervision, and that the same is true and correct to the best of my knowledge and belief.

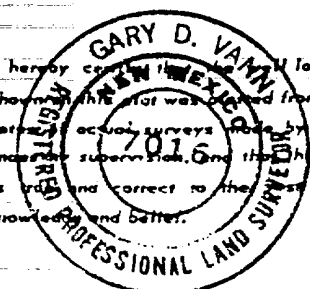

Date Surveyed

July 26, 1985

Registered Professional Engineer
and/or Land Surveyor

Gary D. Vann

Certificate No.

7016

0 330 660 990 1320 1650 1980 2310 2640 2970 3300 3630 3960 4290 4620 4950 5280 5610 5940 6270 6600

JICARILLA APACHE INDIAN RESERVE

TAPICITO

35

25

26

19

20

30

29

Hesperia Ranch

36

31

32

Ojitos

EX-101 FORDS

AMOCO PRODUCTION COMPANY
JICARILLA APACHE TRIBAL "A" 118 No. 21
1890' F/SL 1670' F/WL
SEC. 26, T26N, R3W, NMPM
RIO ARriba COUNTY, NEW MEXICO