

Submit to Appropriate
District Office
State Lease - 6 copies
Fee Lease - 5 copies

State of New Mexico
Energy, Minerals and Natural Resources Department

Form C-101
Revised 1-1-89

OIL CONSERVATION DIVISION

DISTRICT I
P.O. Box 1980, Hobbs, NM 88240

DISTRICT II
P.O. Drawer DD, Artesia, NM 88210

DISTRICT III
1000 Rio Brazos Rd., Aztec, NM 87410

P.O. Box 2088
Santa Fe, New Mexico 87504-2088

SEP 27 1993

OIL CON. DIV.

API NO. (assigned by OCD on New Wells)

30-039-25328

5. Indicate Type of Lease

STATE ☒

FEE ☐

6. State Oil & Gas Lease No.

E-291-25

APPLICATION FOR PERMIT TO DRILL, DEEPEN, OR PLUG BACK

1a. Type of Work:

DRILL ☒

RE-ENTER ☐

DEEPEN ☐

PLUG BACK ☐

b. Type of Well:

OIL
WELL ☐

GAS
WELL ☒

OTHER

SINGLE
ZONE ☐

MULTIPLE
ZONE ☒

7. Lease Name or Unit Agreement Name

State "B" Comm

2. Name of Operator

Caulkins Oil Company 3124

3. Address of Operator

P.O. Box 340, Bloomfield, NM 87413 PH. (505) 632-1544

8. Well No.

233-R

9. Pool name or Wildcat So. Blanco PC-72439
Otero Chacra-Blanco MV-Basin Dakota

4. Well Location

Unit Letter C : 945' Feet From The North Line and 1830' Feet From The West Line

Section 16 Township 26N Range 6W NMPM Rio Arriba County

10. Proposed Depth

7550'

11. Formation

PC-Chacra-MV-Dakota Rotary

12. Rotary or C.T.

13. Elevations (Show whether DF, RT, GR, etc.)

6691 GR

14. Kind & Status Plug. Bond

15. Drilling Contractor

Aztec Well Service

16. Approx. Date Work will start

11-15-93

17. PROPOSED CASING AND CEMENT PROGRAM

| SIZE OF HOLE | SIZE OF CASING | WEIGHT PER FOOT | SETTING DEPTH | SACKS OF CEMENT | EST. TOP |
|--------------|----------------|-----------------|---------------|--------------------|----------|
| 12 1/4 | 9 5/8 | 36.00 | 400' 450' | 250 (295 cu.ft.) | Surface |
| 7 7/8 | 5 1/2 | 15.5 & 17.00 | 7550' | 1400 (2000 cu.ft.) | Surface |

It is proposed to drill Dakota well to approximately 7550' 15.5# and 17.0# Smls casing to be run to TD and cemented in 3 stages with sufficient cement to circulate to surface.

Well will be drilled with 9.0# fluids surface to TD. A 10" 3000# WP, 6000# test BOP will be in use at all times while drilling below surface pipe.

Subject to approval by OCD, well will be dual completed, and downhole commingled with packer set between the commingled Dakota - Mesa Verde zones and commingled Pictured Cliffs - Chacra zones. All four zones will be perforated and foam frac'd individually to stimulate production.

This well is being drilled to replace State "B" Comm 233 located at 980' F/W and 1145' F/N, Sec. 16-26N-6W.

IN ABOVE SPACE DESCRIBE PROPOSED PROGRAM: IF PROPOSAL IS TO DEEPEN OR PLUG BACK, GIVE DATA ON PRESENT PRODUCTIVE ZONE AND PROPOSED NEW PRODUCTIVE ZONE. GIVE BLOWOUT PREVENTER PROGRAM, IF ANY.

I hereby certify that the information above is true and complete to the best of my knowledge and belief.

SIGNATURE

Robert L. Verquer

TITLE

Superintendent

DATE 9-24-93

TYPE OR PRINT NAME

Robert L. Verquer

TELEPHONE NO. 632-1544

(This space for State Use)

APPROVED BY

CONDITIONS OF APPROVAL, IF ANY:

DEPUTY OIL & GAS INSPECTOR, DIST. #3

TITLE

DATE

This Approval

Expires

9-27-94

And Will Not Be

SEP 27 1993

Submit to Appropriate
District Office
State Lease - 4 copies
Fee Lease - 3 copies

State of New Mexico
Energy, Minerals and Natural Resources Department

Form C-102
Revised 1-1-89

OIL CONSERVATION DIVISION

P.O. Box 2088
Santa Fe, New Mexico 7504-2088

DISTRICT I
P.O. Box 1980, Hobbs, NM 88240

DISTRICT II
P.O. Drawer DD, Artesia, NM 88210

DISTRICT III
1000 Rio Brazos Rd., Aztec, NM 87410

WELL LOCATION AND ACREAGE DEDICATION PLAT

All Distances must be from the outer boundaries of the section

| | | | | | | | | |
|---|----------------------|---|--------------------------------|---|-----------------------------|--|--|------------|
| Operator CAULKINS OIL COMPANY | | | Lease STATE "B" COMM | | | Well No. 233 R | | |
| Unit Letter C | Section 16 | Township 26 N. | Range 6 W. | NMPM | County RIO ARRIBA | | | |
| Actual Footage Location of Well: 945 feet from the NORTH line and 1830 feet from the WEST line | | | | | | | | |
| Ground level Elev. 6691 | | Producing Formation PICTURED CLIFFS-CHACRA-MESA VERDE-DAKOTA | | Pool SO. BLANCO PC-OTERO CHACRA BLANCO MV - BASIN DAKOTA | | Dedicated Acreage: PC-CHACRA 160 MV-DAKOTA 160 | | 320 |

1. Outline the acreage dedicated to the subject well by colored pencil or hatchue marks on the plat below.

2. If more than one lease is dedicated to the well, outline each and identify the ownership thereof (both as to working interest and royalty).

3. If more than one lease of different ownership is dedicated to the well, have the interest of all owners been consolidated by communitization, unitization, force-pooling, etc.?

☒ Yes ☐ No If answer is "yes" type of consolidation Communitization

If answer is "no" list the owners and tract descriptions which have actually been consolidated. (Use reverse side of this form if necessary.)

No allowable will be assigned to the well until all interests have been consolidated (by communitization, unitization, forced-pooling, or otherwise) or until a non-standard unit, eliminating such interest, has been approved by the Division.

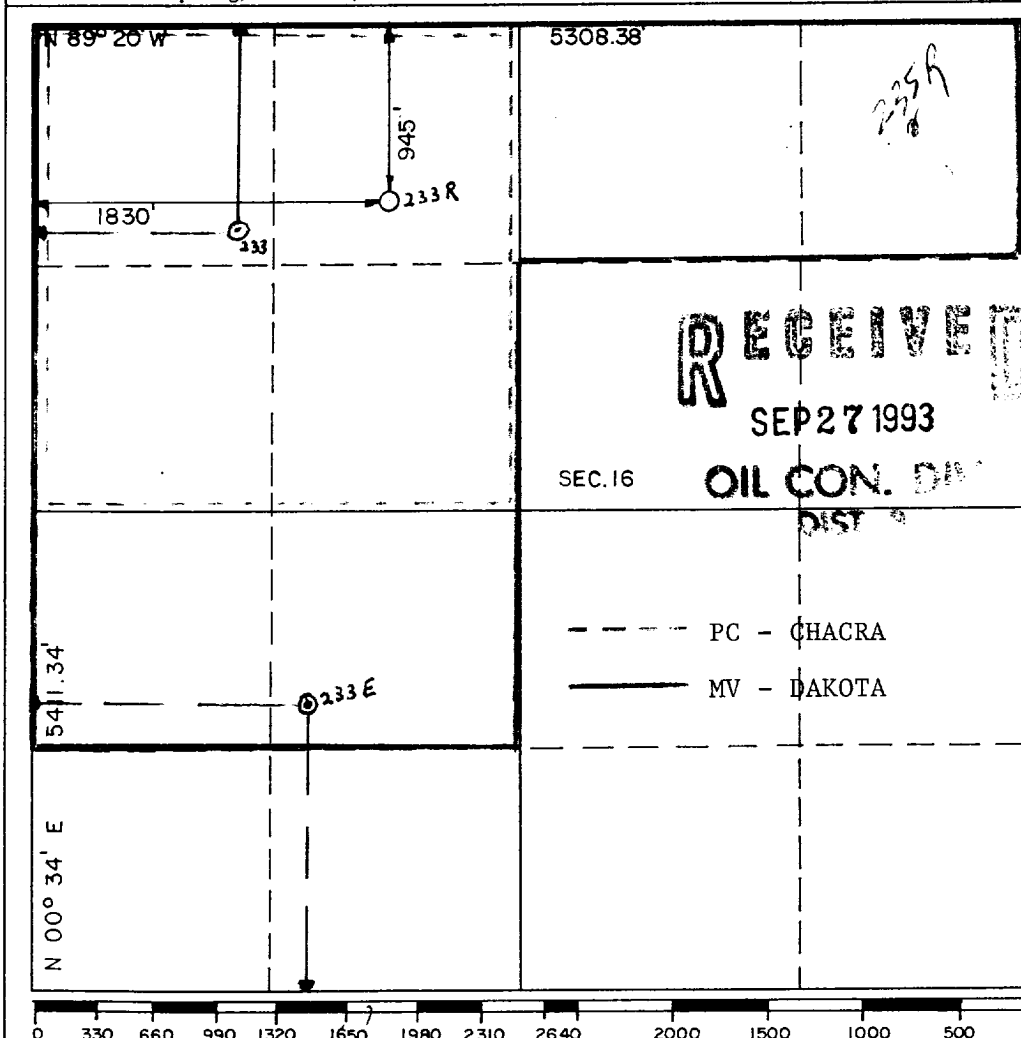

OPERATOR CERTIFICATION

I hereby certify that the information contained herein is true and complete to the best of my knowledge and belief.

Signature

Robert L. Verquer

Printed Name

ROBERT L. VERQUER

Position

SUPERINTENDENT

Company

CAULKINS OIL COMPANY

Date

SEPTEMBER 24, 1993

SURVEYOR CERTIFICATION

I hereby certify that the well location shown on this plat was plotted from field notes of actual surveys made by me or under my supervision, and that the same is true and correct to the best of my knowledge and belief.

Date Surveyed

SEPTEMBER 15, 1993

Signature & Seal

Professional Surveyor

R. Howard Daggett

R. HOWARD DAGGETT
NEW MEXICO
0879
REGISTERED PROFESSIONAL LAND SURVEYOR

Registered Professional
Land Surveyor

10-27-66

To Center of Hole 125 feet

125 feet

80 feet

To Center of Hole 40 feet

GENERAL Rig LAYOUT

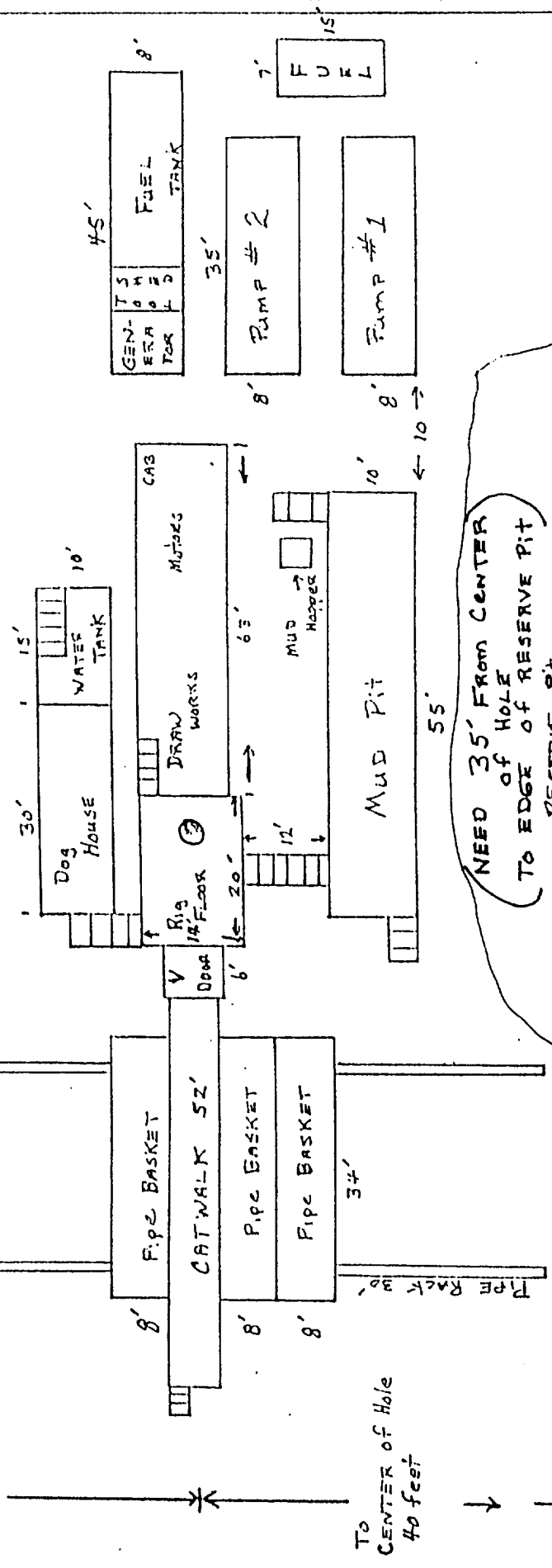
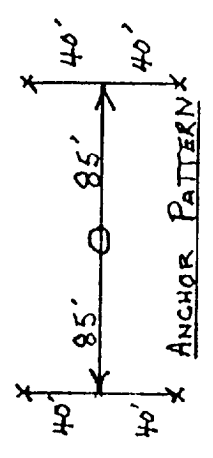

NEED 35' FROM CENTER OF HOLE TO EDGE OF RESERVE PIT
RESERVE PIT
100' X 100' X 5'