

Form 9-331a  
(Feb. 1961)

(SUBMIT IN TRIPLICATE)

Land Office Santa Fe

Lease No. 57-079930

Unit L. E. Lockhart

UNITED STATES  
DEPARTMENT OF THE INTERIOR  
GEOLOGICAL SURVEY

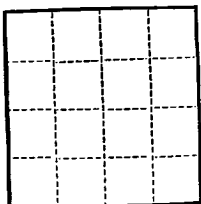

SUNDRY NOTICES AND REPORTS ON WELLS

NOTICE OF INTENTION TO DRILL	<input checked="" type="checkbox"/>	SUBSEQUENT REPORT OF WATER SHUT-OFF
NOTICE OF INTENTION TO CHANGE PLANS		SUBSEQUENT REPORT OF SHOOTING OR ACIDIZING
NOTICE OF INTENTION TO TEST WATER SHUT-OFF		SUBSEQUENT REPORT OF ALTERING CASING
NOTICE OF INTENTION TO RE-DRILL OR REPAIR WELL		SUBSEQUENT REPORT OF RE-DRILLING OR REPAIR
NOTICE OF INTENTION TO SHOOT OR ACIDIZE		SUBSEQUENT REPORT OF ABANDONMENT
NOTICE OF INTENTION TO PULL OR ALTER CASING		SUPPLEMENTARY WELL HISTORY
NOTICE OF INTENTION TO ABANDON WELL		

(INDICATE ABOVE BY CHECK MARK NATURE OF REPORT, NOTICE, OR OTHER DATA)

June 14, 1957

L. E. Lockhart  
Well No. 1 is located 440 ft. from S line and 1980 ft. from E line of sec. 33

SW/4 SE/4 Sec. 33 (1/4 Sec. and Sec. No.) 25N (Twp.) 10W (Range) N.M.P.M. (Meridian)  
Undesignated (Gallup) (Field) San Juan (County or Subdivision) New Mexico (State or Territory)

The elevation of the derrick floor above sea level is \_\_\_\_\_ ft.

DETAILS OF WORK

(State names of and expected depths to objective sands; show sizes, weights, and lengths of proposed casings; indicate mudding jobs, cementing points, and all other important proposed work)

It is our intention to drill well No. 1 to approximately 5500' to test the Gallup formation. Our casing program is as follows:

300' of 10-3/4" OD casing, 32.75# NW H-40, cemented with 150 sks. reg. cement - circulated.  
5500' of 5-1/2" OD casing, 14# SS J-55, cemented with 250 sks. reg. cement.

The designated drilling unit is the SW/4 SE/4 of Section 33-25N-10W, San Juan County, New Mexico.

I understand that this plan of work must receive approval in writing by the Geological Survey before operations may be commenced.

Company Oil Company

Address 1000 N. 1st St. Gallup, N.M.

By (Signed) P. M. Gosper

Title District Superintendent

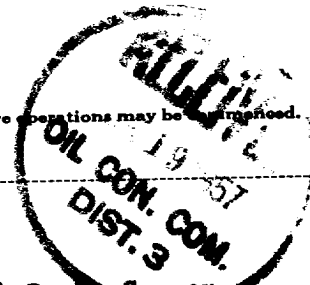



NEW MEXICO OIL CONSERVATION COMMISSION  
Well Location and Acreage Dedication Plat

Section A.

Date June 14, 1957

Operator SKELLY OIL COMPANY Lease L. E. LOCKHART  
Well No. 1 Unit Letter 33 Section 33 Township 25 NORTH Range 10 WEST NMPM  
Located 660 Feet From the SOUTH Line, 1980 Feet From the EAST Line  
County SAN JUAN G. L. Elevation \_\_\_\_\_ Dedicated Acreage 40 Acres  
Name of Producing Formation Gallup Pool Undesignated

1. Is the Operator the only owner\* in the dedicated acreage outlined on the plat below?  
Yes X No \_\_\_\_\_.
2. If the answer to question one is "no," have the interests of all the owners been consolidated by communitization agreement or otherwise? Yes \_\_\_\_\_ No \_\_\_\_\_. If answer is "yes," Type of Consolidation \_\_\_\_\_
3. If the answer to question two is "no," list all the owners and their respective interests below:

Owner

Land Description

\_\_\_\_\_  
\_\_\_\_\_  
\_\_\_\_\_

\_\_\_\_\_  
\_\_\_\_\_  
\_\_\_\_\_

Section B

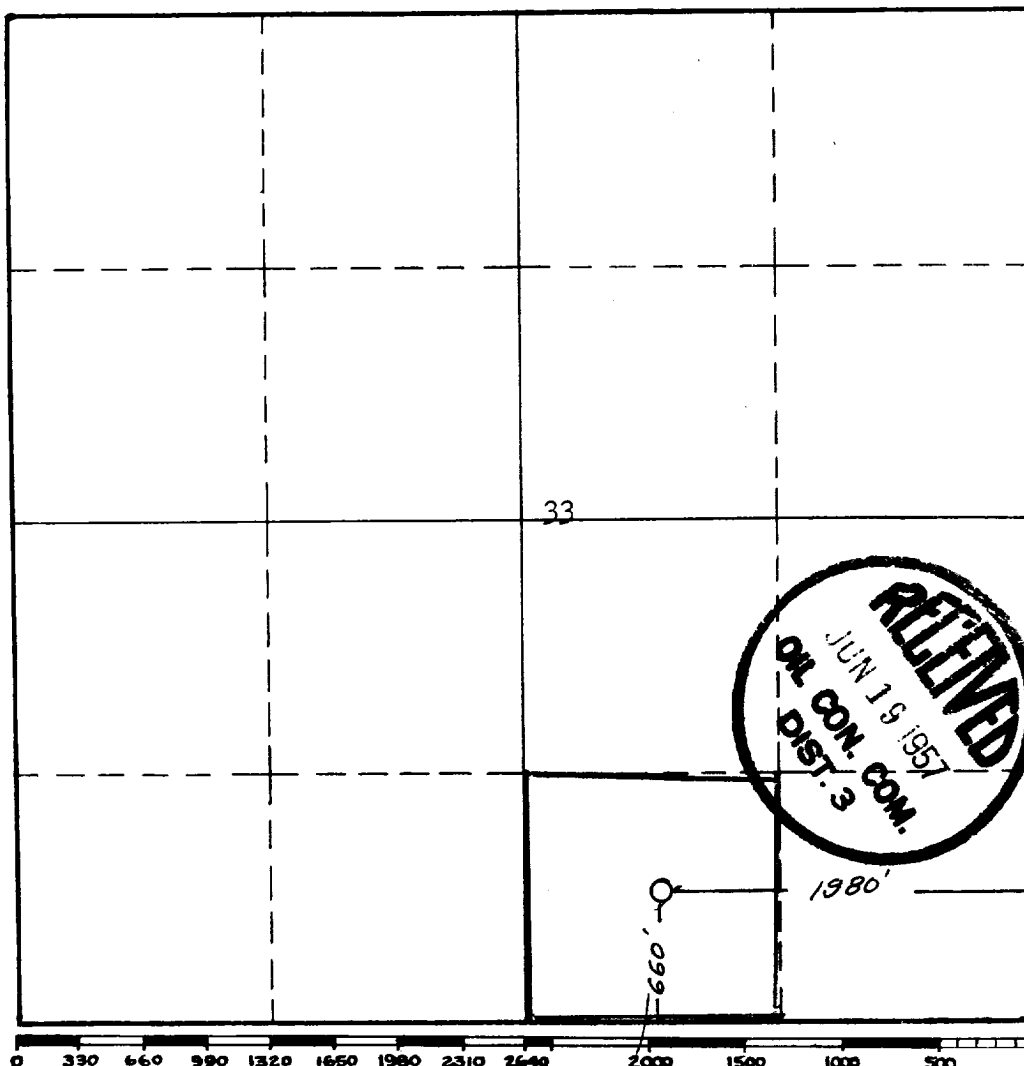

This is to certify that the information in Section A above is true and complete to the best of my knowledge and belief.

Shelly Oil Company  
(Operator)

(Signed) P. E. Cosper  
(Representative)

Box 426, Farmington, New Mexico  
Address

This is to certify that the well location shown on the plat in Section B was plotted from field notes of actual surveys made by me or under my supervision and that the same is true and correct to the best of my knowledge and belief.

Date Surveyed 8 JUNE 1957

James P. Leese  
Registered Professional  
Engineer and/or Land Surveyor.

James P. Leese  
Certificate No. 1463

(See instructions for completing this form on the reverse side)

**INSTRUCTIONS FOR COMPLETION:**

1. Operator shall furnish and certify to the information called for in Section A.
2. Operator shall outline the dedicated acreage for both oil and gas wells on the plat in Section B.
3. A registered professional engineer or land surveyor registered in the State of New Mexico or approved by the Commission shall show on the plat the location of the well and certify this information in the space provided.
4. All distances shown on the plat must be from the outer boundaries of Section.
5. If additional space is needed for listing owners and their respective interests as required in question 3, Section A, please use space below



\* "Owner" means the person who has the right to drill into and to produce from any pool and to appropriate the production either for himself or for himself and another. (65-3-29 (e) NMSA 1953 Comp.)