

NEW MEXICO OIL CONSERVATION COMMISSION

Well Location and Acreage Dedication Plat

Section A.

Date April 18, 1958

Operator Elmwood-2411 Lease Patented Elmwood T
Well No. 3 Unit Letter F Section 33 Township 25 North Range 10 West NMPM
Located 1980 Feet From North Line, 1980 Feet From West Line
County San Juan G. L. Elevation 6793 Dedicated Acreage 80 Acres
Name of Producing Formation Lower Gallup Pool Elmwood

1. Is the Operator the only owner* in the dedicated acreage outlined on the plat below?
Yes X No
2. If the answer to question one is "no," have the interests of all the owners been consolidated by communitization agreement or otherwise? Yes No . If answer is "yes,"
Type of Consolidation
3. If the answer to question two is "no," list all the owners and their respective interests below:

Owner

Land Description

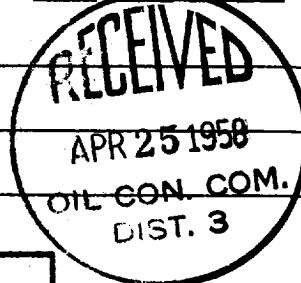

Section. B

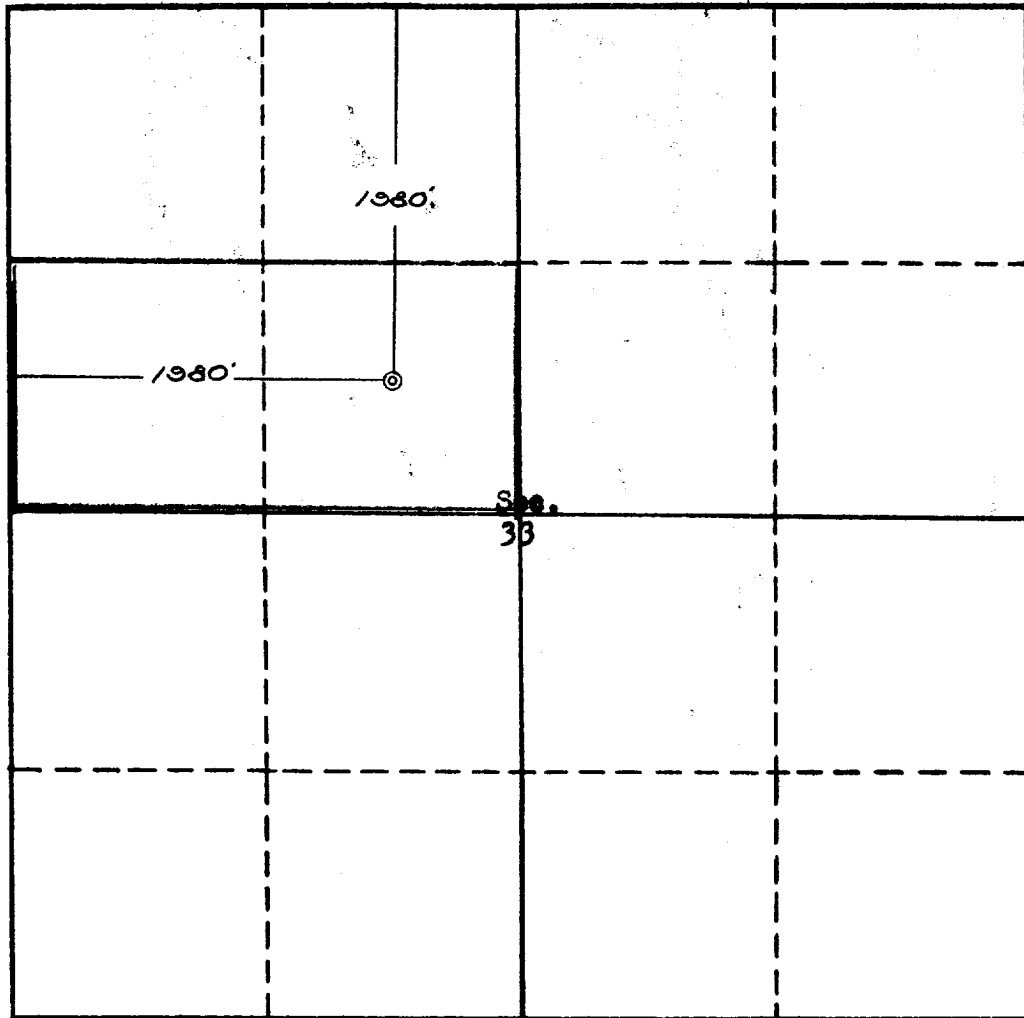

This is to certify that the information in Section A above is true and complete to the best of my knowledge and belief.

Elmwood-2411

(Operator)

[Signature]
(Representative)

Box 702, Roswell, New Mexico

Address

This is to certify that the well location shown on the plat in Section B is plotted from field notes of actual surveys made by me or under my supervision and that the same is true and correct to the best of my knowledge and belief.

Date Surveyed April 18, 1958

[Signature]
Ernest V. Echohawk
Registered Land Surveyor.

Certificate No. 1545

OIL CONSERVATION COMMISSION
AZTEC DISTRICT OFFICE

No. Copies Received 3

DISTRIBUTION

	NO. FURNISHED	
Operator		
Santa Fe		
Permitting Office	/	
State Land Office		
U. S. G. S.	/	
Transporter		
File	/	✓