

NEW MEXICO OIL CONSERVATION COMMISSION

Well Location and Acreage Dedication Plat
As Amended by Order No. 2-1069-2

Section A.

Date 1-30-58

Operator Gulf Oil Corporation Lease Teh Nos Bah Nadins-Navaajo
Well No. 1 Unit Letter 1 Section 21 Township 23 North Range 11 West NMPM
Located 1623 Feet From South Line, 923 Feet From West Line
County Santa Juan G. L. Elevation 6333 Dedicated Acreage 80 Acres
Name of Producing Formation Gallup Pool North-Lower Gallup

1. Is the Operator the only owner* in the dedicated acreage outlined on the plat below?
Yes 1 No .
2. If the answer to question one is "no," have the interests of all the owners been consolidated by communitization agreement or otherwise? Yes No . If answer is "yes," Type of Consolidation
3. If the answer to question two is "no," list all the owners and their respective interests below:

Owner

Land Description

FEB 4 1958

OIL CON. COM.
DIST. 3

Section B

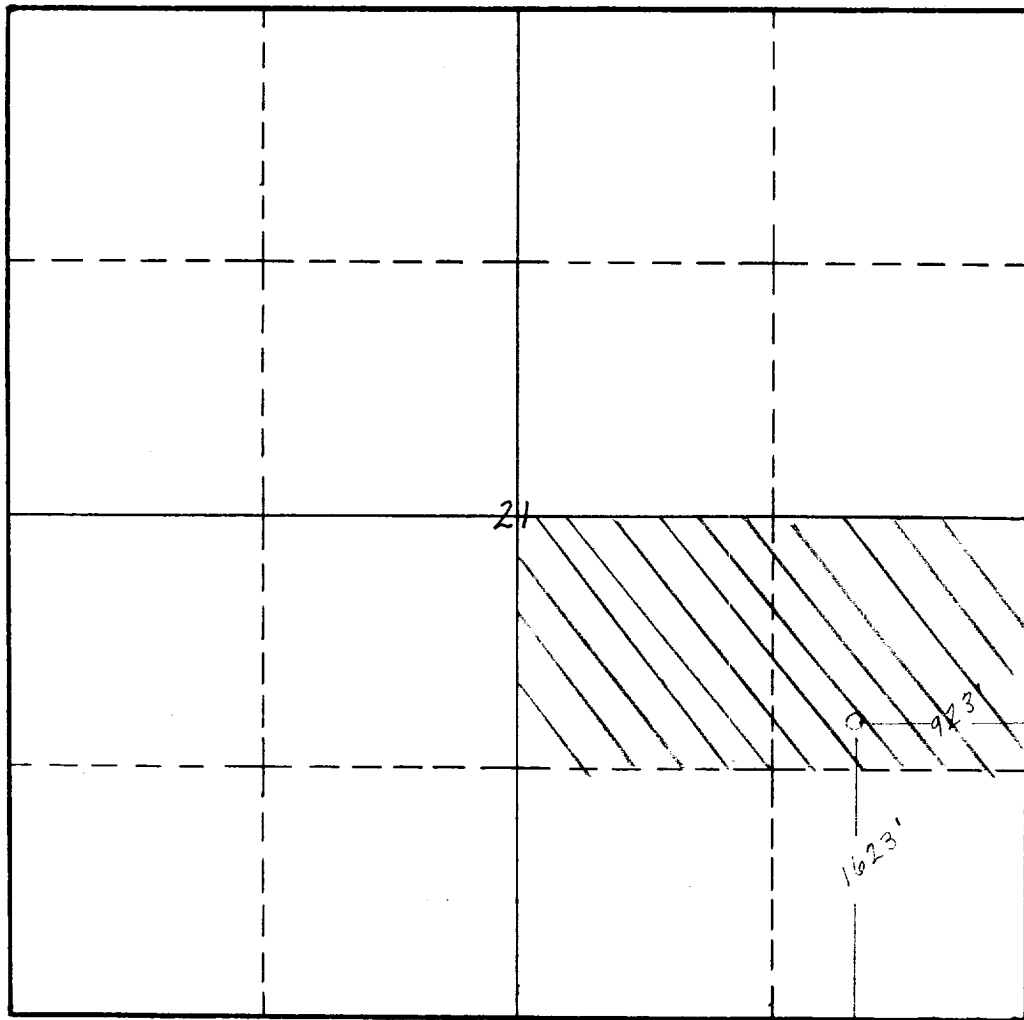

This is to certify that the information in Section A above is true and complete to the best of my knowledge and belief.

Gulf Oil Corporation

(Operator)

(Representative)

W. D. Mitchell

Area Production Superintendent

Address

P. O. Box 38, Durango, Colo.

This is to certify that the well location shown on the plat in Section B was plotted from field notes of actual surveys made by me or under my supervision and that the same is true and correct to the best of my knowledge and belief.

Date Surveyed June 15, 1957

/s/ Ernest V. Schoback

Registered Professional
Engineer and/or Land Surveyor.

1545

Certificate No.

(See instructions for completing this form on the reverse side)

INSTRUCTIONS FOR COMPLETION:

1. Operator shall furnish and certify to the information called for in Section A.
2. Operator shall outline the dedicated acreage for both oil and gas wells on the plat in Section B.
3. A registered professional engineer or land surveyor registered in the State of New Mexico or approved by the Commission shall show on the plat the location of the well and certify this information in the space provided.
4. All distances shown on the plat must be from the outer boundaries of Section.
5. If additional space is needed for listing owners and their respective interests as required in question 3, Section A, please use space below

OIL CONSERVATION COMMISSION		
AZTEC DISTRICT OFFICE		
No. Copies Received		
DISTRIBUTION		
	No.	Signature
Operator		
Landman		
Proration Office		
State Land Office		
U. S. G. S.		
Transporter		
File		

* "Owner" means the person who has the right to drill into and to produce from any pool and to appropriate the production either for himself or for himself and another. (65-3-29 (e) NMSA 1953 Comp.)