

NEW MEXICO OIL CONSERVATION COMMISSION
Well Location and Acreage Dedication Plat

Section A.

Date March 5, 1958

Operator Sunray Mid-Continent Oil Company Lease La-La-Hel e-wood
Well No. 1 Unit Letter I Section 22 Township 25N Range 11W NMPM
Located 1980 Feet From South Line, 760 Feet From East Line
County San Juan G. L. Elevation 6453 ungraded Dedicated Acreage 80 Acres
Name of Producing Formation Gallup Sand Pool Disti-Gallup

1. Is the Operator the only owner* in the dedicated acreage outlined on the plat below?
Yes _____ No x.
2. If the answer to question one is "no," have the interests of all the owners been consolidated by communitization agreement or otherwise? Yes x No _____. If answer is "yes," Type of Consolidation Partnership
3. If the answer to question two is "no," list all the owners and their respective interests below:

<u>Owner</u>	<u>Land Description</u>
<u>Sunray Mid-Continent Oil Company</u> <u>50%</u>	<u>N/2 of SE/4 Section 22, T25N, R11W</u>
<u>Sinclair Oil Company</u> <u>30%</u>	<u>" " " " " "</u>

Section B

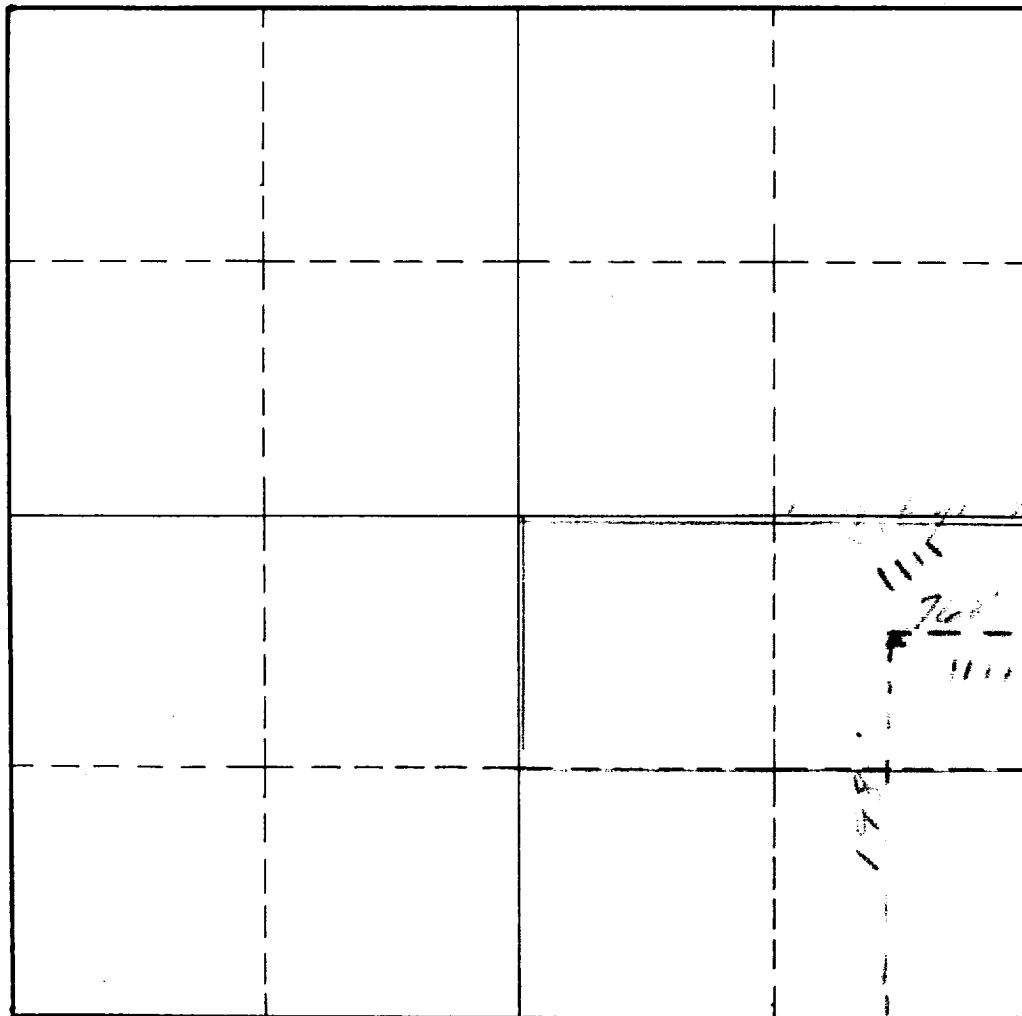

RECEIVED
MAR 6 1958
OIL CON. COM.
DIST. 3

This is to certify that the information in Section A above is true and complete to the best of my knowledge and belief.

Sunray Mid-Continent Oil Company
(Operator)
Robert E. Statler
(Representative)

Box 128, Hobbs, New Mexico
Address

This is to certify that the well location shown on the plat in Section B was plotted from field notes of actual surveys made by me or under my supervision and that the same is true and correct to the best of my knowledge and belief.

Date Surveyed Feb. 7, 1957

Ernest V. Kachamak
Registered Professional
Engineer and/or Land Surveyor.

Certificate No. 1545

(See instructions for completing this form on the reverse side)

INSTRUCTIONS FOR COMPLETION:

1. Operator shall furnish and certify to the information called for in Section A.
2. Operator shall outline the dedicated acreage for both oil and gas wells on the plat in Section B.
3. A registered professional engineer or land surveyor registered in the State of New Mexico or approved by the Commission shall show on the plat the location of the well and certify this information in the space provided.
4. All distances shown on the plat must be from the outer boundaries of Section.
5. If additional space is needed for listing owners and their respective interests as required in question 3, Section A, please use space below

OIL CONSERVATION COMMISSION		
AZTEC DISTRICT OFFICE		
No. Copies Received	3	
DATE RECEIVED		
Operator	/	
Engineer	/	
Transporter		
File	1	✓

* "Owner" means the person who has the right to drill into and to produce from any pool and to appropriate the production either for himself or for himself and another. (65-3-29 (e) NMSA 1953 Comp.)