



UNITED STATES
DEPARTMENT OF THE INTERIOR
GEOLOGICAL SURVEY
P. O. Box 965
Farmington, New Mexico

May 2, 1956

Shell Oil Company
33 Richards Street
Salt Lake City 1, Utah

Re: Santa Fe 078066

Gentlemen:

Receipt is acknowledged of your "Notice of Intention to Drill" dated May 1, 1956 covering your well No. 14-15 Government in SW $\frac{1}{4}$ SW $\frac{1}{4}$ sec. 18, T. 25 N., R. 12 W., N. M. P. M., San Juan County, New Mexico, Bisti pool.

Your proposed work is hereby approved subject to compliance with the provisions of the "Oil and Gas Operating Regulations" revised May 25, 1942, a copy of which will be sent to you on request, and subject to the following conditions:

1. Drilling operations so authorized are subject to the attached sheet for general conditions of approval.
2. Furnish copies of all logs.

Very truly yours,

(Orig. Sign.) J. W. Long

Jerry W. Long
Acting District Engineer

J. Longrac



Form 9-331a
(Feb. 1951)

	15	
X		

(SUBMIT IN TRIPLICATE)

UNITED STATES
DEPARTMENT OF THE INTERIOR
GEOLOGICAL SURVEY

Land Office Santa Fe, New Mexico
Lease No. 87-078066
Unit _____

SUNDRY NOTICES AND REPORTS ON WELLS

NOTICE OF INTENTION TO DRILL.....	<input checked="" type="checkbox"/>	SUBSEQUENT REPORT OF WATER SHUT-OFF.....
NOTICE OF INTENTION TO CHANGE PLANS.....		SUBSEQUENT REPORT OF SHOOTING OR ACIDIZING.....
NOTICE OF INTENTION TO TEST WATER SHUT-OFF.....		SUBSEQUENT REPORT OF ALTERING CASING.....
NOTICE OF INTENTION TO RE-DRILL OR REPAIR WELL.....		SUBSEQUENT REPORT OF RE-DRILLING OR REPAIR.....
NOTICE OF INTENTION TO SHOOT OR ACIDIZE.....		SUBSEQUENT REPORT OF ABANDONMENT.....
NOTICE OF INTENTION TO PULL OR ALTER CASING.....		SUPPLEMENTARY WELL HISTORY.....
NOTICE OF INTENTION TO ABANDON WELL.....		

(INDICATE ABOVE BY CHECK MARK NATURE OF REPORT, NOTICE, OR OTHER DATA)

by 1, 1956

Government
Well No. 14-15 is located 660 ft. from S line and 660 ft. from W line of sec. 15
SW 1/4, Sec. 15 (1/4 Sec. and Sec. No.) 25 N (Twp.) 12 W (Range) N 100° 00' E (Meridian)
R141 (Field) San Juan (County or Subdivision) New Mexico (State or Territory)

The elevation of the derrick floor above sea level is 6242.59 ft. (approx. ground)

DETAILS OF WORK

(State names of and expected depths to objective sands; show sizes, weights, and lengths of proposed casings; indicate mudding jobs, cementing points, and all other important proposed work)

1. Drill 11" hole to 200'±.
2. Run and cement 8 5/8" casing at 200'± with sufficient cement to reach surface.
3. Drill 7 7/8" hole to a total depth of 4850'±.
4. If commercial production is obtained a supplementary completion notice will be filed, otherwise, plug and abandon in accordance with U.S.G.S. regulations.

Surface formation is Ojo Alamo.

I understand that this plan of work must receive approval in writing by the Geological Survey before operations may be commenced.

Company Shell Oil Company
Address 33 Richards Street
Salt Lake City 1, Utah
By R. E. Eddy
Title Sr. Exploitation Engineer

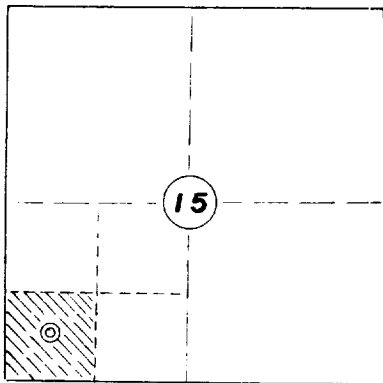
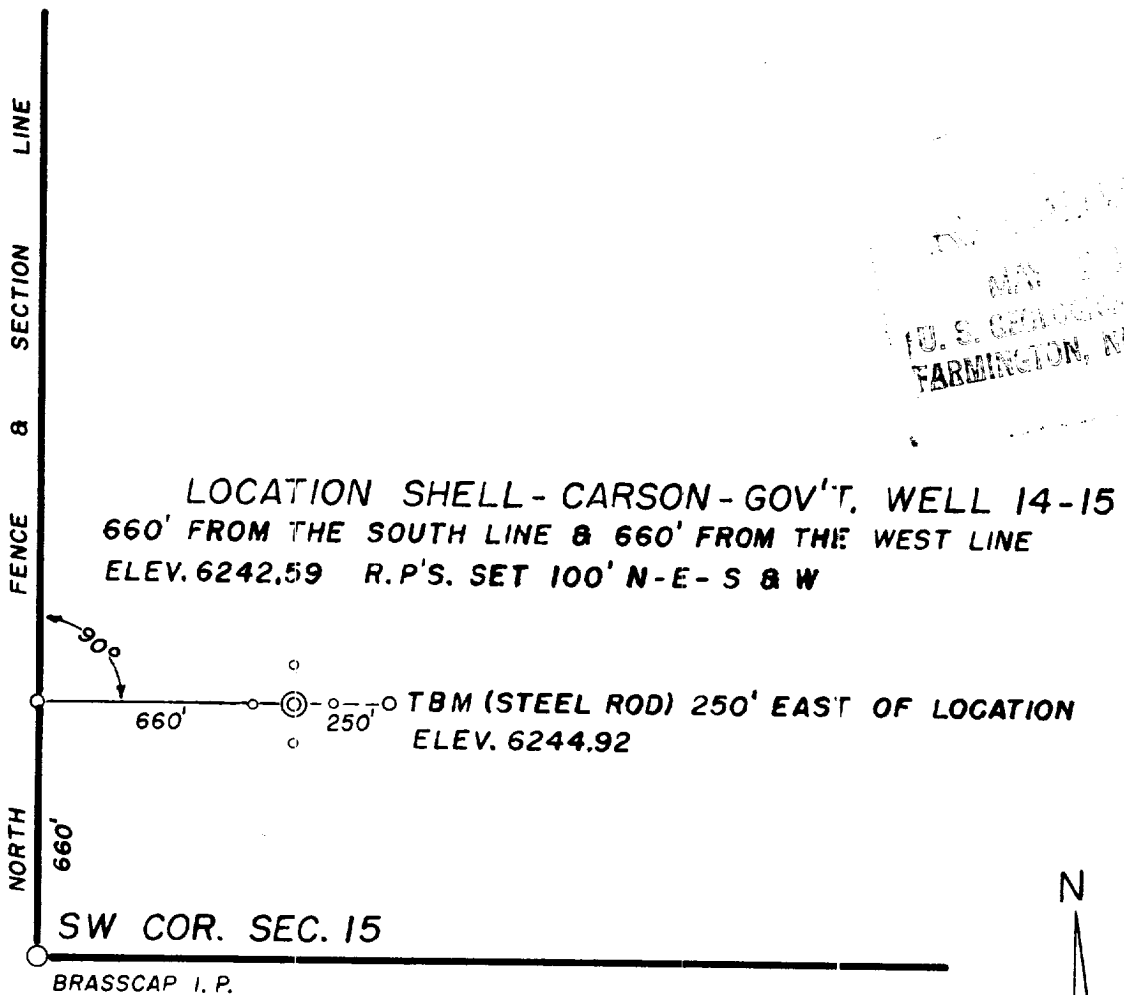

THIS IS TO CERTIFY THAT THE ABOVE PLAT WAS PREPARED FROM
 FIELD NOTES OF ACTUAL SURVEYS MADE BY ME OR UNDER MY
 SUPERVISION AND THAT THE SAME ARE TRUE AND CORRECT TO
 THE BEST OF MY KNOWLEDGE AND BELIEF.

James P. Leese
 JAMES P. LEESE
 REGISTERED LAND SURVEYOR
 REG. NO. 1463 NEW MEX.

SHELL OIL CO.	
WELL LOCATION SW 1/4 SW 1/4	
SECTION 15 T25N R12W NMPM	
SAN JUAN COUNTY NEW MEX	
APRIL 22 1956	SCALE 1" = 500'
DRAWN BY W.G.	
SAN JUAN ENGINEERING CO.	
FARMINGTON NEW MEXICO	
216-523-1	