

(SUBMIT IN TRIPLICATE)

UNITED STATES
DEPARTMENT OF THE INTERIOR
GEOLOGICAL SURVEY

Land Office Santa Fe
Lease No. 070079-A
Unit SA/4

SUNDRY NOTICES AND REPORTS ON WELLS

RECEIVED

NOTICE OF INTENTION TO DRILL.....	<input checked="" type="checkbox"/>	SUBSEQUENT REPORT OF WATER SHUT-OFF.....	APR 21 1958
NOTICE OF INTENTION TO CHANGE PLANS.....		SUBSEQUENT REPORT OF SHOOTING OR ACIDIZING.....	
NOTICE OF INTENTION TO TEST WATER SHUT-OFF.....		SUBSEQUENT REPORT OF ALTERING CASING.....	
NOTICE OF INTENTION TO RE-DRILL OR REPAIR WELL.....		SUBSEQUENT REPORT OF RE-DRILLING OR REPAIR.....	
NOTICE OF INTENTION TO SHOOT OR ACIDIZE.....		SUBSEQUENT REPORT OF ABANDONMENT.....	
NOTICE OF INTENTION TO PULL OR ALTER CASING.....		SUPPLEMENTARY WELL HISTORY.....	
NOTICE OF INTENTION TO ABANDON WELL.....			

(INDICATE ABOVE BY CHECK MARK NATURE OF REPORT, NOTICE, OR OTHER DATA)

April 21, 1958

Well No. 1 is located 660 ft. from EXX line and 1,980 ft. from EXX line of sec. 17

SE/SE Section 17 (1/4 Sec. and Sec. No.) 25-North (Twp.) 13-West (Range) N.M.P.M. (Meridian)
Wildcat (Field) San Juan County (County or Subdivision) New Mexico (State or Territory)

The elevation of the derrick floor above sea level is 6,335 ft.

DETAILS OF WORK

(State names of and expected depths to objective sands; show sizes, weights, and lengths of proposed casings; indicate mudding jobs, cementing points, and all other important proposed work)

Proposed to drill a Dakota test with Rotary Tools. Casing program:
175' - 10-3/4" 40# New J-55 surface casing. Cement with 800 sacks cement.
Circulate cement to surface.
Dakota sand expected at 6,900'. If commercial production obtained, set
3-1/2" - 15# casing on bottom - perforate, and sand fracture. Run 2-3/8" tubing
for production.

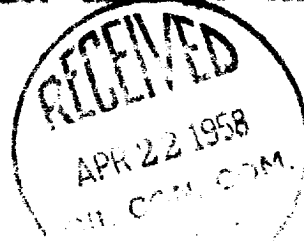

I understand that this plan of work must receive approval in writing by the Geological Survey before operations may be commenced.

Company Kenneth Hershman
Address P. O. Box 728
Farmington, New Mexico

By C. Deeson Neal
Title C. Deeson Neal, Agent in Farmington

NEW MEXICO OIL CONSERVATION COMMISSION

Well Location and Acreage Dedication Plat

Section A.

Date April 21, 1958

Operator Kenneth Murchison Lease Federal - Santa Fe 078079-4
Well No. 1 Unit Letter N Section 17 Township 25 North Range 13 West NMPM
Located 660 Feet From South Line, 1980 Feet From West Line
County San Juan G. L. Elevation 6325 Dedicated Acreage 160 Acres
Name of Producing Formation Dakota Pool Wildcat

1. Is the Operator the only owner* in the dedicated acreage outlined on the plat below?
Yes _____ No X
2. If the answer to question one is "no," have the interests of all the owners been consolidated by communitization agreement or otherwise? Yes X No _____. If answer is "yes,"
Type of Consolidation Owners of record contributing acreage to operator for test well.
3. If the answer to question two is "no," list all the owners and their respective interests below:

Owner

Land Description



RECEIVED

APR 21 1958

Section. B

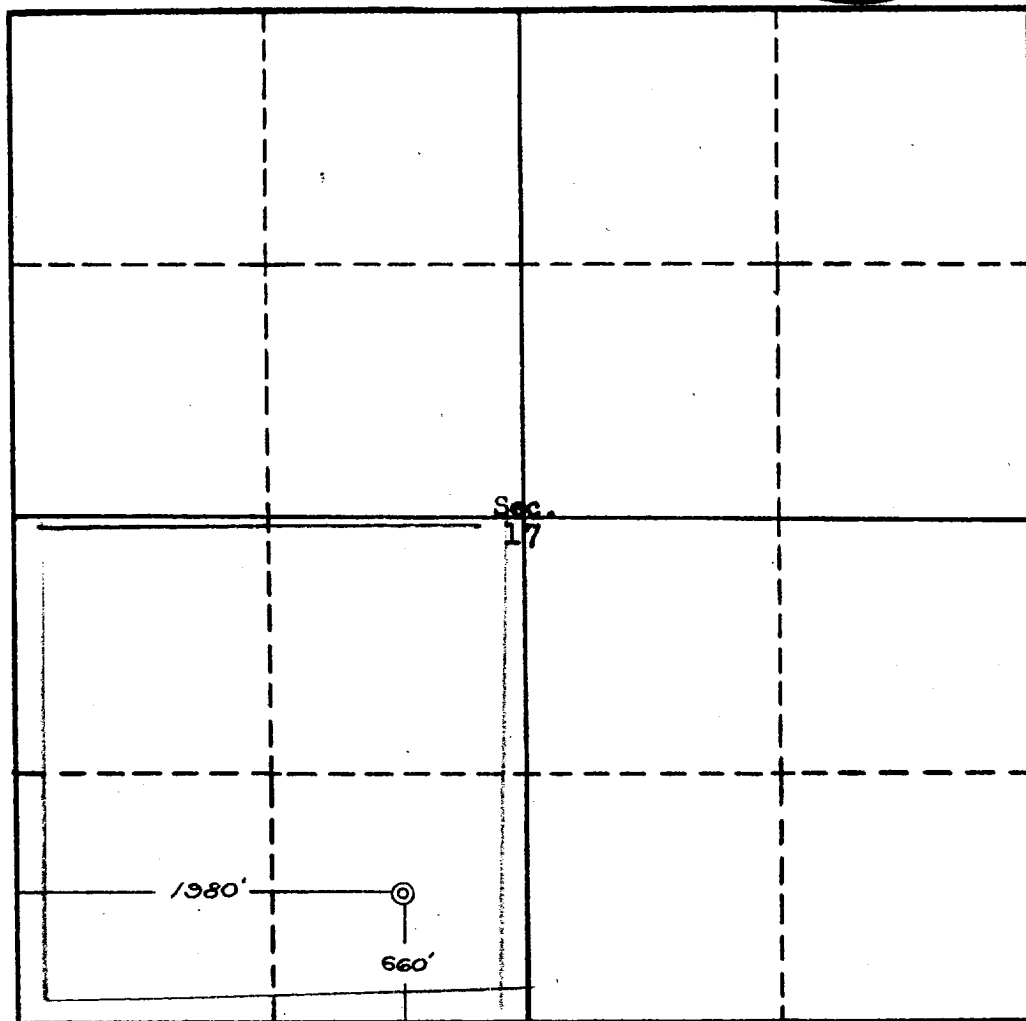

This is to certify that the information in Section A above is true and complete to the best of my knowledge and belief.

KENNETH MURCHISON

(Operator)

(Representative)

C. Deason Neal, Agent
Box 728 - Farmington, N. M.
Address

This is to certify that the well location shown on the plat in Section B was plotted from field notes of actual surveys made by me or under my supervision and that the same is true and correct to the best of my knowledge and belief.

Date Surveyed April 19, 1958

Ernest V. Echoshawk
Ernest V. Echoshawk
Registered Land Surveyor.

Certificate No. 1545