

(SUBMIT IN TRIPLICATE)

UNITED STATES
DEPARTMENT OF THE INTERIOR
GEOLOGICAL SURVEY

Land Office Santa Fe

Lease No. 24 03999

Unit Mexico Fed #J

SUNDRY NOTICES AND REPORTS ON WELLS

NOTICE OF INTENTION TO DRILL	<input checked="" type="checkbox"/>	SUBSEQUENT REPORT OF WATER SHUT-OFF	
NOTICE OF INTENTION TO CHANGE PLANS		SUBSEQUENT REPORT OF SHOOTING OR ACIDIZING	
NOTICE OF INTENTION TO TEST WATER SHUT-OFF		SUBSEQUENT REPORT OF ALTERING CASING	
NOTICE OF INTENTION TO RE-DRILL OR REPAIR WELL		SUBSEQUENT REPORT OF RE-DRILLING OR REPAIR	
NOTICE OF INTENTION TO SHOOT OR ACIDIZE		SUBSEQUENT REPORT OF ABANDONMENT	
NOTICE OF INTENTION TO PULL OR ALTER CASING		SUPPLEMENTARY WELL HISTORY	
NOTICE OF INTENTION TO ABANDON WELL			

(INDICATE ABOVE BY CHECK MARK NATURE OF REPORT, NOTICE, OR OTHER DATA)

July 28, 1960

Mexico Fed #J

Well No. 1 is located 1850 ft. from N line and 1850 ft. from W line of sec. _____

NE 1/4 Section 17

(1/4 Sec. and Sec. No.)

25N

(Twp.)

3E

(Range)

N.M.P.M.

(Meridian)

Undesignated - Dakota

(Field)

San Juan

(County or Subdivision)

New Mexico

(State or Territory)

The elevation of the derrick floor above sea level is _____ ft.

DETAILS OF WORK

(State names of and expected depths to objective sands; show sizes, weights, and lengths of proposed casings; indicate mudding jobs, cementing points, and all other important proposed work)

It is our intention to drill well No. 1 to test the Dakota formation at a depth of around 6750'. Our casing program is as follows:

300' of 10-3/4" OD casing 32.75# R-40, cemented with 300 sacks cement. Cement to be circulated.

6750' of 5 1/2" OD casing, combination string of 14# and 15.5#, J-55 RTAC, cemented with 300 sacks cement.

The designated drilling unit is the SE 1/4 - NE 1/4 Section 17-25N-3E, _____ County, New Mexico.

I understand that this plan of work must receive approval in writing by the Geological Survey before operations may be commenced.

Company Shelly Oil Company

Address Drewer 510

Farmington, New Mexico

By (Signed) P. E. Cosper

Title District Superintendent

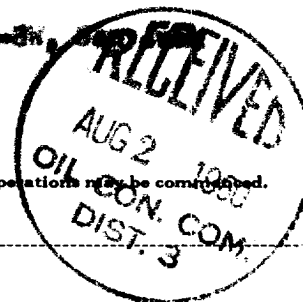

NEW MEXICO OIL CONSERVATION COMMISSION
WELL LOCATION AND ACREAGE DEDICATION PLAT

FORM C-128
Revised 5/1/57

SEE INSTRUCTIONS FOR COMPLETING THIS FORM ON THE REVERSE SIDE

SECTION A

Operator SKELLY OIL COMPANY		Lease MEXICO FED		Well No. 1
Unit Letter F	Section 17	Township 25 NORTH	Range 8 WEST	County SAN JUAN
Actual Footage Location of Well: 1850 feet from the NORTH line and 1850 feet from the WEST line				
Ground Level Elev.	Producing Formation Dakota	Pool Undesignated - Dakota	Dedicated Acreage: 40 Acres	

1. Is the Operator the only owner in the dedicated acreage outlined on the plat below? YES **X** NO ____ . ("Owner" means the person who has the right to drill into and to produce from any pool and to appropriate the production either for himself or for himself and another. (65-3-29 (e) NMSA 1935 Comp.)
2. If the answer to question one is "no," have the interests of all the owners been consolidated by communitization agreement or otherwise? YES ____ NO ____ . If answer is "yes," Type of Consolidation ____
3. If the answer to question two is "no," list all the owners and their respective interests below:

Owner	Land Description

SECTION B

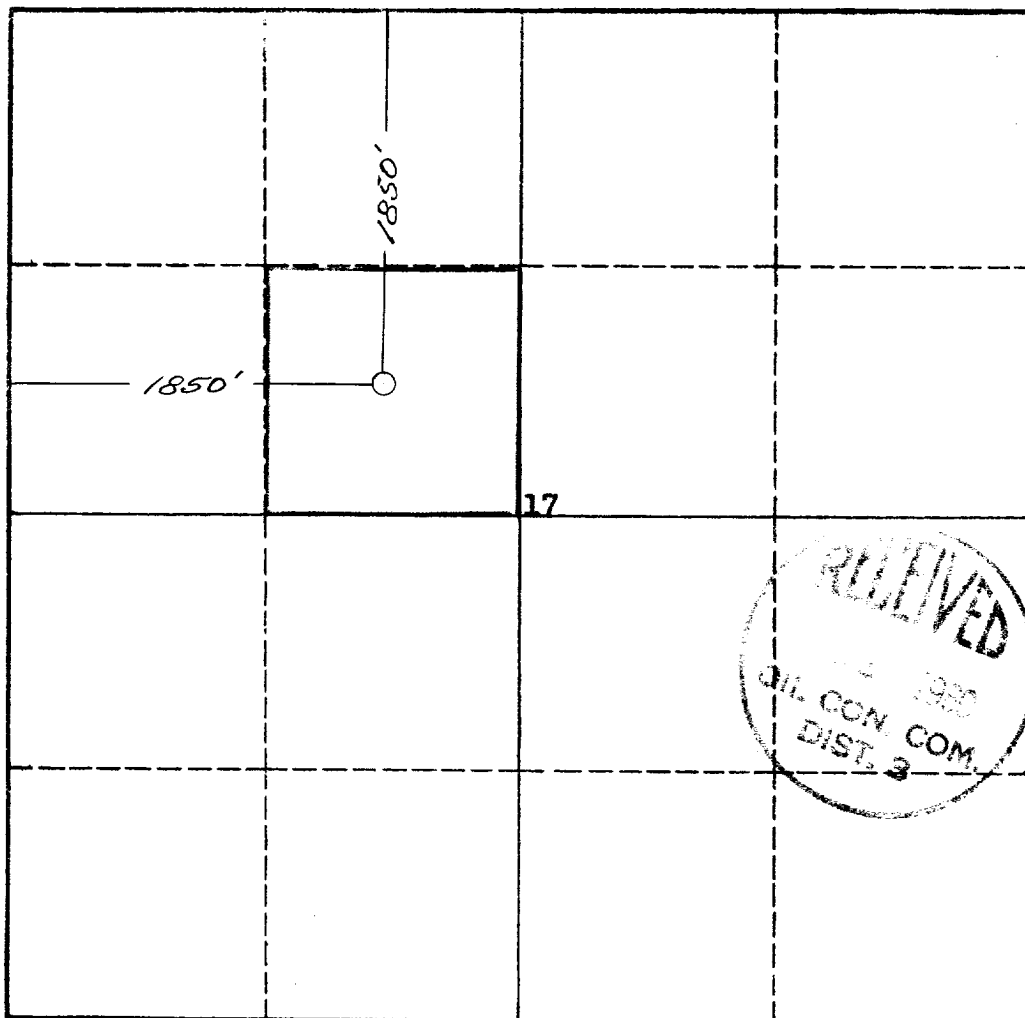

CERTIFICATION

I hereby certify that the information in SECTION A above is true and complete to the best of my knowledge and belief.

Name
(Signed) P. E. Gosper
Position
District Superintendent
Company
Skelly Oil Company
Date
July 28, 1960

I hereby certify that the well location shown on the plat in SECTION B was plotted from field notes of actual surveys made by me or under my supervision, and that the same is true and correct to the best of my knowledge and belief.

Date Surveyed
25 July 1960
Registered Professional Engineer
and/or Land Surveyor
James P. Leese
Certificate No.
1463

0 330 660 990 1320 1650 1980 2310 2640 2000 1500 1000 500 0