



COPY TO O.C.G.

UNITED STATES
DEPARTMENT OF THE INTERIOR
GEOLOGICAL SURVEY
P. O. Box 965
Farmington, New Mexico

IN REPLY REFER TO:

May 10, 1956

Benson-Montin Greer Drilling Corp.
405 1/2 West Broadway
Farmington, New Mexico

Re: Santa Fe 078630

Gentlemen:

Receipt is acknowledged of your "Notice of Intention to Drill" dated May 2, 1956 covering your well No. 6 Foster-Riddle in NE 1/4 sec. 13, T. 25 N., R. 8 W., N. M. P. M., San Juan County, New Mexico, Ballard ext.

Your proposed work is hereby approved subject to compliance with the provisions of the "Oil and Gas Operating Regulations" revised May 25, 1952, a copy of which will be sent to you on request, and subject to the following conditions:

1. Drilling operations so authorized are subject to the attached sheet for general conditions of approval.
2. Furnish copies of all logs.

Very truly yours,

(Orig. S. 100-100000)

Jerry W. Long
Acting District Engineer

JWLong:ac

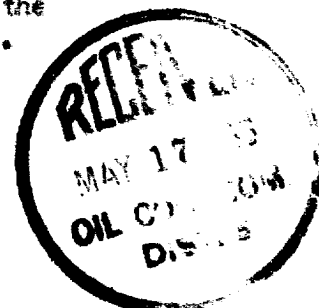

(SUBMIT IN TRIPLICATE)
UNITED STATES
DEPARTMENT OF THE INTERIOR
GEOLOGICAL SURVEY

Land Office Santa Fe
Lease No. 07630
Unit Foster-Riddle
NE/4 of Sec. 13 is
Designated Drilling
Unit

SUNDRY NOTICES AND REPORTS ON WELLS

NOTICE OF INTENTION TO DRILL.....	<input checked="" type="checkbox"/>	SUBSEQUENT REPORT OF WATER SHUT-OFF.....
NOTICE OF INTENTION TO CHANGE PLANS.....	<input type="checkbox"/>	SUBSEQUENT REPORT OF SHOOTING OR ACIDIZING.....
NOTICE OF INTENTION TO TEST WATER SHUT-OFF.....	<input type="checkbox"/>	SUBSEQUENT REPORT OF ALTERING CASING.....
NOTICE OF INTENTION TO RE-DRILL OR REPAIR WELL.....	<input type="checkbox"/>	SUBSEQUENT REPORT OF REDRILLING OR REPAIR.....
NOTICE OF INTENTION TO SHOOT OR ACIDIZE.....	<input type="checkbox"/>	SUBSEQUENT REPORT OF ABANDONMENT.....
NOTICE OF INTENTION TO PULL OR ALTER CASING.....	<input type="checkbox"/>	SUPPLEMENTARY WELL HISTORY.....
NOTICE OF INTENTION TO ABANDON WELL.....	<input type="checkbox"/>	

(INDICATE ABOVE BY CHECK MARK NATURE OF REPORT, NOTICE, OR OTHER DATA)

May 2nd, 1956

Well No. 6 is located 1228 ft. from [N] line and 857 ft. from [E] line of sec. 13

NE/4 NE/4 Sec. 13 25N 8W N. M. P. M.
(1/4 Sec. and Sec. No.) (Twp.) (Range) (Meridian)
Ballard San Juan New Mexico
(Field) (County or Subdivision) (State or Territory)

RECEIVED
MAY 10 1956
GEOLOGICAL SURVEY
FARMINGTON, NEW MEXICO

The elevation of the derrick floor above sea level is 6576 ft.

DETAILS OF WORK

(State names of and expected depths to objective sands; show sizes, weights, and lengths of proposed casings; indicate mudding jobs, cementing points, and all other important proposed work)

Pictured Cliffs Sand test. Estimated total depth 2000'.

Surface Casing: 90' of 8-5/8" OD 24# J-55 cemented to surface.
Production : Approximately 2200' of 5-1/2" OD 15.5# J-55
cemented with 100 sacks.

If commercial production is indicated, the producing section will be shot with nitroglycerin and/or sand-oil treated.

I understand that this plan of work must receive approval in writing by the Geological Survey before operations may be commenced.

Company BENSON-MONTIN-GREER DRILLING CORP.

Address 405 1/2 West Broadway

Farmington, New Mexico

By Walter H. Greer

Title Vice-President

COMPANY HEMSON - MORTIN - GREEN DRILLING CORPORATION

Well Name & No. FOSTER NO. 6

Lease No. _____

Location 1226' FROM THE NORTH LINE AND 657' FROM THE EAST LINE.

Being in SW NE NE

Sec. 13, T 25 N., R. 2 W., N.M.P.M.

SAN JUAN COUNTY, NEW MEXICO

Ground Elevation 6560.5 UNGRADER.

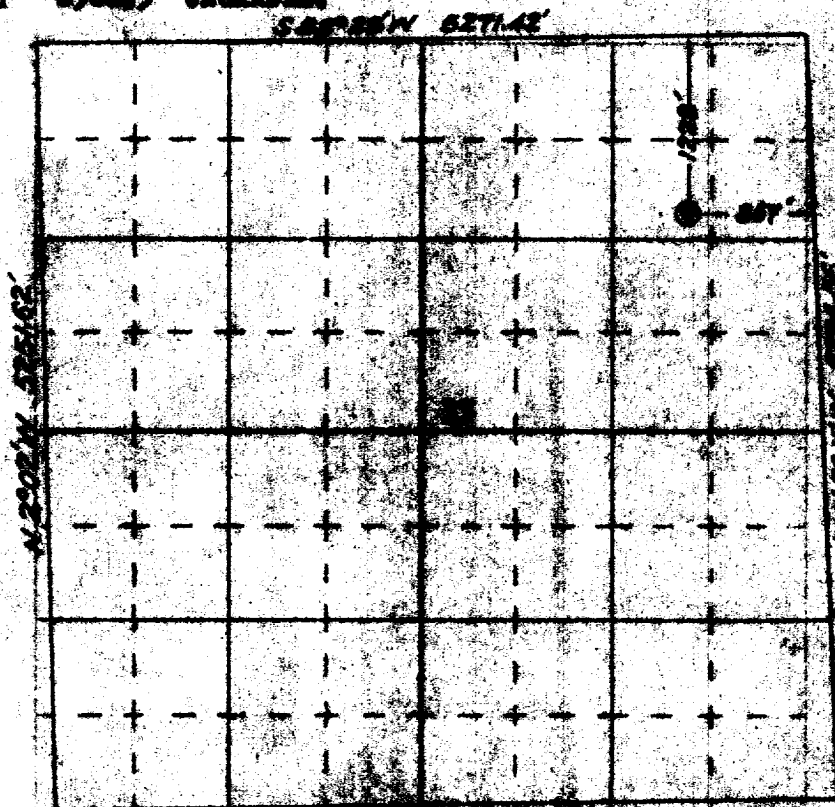

RECEIVED
MAY 10 1956
U. S. GEOLOGICAL SURVEY
SARASOTA, NEW MEXICO

Surveyed _____

31 JANUARY

1956

This is to certify that the above plat was prepared from field notes of actual survey made by me or under my supervision and that the same are true and correct to the best of my knowledge and belief.

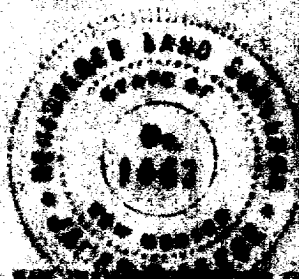

James P. Hesse
JAMES P. HESSE
S. M. S. S. S. S. S.

NEW MEXICO DEPARTMENT OF CONSERVATION, NEW MEXICO