



COPY TO O.G.C.

UNITED STATES  
DEPARTMENT OF THE INTERIOR  
GEOLOGICAL SURVEY  
P. O. Box 965  
Farmington, New Mexico

IN REPLY REFER TO:

December 30, 1955

Senson-Mottin-Greer Drilling Corp.  
405 1/2 West Broadway  
Farmington, New Mexico

Re: Santa Fe 078630

Gentlemen:

Receipt is acknowledged of your "Notice of Intention to Drill" dated December 29, 1955 covering your well No. 1 Foster-Riddle in NE 1/4 NW 1/4 sec. 13, T. 25 N., R. 8 W., N. M. P. M., San Juan County, New Mexico, Ballard P.C.

Your proposed work is hereby approved subject to compliance with the provisions of the "Oil and Gas Operating Regulations" revised May 25, 1942, a copy of which will be sent to you on request, and subject to the following conditions:

1. Drilling operations so authorized are subject to the attached sheet for general conditions of approval.
2. Furnish copies of all logs.

Very truly yours,

(Orig. Sgd.) P. T. McGrath

P. T. McGrath  
District Engineer

PTMcGrath:ac

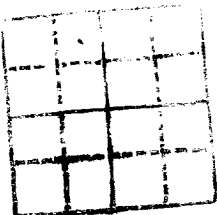

IN REPLY REFER TO:

UNITED STATES  
DEPARTMENT OF THE INTERIOR  
GEOLOGICAL SURVEY



OFFICE OF THE  
DIRECTOR

(SUBMIT IN TRIPLICATE)

UNITED STATES  
DEPARTMENT OF THE INTERIOR  
GEOLOGICAL SURVEY

Land Office Santa Fe  
Lease No. 078630  
Unit Foster-Riddle

NW/4 of Section 13 is  
Designated Drilling Unit

SUNDRY NOTICES AND REPORTS ON WELLS

NOTICE OF INTENTION TO DRILL.....	<input checked="" type="checkbox"/>	SUBSEQUENT REPORT OF WATER SHUT-OFF.....
NOTICE OF INTENTION TO CHANGE PLANS.....		SUBSEQUENT REPORT OF SHOOTING OR ACIDIZING.....
NOTICE OF INTENTION TO TEST WATER SHUT-OFF.....		SUBSEQUENT REPORT OF ALTERING CASING.....
NOTICE OF INTENTION TO RE-DRILL OR REPAIR WELL.....		SUBSEQUENT REPORT OF REDRILLING OR REPAIR.....
NOTICE OF INTENTION TO SHOOT OR ACIDIZE.....		SUBSEQUENT REPORT OF ABANDONMENT.....
NOTICE OF INTENTION TO PULL OR ALTER CASING.....		SUPPLEMENTARY WELL HISTORY.....
NOTICE OF INTENTION TO ABANDON WELL.....		

(INDICATE ABOVE BY CHECK MARK NATURE OF REPORT, NOTICE, OR OTHER DATA)

December 29th, 1955

Well No. 1 is located 1065 ft. from N line and 1850 ft. from W line of sec. 13

NW/4 NW/4 Sec. 13 25N 8W N.M.P.M.  
(1/4 Sec. and Sec. No.) (Twp.) (Range) (Meridian)  
Ballard PC San Juan New Mexico  
(Field) (County or Subdivision) (State or Territory)

The elevation of the derrick floor above sea level is 6643 ft.

DETAILS OF WORK

(State names of and expected depths to objective sands; show sizes, weights, and lengths of proposed casings; indicate mudding jobs, cementing points, and all other important proposed work)

Pictured Cliffs Sand Test. Estimated total depth 2400'.

Surface Casing: 90' of 8-5/8" OD 24# J-55 casing cemented with 80 sacks, circulated to surface.

Production " : Approximately 2300' of 5-1/2" OD 15.5# J-55 casing cemented with 100 sacks.

If commercial production is indicated, the producing section will be shot with nitroglycerin and/or sand-oil treated.

I understand that this plan of work must receive approval in writing by the Geological Survey before operations may be commenced.

Company BENSON-MONT IN-CHEER DRILLING CORP.

Address 405 1/2 West Broadway

Farmington, New Mexico

By [Signature]

Title Vice-President

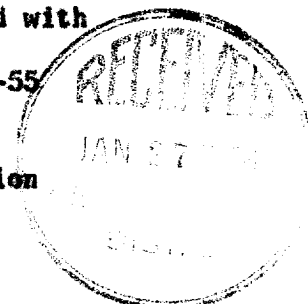

Company BENSON - MONTIN AND GREER  
Lease FOSTER - RIDDLE Well No. 1  
Sec. 13, T. 25 N., R. 8 W., N.M.P.M.  
Location 1065' FROM THE NORTH LINE AND 1850' FROM  
THE WEST LINE.  
Elevation 6635.0 UNGRADED GROUND.

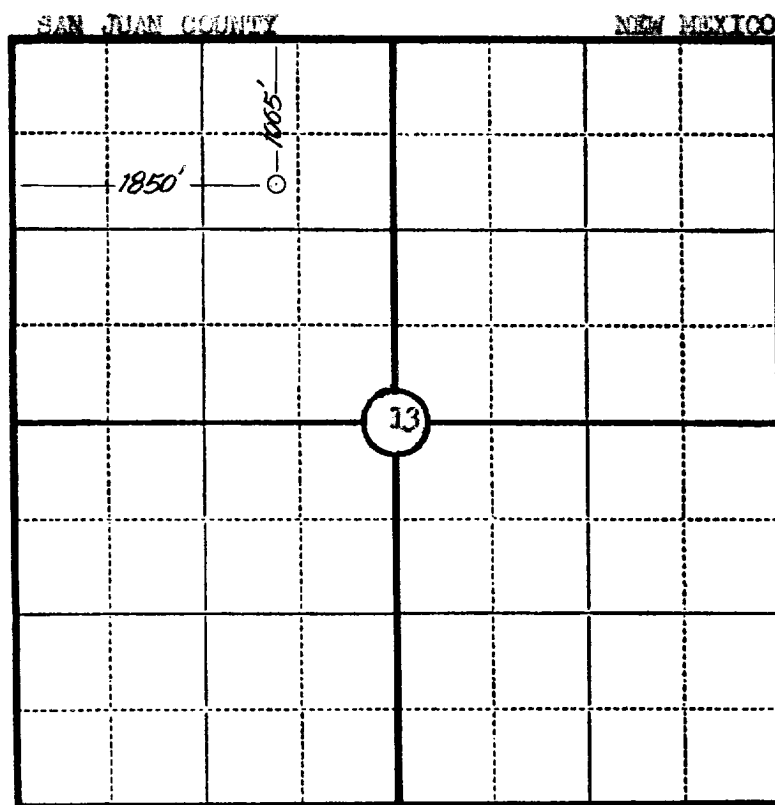

Scale—4 inches equal 1 mile.

This is to certify that the above plat was prepared from field notes of actual surveys made by me or under my supervision and that the same are true and correct to the best of my knowledge and belief.

Seal:

*James P. Leese*  
Registered Land Surveyor.  
James P. Leese  
N. Mex. Reg. No. 1463

Surveyed 20 December, 1955

SAN JUAN ENGINEERING COMPANY, FARMINGTON, N. M.

