

NEW MEXICO OIL CONSERVATION COMMISSION
Santa Fe, New Mexico

NOTICE OF INTENTION TO DRILL OR RECOMPLETE

Notice must be given to the District Office of the Oil Conservation Commission and approval obtained before drilling or recompletion begins. If changes in the proposed plan are considered advisable, a copy of this notice showing such changes will be returned to the sender. Submit this notice in **QUINTUPLICATE**. One copy will be returned following approval. See additional instructions in Rules and Regulations of the Commission.

Farmington, New Mexico

(Place)

August 9, 1955

(Date)

OIL CONSERVATION COMMISSION
SANTA FE, NEW MEXICO

Gentlemen:

You are hereby notified that it is our intention to commence the (Drilling) ~~(Recompletion)~~ of a well to be known as

El Paso Natural Gas Company

(Company or Operator)

Kelly State

(Lease)

, Well No. **1**, in **A** (Unit) The well is

located **990** feet from the **North** line and **1090** feet from the

East line of Section **16**, T. **25N**, R. **12W**, NMPM.

(GIVE LOCATION FROM SECTION LINE) **Wildcat** Pool, **San Juan** County

If State Land the Oil and Gas Lease is No. **E 6597**

If patented land the owner is

Address

We propose to drill well with drilling equipment as follows: **Rotary tools to an estimated total depth of 5270'.**

The status of plugging bond is **Statewide**

Drilling Contractor **Company tools.**

We intend to complete this well in the formation at an approximate depth of **5270** feet.

CASING PROGRAM

We propose to use the following strings of Casing and to cement them as indicated:

Size of Hole	Size of Casing	Weight per Foot	New or Second Hand	Depth	Sacks Cement
13 3/4"	9 5/8"	25.4#	New	170'	125
8 3/4"	7"	20 & 23#	New	4900'	350

If changes in the above plans become advisable we will notify you immediately.

ADDITIONAL INFORMATION (If recompletion give full details of proposed plan of work.) **Intervals which are possible producing zones will be drill stem tested and after setting 7" casing such intervals that show to be possible producing zones will be perforated, tested and possibly sandoil fractured.** (over)

Approved **8-10**, 19 **55**
Except as follows:

OIL CONSERVATION COMMISSION

By **A. R. Keefe**
Title **PETROLEUM ENGINEER DIST. NO. 3**

Sincerely yours,

El Paso Natural Gas Company

(Company or Operator)

By **Will W. Wood**

Petroleum Engineer

Position **Send Communications regarding well to**

Name **E. J. Coel**

Address **Box 997, Farmington, New Mexico**

U. S. CONSERVATION COMMISSION
AZTEC DISTRICT OFFICE

No. Copies Received 4

DISTRIBUTION

	NO. FURNISHED	
Operator	1	
Santa Fe	1	
Proration Office		
State Land Office	1	
U. S. G. S.	2	
Transporter		
File	1	

Tentative formation tops:

Pictured cliffs
Cliff House
Point Lookout
Gallup
Sanassee
L. Mancos

1095'
2995'
3595'
4645'
5150'
5260'

[Handwritten signature]

COMPANY EL PASO NATURAL GAS COMPANY

Well Name & No. KELLY STATE NO. 1 Lease No. E6597

Location 990 FEET FROM THE NORTH LINE, 1090 FEET FROM THE EAST LINE

Being in NE/4 OF THE NE/4

Sec. 16, T 25 N., R 12 W., N.M.P.M., SAN JUAN COUNTY, NEW MEXICO

Ground Elevation 6229.41

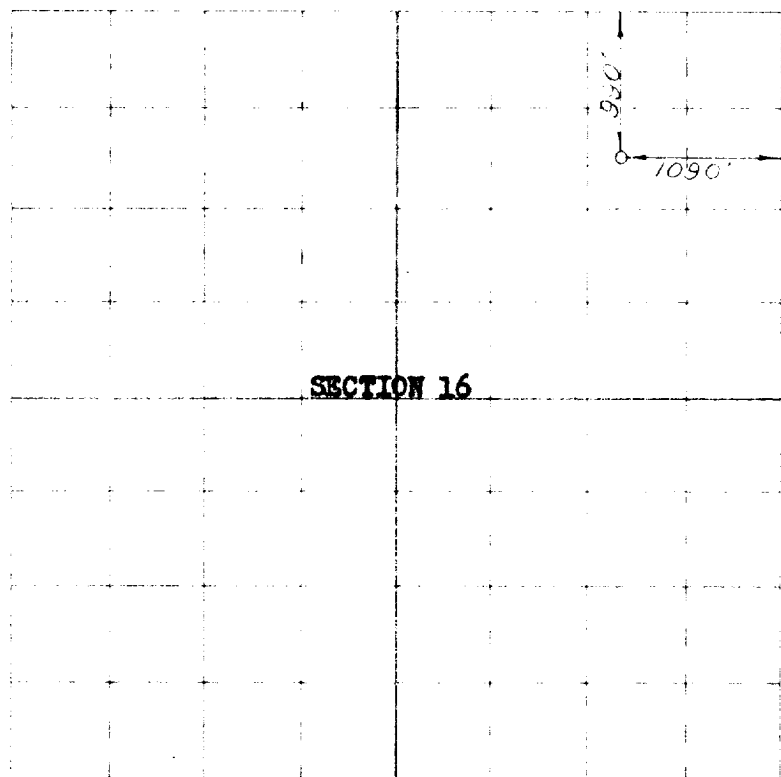

Scale -- 4 inches equals 1 mile

Surveyed AUGUST 2, 19 55

This is to certify that the above plat was prepared from field notes of actual surveys made by me or under my supervision and that the same are true and correct to the best of my knowledge and belief.

Seal:

E. O. Walker
Registered Professional
Engineer and Land Surveyor.

Farmington, New Mexico

160 ACRES, NE/4 OF SECTION (PLAT)



OIL CONSERVATION COMMISSION

AZTEC DISTRICT OFFICE

No. Copies Received

6

DISTRIBUTION

	NO. FURNISHED	
Operator	1	
Santa Fe	1	
Proration Office		
State Land Office	1	
U. S. G. S.	2	
Transporter		
File	1	