

NEW MEXICO
OIL CONSERVATION COMMISSION

Form C-128

Well Location and/or Gas Proration Plat

Date **JUNE 26, 1956**

Operator **British American Oil Producing Company** Lease **Govt. Seige**

Well No. **SALE B-2** Section **3** Township **25 North** Range **13 West** NMPM

Located **1980** Feet From **North** Line, **660** Feet From **West** Line,

San Juan

County, New Mexico.

G. L. Elevation **6337**

Name of Producing Formation **Dakota (expected)** Pool **Bisti Gallup** Dedicated Acreage

(Note: All distances must be from outer boundaries of Section)

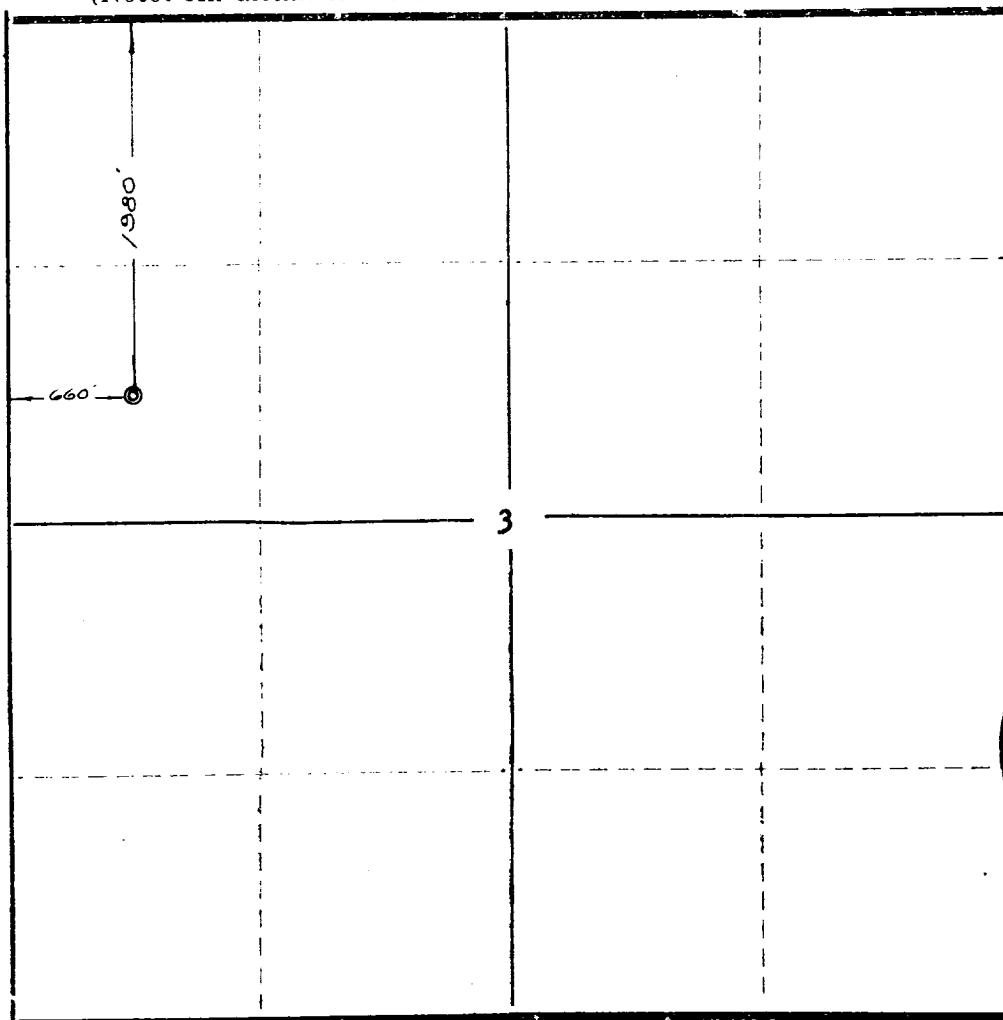

NOTE

This section of form is to be used for gas wells only.

SCALE: 1" 1000'

1. Is this Well a Dual Comp. ? Yes No
2. If the answer to Question 1 is yes, are there any other dually completed wells within the dedicated acreage?
Yes No

Original Signed by:

Name **Thomas M. Hogan**

Position **District Superintendent**

Representing **British-American Oil Prod Co**

Address **Box 180, Denver, Colorado.**

This is to certify that the above plat was prepared from field notes of actual surveys made by me or under my supervision and that the same are true and correct to the best of my knowledge and belief.

Date Surveyed **June 22, 1956**

Ernest V. Echhawk

Ernest V. Echhawk

Reg. Land Surveyor, N. Mex., Reg. No. 1545



SECRET

WILDLIFE CONSERVATION COMMISSION		
AZTEC DISTRICT OFFICE		
No. Copies Received 4		
DISTRIBUTION		
	NO. FURNISHED	
Operator	1	
Santa Fe	1	
Proration Office		
State Land Office		
U. S. G. S.	1	
Transporter		
File	1	✓