



COPY TO O.C.C.

IN REPLY REFER TO:

UNITED STATES
DEPARTMENT OF THE INTERIOR
GEOLOGICAL SURVEY
P. O. Box 965
Farmington, New Mexico

April 25, 1956

Sunray Mid-Continent Oil Company
Box 126
Hobbs, New Mexico

Re: Santa Fe 078056

Gentlemen:

Receipt is acknowledged of your "Notice of Intention to Drill" dated April 24, 1956 covering your well No. 3 New Mexico Federal "O" lease in SE¹ M⁰ sec. 6, T. 25 N., R. 12 W., N.M.P.M., San Juan County, New Mexico.

Your proposed work is hereby approved subject to compliance with the provisions of the "Oil and Gas Operating Regulations" revised May 25, 1948, a copy of which will be sent to you on request, and subject to the following conditions:

1. Drilling operations so authorized are subject to the attached sheet for general conditions of approval.
2. Furnish copies of all logs.

Very truly yours,

(Sg) J. W. Long

Jerry W. Long
Acting District Engineer

JWLong:ac

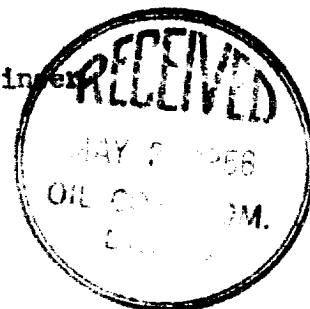

UNITED STATES
DEPARTMENT OF THE INTERIOR
GEOLOGICAL SURVEY



COPY TO O.C.C.



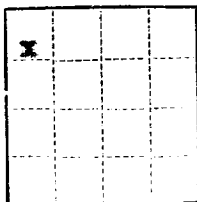

(SUBMIT IN TRIPLICATE)

UNITED STATES
DEPARTMENT OF THE INTERIOR
GEOLOGICAL SURVEY

Land Office USA - 078056Lease No. 1Unit

SUNDRY NOTICES AND REPORTS ON WELLS

X

NOTICE OF INTENTION TO DRILL	SUBSEQUENT REPORT OF WATER SHUT-OFF
NOTICE OF INTENTION TO CHANGE PLANS	SUBSEQUENT REPORT OF SHOOTING OR ACIDIZING
NOTICE OF INTENTION TO TEST WATER SHUT-OFF	SUBSEQUENT REPORT OF ALTERING CASING
NOTICE OF INTENTION TO RE-DRILL OR REPAIR WELL	SUBSEQUENT REPORT OF RE-DRILLING OR REPAIR
NOTICE OF INTENTION TO SHOOT OR ACIDIZE	SUBSEQUENT REPORT OF ABANDONMENT
NOTICE OF INTENTION TO PULL OR ALTER CASING	SUPPLEMENTARY WELL HISTORY
NOTICE OF INTENTION TO ABANDON WELL	

(INDICATE ABOVE BY CHECK MARK NATURE OF REPORT, NOTICE, OR OTHER DATA)

April 21

56

Federal 40% lease

Well No. 3 is located 1980 ft. from N line and 660 ft. from E line of sec. 6
SW 1/4 of 12/4 200 188 W

Section 12 (Field) 12 (County or Subdivision) 188 (State or Territory)
 (Range) 188 (Meridian) 188

The elevation of the derrick floor above sea level is ft.

DETAILS OF WORK

(State names of and expected depths to objective sands; show sizes, weights, and lengths of proposed casings; indicate mudding jobs, cementing points, and all other important proposed work)

We propose to drill this well with rotary tools to a sufficient depth to test the Gallup Sand expected at 4650'.

We propose to set 200' of 9-5/8" 32.30% J-45 surface casing and cement to the surface.

We propose to drill through the Gallup Sand section to a depth of approximately 5000' and if productive, to set 7" casing through the zone. We intend to use scratchers and centralizers and once it comes to cement at least 300' above the top of the pay zone.

We propose to run perforate the casing and sand oil free the formation prior completion.

I understand that this plan of work must receive approval in writing by the Geological Survey before operations may be commenced.

Sunray Oil Company

Company Box 120Address Albuquerque, New MexicoBy J. A. Barry

District Superintendent

Title

NEW MEXICO
OIL CONSERVATION COMMISSION

Form C-123

Well Location and/or Gas Proration Plat

Date 4-20-56

Operator Sunray Mid-Continent Oil Company Lease _____
Well No. Fed. C#3 Section 6 Township 25 North Range 12 West NMPM
Located 1980 Feet From North Line, 660 Feet From West Line,
San Juan County, New Mexico. G. L. Elevation 6186
Name of Producing Formation Gallup Sand Pool undesignated Dedicated Acreage 40

(Note: All distances must be from outer boundaries of Section)

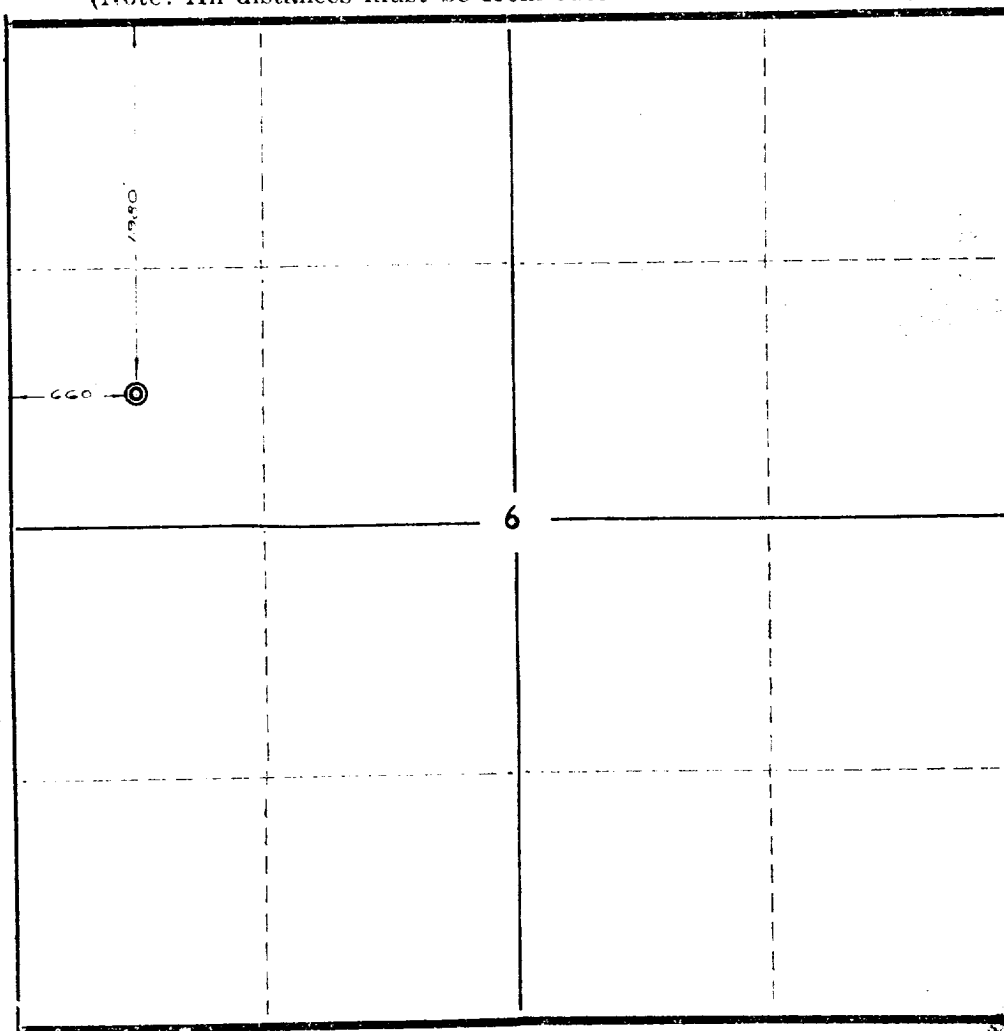

NOTE
This section of
form is to be
used for gas
wells only.

SCALE: 1" = 1000'

1. Is this Well a Dual Comp. ? Yes No
2. If the answer to Question 1 is yes, are there any other dually completed wells within the dedicated acreage?
Yes No

Name Ernest V. Echohawk
Position Reg. Land Surveyor
Representing Sunray Mid-Continent Oil Co
Address Box 125 - Hobbs, N. M.

This is to certify that the above plat was prepared from field notes of actual surveys made by me or under my supervision and that the same are true and correct to the best of my knowledge and belief.

Date Surveyed April 20, 1956

Ernest V. Echohawk
Reg. Land Surveyor, N. Mex., Reg. No. 1545

